

Flip for Leckey Attendant Foot Lock

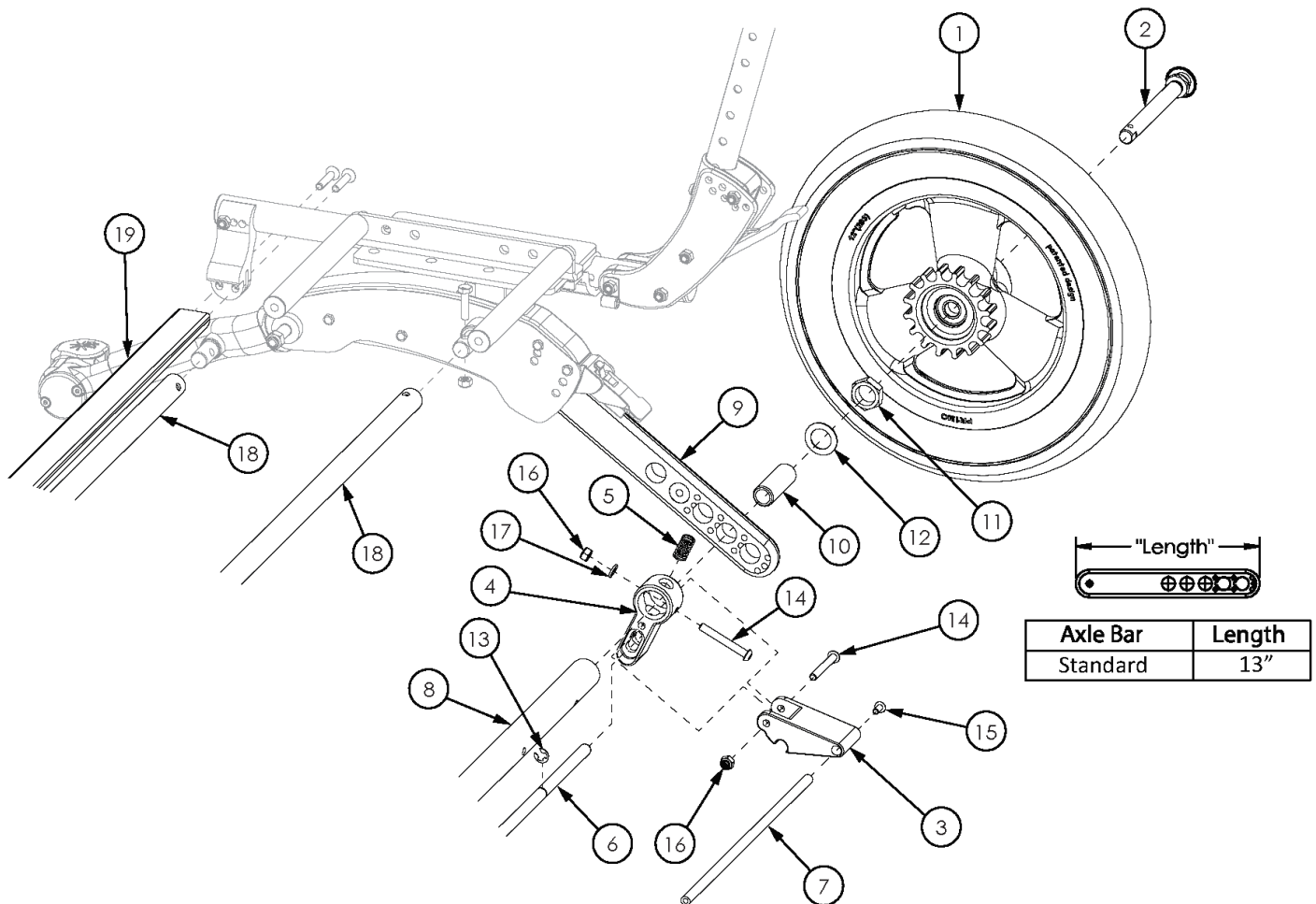

This design effective starting with serial number FLP007536 Attendant Foot Lock Kits do not include wheel or locking hub; please also select the appropriate Attendant Foot Lock Wheels

| Item Number | Part Number | Description | Quantity |
|----------------------------------|-------------|--|----------|
| 3-5, 6a, 7a, 13-17 | 505474 | Attendant Foot Lock Kit 14 Wide FLIP | 1 |
| 3-5, 6b, 7b, 13-17 | 505475 | Attendant Foot Lock Kit 15 Wide FLIP | 1 |
| 4, 6a, 7a, 8a, 13, 18a, 18c, 19a | 505483 | Strut Kit 14" Wide Flip w/ Attendant Foot Lock | 1 |
| 4, 6b, 7b, 8b, 13, 18b, 18d, 19b | 505484 | Strut Kit 15" Wide Flip w/ Attendant Foot Lock | 1 |
| 4, 6a, 13 | 505465 | Locking Rod Hub Lock 14 Wide Kit | 1 |
| 4, 6b, 13 | 505466 | Locking Rod Hub Lock 15 Wide Kit | 1 |

| Item Number | Part Number | Description | Quantity |
|-------------|-------------|---|----------|
| 1a | 502853 | Flip Attendant Foot Lock Wheel, 12" Pneumatic EACH | 1 |
| 1b | 502854 | Flip Attendant Foot Lock Wheel, 12" Airless EACH | 1 |
| 1c | 502855 | Flip Attendant Foot Lock Wheel, 12" Full Poly EACH | 1 |
| 1d | 502856 | Flip Attendant Foot Lock Wheel, 16" Pneumatic EACH | 1 |
| 1e | 502857 | Flip Attendant Foot Lock Wheel, 16" Airless EACH | 1 |
| 1f | 502858 | Flip Attendant Foot Lock Wheel, 16" Full Poly EACH | 1 |
| 2a | 101108 | Axle Quick Release w/ Button 1/2" x 99MM <i>Used with axle receiver 100756 (Discontinued 3/3/2023)</i> | 2 |
| 2b | 101191 | Axle Quick Release w/ Button 1/2" x 110MM <i>Used with axle receiver 114480</i> | 1 |
| 3 | 001928 | Lever, Hub Lock | 2 |
| 5 | 001929 | Spring, Hub Lock | 2 |
| 7a | 001943 | Link Rod Hub Lock 14 Wide | 1 |
| 7b | 001944 | Link Rod Hub Lock 15 Wide | 1 |
| 8a | 001844 | Axle Tube, 14W | 1 |
| 8b | 001845 | Axle Tube, 15W | 1 |
| 9a | 001838 | Axle Bar, Standard | 2 |
| 10 | 114480 | Axle Receiver, 2.5" Length <i>Replaced part number 100756</i> | 2 |
| 11 | 100514 | Axle Receiver Nut M18 x D12 x 8mm | 2 |
| 12 | 100583 | Axle Plate Washer 18mm | 2 |
| 13 | 103503 | 3/8" External Self-Locking Shaft Ring | 2 |
| 14 | 100670 | M6 x 45 BTN SHCS BLK ZC | 4 |
| 15 | 100669 | M5 x 10 BTN SHCS BLKZC w/Patch | 2 |
| 16 | 100658 | M6 Nylock Nut Blk Zn | 4 |
| 17 | 100746 | M6 Flat Washer Blk Zn | 2 |
| 18a | 002632 | Frame Growth Strut 10.5" <i>Used on 14" wide chairs</i> | 1 |
| 18b | 002633 | Frame Growth Strut 11.5" <i>Used on 15" wide chairs</i> | 1 |

| Item Number | Part Number | Description | Quantity |
|-------------|-------------|--|----------|
| 18c | 002635 | Frame Growth Strut 13.5" <i>Used on 14" wide chairs</i> | 1 |
| 18d | 002636 | Frame Growth Strut 14.5" <i>Used on 15" wide chairs</i> | 1 |
| 19a | 001883 | Strut Tube Seat 14 Wide | 1 |
| 19b | 001884 | Strut Tube Seat 15 Wide | 1 |