

# Flip Adjustable Height with Adjustable Handle Backrest - Growth

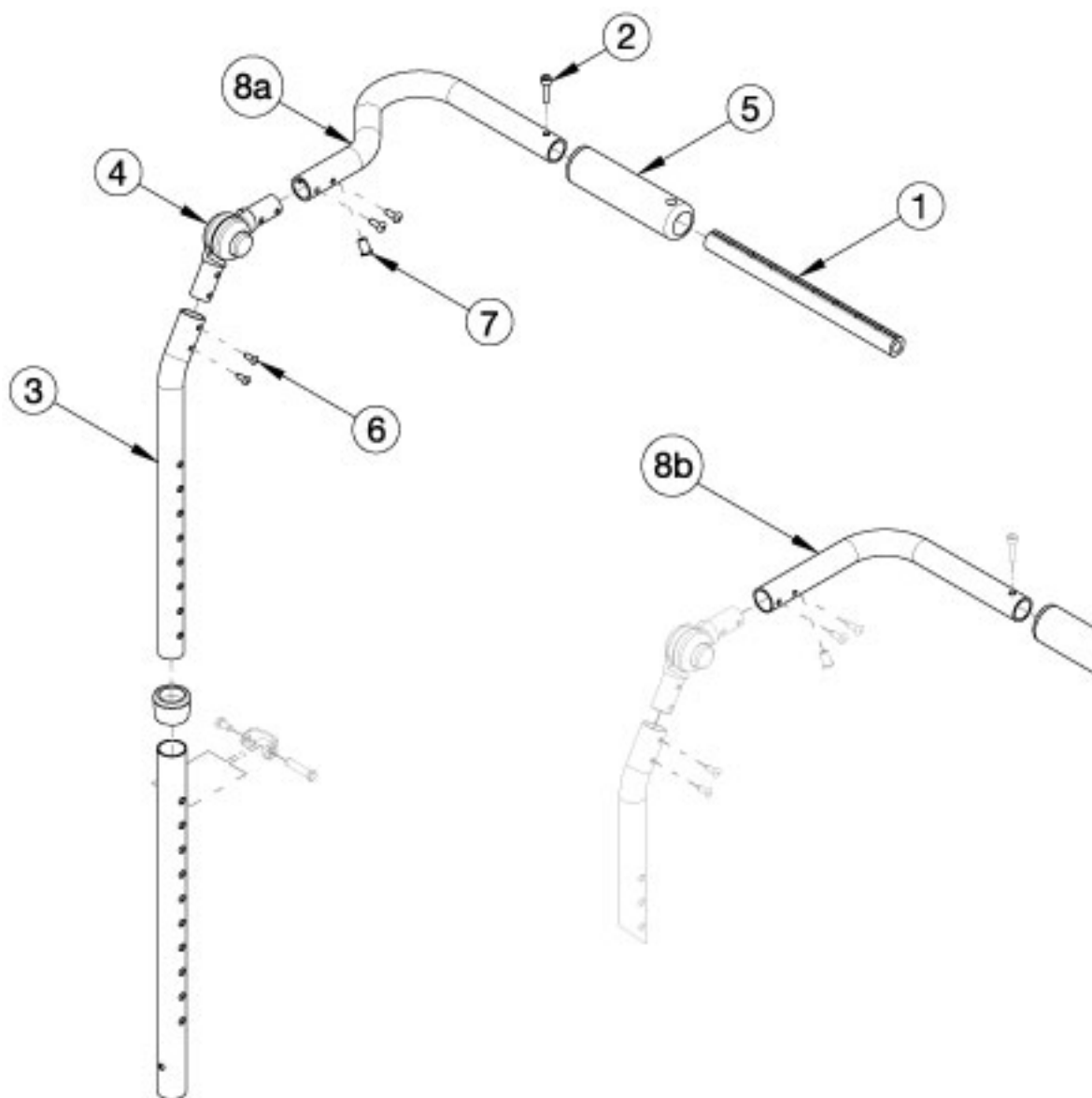

Has your width changed? Will the push handle (#8) accommodate your new width? If no, please select the appropriate upper back tube assemblies. If chair was invoiced prior to 12/18/23, an upper back tube assembly is required. If chair was invoiced after to 12/18/23, upper back tube assembly can now be purchased individually

Item Number	Part Number	Description	Quantity
3, 4, 5, 6, 7, 8a	502813	Upper Back Tube Assembly, Height Adj, 10-13W, Right FLIP	1
3, 4, 5, 6, 7, 8a	502814	Upper Back Tube Assembly, Height Adj, 10-13W Left FLIP	1
3, 4, 5, 6, 7, 8b	502665	Upper Back Tube Assembly Height Adj, Right Focus/Flip <i>Used on 14-18 wide with serial numbers prior to FLP010784 and serial numbers starting with FLP011080</i>	1

Item Number	Part Number	Description	Quantity
3, 4, 5, 6, 7, 8b	502666	Upper Back Tube Assembly Height Adj, Left Focus/Flip <i>Used on 14-18 wide with serial numbers prior to FLP010784 and serial numbers starting with FLP011080</i>	1
1a	002578	Growth Strut, Stroller, Short	1
1a, 2	503107	Growth Strut Assembly Short, Focus/Flip	1
1b	002579	Growth Strut, Stroller, Long <i>Used only if growing chair from 13" wide or less to 14" wide or greater</i>	1
2	101843	M5 x 20 SHCS Blk Zn	1