

101 Rehab Shower/Commode Chair-Bath/Toilet Modular System

350 lb. Weight Capacity Effective January 1, 2025

Email form to webquotes@altimatemedical.com

Bill To:

Ship To:

Date: P.O.#: Quote#: Account#: Ordered By: Supplier Company: ATP (REQUIRED): Address: City, State, Zip: Phone: Email:

Name: Address: City/State: Zip: Phone: Tag For:



Ph: 800.342.8968 or 507.697.6393 Fax: 877.342.8968 or 507.697.6900 orders@activeaid.com activeaid.com

Frames - must select one

[X] PRT50000 18"Wx18"D Black-Stainless Steel Frame \$147

Seats - must select one

- [] P61367 16"Wx18"D Ensolite® Front/Rear Open Seat (A-4.5"xB-7.5" opening, 2" foam)* \$575
[] P61368 16"Wx15.5"D Ensolite® Front/Rear Open Seat (A-3.5"xB-6" opening, 2" waterfall foam)* \$575
[] P61369 16"Wx16"D Ensolite® Front/Rear Open Seat (A-4"xB-6.5" opening, 1" foam)* \$575
[] P61189 18"Wx18"D Molded Gel Front Open Contoured Seat (A-3.5"xB-7.25" opening, 2.5" gel) \$568
[] P61190 18"Wx18"D Molded Foam Oval Contoured Seat (A-7.25"xB-12.5" opening, 2.25" foam) \$487
[] P61191 18"Wx18"D Molded Gel Oval Contoured Seat (A-7.25"xB-12.5" opening, 2.5" gel) \$568
[] P61192 18"Wx18"D Molded Foam Front Open Contoured Seat (A-3.5"xB-7.25" opening, 2.25" foam) \$487
[] P60911 18"Wx18"D Ensolite® Front/Rear Open Seat (A-4.5"xB-7.5" opening, 1" foam)* \$575
[] P61370 18"Wx18"D Ensolite® Front/Rear Open Seat (A-5.25"xB-8" opening, 2" waterfall foam)* \$575

*Seat works in all 4 positions

Legs - must select one

- [] PRT50001 Short Legs w/Crutch Tips (height seat range from floor to bottom frame-15.5"-18.5") \$159
[] PRT50002 Short Legs w/Suction Cups (height seat range from floor to bottom frame-15.5"-18.5") \$206
[] PRT50003 Long Legs w/Crutch Tips (height seat range from floor to bottom frame-18.5"-21.5") \$165
[] PRT50004 Long Legs w/Suction Cups (height seat range from floor to bottom frame-18.5"-21.5") \$206

Seat Opening Measurements

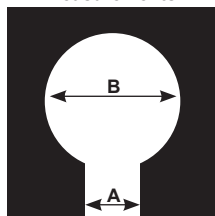

Oval Opening Measurements

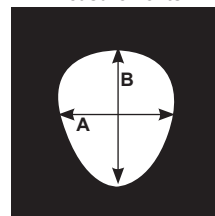

Notes

Multiple horizontal lines for user notes.