



ALLCOURT DUAL ANTI-TIP 5TH WHEEL SUPPORT



Please read these instructions carefully before beginning the assembly. Failure to understand and follow assembly instructions may result in injury to technician and/or end user and may void the warranty. If you have any questions call Sunrise Medical Technical Support at +1 (800) 333-4000.

ITEM NO.	QTY	TITANIUM ASSEMBLY	ALUMINUM ASSEMBLY
1	5	3/4" SADDLE	3/4" SADDLE
2	2	INSERT PLUG	INSERT PLUG
3	1	SEAT CLAMP W/GROOVE	SEAT CLAMP W/GROOVE
4	1	SEAT CLAMP	SEAT CLAMP
5	7	1/4" WASHER	1/4" WASHER
6	1	2-1/2 HEX CAP SCREW TI	2-1/2 BUTTONHEAD CAP SCREW AL
7	1	REAR SUPPORT TUBE	REAR SUPPORT TUBE
8	2	1-3/4" HEX CAP SCREW TI	1-3/4" BUTTONHEAD SCREW AL BLK
9	2	REAR SUPPORT STRAP	REAR SUPPORT STRAP
10	1	2" HEX CAP SCREW TI	2" BUTTONHEAD SCREW AL
11	1	THREADED CLAMP	THREADED CLAMP
12	2	RECESS CLAMP	RECESS CLAMP
13	4	NYLOCK NUT AL	NYLOCK NUT STEEL
14	1	SPACER	SPACER
15	2	1" SOCKET HEAD SCREW BLK	1" SOCKET HEAD SCREW BLK
16	2	LOCK WASHER	LOCK WASHER

The following assembly instructions are for the 5th Wheel Support for the RGK AllCourt sportchair with dual anti-tip.

To connect 5TH Wheel Support:

1. Unscrew nut (item 13a) from bolt (item 6).
2. Connect clamp (items 3 and 4) to rear cross brace on seat frame (detail A). Screw nut back onto screw with washer (items 13a, 5, and 6). Leave loose.
3. Remove screws and lock washers (items 15 and 16) from anti-tip clamps (items 11 and 12). Install clamps around anti-tip cross tube at rear of chair and spacer (item 14). Reconnect all hardware (detail A). Leave loose.
4. Rotate anti-tip clamps (items 11 and 12) around anti-tip tube. When satisfied with positioning tighten all nuts and bolts on both clamps at seat and at anti-tip.
5. If necessary for height adjustment remove nuts, screws, saddles, and washers (item 8) from tube support (item 7) and reattach in next set of adjustment holes.

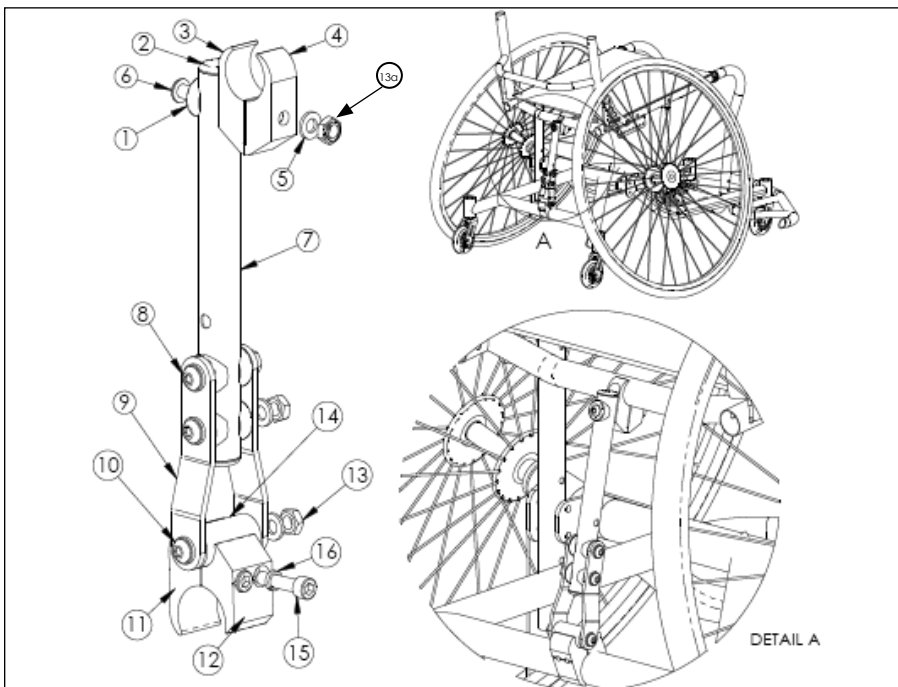

⚠️ DEALER/TECHNICIAN WARNING

Attention dealers and qualified technicians, do not operate or service this device without first reading the owner's manual. If you do not understand the instructions and warnings in the owner's manual please contact the Sunrise Technical Service Department before operating and/or servicing the RGK wheelchair. Failure to do so may result in damage and/or injury.

Find more information and important warnings in the wheelchair owner's manual or at: www.SunriseMedical.com



Customer Service: +1 (800) 333-4000
In Canada (800) 263-3390
or visit www.SunriseMedical.com

© 2023 Sunrise Medical (US) LLC
07/2023 P/N 930720 Rev. B
Pg 1 of 1