

CR45 Adjustable Height with Adjustable Handle Backrest

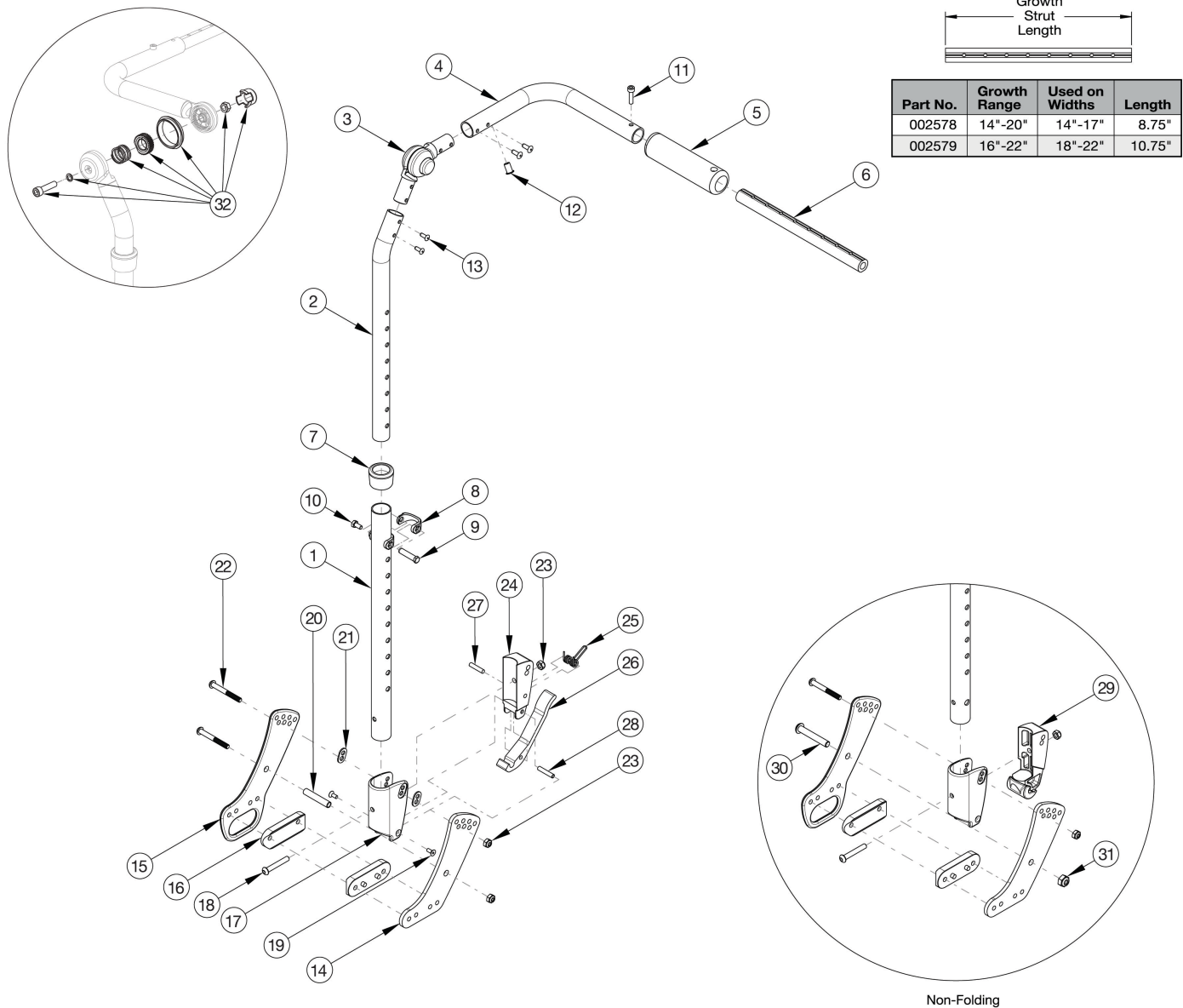

If chair was invoiced prior to 12/18/23, an upper back tube assembly is required. If chair was invoiced after to 12/18/23, parts 2-4 and 13 shown in the diagram above can now be purchased individually. If changing from another style backrest and the hand tilt is present, a new Hand Tilt Cable/Trigger Kit may be required.

Item Number	Part Number	Description	Quantity
1a, 7 - 10, 17 - 19 - 24, 26 - 28	502663	Back Assembly w/Latch Insert Lower Tube Height Adjustable Short Focus/CR45/Flip	1
1b, 7 - 10, 17 - 19 - 24, 26 - 28	502664	Back Assembly w/Latch Insert Lower Tube Height Adjustable Tall Focus/CR45/Flip	1
1a, 7 - 9, 17 - 18, 22 - 23, 29 - 31	502673	Lower Tube w/Latch Insert Height Adjustable Back Short Non-Folding Focus/CR45/Flip	1

Item Number	Part Number	Description	Quantity
1a, 7 - 9, 17 - 18, 22 - 23, 29 - 31	502674	Lower Tube w/Latch Insert Height Adjustable Back Tall Non-Folding Focus/CR45/Flip	1
2a, 3, 4a, 5, 12 - 13	116504	Upper Back Tube Assembly Height Adjustable, Right CR45	1
2b, 3, 4b, 5, 12 - 13	116505	Upper Back Tube Assembly Height Adjustable, Left CR45	1
14, 16, 20, 22 - 23	116506	Backrest Hardware Assembly, Single Side, Std CR45	1
14 - 16, 20, 22 - 23	116507	Backrest Hardware Assembly, Single Side, Transit CR45	1
14, 16, 22 - 23, 30 - 31	116508	Backrest Hardware Assembly, Single Side, Std Non-Folding CR45	1
14 - 16, 22 - 23, 30 - 31	116509	Backrest Hardware Assembly, Single Side, Transit Non-Folding CR45	1
6a, 11	503107	Growth Strut Assembly Short, Focus/Flip <i>Used on chairs 14"-17" wide</i>	1
6b, 11	503108	Growth Strut Assembly Long, Flip/Focus <i>Used on chairs 18"-22" wide</i>	1
4b, 5, 11, 12, 13	122918	Push Handle Tube w/ Grip and Hardware, Left	1
4a, 5, 11, 12, 13	122920	Push Handle Tube w/ Grip and Hardware, Right	1
1b	001901	Lower Tube, HT ADJ Back Tall	1
2a	002597	Tube, Upper Ht Adj Back R <i>Used on chairs starting 12/18/23</i>	1
2b	002598	Tube, Upper Ht Adj Back L <i>Used on chairs starting 12/18/23</i>	1
3	116066	Locking Hinge Assembly <i>Used on chairs starting 12/18/23</i>	1
5	001098	Foam Push Handle Tilt	1
6a	002578	Growth Strut, Stroller, Short	1
6b	002579	Growth Strut, Stroller, Long	1
7	001083	Bushing Height Adjustable Back Tilt	1
8	000988	Fastener Retainer	1
9	000987	Threaded Fastener	1
10	200427	M5 x 10 CLS8.8 HHCS ZC w/Patch DIN933	1
11	101843	M5 x 20 SHCS Blk Zn	1
13	100669	M5 x 10 BTN SHCS BLKZC w/Patch <i>Used on chairs starting 12/18/23</i>	4

Item Number	Part Number	Description	Quantity
14	112488	Standard Back Plate, CR45/Flip XPA <i>Quantity of 4 used with non-transit. Quantity of 2 used with transit.</i>	1
15	112489	Transit Back Plate, CR45/Flip XPA <i>Quantity of 2 used with transit.</i>	1
16	112491	Saddle, Dual, 1" x 2.0SP	2
18	100797	M6 x 40 BHCS BLK ZC	1
19	101818	M4 x 10 FHCS BLKZC w/Patch	2
20	002738	Spacer .313 OD x .243 ID x 1.68 long	1
21	001897	Washer, Dual, PSA	2
22	101781	M6 x 50mm Partial Thread BHCS Blk ZC	2
23	100658	M6 Nylock Nut Blk Zn	2
24	001895	Latch Insert, Folding Backrest	1
25	001896	Spring, Backrest Latch	1
26	001893	Latch Lever, Backrest	1
27	102694	Dowel Pin, M5 X 24, Blk Zn	1
28	002513	Threaded Barrel, 5mm OD x M4	1
29	002035	Insert, Backrest, Non-Folding	1
30	101815	M8 x 50 BHCS Blk Zn	1
31	100659	M8 Nylock Nut Blk Zn	1
32	110524	Locking Hinge Button Assembly with Instruction	1