

# User Activated Anti-Tips Clik

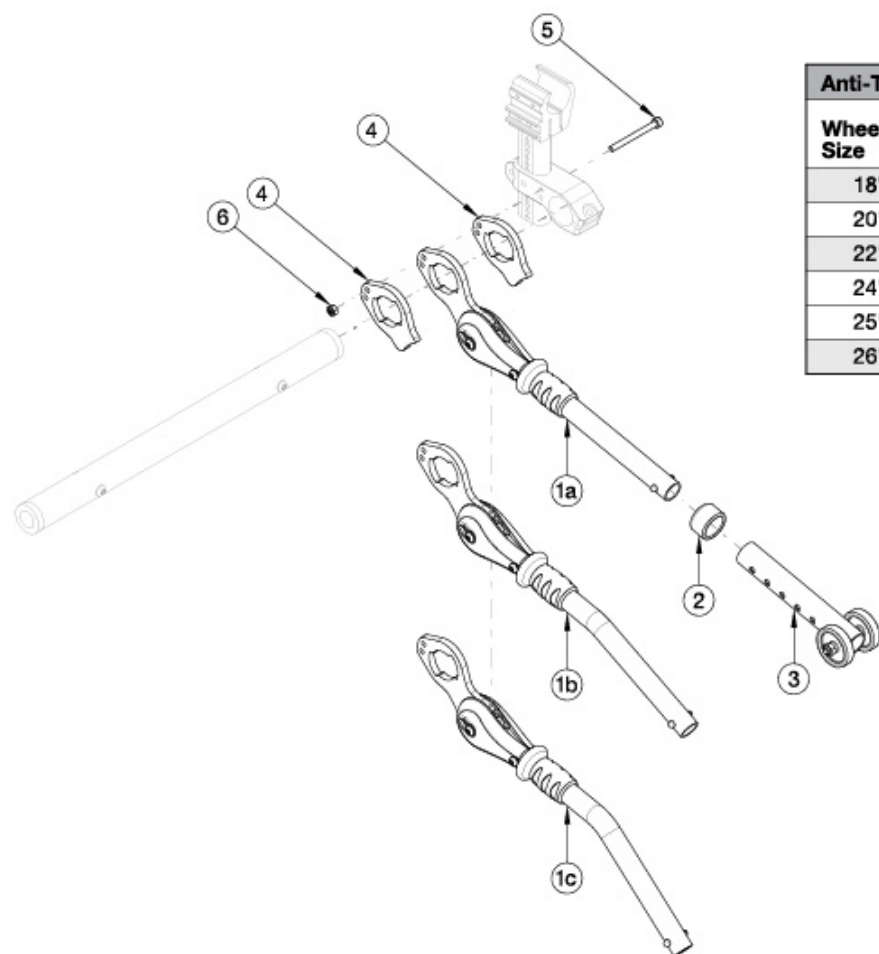

Anti-Tip Assemblies					
Wheel Size	Dump				
	1"	2"	3"	4"	5"
18"	116542	114198	114198	114198	114198
20"	114197	116542	116542	114198	114198
22"	114197	116542	116542	116542	114198
24"	114197	114197	116542	116542	116542
25"	114198	114197	114197	116542	116542
26"	114197	114197	116542	116542	116542

Contact Customer Service for chairs with more than 2" of variance between Front and Rear Seat Height. Complete assemblies contain "one" complete user activated anti-tip. Quantity two is required for a pair. A pair of User Activated Anti-Tips is not available if a tipping lever is present. Not available with One Arm Drive.

Item Number	Part Number	Description	Quantity
1a, 2-6	122611	UserActivated Anti-Tip Complete Assembly Straight CLIK/Rogue XP	1
1b, 2-6	122612	UserActivated Anti-Tip Complete Assembly Bent CLIK/Rogue XP	1
1c, 2-6	122613	UserActivated Anti-Tip Complete Assembly 15 Degrees CLIK/Rogue XP	1
1a	119617	User Activated Anti-Tip Assembly, Straight, Clik / Rogue XP	1
1b	119615	User Activated Anti-Tip Assembly, Bent, Clik / Rogue XP	1
1c	119616	User Activated Anti-Tip Assembly, Bent 15 Deg, Clik / Rogue XP	1
2	004306	Anti-Tip Anti Rattle Bushing	1

Item Number	Part Number	Description	Quantity
3	119668	Anti-Tip Lower Assembly	1
4	119610	User Tipper Mount Spacer, Klik / Rogue XP	1
5	121004	SHCS M5 X 0.8 X 55, Partially Threaded, Black Zinc, CLS 10.9	1
6	100657	M5 Nylock Nut Blk Zn	1