

Rogue ALX Adjustable Height Backrest with Adjustable Height Rigidizer Bar (Formerly Tsunami)

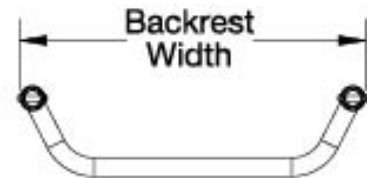
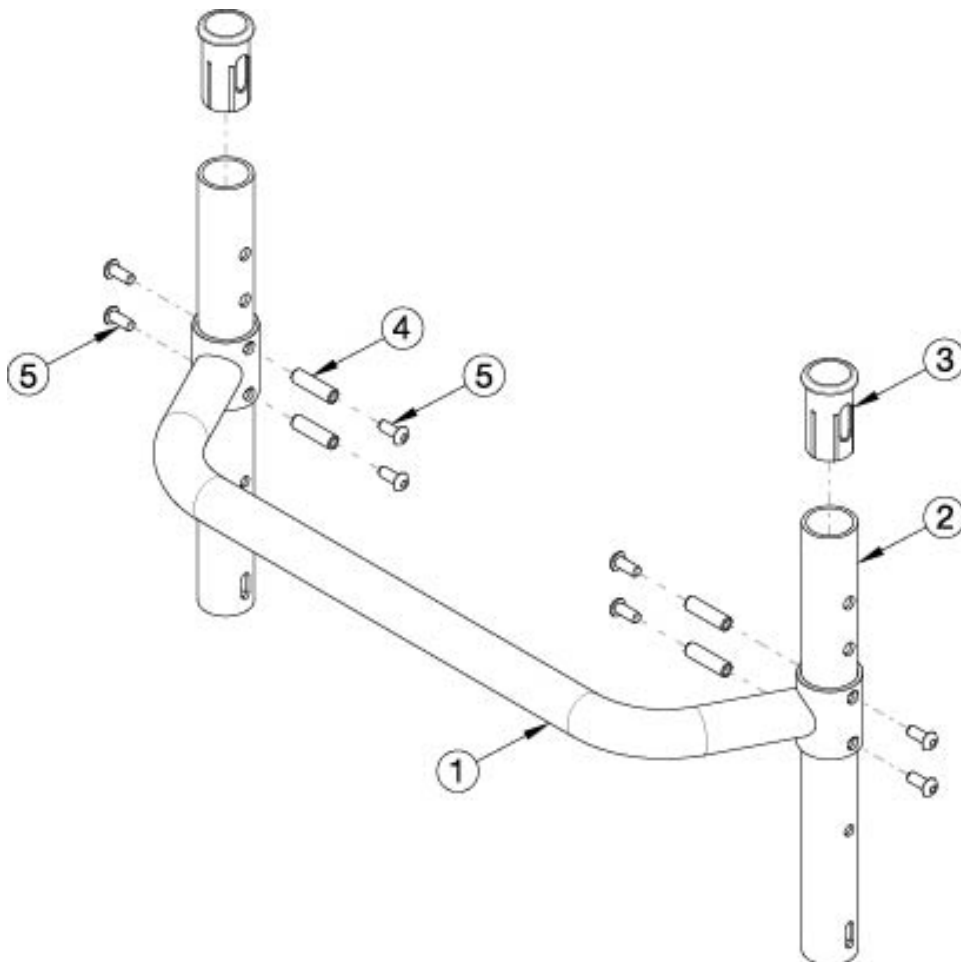

| Backrest | Width |
|--------------|-------|
| Backrest 10" | 10.3" |
| Backrest 11" | 11.3" |
| Backrest 12" | 12.3" |
| Backrest 13" | 13.3" |
| Backrest 14" | 14.3" |
| Backrest 15" | 15.3" |
| Backrest 16" | 16.3" |
| Backrest 17" | 17.3" |
| Backrest 18" | 18.3" |
| Backrest 19" | 19.3" |
| Backrest 20" | 20.3" |
| Backrest 21" | 21.3" |
| Backrest 22" | 22.3" |

| Item Number | Part Number | Description | Quantity |
|-------------|-------------|--|----------|
| 1a | 000525 | Adjustable Height Rigidizer Bar 10" | 1 |
| 1b | 000526 | Adjustable Height Rigidizer Bar 11" | 1 |
| 1c | 000527 | Adjustable Height Rigidizer Bar 12" Wide | 1 |
| 1d | 000528 | Adjustable Height Rigidizer Bar 13" Wide | 1 |
| 1e | 000185 | Adjustable Height Rigidizer Bar 14" Wide | 1 |
| 1f | 000186 | Adjustable Height Rigidizer Bar 15" Wide | 1 |
| 1g | 000187 | Adjustable Height Rigidizer Bar 16" Wide | 1 |
| 1h | 000188 | Adjustable Height Rigidizer Bar 17" Wide | 1 |
| 1i | 000189 | Adjustable Height Rigidizer Bar 18" Wide | 1 |

| Item Number | Part Number | Description | Quantity |
|-------------|-------------|--|----------|
| 1j | 000190 | Adjustable Height Rigidizer Bar 19" Wide | 1 |
| 1k | 000191 | Adjustable Height Rigidizer Bar 20" Wide | 1 |
| 1l | 000529 | Adjustable Height Rigidizer Bar 21" | 1 |
| 1m | 000530 | Adjustable Height Rigidizer Bar 22" | 1 |
| 2a | 000177 | Rigid Backrest Tube, 9.25" <i>Used with standard push handles, low profile push handles or omit push handles in any back height range. Also used with fold down push handles with a tall back height range.</i> | 2 |
| 2b | 109099 | Rigid Backrest Tube, 8.25" <i>Used with fold down push handles with a short or medium back height range</i> | 2 |
| 2a, 3 | 110663 | Rigid Backrest Tube, 9.25" with Sleeve <i>Used with standard push handles, low profile push handles or omit push handles in any back height range. Also used with fold down push handles with a tall back height range.</i> | 2 |
| 2b, 3 | 110664 | Rigid Backrest Tube, 8.25" with Sleeve <i>Used with fold down push handles with a short or medium back height range</i> | 2 |
| 3 | 000034 | Sleeve 3/4" x 1 1/2" | 2 |
| 4 | 000073 | M5 x 24 Threaded Barrel | 4 |
| 5 | 103524 | M5 x 10 BTN SHCS BLK ZN | 8 |