

## Front Mount Hanger Extension

---

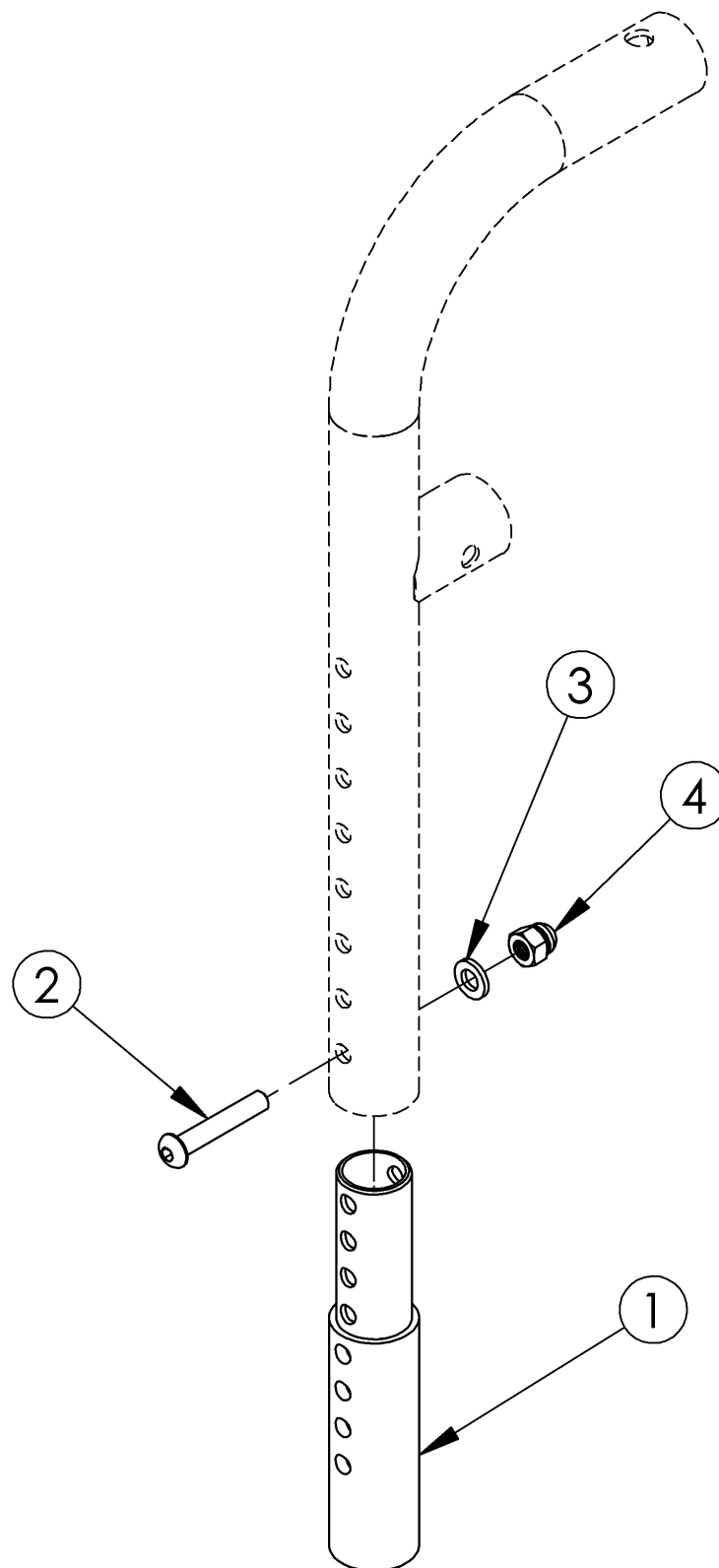

| Item Number | Part Number | Description   | Quantity |
|-------------|-------------|---|----------|
| 1           | 000164      | Hanger Extension 3" (Front Mount)                         | 1        |
| 2           | 101811      | M6 x 35 BHCS Blk Zn                                       | 1        |
| 3           | 100746      | M6 Flat Washer Blk Zn                                     | 1        |
| 4           | 100558      | M6 Nyl Ins Domed Cap L/N Zc                               | 1        |
| 1-4         | 502642      | Hanger Extension 3" (Front Mount) Assembly w/<br>Hardware | 1        |

Distance between Point A and Point B  
B = Footplate Length

**NOTE:** The yardstick on the top plane of the seat frame must lie flat against frame. The yardstick going from the footplate to the second yardstick must be square against the hanger tube.



Distance between Point A and Point B  
B = Footplate Length

**NOTE:** The yardstick on the top plane of the seat frame must lie flat against frame. The yardstick going from the footplate to the second yardstick must be square against the front tube.



Distance between Point A and Point B  
B = Footplate Length

**NOTE:** The yardstick on the top plane of the hanger must lie flat against hanger. The yardstick going from the footplate to the second yardstick must be square against the hanger tube.

