

# Flip Dynamic Back

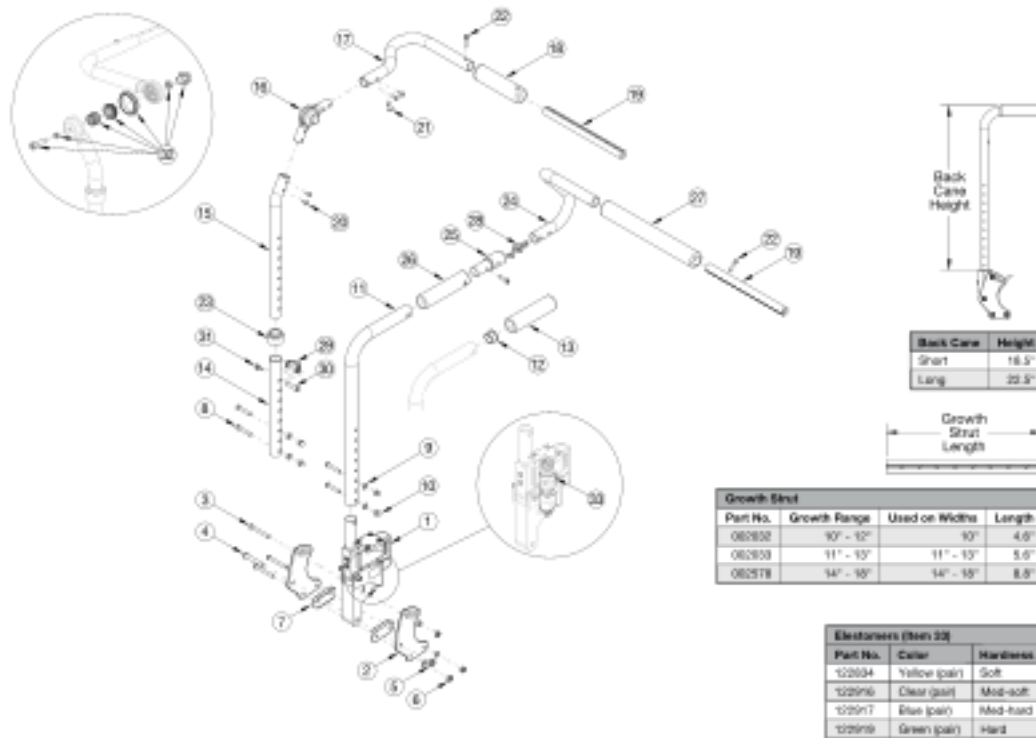

If chair was invoiced prior to 12/18/23, an upper back tube assembly is required. If chair was invoiced after to 12/18/23, parts 15-17 and 20 shown in the diagram above can now be purchased individually. If chair width is 14"-18" wide and has a serial number of FLP010784 through FLP011079, see the Discontinued Flip Seating Dynamics Rocker Back page. Note: Tilt Mechanism parts may be required if changing to a different backrest style. Please see the applicable tilt mechanism parts manual page for verification.

Item Number	Part Number	Description	Quantity
1a, 2a	504352	Dynamic Back Adj Ht w/ Back Plate PAIR, Flip <i>Elastomers Included</i>	1
1b, 2a	504353	Dynamic Back Fixed Ht w/ Back Plate PAIR, Flip <i>Elastomers Included</i>	1
1a, 2a, 2b	504354	Dynamic Back Adj Ht w/ Transit Back Plate PAIR, Flip <i>Elastomers Included</i>	1
1b, 2a, 2b	504355	Dynamic Back Fixed Ht w/ Transit Back Plate PAIR, Flip <i>Elastomers Included</i>	1

Item Number	Part Number	Description	Quantity
33a	122834	Yellow Replacement Elastomers (Pair)	1
33b	122916	Clear Replacement Elastomers (Pair)	1
33c	122917	Blue Replacement Elastomers (Pair)	1
33d	122919	Green Replacement Elastomers (Pair)	1
3-7, 9	504364	Frame Attaching Hardware for Dynamic Back Assembly, One Side Flip	1
8-10	502521	Tube Attaching Hardware for Dynamic Back Assembly, One Side Focus/Flip	1
8-10, 14, 23, 29, 30, 31	502518	Height Adjustable Lower Tube Assembly, Dynamic Back Tall	1
11a, 12, 13	504356	Back Tube Assembly Fixed with Grip, Dynamic Back Short Flip	1
11b, 12, 13	504357	Back Tube Assembly Fixed with Grip, Dynamic Back Tall Flip	1
11a, 26	504358	Back Cane Assm Fixed Stroller Short Flip	1
11b, 26	504359	Back Cane Assm Fixed Stroller Tall Flip	1
15a, 16, 17a, 18, 20, 21	504360	Upper Back Tube Assembly Height Adj, Right Flip <i>Used on 10" - 13" chair widths</i>	1
15b, 16, 17b, 18, 20, 21	504361	Upper Back Tube Assembly Height Adj, Left Flip <i>Used on 10" - 13" chair widths</i>	1
15a, 16, 17c, 18, 20, 21	502665	Upper Back Tube Assembly Height Adj, Right Focus/Flip <i>Used on 14" - 18" wide with serial numbers prior to FLP010784 and serial numbers starting with FLP011080</i>	1
15b, 16, 17d, 18, 20, 21	502666	Upper Back Tube Assembly Height Adj, Left Focus/Flip <i>Used on 14" - 18" wide with serial numbers prior to FLP010784 and serial numbers starting with FLP011080</i>	1
19a, 22	503107	Growth Strut Assembly Short, Focus/Flip	1
19b, 22	503108	Growth Strut Assembly Long, Flip/Focus	1
19a, 22, 23, 24a, 24b, 25, 27, 28	504367	Removable Stroller Handle Assm 10W Flip	1
19b, 22, 23, 24a, 24b, 25, 27, 28	504368	Removable Stroller Handle Assm 11-13W Flip	1
19c, 22, 23, 24c, 24d, 25, 27, 28	503104	Removable Stroller Handle Assembly 14-18W Focus/CR45/CR45/Flip/Liberty	1
24a, 27	504362	Stroller Handle w/ Foam, Right Flip <i>Used on 10" - 13" chair widths</i>	1
24b, 27	504363	Stroller Handle w/ Foam, Left Flip <i>Used on 10" - 13" chair widths</i>	1

Item Number	Part Number	Description	Quantity
24c, 27	501090	Stroller Handle with Foam Grip, Right <i>Used on 14" - 18" chair widths</i>	1
24d, 27	501091	Stroller Handle with Foam Grip, Left <i>Used on 14" - 18" chair widths</i>	1
3	101781	M6 x 50mm Partial Thread BHCS Blk ZC	3
4	101815	M8 x 50 BHCS Blk Zn	1
5	100659	M8 Nylock Nut Blk Zn	1
6	100658	M6 Nylock Nut Blk Zn	3
7	002595	Saddle, Dual, 1" OD X 1.5 SP	2
8	101811	M6 x 35 BHCS Blk Zn	2
9	100746	M6 Flat Washer Blk Zn	5
10	100558	M6 Nyl Ins Domed Cap L/N Zc	2
15a	002597	Tube, Upper Ht Adj Back R <i>Used on chairs that starting 12/18/23</i>	1
15b	002598	Tube, Upper Ht Adj Back L <i>Used on chairs that starting 12/18/23</i>	1
16	116066	Locking Hinge Assembly <i>Used on chairs that starting 12/18/23</i>	1
17c	001088	Tube, Push Handle, Right Tilt <i>Used on chairs that invoiced after 12/18. Used on 14" - 18" wide with serial numbers prior to FLP010784 and serial numbers starting with FLP011080</i>	1
17d	001089	Tube, Push Handle, Left Tilt <i>Used on chairs that invoiced after 12/18. Used on 14" - 18" wide with serial numbers prior to FLP010784 and serial numbers starting with FLP011081</i>	1
19a	002032	Growth Strut, Stroller, 10-12 <i>Used on 10" chair width</i>	1
19b	002033	Growth Strut, Stroller, 11-13 <i>Used on 11" - 13" chair widths</i>	1
19c	002578	Growth Strut, Stroller, Short <i>Used on 14" - 18" chair widths</i>	1
21	100669	M5 x 10 BTN SHCS BLKZC w/Patch <i>Used on chairs that starting 12/18/23</i>	4
22	101843	M5 x 20 SHCS Blk Zn	5

Item Number	Part Number	Description	Quantity
23	001083	Bushing Height Adjustable Back Tilt	1
25	001243	Stroller Handle Adaptor	2
28	100533	Detent Button	2
29	000988	Fastener Retainer	1
30	000987	Threaded Fastener	1
31	200427	M5 x 10 CLS8.8 HHCS ZC w/Patch DIN933	1
32	110524	Locking Hinge Button Assembly with Instruction <i>This kit contains the contents inside callout # 16. This assembly may not be compatible if chair was invoiced prior to 6/22/16</i>	1