

# Little Wave XP Fixed Height Backrest with Adjustable Height Rigidizer Bar

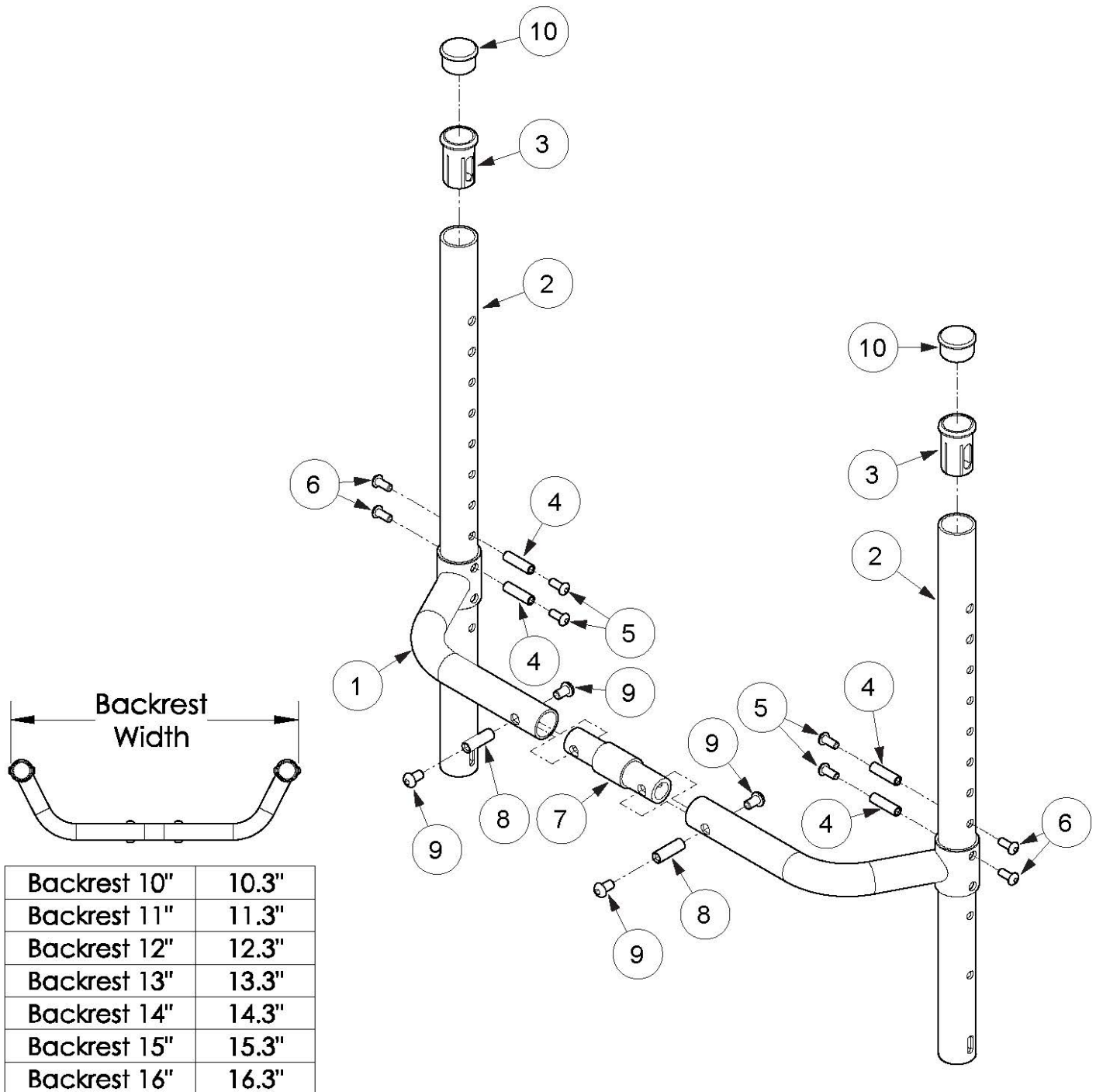

Adjustable Height Rigidizer Bar based on seat width

Item Number	Part Number	Description	Quantity	Retail
1a, 7a, 8, 9	109150	Adjustable Height Rigidizer Bar 10", 0" Connector and Hardware	1	\$130.28
1a, 7b, 8, 9	109151	Adjustable Height Rigidizer Bar 10", 1" Connector and Hardware	1	\$130.28
1a, 7c, 8, 9	109152	Adjustable Height Rigidizer Bar 10", 2" Connector and Hardware	1	\$130.28
1a, 7d, 8, 9	109153	Adjustable Height Rigidizer Bar 10", 3" Connector and Hardware	1	\$130.28
1b, 7a, 8, 9	109154	Adjustable Height Rigidizer Bar 11", 0" Connector and Hardware	1	\$130.28
1b, 7b, 8, 9	109155	Adjustable Height Rigidizer Bar 11", 1" Connector and Hardware	1	\$130.28
1b, 7c, 8, 9	109156	Adjustable Height Rigidizer Bar 11", 2" Connector and Hardware	1	\$130.28
1b, 7d, 8, 9	109157	Adjustable Height Rigidizer Bar 11", 3" Connector and Hardware	1	\$130.28
1c, 7a, 8, 9	109158	Adjustable Height Rigidizer Bar 12", 0" Connector and Hardware	1	\$130.28
1c, 7b, 8, 9	109159	Adjustable Height Rigidizer Bar 12", 1" Connector and Hardware	1	\$130.28
1c, 7c, 8, 9	109160	Adjustable Height Rigidizer Bar 12", 2" Connector and Hardware	1	\$130.28
1c, 7d, 8, 9	109161	Adjustable Height Rigidizer Bar 12", 3" Connector and Hardware	1	\$130.28
1d, 7a, 8, 9	109162	Adjustable Height Rigidizer Bar 13", 0" Connector and Hardware	1	\$130.28
1d, 7b, 8, 9	109163	Adjustable Height Rigidizer Bar 13", 1" Connector and Hardware	1	\$130.28
1d, 7c, 8, 9	109164	Adjustable Height Rigidizer Bar 13", 2" Connector and Hardware	1	\$130.28
1d, 7d, 8, 9	109165	Adjustable Height Rigidizer Bar 13", 3" Connector and Hardware	1	\$130.28
1e, 7a, 8, 9	109166	Adjustable Height Rigidizer Bar 14", 0" Connector and Hardware	1	\$130.28
1e, 7b, 8, 9	109167	Adjustable Height Rigidizer Bar 14", 1" Connector and Hardware	1	\$130.28
1e, 7c, 8, 9	109168	Adjustable Height Rigidizer Bar 14", 2" Connector and Hardware	1	\$130.28
1e, 7d, 8, 9	109169	Adjustable Height Rigidizer Bar 14", 3" Connector and Hardware	1	\$130.28
1f, 7a, 8, 9	109170	Adjustable Height Rigidizer Bar 15", 0" Connector and Hardware	1	\$130.28
1f, 7b, 8, 9	109171	Adjustable Height Rigidizer Bar 15", 1" Connector and Hardware	1	\$130.28
1f, 7c, 8, 9	109172	Adjustable Height Rigidizer Bar 15", 2" Connector and Hardware	1	\$130.28
1f, 7d, 8, 9	109173	Adjustable Height Rigidizer Bar 15", 3" Connector and Hardware	1	\$130.28
1g, 7a, 8, 9	109174	Adjustable Height Rigidizer Bar 16", 0" Connector and Hardware	1	\$130.28
1g, 7b, 8, 9	109175	Adjustable Height Rigidizer Bar 16", 1" Connector and Hardware	1	\$130.28
1g, 7c, 8, 9	109176	Adjustable Height Rigidizer Bar 16", 2" Connector and Hardware	1	\$130.28

Item Number	Part Number	Description	Quantity	Retail
1g, 7d, 8, 9	109177	Adjustable Height Rigidizer Bar 16", 3" Connector and Hardware	1	\$130.28
7b, 8, 9	502318	Backrest Connector Assembly 1" w/ Hardware, Rigid	1	\$47.61
7c, 8, 9	502319	Backrest Connector Assembly 2" w/ Hardware, Rigid	1	\$47.61
7d, 8, 9	502320	Backrest Connector Assembly 3" w/ Hardware, Rigid	1	\$47.61
2a	109096	Backrest Tube Fixed Height, 6.25" <i>Used with 12" back height with fold down push handles or 9" back height with standard or low profile push handles</i>	2	\$27.31
2b	109095	Backrest Tube Fixed Height, 7.25" <i>Used with 13" back height with fold down push handles or 10" back height with standard or low profile push handles</i>	2	\$27.31
2c	109094	Backrest Tube Fixed Height, 8.25" <i>Used with 9" back height with omit push handles, 14" back height with fold down push handles or 11" back height with standard or low profile push handles</i>	2	\$27.31
2d	109093	Backrest Tube Fixed Height, 9.25" <i>Used with 10" back height with omit push handles, 15" back height with fold down push handles or 12" back height with standard or low profile push handles</i>	2	\$27.31
2e	109092	Backrest Tube Fixed Height, 10.25" <i>Used with 11" back height with omit push handles, 16" back height with fold down push handles or 13" back height with standard or low profile push handles</i>	2	\$27.31
2f	109091	Backrest Tube Fixed Height, 11.25" <i>Used with 12" back height with omit push handles, 17" back height with fold down push handles or 14" back height with standard or low profile push handles</i>	2	\$27.31
2g	109090	Backrest Tube Fixed Height, 12.25" <i>Used with 13" back height with omit push handles, 18" back height with fold down push handles or 15" back height with standard or low profile push handles</i>	2	\$27.31
2h	109089	Backrest Tube Fixed Height, 13.25" <i>Used with 14" back height with omit push handles or 16" back height with standard or low profile push handles</i>	2	\$27.31
2i	109088	Backrest Tube Fixed Height, 14.25" <i>Used with 15" back height with omit push handles or 17" back height with standard or low profile push handles</i>	2	\$27.31
2j	109087	Backrest Tube Fixed Height, 15.25" <i>Used with 16" back height with omit push handles or 18" back height with standard or low profile push handles</i>	2	\$27.31
2k	109086	Backrest Tube Fixed Height, 16.25" <i>Used with 17" back height with omit push handles</i>	2	\$27.31
2l	000698	Backrest Tube Fixed Height, 17.25" <i>Used with 18" back height with omit push handles</i>	2	\$27.31

Item Number	Part Number	Description	Quantity	Retail
3	000034	Sleeve 3/4" x 1 1/2" <i>Used with standard push handles, low profile push handles or fold down push handles</i>	2	\$3.66
4	000073	M5 x 24 Threaded Barrel	4	\$3.78
5	100669	M5 x 10 BTN SHCS BLKZC w/Patch	4	\$1.58
6	103524	M5 x 10 BTN SHCS BLK ZN	4	\$0.53
7a	000589	Backrest Connector 0" LW/RG	1	\$33.05
7b	000590	Backrest Connector 1" LW/RG	1	\$33.05
7c	000591	Backrest Connector 2" LW/RG	1	\$33.05
7d	000592	Backrest Connector 3" LW/RG	1	\$33.05
8	000669	M6 x 20.5 Threaded Barrel	2	\$4.88
9	101184	M6 x 10 BTN SHCS BLKZC w/Patch	4	\$1.58
10	100804	Tube End Plug 1" <i>Used with omit push handles</i>	2	\$1.58