



SEDEO PRO RECLINING 2-POINT ARMREST INSTRUCTION SHEET



Please read these instructions carefully before beginning the installation. Failure to understand and follow installation instructions may result in injury to installer and/or end user and may void the warranty. If you have any questions call Sunrise Medical Technical support at 800-333-4000.

Armrest parts:

- | | | |
|------------------------------|----------------------------|-------------------------------|
| 1. 2 ea M6x1x45 screw (A) | 4. 1 ea Spacer (D) | 7. 2 ea Clamp Nut Profile (G) |
| 2. 2 ea bushings (B) | 5. 2 ea T-Nut M6 (E) | 8. 2 ea flat washers (H) |
| 3. 1 ea Armrest Receiver (C) | 6. 1 ea 2 PT Arm Assy. (F) | 9. 2 ea M6x1x10 screw (I) |

Tools needed for assembly:

1. 5mm hex key
2. Torque wrench
3. Std. Screwdriver

A. INSTALLATION

1. Start by flipping back each of the armrests (Fig. 1). Insert a 5mm hex key into the rear elbow of each armrest and turn the setscrew(J), counter clockwise until it comes completely out. Once both setscrews are removed, please save for possibly later use. The setscrews will not be reinstalled unless the two point arm mount feature is removed.
2. Once the screws are removed from both arms, flip the arms back down to their home position.
3. With a standard screwdriver, start by gently tapping out both seat rail caps from seat rails. Save caps for re-installation. (Fig. 2)
4. Take two T-Nuts (E) and insert them inside the front of the seat rail. (Fig. 2)

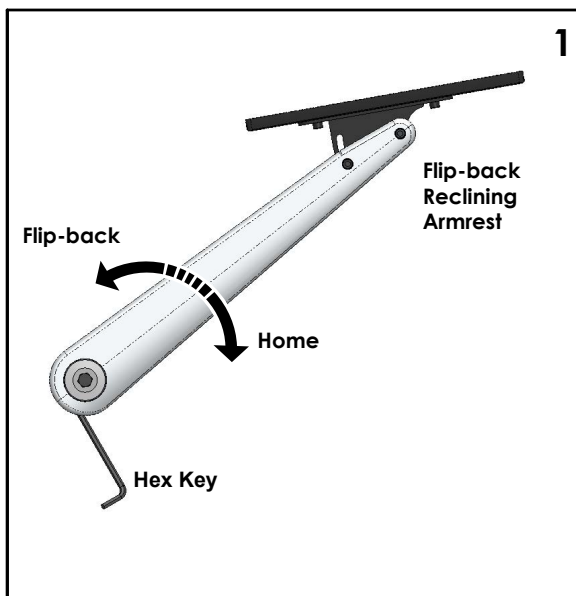

A. INSTALLATION(Continued):

5. Take two screws (A) and slide one bushing (B) on to each screw. (Fig. 2)
6. Now take the two screws (A) and bushings (B) and insert them into the armrest receiver (C). (Fig. 2)
7. With the two screws (A), protruding out of the back of the armrest receiver, slide the spacer (D) onto the screws (A). (Fig. 2)
8. There should now still be threads from screws (A), sticking outside the spacer (D). Line up and thread screws (A) into the two T-Nuts (E) that are sitting inside the seat rail.
9. With a 5mm hex key, tighten both screws (A). (Fig. 2) Torque both screws (A) to 60-70 in-lbs.
10. Now take both of the clamp nut profiles (G) and insert them into the channel of the armpad profile. (Fig. 3)
11. Take both screws (I) and put them through both flat washers (H). (Fig. 3)
12. Now take the combined screws (I) and flat washers (H) and run them through the top of the 2 PT Arm Assy bracket and then thread screws (I) into the clamp nut profiles (G), which are in the channel of the armpad profile. With a 5mm hex key snug down both screws (I) (Fig. 3).
13. Torque both screws (I) to 60-70 in-lbs.
14. Take the bottom of the 2 PT Arm Assy and insert it into the armrest receiver. Take the seat rail caps and gently tap them back onto seat rails.
15. Repeat all these steps for the armrest on the opposite side.

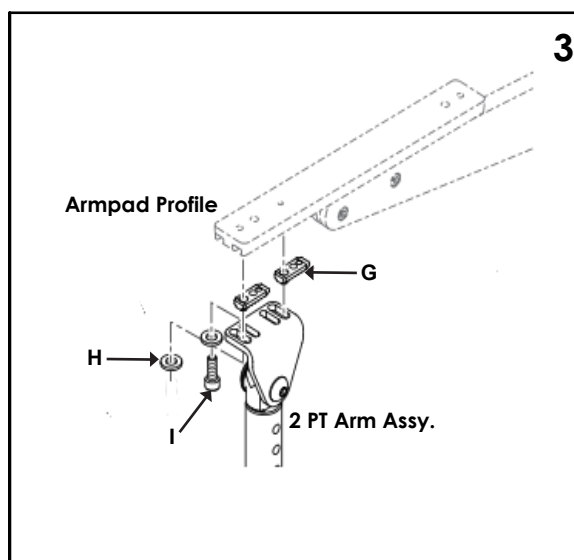
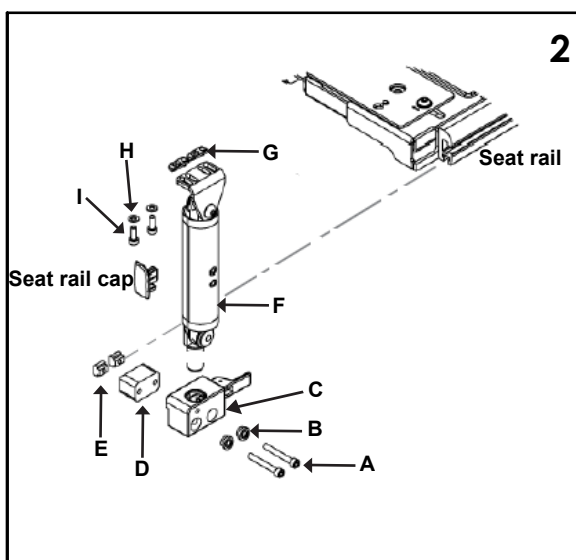

B. Removal:

1. Start by releasing both armrest receiver levers into the unlock position and then flip both armrests back.
2. With a standard screwdriver, gently tap both seat rail caps out from the seat rails. Save the caps for re-installation.(Fig. 2)
3. With a 5mm hex key, loosen all four screws(A), two per side that hold the armrest receivers to the seat rails. (Fig. 2)
4. Now completely remove all four of screws(A), along with the bushings, spacers and T-Nuts. Save all the parts if you plan to reuse them again, otherwise discard. (Fig. 2)
5. Re-install both seat rail caps into the seat rails by gently tapping them back into place.
6. With both the main armrests still in the flipped back position, take a 5mm hex key and completely remove all four screws (I), two per side. (Fig. 3)
7. Along with all four screws (I), washers (H), clamp nut profiles (G) and 2 PT Arm Assemblies, completely remove from the Armpad profiles. Save all of the parts if you plan to reuse them, otherwise discard. (Fig.2 & 3)
8. With a 5mm hex key, re-install saved setscrews (J), back into the rear elbow of the armrests. Thread the setscrews back in about three quarters of the way in and then drop both armrests back down to their home position. (Fig. 4)
9. With the 5mm hex key, adjust each armrest to their desired height. (Fig. 1)

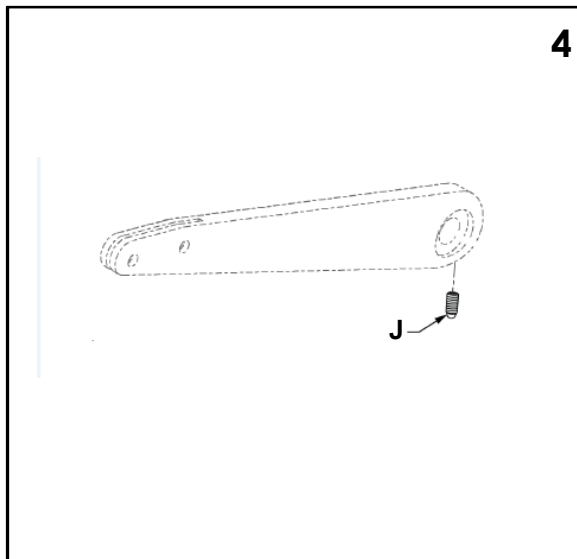

Sunrise Medical 2842 Business Park Ave Fresno, CA 93727 USA In
Canada (800) 263-3390