

# Rogue2 Side Guard Receiver

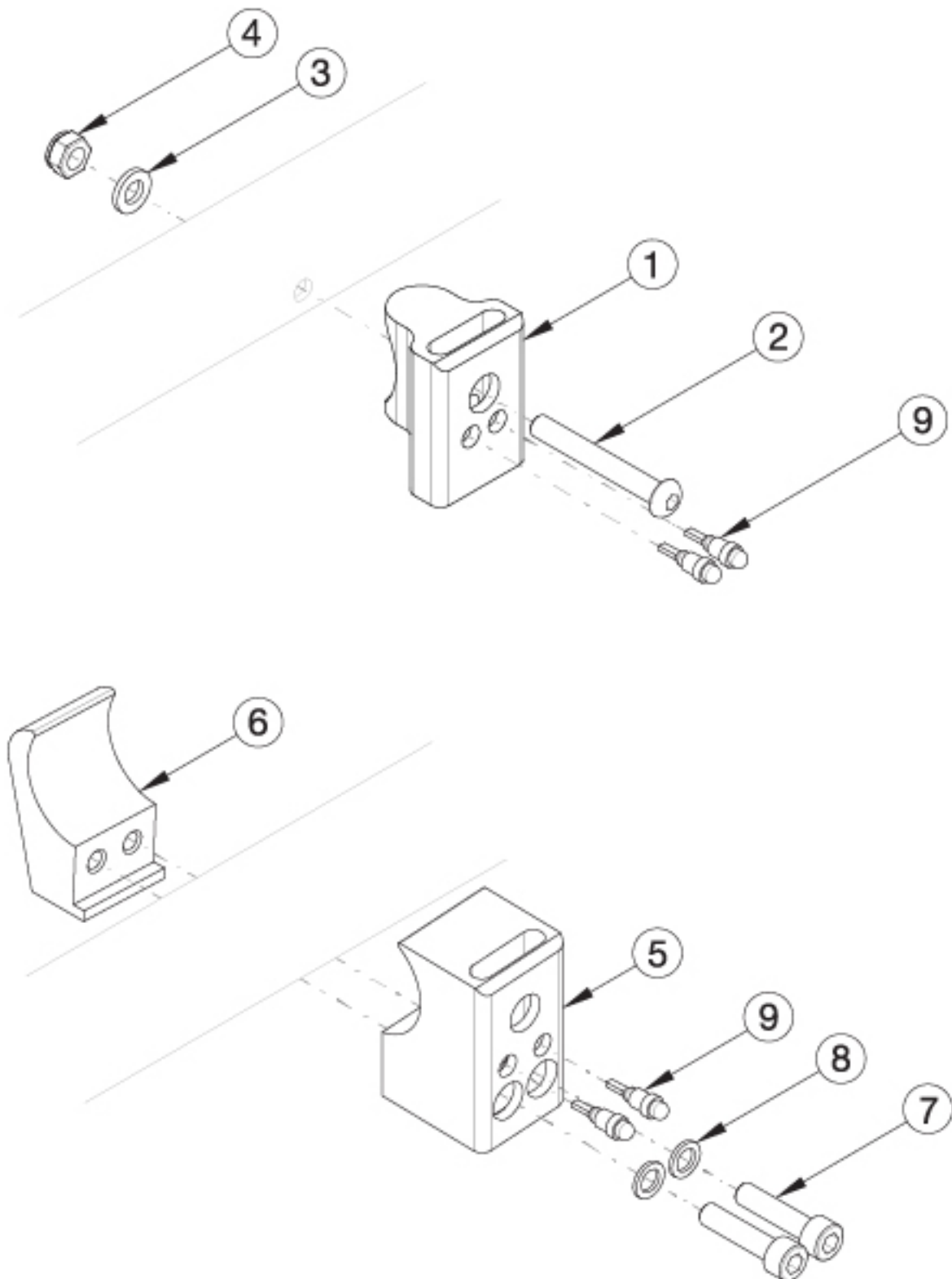

*If retrofitting side guards, clamp on receiver is required*

| Item Number | Part Number | Description  | Quantity |
|-------------|-------------|--|----------|
| 1 - 4, 9    | 503141      | Wide Side Guard Direct Mount Receiver Assembly Black Anodized Rigid          | 1        |
| 7 - 9       | 501330      | Wide Side Guard Clamp Mount Receiver Assembly Black Anodized Rigid           | 1        |
| 1, 9        | 112060      | Wide Side Guard Direct Mount Receiver 1-3/8" w/ Chamfer Black Anodized Rigid | 1        |
| 1, 5        | 112061      | Wide Side Guard Clamp Mount Receiver 1-3/8" w/ Chamfer Black Anodized Rigid  | 1        |
| 2           | 101781      | M6 x 50mm Partial Thread BHCS Blk ZC   | 1        |
| 3           | 100746      | M6 Flat Washer Blk Zn  | 1        |
| 4           | 100658      | M6 Nylock Nut Blk Zn   | 1        |
| 5           | 004443      | Wide Side Guard Clamp Receiver 1-3/8" w/ Chamfer Black Anodized Rigid        | 1        |
| 6           | 000554      | Side Guard Clamp Mount Rigid   | 1        |
| 7           | 101810      | M6 x 35 SHCS BLK ZC  | 2        |
| 8           | 102326      | Flat Washer ID .254" x OD .396" Thickness .047" Zinc                         | 2        |
| 9           | 001788      | Button Assembly  | 1        |