

# Catalyst Reclining Backrest

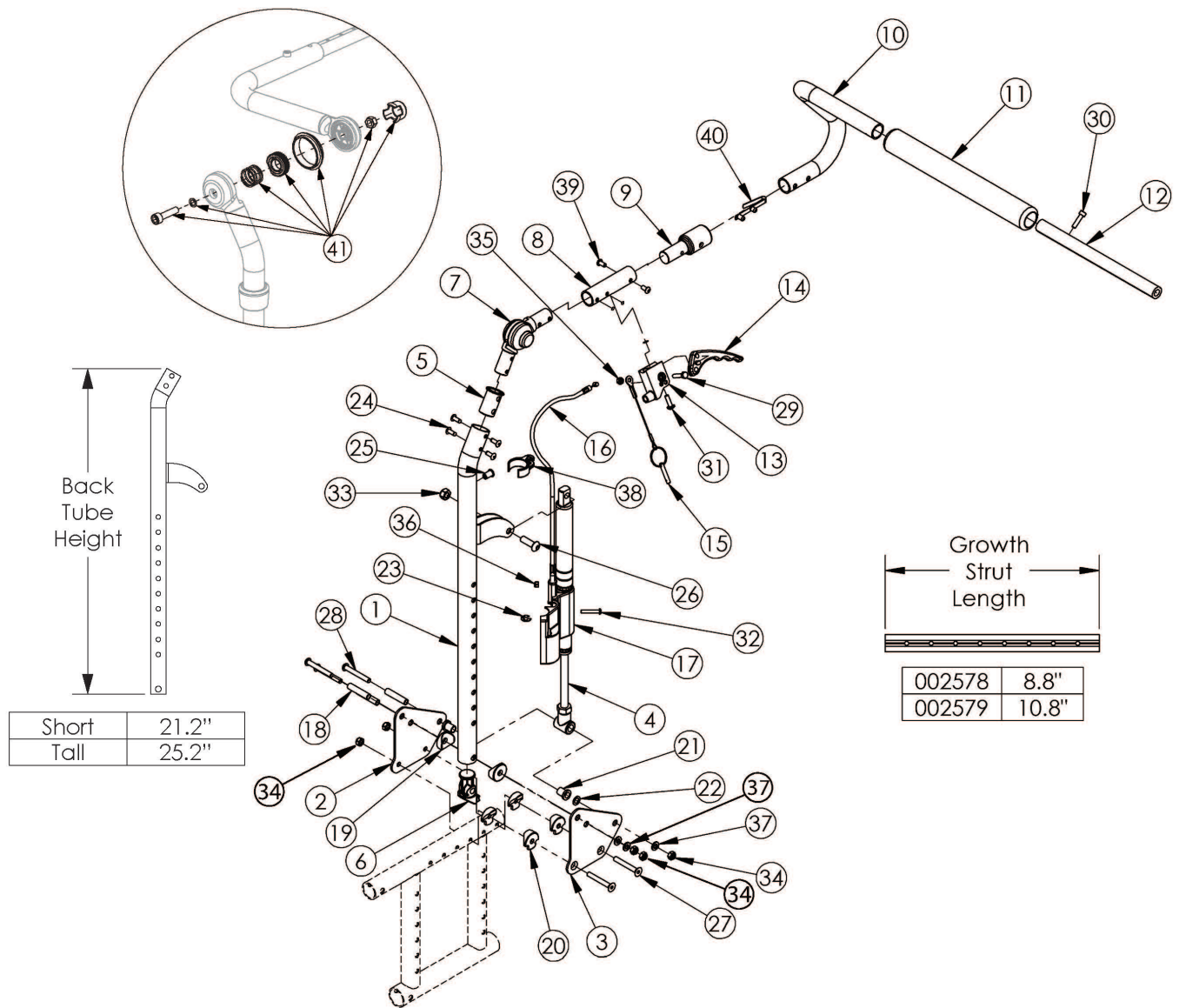

If chair was invoiced prior to 12/18/23, an upper back tube assembly is required. If chair was invoiced after to 12/18/23, parts 1, 5, 7, 8 and 25 shown in the diagram above can now be purchased individually. If retrofitting, new rear frames, amputee axle plates, and anti-tip spacers are required. New sized anti-tips may be required. Not available with Transit Option or Heavy Duty option. If Anti-Rollback is present, see Back Tubes for Anti-Rollback System

Item Number	Part Number	Description	Quantity
1a, 2, 3a, 3b, 4a, 4b, 5-7, 8a, 8b, 9, 10a, 10b, 11, 12a, 13-15, 16a, 17a, 17b, 18-40	503333	Recline Back Kit, Short Height, 14-17" Width, Standard Gas Spring PAIR, Catalyst  <i>Contains parts for complete retrofit</i>	1

Item Number	Part Number	Description	Quantity
1a, 2, 3a, 3b, 4a, 4b, 5-7, 8a, 8b, 9, 10a, 10b, 11, 12b, 13-15, 16a, 17a, 17b, 18- 40	503334	Recline Back Kit, Short Height, 18-22" Width, Standard Gas Spring PAIR, Catalyst  <i>Contains parts for complete retrofit</i>	1
1b, 2, 3a, 3b, 4a, 4b, 5-7, 8a, 8b, 9, 10a, 10b, 11, 12a, 13-15, 16b, 17a, 17b, 18- 40	503335	Recline Back Kit, Tall Height, 14-17" Width, Standard Gas Spring PAIR, Catalyst  <i>Contains parts for complete retrofit</i>	1
1b, 2, 3a, 3b, 4a, 4b, 5-7, 8a, 8b, 9, 10a, 10b, 11, 12b, 13-15, 16b, 17a, 17b, 18- 40	503336	Recline Back Kit, Tall Height, 18-22" Width, Standard Gas Spring PAIR, Catalyst  <i>Contains parts for complete retrofit</i>	1
1a, 2, 3a, 3b, 4c, 4d, 5-7, 8a, 8b, 9, 10a, 10b, 11, 12a, 13-15, 16a, 17a, 17b, 18- 40	503337	Recline Back Kit, Short Height, 14-17" Width, Heavy Duty Gas Spring PAIR, Catalyst  <i>Contains parts for complete retrofit</i>	1
1a, 2, 3a, 3b, 4c, 4d, 5-7, 8a, 8b, 9, 10a, 10b, 11, 12b, 13-15, 16a, 17a, 17b, 18- 40	503338	Recline Back Kit, Short Height, 18-22" Width, Heavy Duty Gas Spring PAIR, Catalyst  <i>Contains parts for complete retrofit</i>	1
1b, 2, 3a, 3b, 4c, 4d, 5-7, 8a, 8b, 9, 10a, 10b, 11, 12a, 13-15, 16b, 17a, 17b, 18- 40	503339	Recline Back Kit, Tall Height, 14-17" Width, Heavy Duty Gas Spring PAIR, Catalyst  <i>Contains parts for complete retrofit</i>	1
1b, 2, 3a, 3b, 4c, 4d, 5-7, 8a, 8b, 9, 10a, 10b, 11, 12b, 13-15, 16b, 17a, 17b, 18- 40	503340	Recline Back Kit, Tall Height, 18-22" Width, Heavy Duty Gas Spring PAIR, Catalyst  <i>Contains parts for complete retrofit</i>	1
1a, 5, 7, 8b, 9, 10a, 11, 24, 25, 39, 40	503327	Recline Back Tube Subassembly, Short 22", Right, Catalyst	1

Item Number	Part Number	Description	Quantity
1a, 5, 7, 8a, 9, 10b, 11, 24, 25, 39, 40	503328	Recline Back Tube Subassembly, Short 22", Left, Catalyst	1
1b, 5, 7, 8b, 9, 10a, 11, 24, 25, 39, 40	503329	Recline Back Tube Subassembly, Tall 26", Right, Catalyst	1
1b, 5, 7, 8a, 9, 10b, 11, 24, 25, 39, 40	503330	Recline Back Tube Subassembly, Tall 26", Left, Catalyst	1
9, 10a, 10b, 11, 12a, 30, 39, 40	503331	Recline Removable Stroller Handle Assembly 14 - 17W Catalyst <i>Kit includes parts for both sides</i>	1
9, 10a, 10b, 11, 12b, 30, 39, 40	503332	Recline Removable Stroller Handle Assembly 18 - 22W Catalyst <i>Kit includes parts for both sides</i>	1
1a, 25	122738	Back Tube Weld Recline Short <i>Used on chairs starting 12/18</i>	1
1b, 25	122739	Back Tube Weld Recline Tall <i>Used on chairs starting 12/18</i>	1
2	003217	Backplate, Catalyst Recline, Outside	1
3a	003218	Backplate, Catalyst Recline, Inside Left	1
3b	003219	Backplate, Catalyst Recline, Inside Right	1
4a	001264	Gas Spring Lock 92mm 20kg, Left (Standard Weight Capacity)	1
4b	001265	Gas Spring Lock 92mm 20kg, Right (Standard Weight Capacity)	1
4c	001375	Gas Spring Lock 92mm 40kg, Left (Heavy Duty)	1
4d	001376	Gas Spring Lock 92mm 40kg, Right (Heavy Duty)	1
5	001266	Bushing .832 OD x .720 ID <i>Used on chairs starting 12/18/23</i>	1
6	001267	Plug, Back Tube, Lower, Recline	1
7	116066	Locking Hinge Assembly <i>Used on chairs starting 12/18/23</i>	1
8a	003220	Mounting Tube, Recline, Stroller Left <i>Used on chairs starting 12/18/23</i>	1
8b	003221	Mounting Tube, Recline, Stroller Right <i>Used on chairs starting 12/18/23</i>	1
9	003222	Recline Stroller Handle Adaptor	1
10a, 11	501090	Stroller Handle with Foam Grip, Right	1

Item Number	Part Number	Description	Quantity
10b, 11	501091	Stroller Handle with Foam Grip, Left	1
12a	002578	Growth Strut, Stroller, Short <i>Used on chair widths 14 - 17</i>	1
12b	002579	Growth Strut, Stroller, Long <i>Used on chair widths 18 - 22</i>	1
13	003638	Trigger Mount, No Lockout	1
14	001123	Trigger Horizontal	1
15	001124	Pin with Lanyard	1
16a	001268	Cable, Recline, Short	1
16b	001269	Cable, Recline, Long	1
17a	001298	Cover, Gas Spring, Left	1
17b	001299	Cover, Gas Spring, Right	1
18	003223	Recline Backplate Stop Pin	3
19	001271	1" Saddle, .323 Hole	2
20	000612	1" Half Saddle Washer	4
21	102081	Bushing Flange .319 IDx.394 OD	2
22	101861	Nylon Washer 5/16 x 1/2 x .03	2
23	101076	1/4" E Ring	1
24	102799	M5 x 12, BHCS, BZ w/Patch <i>Used on chairs starting 12/18/23</i>	6
26	101814	M8 x 25 BHCS Blk Zn	1
27	101592	M6 x 45 CLS10.9 DIN7991 FHCS BLKZC	2
28	100670	M6 x 45 BTN SHCS BLK ZC	3
29	101820	M5 x 22 HHCS Blk Zn	1
30	101843	M5 x 20 SHCS Blk Zn	1
31	100734	M5 x 16 PHMS ZC	1
32	102328	M4 x 25 Pan Head Phil Blk Zn	1
33	100659	M8 Nylock Nut Blk Zn	1
34	100658	M6 Nylock Nut Blk Zn	5

Item Number	Part Number	Description	Quantity
35	100657	M5 Nylock Nut Blk Zn	1
36	102329	M4 Nylock Nut Blk Zn	1
37	100746	M6 Flat Washer Blk Zn	3
38	001117	Cable Clip 1"	1
39	100669	M5 x 10 BTN SHCS BLKZC w/Patch	2
40	100533	Detent Button	1
41	110524	Locking Hinge Button Assembly with Instruction <i>This kit contains the contents inside callout # 7. This assembly may not be compatible if chair was invoiced prior to 6/22/16</i>	1