

# Arc Plastic Coated Handrim

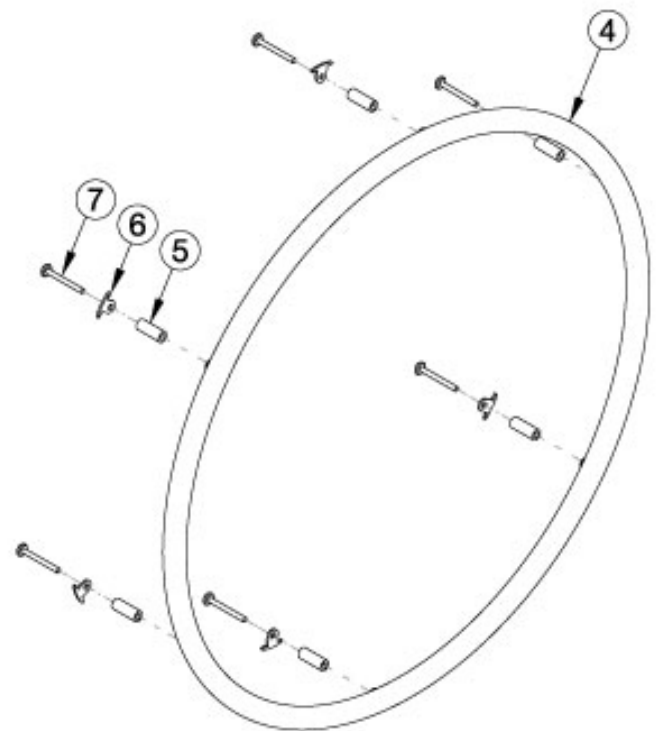
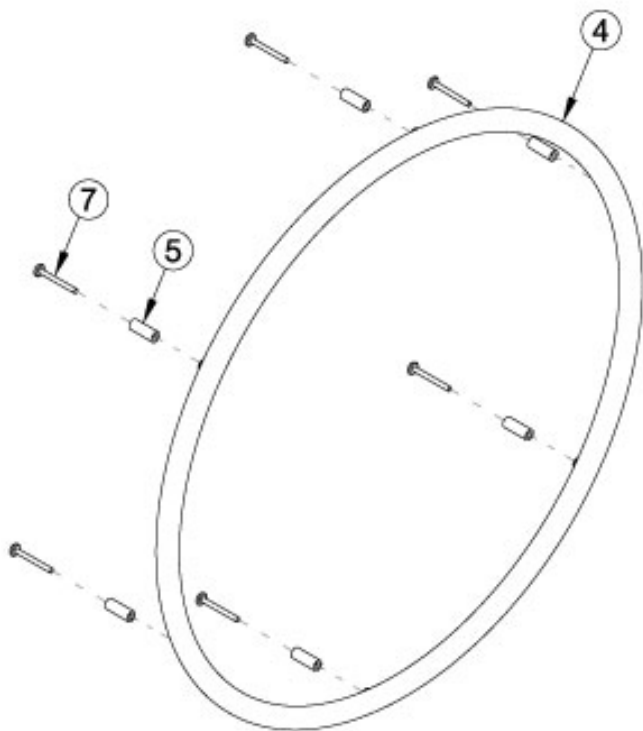
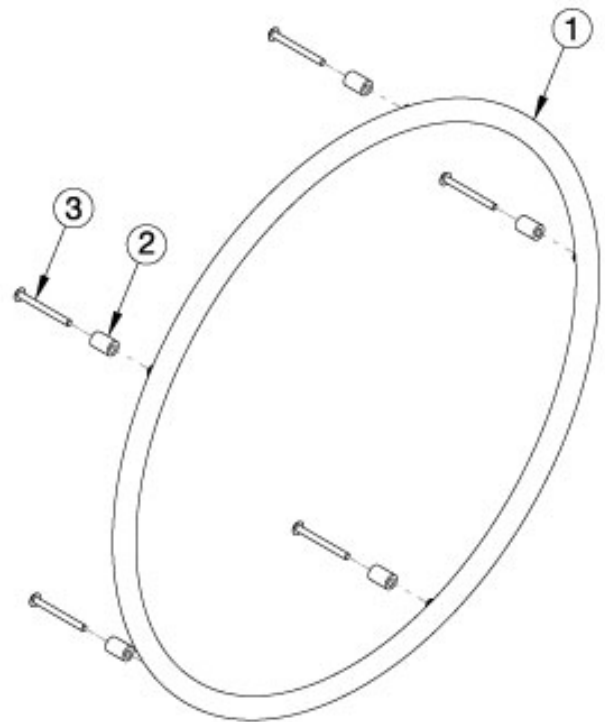

For more information see Handrim Hardware Chart. Quantity in Handrim Hardware Kits are for one wheel.

Item Number	Part Number	Description	Quantity
5a, 6, 7a	502168	Handrim Hardware Kit, 6 Rivet Nut, EACH	1

Item Number	Part Number	Description	Quantity
		<i>Used with Ki Spoke and MAXX Spoke wheels with standard handrim mount option</i>	
5b, 6, 7b	113069	Handrim Hardware Kit, Close Mount, 6 Rivet Nut, EACH <i>Used with Ki Spoke and MAXX Spoke wheels with close mount handrim mount option</i>	1
5c, 7c	117377	Handrim Hardware Kit, Standard Mount, MAXX Mag, EACH <i>Used with MAXX Mag wheels with standard handrim mount option</i>	1
5b, 7a	117378	Handrim Hardware Kit, Close Mount, MAXX Mag, EACH <i>Used with MAXX Mag wheels with close mount handrim mount option</i>	1
4	112819	Handrim Plastic Coated 6 Rivet Nut 20" <i>Used on 20" Ki Spoke, 20" MAXX Spoke, and 20" MAXX Mag wheels. Replaced 200542.</i>	1
2a, 3a	502173	Handrim Hardware Kit, 5 Rivet Nut, Plastic Coated, EACH <i>Used with X Core Mag wheels with standard handrim mount option</i>	1
2b, 3b	113070	Handrim Hardware Kit, Close Mount, 5 Rivet Nut, EACH <i>Used with X Core Mag wheels with close mount handrim mount option</i>	1
1	101963	Handrim Plastic Coated 5 Rivet Nut 20" <i>Used on 20" 5-Spoke X Core Mag wheels</i>	1
2a	101756	Handrim Spacer Plastic Coated Rivet <i>Used with X Core Mag with standard handrim mount option</i>	5
3a	100724	M5 x 55 PH TRS HD M/S ZC <i>Used with X Core Mag with standard handrim mount option</i>	5
5a	100653	Handrim Spacer Spoke <i>Used with Ki Spoke and MAXX Spoke with standard handrim mount option</i>	6
5c	100629	Handrim Spacer Alum Ano Riv <i>Used with MAXX Mag wheels with standard handrim mount option</i>	6
6	100698	Handrim Tab <i>Used with Ki Spoke and MAXX Spoke wheels</i>	6
7a	100654	M5 x 40 DIN7985 PH Pan HD M/S ZC <i>Used with Ki Spoke and MAXX Spoke with standard handrim mount option</i>	6
7c	103545	M5 x 50 DIN7985 PH PAN HD M/S BLK ZC <i>Used with MAXX Mag wheels with standard handrim mount option</i>	6

Handrim Hardware Chart													
Wheel		Handrim Connection				Handrim							
Wheel	Wheel Part No.	Connection Points	Tab	Spacer*	Screw*	Aluminum Anodized	Superlight	Plastic Coated	Projection	Natural Fit Standard	Natural Fit LT	Flex Rim	
18" MAXX Spoke	109285	3	100698 (Not used w/ Superlight Handrim)	100653 (Not used w/ Superlight Handrim)	Aluminum, Plastic Ctd, Projection: 100654	100206		101106					
20" MAXX Spoke	108244	6			Natural Fit: 100835	200536		200542					
22" MAXX Spoke	105135				Superlight: 100669	100560		100576	100569	200538	200201		
24" MAXX Spoke	105136				Nut: 100657	200349	101161	100577	200547	100793	200202		
25" MAXX Spoke	107436					200350		101870	200548	200539	200540		
26" MAXX Spoke	107437					200351		100578	200549	100907	101454		
20" MAXX Mag	111853		6		100629	Aluminum, Plastic Ctd, Projection: 103545	200536		112819				
22" MAXX Mag	111854	Natural Fit: 101893				100560		112820	112824	200538	200201		
24" MAXX Mag	111855	105137					112821	112825	100793	200202			
24" Superlight	101159	6			100536	100754	101161	100836		100830	100828		
25" Superlight	101160						101160	101091		101464	101460		
20" Spinergy Spox	See Spinergy Spox Page	6			Screw: 100669 Nut: 100657	103125		103179					
22" Spinergy Spox						100827		100808		100889	100888		
24" Spinergy Spox						100766	101161	100615		100830	100828		
25" Spinergy Spox						100767	101160	100765		101464	101460		
26" Spinergy Spox						101477		101148		200200	100950		
22" Spinergy LX	See Spinergy LX Page	6			Screw: 100669 Nut: 100657	100827		100808		100889	100888		
24" Spinergy LX						100766	101161	100615		100830	100828	See Spinergy LX Page	
25" Spinergy LX						100767	101160	100765		101464	101460		
26" Spinergy LX						101477		101148		200200	100950		

\* Spacer and screw part numbers listed in the chart are for standard handrim mounting. If using close mount handrim mounting on aluminum anodized, plastic coated or projection handrims, use part number 100792 for the spacer, part number 102616 for the screw on Ki Spoke and MAXX Spoke wheels, part number 100666 for the screw on 5-Spoke X Core wheels, or part number 100654 for the screw on MAXX Mag wheels.

See Page 2 for Discontinued Wheels.

Effective 9/6/2022

### Handrim Hardware Chart (Discontinued Wheels)

Wheel		Handrim Connection				Handrim							
Wheel	Wheel Part No.	Connection Points	Tab	Spacer*	Screw*	Aluminum Anodized	Superlight	Plastic Coated	Projection	Natural Fit Standard	Natural Fit LT	Flex Rim	
18" Ki Spoke	200529	3	100698	100653	Aluminum, Plastic Ctd, Projection: 100654	100206		101106					
20" Ki Spoke	200530	6				200536		200542					
22" Ki Spoke	200531					100560		100576	100569	200538	200201		
24" Ki Spoke	200532					200349		100577	200547	100793	200202		
25" Ki Spoke	200533				Natural Fit: 100835	200350		101870	200548	200539	200540		
26" Ki Spoke	200534					200351		100578	200549	100907	101454		
20" 5-Spoke X Core	101961		5		Aluminum, Projection, Natural Fit: 100629	100724	101897		101963				
22" 5-Spoke X Core	101962			101898				101964					
24" 5-Spoke X Core	100960			100975				100976	200546				
24" 5-Spoke X Core	100960			Plastic Ctd: 101756	101893				100768	100769			

\* Spacer and screw part numbers listed in the chart are for standard handrim mounting. If using close mount handrim mounting on aluminum anodized, plastic coated or projection handrims, use part number 100792 for the spacer, part number 102616 for the screw on Ki Spoke and MAXX Spoke wheels, part number 100666 for the screw on 5-Spoke X Core wheels, or part number 100654 for the screw on MAXX Mag wheels.