

## Focus CR Drum Brake (Hand Tilt)

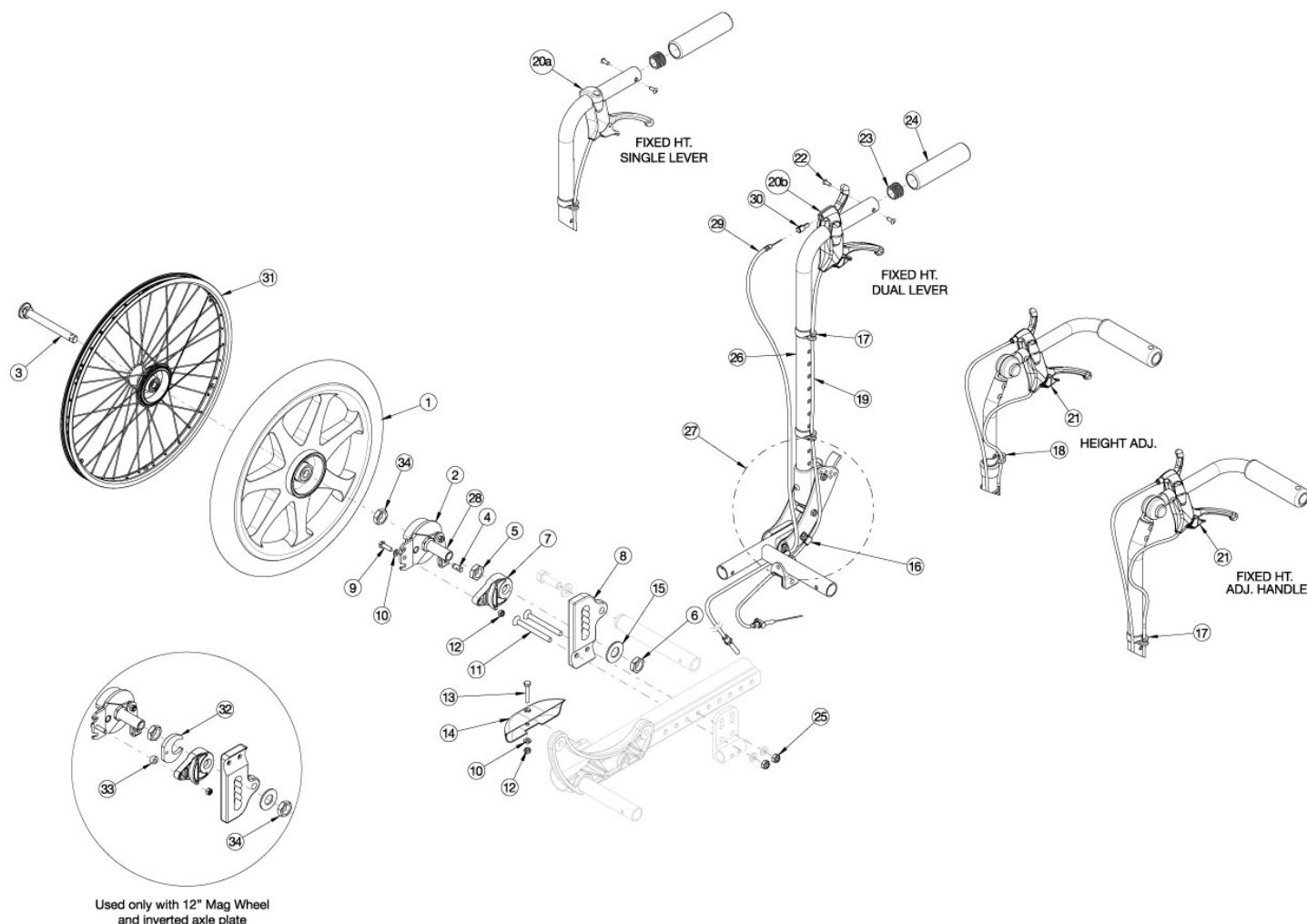

For complete retrofit, quote drum brake retro kit and cable kit. Must also quote rear tires and handrims if quoting 24" MAXX Spoke wheels. If retrofitting and chair was invoiced prior to October 11th, 2019, with stroller handle back posts present, new stroller handle back post assemblies are required. If changing wheel type and the drum brake is already present, the drum brake rotor kit with hardware is required.

| Item Number  | Part Number | Description   | Quantity |
|--|-------------|---|----------|
| 1a, 2a, 2b, 3a, 4-8, 9a, 9b, 10-12, 15, 25, 28a, 32-34 | 113355      | Drum Brake Retro Kit, 12" Mag w/Pneumatic Tire, PAIR, TILT  | 1        |
| 1b, 2a, 2b, 3a, 4-8, 9a, 9b, 10-12, 15, 25, 28a, 32-34 | 113356      | Drum Brake Retro Kit, 12" Mag w/ Full Poly Tire, PAIR, TILT | 1        |
| 1c, 2a, 2b, 3a, 4-12, 15, 25, 28a                      | 502692      | Drum Brake Retro Kit, 16" Mag w/ Pneumatic Tire, PAIR, TILT | 1        |
| 1d, 2a, 2b, 3a, 4-12, 15, 25, 28a                      | 502694      | Drum Brake Retro Kit, 16" Mag w/ Full Poly Tire, PAIR, TILT | 1        |

| Item Number                                    | Part Number | Description   | Quantity |
|--|-------------|---|----------|
| 1e, 2a, 2b, 3a, 4-12, 15, 25, 28a              | 502693      | Drum Brake Retro Kit, 16" Mag w/ Airless Insert Tire, PAIR, TILT  | 1        |
| 2a, 2b, 3b, 4-12, 15, 25, 28b, 31              | 113357      | Drum Brake Retro Kit, 24" MAXX Spoke, PAIR, TILT<br><i>This retrofit kit does not contain rear tires or handrims</i>            | 1        |
| 2a, 2b, 3b, 4-12, 15, 25, 28b, 31              | 118245      | Drum Brake Retro Kit, 24" MAXX Spoke, Pneumatic w/ Airless Insert Tire (Black), PAIR, TILT<br><i>Replaced kit number 116575</i> | 1        |
| 12, 16, 17, 19a, 20a, 20b, 22-24, 26a, 29a, 30 | 114087      | Cable Kit, Drum Brake w/Right Hand Tilt, Stroller Handle Back Post Short, Std Axle Plate  | 1        |
| 12, 16, 17, 19b, 20a, 20b, 22-24, 26b, 29b, 30 | 114088      | Cable Kit, Drum Brake w/Right Hand Tilt, Stroller Handle Back Post Tall, Std Axle Plate   | 1        |
| 12, 16, 17, 19b, 20a, 20b, 22-24, 26a, 29a, 30 | 114089      | Cable Kit, Drum Brake w/Right Hand Tilt, Stroller Handle Back Post Short, Inv Axle Plate  | 1        |
| 12, 16, 17, 19c, 20a, 20b, 22-24, 26b, 29b, 30 | 114090      | Cable Kit, Drum Brake w/Right Hand Tilt, Stroller Handle Back Post Tall, Inv Axle Plate   | 1        |
| 12, 16, 17, 19a, 20a, 20b, 22-27, 29a, 30      | 114091      | Cable Kit w/ Folding Hardware, Drum Brake w/Right Hand Tilt, Stroller Handle Back Post Short, Std Axle Plate                    | 1        |
| 12, 16, 17, 19b, 20a, 20b, 22-27, 29b, 30      | 114092      | Cable Kit w/ Folding Hardware, Drum Brake w/Right Hand Tilt, Stroller Handle Back Post Tall, Std Axle Plate                     | 1        |
| 12, 16, 17, 19b, 20a, 20b, 22-27, 29a, 30      | 114093      | Cable Kit w/ Folding Hardware, Drum Brake w/Right Hand Tilt, Stroller Handle Back Post Short, Inv Axle Plate                    | 1        |
| 12, 16, 17, 19c, 20a, 20b, 22-27, 29b, 30      | 114094      | Cable Kit w/ Folding Hardware, Drum Brake w/Right Hand Tilt, Stroller Handle Back Post Tall, Inv Axle Plate                     | 1        |
| 16-18, 19c, 21a, 21b, 29b, 30                  | 114095      | Cable Kit, Drum Brake w/Right Hand Tilt, Ht Adj Back Post Short, Back Height 18-21", Std Axle Plate                             | 1        |
| 16-18, 19c, 21a, 21b, 29c, 30                  | 114096      | Cable Kit, Drum Brake w/Right Hand Tilt, Ht Adj Back Post Short, Back Height 22-25", Std Axle Plate                             | 1        |
| 16-18, 19d, 21a, 21b, 29c, 30                  | 114097      | Cable Kit, Drum Brake w/Right Hand Tilt, Ht Adj Back Post Tall, Back Height 20-25", Std Axle Plate                              | 1        |
| 16-18, 19d, 21a, 21b, 29d, 30                  | 114098      | Cable Kit, Drum Brake w/Right Hand Tilt, Ht Adj Back Post Tall, Back Height 26-27", Std Axle Plate                              | 1        |
| 16-18, 19d, 21a, 21b, 29b, 30                  | 114099      | Cable Kit, Drum Brake w/Right Hand Tilt, Ht Adj Back Post Short, Back Height 18-21", Inv Axle Plate                             | 1        |
| 16-18, 19d, 21a, 21b, 29c, 30                  | 114100      | Cable Kit, Drum Brake w/Right Hand Tilt, Ht Adj Back Post Short, Back Height 22-25", Inv Axle Plate                             | 1        |

| Item Number  | Part Number | Description   | Quantity |
|--|-------------|---|----------|
| 16-18, 19e,<br>21a, 21b, 29c,<br>30                      | 114101      | Cable Kit, Drum Brake w/Right Hand Tilt, Ht Adj Back Post Tall, Back Height 20-25", Inv Axle Plate          | 1        |
| 16-18, 19e,<br>21a, 21b, 29d,<br>30                      | 114102      | Cable Kit, Drum Brake w/Right Hand Tilt, Ht Adj Back Post Tall, Back Height 26-27", Inv Axle Plate          | 1        |
| 16, 17, 19c,<br>21a, 21b, 29c,<br>30                     | 114103      | Cable Kit, Drum Brake w/Right Hand Tilt, Fixed Height with Adj Handle Back Post Short, Std Axle Plate       | 1        |
| 16, 17, 19d,<br>21a, 21b, 29d,<br>30                     | 114104      | Cable Kit, Drum Brake w/Right Hand Tilt, Fixed Height with Adj Handle Back Post Tall, Std Axle Plate        | 1        |
| 16, 17, 19d,<br>21a, 21b, 29c,<br>30                     | 114105      | Cable Kit, Drum Brake w/Right Hand Tilt, Fixed Height with Adj Handle Back Post Short, Inv Axle Plate       | 1        |
| 16, 17, 19e,<br>21a, 21b, 29d,<br>30                     | 114106      | Cable Kit, Drum Brake w/Right Hand Tilt, Fixed Height with Adj Handle Back Post Tall, Inv Axle Plate        | 1        |
| 12, 16, 17,<br>19a, 20a, 20b,<br>22-24, 26a,<br>29a, 30  | 114107      | Cable Kit, Drum Brake w/Left Hand Tilt, Stroller Handle Back Post Short, Std Axle Plate                     | 1        |
| 12, 16, 17,<br>19b, 20a, 20b,<br>22-24, 26b,<br>29b, 30  | 114108      | Cable Kit, Drum Brake w/Left Hand Tilt, Stroller Handle Back Post Tall, Std Axle Plate                      | 1        |
| 12, 16, 17,<br>19b, 20a, 20b,<br>22-24, 26a,<br>29a, 30  | 114109      | Cable Kit, Drum Brake w/Left Hand Tilt, Stroller Handle Back Post Short, Inv Axle Plate                     | 1        |
| 12, 16, 17, 19c,<br>20a, 20b, 22-<br>24, 26b, 29b,<br>30 | 114110      | Cable Kit, Drum Brake w/Left Hand Tilt, Stroller Handle Back Post Tall, Inv Axle Plate                      | 1        |
| 12, 16, 17,<br>19a, 20a, 20b,<br>22-27, 29a, 30          | 114111      | Cable Kit w/ Folding Hardware, Drum Brake w/Left Hand Tilt, Stroller Handle Back Post Short, Std Axle Plate | 1        |
| 12, 16, 17,<br>19b, 20a, 20b,<br>22-27, 29b, 30          | 114112      | Cable Kit w/ Folding Hardware, Drum Brake w/Left Hand Tilt, Stroller Handle Back Post Tall, Std Axle Plate  | 1        |
| 12, 16, 17,<br>19b, 20a, 20b,<br>22-27, 29a, 30          | 114113      | Cable Kit w/ Folding Hardware, Drum Brake w/Left Hand Tilt, Stroller Handle Back Post Short, Inv Axle Plate | 1        |
| 12, 16, 17, 19c,<br>20a, 20b, 22-<br>27, 29b, 30         | 114114      | Cable Kit w/ Folding Hardware, Drum Brake w/Left Hand Tilt, Stroller Handle Back Post Tall, Inv Axle Plate  | 1        |
| 16-18, 19c,<br>21a, 21b, 29b,<br>30                      | 114115      | Cable Kit, Drum Brake w/Left Hand Tilt, Ht Adj Back Post Short, Back Height 18-21", Std Axle Plate          | 1        |
| 16-18, 19c,<br>21a, 21b, 29c,<br>30                      | 114116      | Cable Kit, Drum Brake w/Left Hand Tilt, Ht Adj Back Post Short, Back Height 22-25", Std Axle Plate          | 1        |
| 16-18, 19d,<br>21a, 21b, 29c,<br>30                      | 114117      | Cable Kit, Drum Brake w/Left Hand Tilt, Ht Adj Back Post Tall, Back Height 20-25", Std Axle Plate           | 1        |

| Item Number   | Part Number | Description   | Quantity |
|---|-------------|---|----------|
| 16-18, 19d,<br>21a, 21b, 29d,<br>30                 | 114118      | Cable Kit, Drum Brake w/Left Hand Tilt, Ht Adj<br>Back Post Tall, Back Height 26-27", Std Axle<br>Plate           | 1        |
| 16-18, 19d,<br>21a, 21b, 29b,<br>30                 | 114119      | Cable Kit, Drum Brake w/Left Hand Tilt, Ht Adj<br>Back Post Short, Back Height 18-21", Inv Axle<br>Plate          | 1        |
| 16-18, 19d,<br>21a, 21b, 29c,<br>30                 | 114120      | Cable Kit, Drum Brake w/Left Hand Tilt, Ht Adj<br>Back Post Short, Back Height 22-25", Inv Axle<br>Plate          | 1        |
| 16-18, 19e,<br>21a, 21b, 29c,<br>30                 | 114121      | Cable Kit, Drum Brake w/Left Hand Tilt, Ht Adj<br>Back Post Tall, Back Height 20-25", Inv Axle<br>Plate           | 1        |
| 16-18, 19e,<br>21a, 21b, 29d,<br>30                 | 114122      | Cable Kit, Drum Brake w/Left Hand Tilt, Ht Adj<br>Back Post Tall, Back height 26-27", Inv Axle Plate              | 1        |
| 16, 17, 19c,<br>21a, 21b, 29c,<br>30                | 114123      | Cable Kit, Drum Brake w/Left Hand Tilt, Fixed<br>Height with Adj Handle Back Post Short, Std Axle<br>Plate        | 1        |
| 16, 17, 19d,<br>21a, 21b, 29d,<br>30                | 114124      | Cable Kit, Drum Brake w/Left Hand Tilt, Fixed<br>Height with Adj Handle Back Post Tall, Std Axle<br>Plate         | 1        |
| 16, 17, 19d,<br>21a, 21b, 29c,<br>30                | 114125      | Cable Kit, Drum Brake w/Left Hand Tilt, Fixed<br>Height with Adj Handle Back Post Short, Inv Axle<br>Plate        | 1        |
| 16, 17, 19e,<br>21a, 21b, 29d,<br>30                | 114126      | Cable Kit, Drum Brake w/Left Hand Tilt, Fixed<br>Height with Adj Handle Back Post Tall, Inv Axle<br>Plate         | 1        |
| 12, 16, 17,<br>19a, 20b, 22-<br>24, 26a, 29a,<br>30 | 114127      | Cable Kit, Drum Brake w/Dual Hand Tilt, Stroller<br>Handle Back Post Short, Std Axle Plate                        | 1        |
| 12, 16, 17,<br>19b, 20b, 22-<br>24, 26b, 29b,<br>30 | 114128      | Cable Kit, Drum Brake w/Dual Hand Tilt, Stroller<br>Handle Back Post Tall, Std Axle Plate                         | 1        |
| 12, 16, 17,<br>19b, 20b, 22-<br>24, 26a, 29a,<br>30 | 114129      | Cable Kit, Drum Brake w/Dual Hand Tilt, Stroller<br>Handle Back Post Short, Inv Axle Plate                        | 1        |
| 12, 16, 17, 19c,<br>20b, 22-24,<br>26b, 29b, 30     | 114130      | Cable Kit, Drum Brake w/Dual Hand Tilt, Stroller<br>Handle Back Post Tall, Inv Axle Plate                         | 1        |
| 12, 16, 17,<br>19a, 20b, 22-<br>27, 29a, 30         | 114131      | Cable Kit w/ Folding Hardware, Drum Brake<br>w/Dual Hand Tilt, Stroller Handle Back Post<br>Short, Std Axle Plate | 1        |
| 12, 16, 17,<br>19b, 20b, 22-<br>27, 29b, 30         | 114132      | Cable Kit w/ Folding Hardware, Drum Brake w/<br>Dual Hand Tilt, Stroller Handle Back Post Tall,<br>Std Axle Plate | 1        |
| 12, 16, 17,<br>19b, 20b, 22-<br>27, 29a, 30         | 114133      | Cable Kit w/ Folding Hardware, Drum Brake<br>w/Dual Hand Tilt, Stroller Handle Back Post<br>Short, Inv Axle Plate | 1        |
| 12, 16, 17, 19c,<br>20b, 22-27,<br>29b, 30          | 114134      | Cable Kit w/ Folding Hardware, Drum Brake<br>w/DualHand Tilt, Stroller Handle Back Post Tall,<br>Inv Axle Plate   | 1        |
| 16-18, 19c,<br>21b, 29b, 30                         | 114135      | Cable Kit, Drum Brake w/Dual Hand Tilt, Ht Adj<br>Back Post Short, Back Height 18-21", Std Axle<br>Plate          | 1        |

| Item Number   | Part Number | Description  | Quantity |
|---|-------------|--|----------|
| 16-18, 19c, 21b, 29c, 30                            | 114136      | Cable Kit, Drum Brake w/Dual Hand Tilt, Ht Adj Back Post Short, Back Height 22-25", Std Axle Plate   | 1        |
| 16-18, 19d, 21b, 29c, 30                            | 114137      | Cable Kit, Drum Brake w/Dual Hand Tilt, Ht Adj Back Post Tall, Back Height 20-25", Std Axle Plate    | 1        |
| 16-18, 19d, 21b, 29d, 30                            | 114138      | Cable Kit, Drum Brake w/Dual Hand Tilt, Ht Adj Back Post Tall, Back Height 26-27", Std Axle Plate    | 1        |
| 16-18, 19d, 21b, 29b, 30                            | 114139      | Cable Kit, Drum Brake w/Dual Hand Tilt, Ht Adj Back Post Short, Back Height 18-21", Inv Axle Plate   | 1        |
| 16-18, 19d, 21b, 29c, 30                            | 114140      | Cable Kit, Drum Brake w/Dual Hand Tilt, Ht Adj Back Post Short, Back Height 22-25", Inv Axle Plate   | 1        |
| 16-18, 19e, 21b, 29c, 30                            | 114141      | Cable Kit, Drum Brake w/Dual Hand Tilt, Ht Adj Back Post Tall, Back Height 20-25", Inv Axle Plate    | 1        |
| 16-18, 19e, 21b, 29d, 30                            | 114142      | Cable Kit, Drum Brake w/Dual Hand Tilt, Ht Adj Back Post Tall, Back height 26-27", Inv Axle Plate    | 1        |
| 16, 17, 19c, 21b, 29c, 30                           | 114143      | Cable Kit, Drum Brake w/Dual Hand Tilt, Fixed Height with Adj Handle Back Post Short, Std Axle Plate | 1        |
| 16, 17, 19d, 21b, 29d, 30                           | 114144      | Cable Kit, Drum Brake w/Dual Hand Tilt, Fixed Height with Adj Handle Back Post Tall, Std Axle Plate  | 1        |
| 16, 17, 19d, 21b, 29c, 30                           | 114145      | Cable Kit, Drum Brake w/Dual Hand Tilt, Fixed Height with Adj Handle Back Post Short, Inv Axle Plate | 1        |
| 16, 17, 19e, 21b, 29d, 30                           | 114146      | Cable Kit, Drum Brake w/Dual Hand Tilt, Fixed Height with Adj Handle Back Post Tall, Inv Axle Plate  | 1        |
| 2a, 2b, 3a, 4-7, 9a, 9b, 10, 12, 15, 25, 28a, 32-34 | 116063      | Drum Brake Rotor Kit for 12" Mag Wheels with Hardware PAIR, TILT                                     | 1        |
| 2a, 2b, 3a, 4-7, 9, 10, 12, 15, 25, 28a             | 113358      | Drum Brake Rotor Kit for 16" Mag Wheels with Hardware PAIR, TILT                                     | 1        |
| 2a, 2b, 3b, 4-7, 9, 10, 12, 15, 25, 28b             | 113359      | Drum Brake Rotor Kit for MAXX Spoke Wheels with Hardware PAIR, TILT                                  | 1        |
| 2a, 2b, 3b, 4-7, 9a, 9b, 10, 12, 15, 25, 28a, 32-34 | 116064      | Hardware Kit for Drum Brake Rotor for 12" Mag Wheels PAIR, TILT                                      | 1        |
| 3a, 4, 5, 6, 9, 10, 12, 15, 25, 28a                 | 113360      | Hardware Kit for Drum Brake Rotor for 16" Mag Wheels PAIR, TILT                                      | 1        |
| 3b, 4, 5, 6, 9, 10, 12, 15, 25, 28b                 | 113361      | Hardware Kit for Drum Brake Rotor for MAXX Spoke Wheels, PAIR, TILT                                  | 1        |
| 2a, 3a, 4-7, 9, 10, 12, 15, 25, 28a                 | 113362      | Drum Brake Rotor Kit for Mag Wheels with Hardware, Side A, TILT                                      | 1        |

| Item Number                         | Part Number | Description   | Quantity |
|-------------------------------------|-------------|---|----------|
| 2b, 3a, 4-7, 9, 10, 12, 15, 25, 28a | 113363      | Drum Brake Rotor Kit for Mag Wheels with Hardware, Side A, TILT                               | 1        |
| 2a, 3b, 4-7, 9, 10, 12, 15, 25, 28b | 113364      | Drum Brake Rotor Kit for MAXX Spoke Wheels with Hardware, Side B, TILT                        | 1        |
| 2b, 3b, 4-7, 9, 10, 12, 15, 25, 28b | 113365      | Drum Brake Rotor Kit for MAXX Spoke Wheels with Hardware, Side A, TILT                        | 1        |
| 3a, 4, 5, 6, 9, 10, 12, 15, 25, 28a | 113366      | Hardware Kit for Drum Brake Rotor for Mag Wheels, One Side, TILT                              | 2        |
| 3b, 4, 5, 6, 9, 10, 12, 15, 25, 28b | 113367      | Hardware Kit for Drum Brake Rotor for MAXX Spoke Wheels, One Side, TILT                       | 2        |
| 1a                                  | 111804      | 12" Mag Wheel with Pneumatic Tire, Drum Brake Hub   | 2        |
| 1b                                  | 111805      | 12" Mag Wheel with Full Poly Tire, Drum Brake Hub   | 2        |
| 1b                                  | 111803      | 16" Mag Wheel with Full Poly Tire, Drum Brake Hub   | 1        |
| 1c, 2-6                             | 002678      | Drum Brake Kit, 16" Mag, Pneumatic Tire PAIR  | 1        |
| 1d, 2-6                             | 002680      | Drum Brake Kit, 16" Mag, Full Poly Tire PAIR  | 1        |
| 1e, 2-6                             | 002679      | Drum Brake Kit, 16" Mag, Pneumatic Tire w/ Airless Insert PAIR                                | 1        |
| 2a, 28a                             | 113368      | Drum Brake Rotor with Axle Sleeve, Side B, for Mag Wheel                                      | 1        |
| 2b, 28a                             | 113369      | Drum Brake Rotor with Axle Sleeve, Side A, for Mag Wheel                                      | 1        |
| 2a, 28b                             | 113370      | Drum Brake Rotor with Axle Sleeve, Side B, for MAXX Spoke Wheel                               | 1        |
| 2b, 28b                             | 113371      | Drum Brake Rotor with Axle Sleeve, Side A, for MAXX Spoke Wheel                               | 1        |
| 3a                                  | 101108      | Axle Quick Release w/ Button 1/2" x 99MM<br><i>Used with 12" and 16" Mag wheels</i>           | 2        |
| 3b                                  | 101191      | Axle Quick Release w/ Button 1/2" x 110MM<br><i>Used with 24" MAXX Spoke wheel</i>            | 2        |
| 4                                   | 111598      | Drum Brake, Pinch Bolt  | 2        |
| 7                                   | 002465      | Adapter, Drum Brake, Focus  | 2        |
| 8a                                  | 002463      | Axle Plate, Drum Brake R  | 1        |
| 8b                                  | 002464      | Axle Plate, Drum Brake L  | 1        |
| 9a                                  | 101823      | M6 x 20 HHCS Blk Zn   | 2        |
| 9b                                  | 102792      | M6 x 25, HHCS, Blk Zn<br><i>Used with 12" Wheels in combination with Inverted Axle Plates</i> | 2        |

| Item Number | Part Number | Description   | Quantity |
|-------------|-------------|---|----------|
| 10          | 100746      | M6 Flat Washer Blk Zn   | 4        |
| 11          | 101831      | M8 x 80 HHCS Blk Zn   | 4        |
| 12          | 100658      | M6 Nylock Nut Blk Zn  | 4        |
| 13          | 102386      | M6 x 35mm HHCS Blk Zc   | 2        |
| 14          | 002709      | Cover, Wheel Lock Mount<br><i>Used only with inverted axle plate when no other wheel lock is mounted</i>  | 2        |
| 15          | 000465      | Washer - .725 x 1.5 x .09 F/W ZC PR   | 2        |
| 16          | 001239      | P-Clip 3/16"  | 2        |
| 17          | 001117      | Cable Clip 1"<br><i>Use quantity 2 per stroller handle back post; quantity 1 per height adjustable back post; quantity 2 per fixed height with adjustable handle back post</i>  | 4        |
| 18          | 001118      | Cable Clip 7/8"<br><i>Use quantity 1 per height adjustable back post</i>  | 2        |
| 19a         | 002468      | Cable, Drum Brake, Short<br><i>Used with short stroller handle back post and standard axle plate</i>  | 2        |
| 19b         | 002469      | Cable, Drum Brake, Medium<br><i>Used with with short stroller handle back post and inverted axle plate or tall stroller handle back post and standard axle plate</i>  | 2        |
| 19c         | 002470      | Cable, Drum Brake, Long<br><i>Used with tall stroller handle back post and inverted axle plate; short height adjustable back post and standard axle plate; or short fixed height with adjustable handle back post and standard axle plate</i>   | 2        |
| 19d         | 002471      | Cable, Drum Brake, XL<br><i>Used with short height adjustable back post and inverted axle plate; tall height adjustable back post and standard axle plate; short fixed height with adjustable handle back post and inverted axle plate; or tall fixed height with adjustable handle back post and standard axle plate</i> | 2        |
| 19e         | 002472      | Cable, Drum Brake, XXL<br><i>Used with tall height adjustable back post and standard or inverted axle plate or tall fixed height with adjustable handle and standard or inverted axle plate</i>   | 2        |
| 20a         | 002673      | Brake Lever, Lock, Ang, 25mm<br><i>Used with stroller handle back posts and left or right hand tilt is present. Not used if dual hand tilt is present.</i>  | 1        |
| 20b, 30     | 114147      | Tilt and Drum Brake Lever, 25MM, with Dual Lever Cable End Adapter<br><i>Use quantity 1 when stroller handle back posts are present with a left or right hand tilt. Use quantity 2 if dual hand tilt is present.</i>  | 1        |

| Item Number | Part Number | Description  | Quantity |
|-------------|-------------|--|----------|
| 21a         | 002674      | Brake Lever, Lock, Str, 22mm<br><i>Used with height adjustable and fixed height with adjustable handle back posts and left or right hand tilt is present. Not used if dual hand tilt is present.</i>   | 1        |
| 21b, 30     | 114148      | Tilt and Drum Brake Lever, 22MM, with Dual Lever Cable End Adapter<br><i>Use quantity 1 when height adjustable and fixed height with adjustable handle back posts are present with left or right hand tilt. Use quantity 2 if dual hand tilt is present.</i> | 1        |
| 23          | 100804      | Tube End Plug 1"   | 2        |
| 25          | 100659      | M8 Nylock Nut Blk Zn   | 2        |
| 29a         | 112932      | Cable, Tilt w/Drum, Long, Focus<br><i>Used with short stroller handle back post</i>  | 1        |
| 29b         | 112933      | Cable, Tilt w/Drum, XL<br><i>Used with tall stroller handle back post or short height adjustable back post with back heights of 18 - 21"</i>   | 1        |
| 29c         | 112934      | Cable, Tilt w/Drum, XXL<br><i>Used with short height adjustable back post with back heights of 22 - 25" or tall height adjustable back post with back heights of 20 - 25" or short fixed height adjustable handle back post</i>                              | 1        |
| 29d         | 112570      | Cable, Tilt w/Drum, XXXL<br><i>Used with tall height adjustable back post with back heights of 26 - 27" or tall fixed height adjustable handle back post</i>   | 1        |
| 31a         | 111733      | Wheel 24" MAXX Spoke, Drum Brake   | 2        |
| 31b         | 118358      | 24" Spoke for Drum Brake, Pneumatic w/ Airless Insert Tire (Black)<br><i>Replaced kit number 117432. Does not include the handrim. Quote handrim hardware if needed.</i>   | 2        |



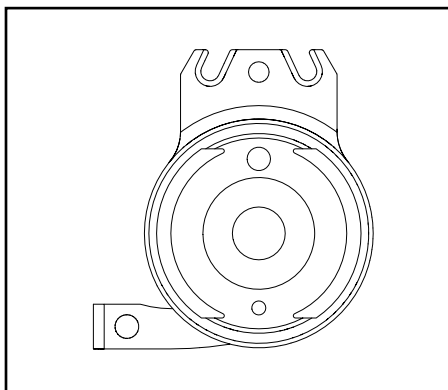

**Rotor A** - Part No. 111641

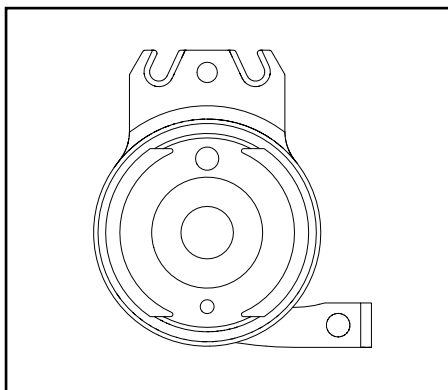

**Rotor B** - Part No. 111640

| Catalyst 5            |      |       |
|-----------------------|------|-------|
| Configuration         | Left | Right |
| Axle plate curve up   | B    | A     |
| Axle plate curve down | A    | B     |

Left: Axle Plate Curve Up  
Right: Axle Plate Curve Down

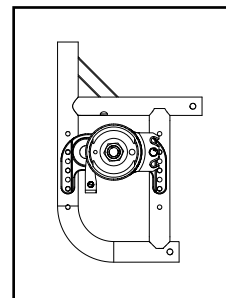
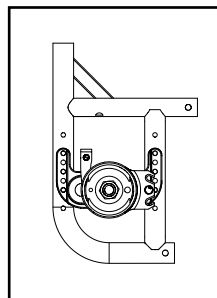

| Catalyst 5VX                     |      |       |
|----------------------------------|------|-------|
| Configuration                    | Left | Right |
| Axle Position holes 1-5 (top)    | A    | B     |
| Axle Position holes 6-7 (bottom) | B    | A     |

Left: Axle Position Top  
Right: Axle Position Bottom

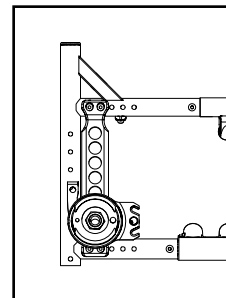
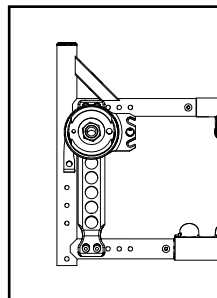

| Liberty       |      |       |
|---------------|------|-------|
| Configuration | Left | Right |
| All           | B    | A     |

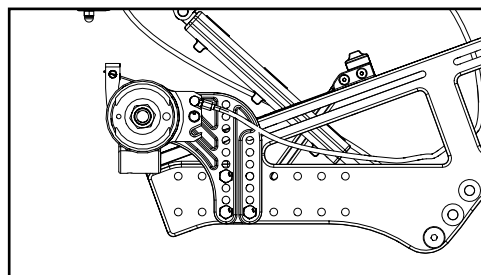

| Flip          |      |       |
|---------------|------|-------|
| Configuration | Left | Right |
| All           | A    | B     |

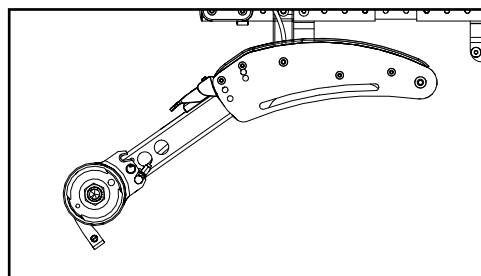

| Focus                              |      |       |
|------------------------------------|------|-------|
| Configuration                      | Left | Right |
| Standard (mounts above base frame) | A    | B     |
| Inverted (mounts below base frame) | B    | A     |

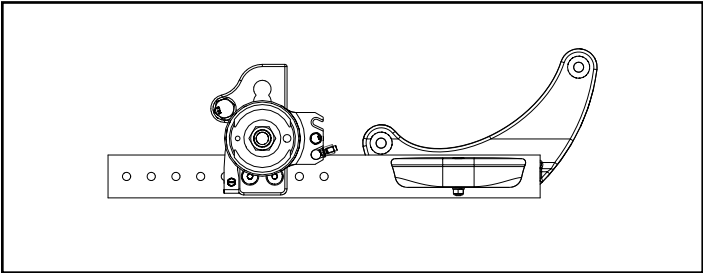

Standard Configuration

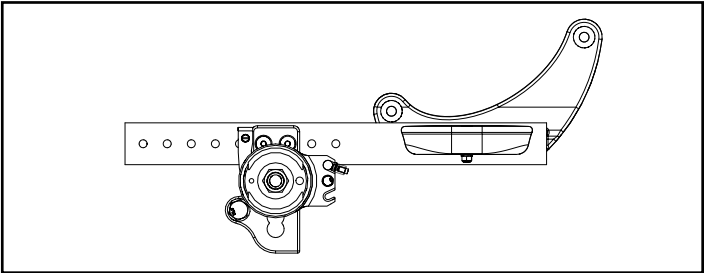

Inverted Configuration

| Rigid  |      |       |
|--|------|-------|
| Configuration  | Left | Right |
| Tower 000925 - upper holes (14 or more exposed below clamp)        | B    | A     |
| Tower 000925 - lower holes (13 or fewer holes exposed below clamp) | A    | B     |
| Tower 000926 (all hole locations)                                  | A    | B     |

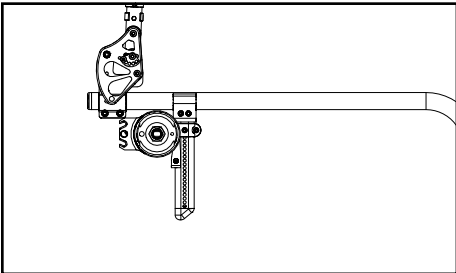

Tower 000925 - Upper Holes

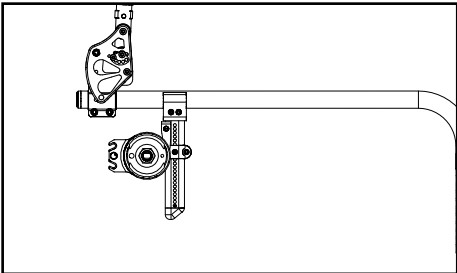

Tower 000925 - Lower Holes

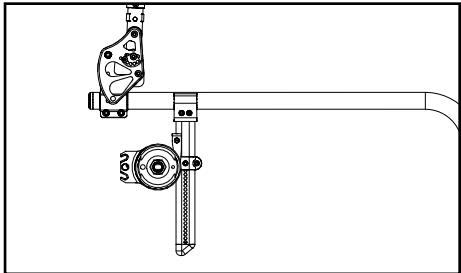

Tower 000926 - All Holes

| Arc           |      |       |
|---------------|------|-------|
| Configuration | Left | Right |
| All           | B    | A     |

