

Spark Stroller Handle Back Post with Removable Stroller Extension

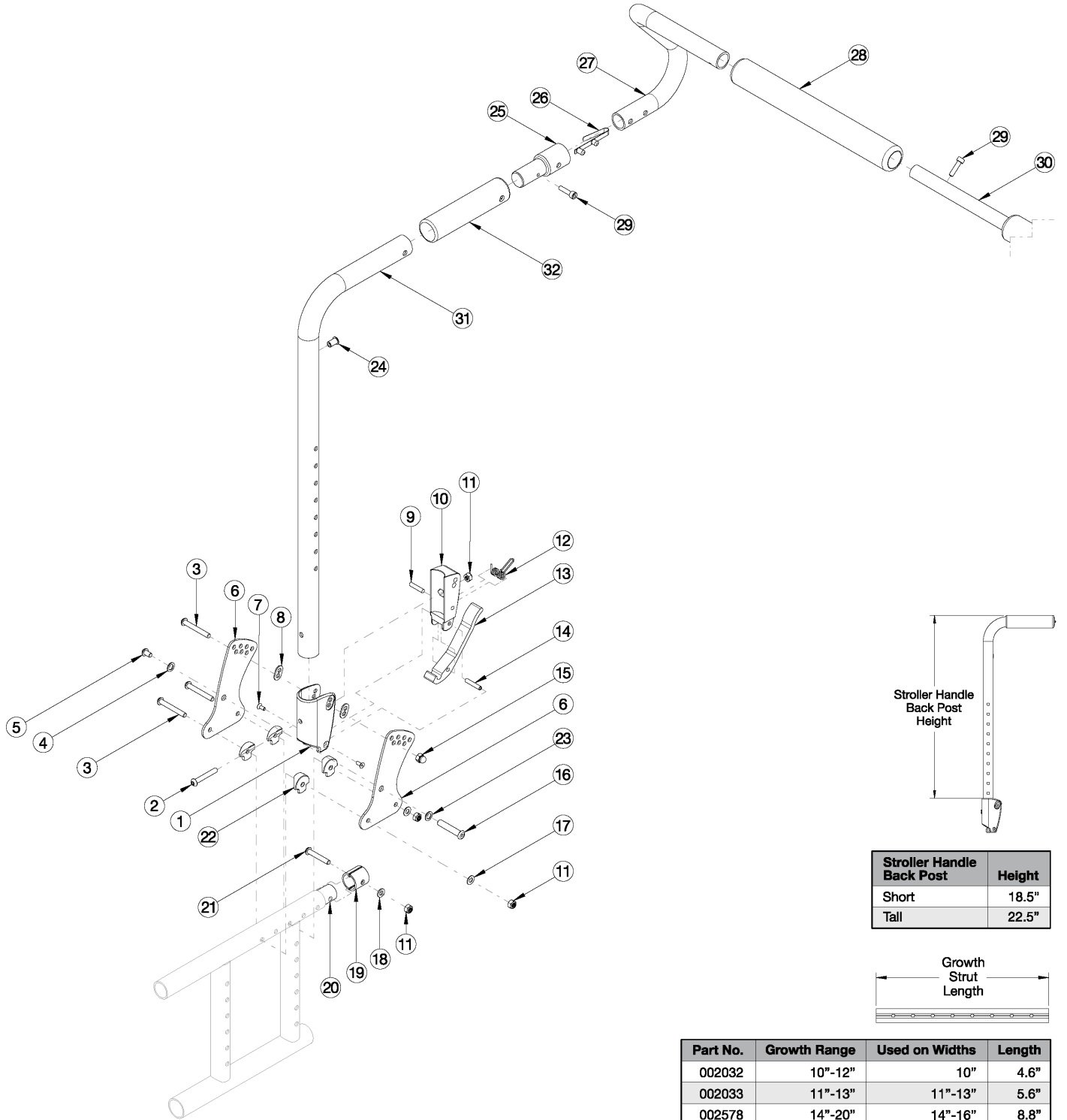

Stroller Handle Back Post	Height
Short	18.5"
Tall	22.5"

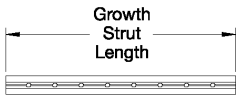

Part No.	Growth Range	Used on Widths	Length
002032	10"-12"	10"	4.6"
002033	11"-13"	11"-13"	5.6"
002578	14"-20"	14"-16"	8.8"

This backrest style and removable stroller handle extension was released February 8th, 2021

Item Number	Part Number	Description	Quantity
24, 25, 26, 27a, 27b, 28, 29, 30a, 31a, 32	112650	Stroller Handle Back Post, Short, with Removable Stroller Handle Extension Assembly, 10" Wide, Spark Pair <i>This kit does not contain any backrest hardware. For a complete retrofit, select this kit and the Depth Adjustable Backrest hardware Assembly.</i>	1
24, 25, 26, 27a, 27b, 28, 29, 30a, 31b, 32	112651	Stroller Handle Back Post, Tall, with Removable Stroller Handle Extension Assembly, 10" Wide, Spark Pair <i>This kit does not contain any backrest hardware. For a complete retrofit, select this kit and the Depth Adjustable Backrest hardware Assembly.</i>	1
24, 25, 26, 27a, 27b, 28, 29, 30b, 31a, 32	112652	Stroller Handle Back Post, Short, with Removable Stroller Handle Extension Assembly, 11-13" Wide, Spark Pair <i>This kit does not contain any backrest hardware. For a complete retrofit, select this kit and the Depth Adjustable Backrest hardware Assembly.</i>	1
24, 25, 26, 27a, 27b, 28, 29, 30b, 31b, 32	112653	Stroller Handle Back Post, Tall, with Removable Stroller Handle Extension Assembly, 11-13" Wide, Spark Pair <i>This kit does not contain any backrest hardware. For a complete retrofit, select this kit and the Depth Adjustable Backrest hardware Assembly.</i>	1
24, 25, 26, 27c, 27d, 28, 29, 30c, 31a, 32	112640	Stroller Handle Back Post, Short, with Removable Stroller Handle Extension Assembly, 14-17" Wide, Catalyst/Spark, PAIR <i>This kit does not contain any backrest hardware. For a complete retrofit, select this kit and the Depth Adjustable Backrest hardware Assembly.</i>	1
24, 25, 26, 27c, 27d, 28, 29, 30c, 31b, 32	112641	Stroller Handle Back Post, Tall, with Removable Stroller Handle Extension Assembly, 14-17" Wide, Catalyst/Spark, PAIR <i>This kit does not contain any backrest hardware. For a complete retrofit, select this kit and the Depth Adjustable Backrest hardware Assembly.</i>	1
25, 26, 27a, 27b, 28, 29, 30a	112648	Removable Stroller Handle Extension Assembly, 10" Wide, Spark, PAIR <i>This kit does not contain back posts or backrest hardware</i>	1
25, 26, 27a, 27b, 28, 29, 30b	112649	Removable Stroller Handle Extension Assembly, 11" - 13" Wide, Spark, PAIR <i>This kit does not contain back posts or backrest hardware</i>	1
25, 26, 27c, 27d, 28, 29, 30c	112644	Removable Stroller Handle Extension Assembly, 14" - 17" Wide, Catalyst/Spark, PAIR <i>This kit does not contain back posts or backrest hardware</i>	1
24, 31a, 32	112646	Stroller Handle Back Post for Removable Stroller Handle Extension, Short	1
24, 31b, 32	112647	Stroller Handle Back Post for Removable Stroller Handle Extension, Tall	1
1-19, 21, 22, 23	112605	Depth Adjustable Backrest Hardware Assembly, for Seating Cross Braces Left	1

Item Number	Part Number	Description	Quantity
1-19, 21, 22, 23	122899	Depth Adjustable Backrest Hardware Assembly, for Seating Cross Braces Right	1
1-19, 21, 22, 23	112606	Depth Adjustable Backrest Hardware Assembly, for Seating Cross Braces, PAIR	1
1, 8	503834	Cover Plate, Latch Insert Kit	1
2	100797	M6 x 40 BHCS BLK ZC	1
3	100670	M6 x 45 BTN SHCS BLK ZC	3
4	101701	Washer 3.315/.350 x .425/.525 x .059/.067 18-8 F/W	1
5	101184	M6 x 10 BTN SHCS BLKZC w/Patch	1
6	111833	Depth Adjustable Back Plate, Folding	2
7	101818	M4 x 10 FHCS BLKZC w/Patch	2
8	001897	Washer, Dual, PSA	2
9	102694	Dowel Pin, M5 X 24, Blk Zn	1
10	001895	Latch Insert, Folding Backrest	1
11	100658	M6 Nylock Nut Blk Zn	4
12	001896	Spring, Backrest Latch	1
13	001893	Latch Lever, Backrest	1
14	002513	Threaded Barrel, 5mm OD x M4	1
15	100558	M6 Nyl Ins Domed Cap L/N Zc	1
16	003284	Binding Post, 8mm x 40mm x M6	1
17	102803	Washer Flat .250 X .500 X .027 Hx Blz	2
18	100746	M6 Flat Washer Blk Zn	1
19	114443	Tube Spacer, Black, 1" OD x .083" x .80 LG <i>Replacement for part number 001230</i>	2
20	000605	Depth Adjustable Frame Extension Tube, Catalyst/Spark	1
21	101811	M6 x 35 BHCS Blk Zn	1
22	000612	1" Half Saddle Washer	4
23	101861	Nylon Washer 5/16 x 1/2 x .03	1
25	001243	Stroller Handle Adaptor	1
26	100533	Detent Button	1

Item Number	Part Number	Description	Quantity
27a, 28	503222	Stroller Handle with Foam Grip, Pediatric, Left <i>Used on 10"-13" Wide</i>	1
27b, 28	503221	Stroller Handle with Foam Grip, Pediatric, Right <i>Used on 10"-13" Wide</i>	1
27c, 28	501091	Stroller Handle with Foam Grip, Left <i>Used on 14 - 16" Wide</i>	1
27d, 28	501090	Stroller Handle with Foam Grip, Right <i>Used on 14 - 16" Wide</i>	1
29	101843	M5 x 20 SHCS Blk Zn	2
30a	002032	Growth Strut, Stroller, 10-12 <i>Used on 10" Wide</i>	1
30b	002033	Growth Strut, Stroller, 11-13 <i>Used on 11 - 13" Wide</i>	1
30c	002578	Growth Strut, Stroller, Short <i>Used on 14 - 16" Wide</i>	1