

# Catalyst / Spark Dynamic Rocker Back

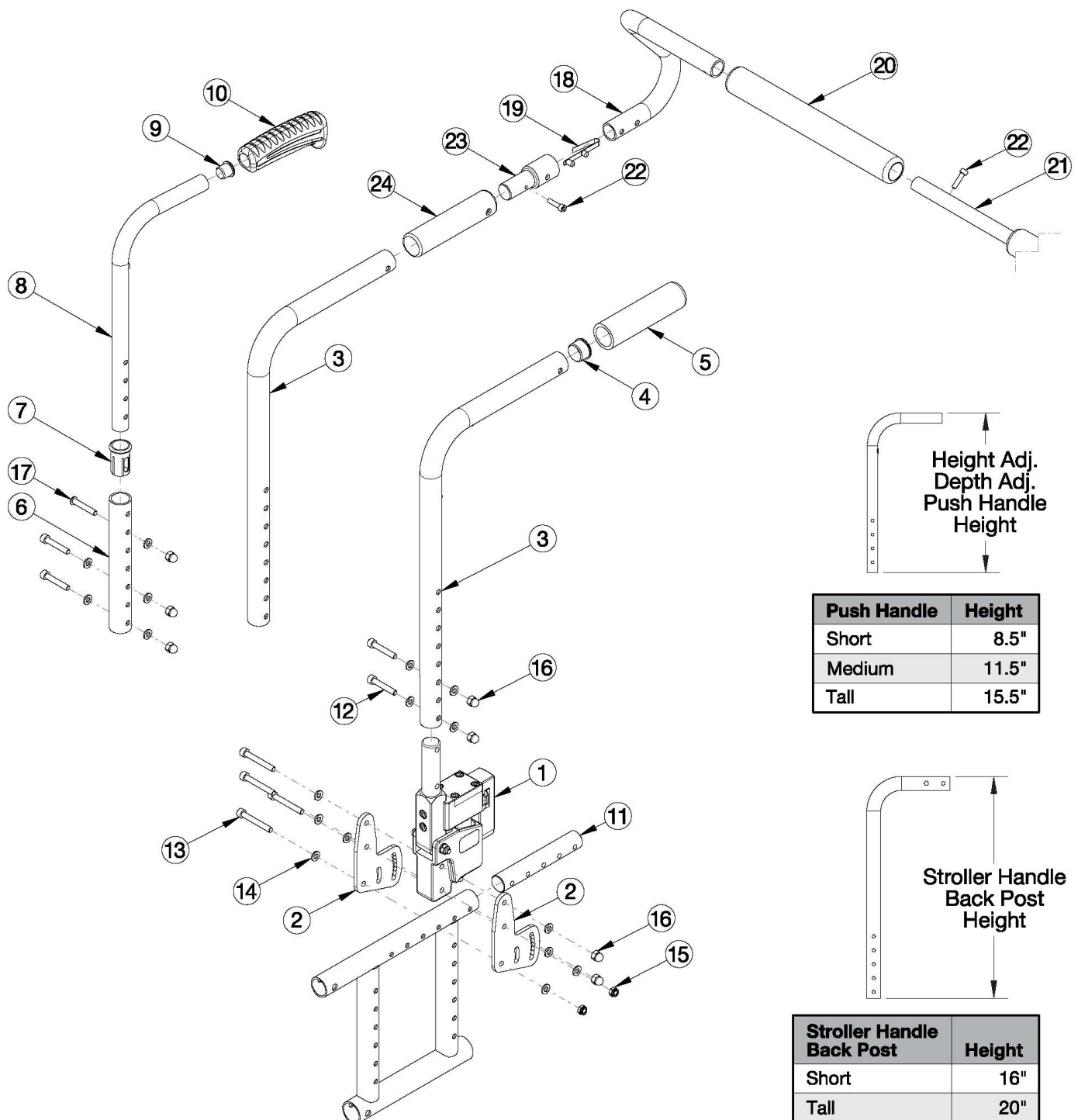

*This backrest style was released February 8th, 2021. When retrofitting, a depth adjustable rear frame is required. For a complete retrofit, you will need the Dynamic Rocker Back (PAIR), Frame Attaching Hardware Kit for Rocker Back (qty 2) and desired back post assemblies (qty 1 or 2 depending on kit selected). If retrofitting from the Discontinued Stroller Handle Extensions to this Removable Stroller Handle Extension, you will need to order the desired Stroller Handle Back Post with Removable Stroller Handle Extension for Rocker Back (Depth Adjustable) kit; part #'s 114181 - 114188. Low Profile Push Handles are not available with Heavy Duty Option or Drum Brake. If changing from another style backrest and the Drum Brake is present, a new Drum Brake Cable Kit may be required.*

Item Number	Part Number	Description	Quantity
1	121060	Dynamic Rocker Back Fixed Ht PAIR Focus/Flip	1
13 - 16	502596	Frame Attaching Hardware Kit for Rocker Back, (One Side) Catalyst	1
3a ,4, 5, 12, 14, 16	114177	Stroller Handle Back Post for Rocker Back with Grip (Depth Adjustable), One Side, Short	1
3b ,4, 5, 12, 14, 16	114178	Stroller Handle Back Post for Rocker Back with Grip (Depth Adjustable), One Side, Tall	1
6, 7, 8a, 9, 10a, 12, 14, 16, 17	502597	Depth Adjustable Height Adjustable Rocker Back Tube Assembly, 16" - 18" Back Height, One Side	1
6, 7, 8b, 9, 10a, 12, 14, 16, 17	502598	Depth Adjustable Height Adjustable Rocker Back Tube Assembly, 19" - 22" Back Height, One Side	1
6, 7, 8c, 9, 10a, 12, 14, 16, 17	502599	Depth Adjustable Height Adjustable Rocker Back Tube Assembly, 23" - 24" Back Height, One Side	1
8a, 9, 10a	501654	Depth Adjustable Height Adjustable Upper Push Handle Short Assembly w/ Standard Grip	1
8b, 9, 10a	501655	Depth Adjustable Height Adjustable Upper Push Handle Medium Assembly w/ Standard Grip	1
8c, 9, 10a	501656	Depth Adjustable Height Adjustable Upper Push Handle Tall Assembly w/ Standard Grip	1
8a, 9, 10b	002762	Depth Adjustable Height Adjustable Upper Push Handle Short Assembly w/ Low Profile Grip	1
8b, 9, 10b	002763	Depth Adjustable Height Adjustable Upper Push Handle Medium Assembly w/ Low Profile Grip	1
8c, 9, 10b	002764	Depth Adjustable Height Adjustable Upper Push Handle Tall Assembly w/ Low Profile Grip	1
3a, 12, 14, 16, 18a, 18b, 19, 20, 21a, 22, 23, 24	114181	Stroller Handle Back Post with Removable Stroller Handle Extension for Rocker Back (Depth Adjustable) Short, 10" Wide	1
3a, 12, 14, 16, 18a, 18b, 19, 20, 21b, 22, 23, 24	114182	Stroller Handle Back Post with Removable Stroller Handle Extension for Rocker Back (Depth Adjustable) Short, 11" - 13" Wide	1
3a, 12, 14, 16, 18c, 18d, 19, 20, 21c, 22, 23, 24	114183	Stroller Handle Back Post with Removable Stroller Handle Extension for Rocker Back (Depth Adjustable) Short, 14" - 17" Wide	1
3a, 12, 14, 16, 18c, 18d, 19, 20, 21d, 22, 23, 24	114184	Stroller Handle Back Post with Removable Stroller Handle Extension for Rocker Back (Depth Adjustable) Short, 18" - 22" Wide	1
3b, 12, 14, 16, 18a, 18b, 19, 20, 21a, 22, 23, 24	114185	Stroller Handle Back Post with Removable Stroller Handle Extension for Rocker Back (Depth Adjustable) Tall, 10" Wide	1
3b, 12, 14, 16, 18a, 18b, 19, 20, 21b, 22, 23, 24	114186	Stroller Handle Back Post with Removable Stroller Handle Extension for Rocker Back (Depth Adjustable) Tall, 11" - 13" Wide	1
3b, 12, 14, 16, 18c, 18d, 19, 20, 21c, 22, 23, 24	114187	Stroller Handle Back Post with Removable Stroller Handle Extension for Rocker Back (Depth Adjustable) Tall, 14" - 17" Wide	1

Item Number	Part Number	Description	Quantity
3b, 12, 14, 16, 18c, 18d, 19, 20, 21d, 22, 23, 24	114188	Stroller Handle Back Post with Removable Stroller Handle Extension for Rocker Back (Depth Adjustable) Tall, 18" - 22" Wide	1
3a, 12, 14, 16, 22, 23, 24	114179	Stroller Handle Back Post for Removable Stroller Handle Extension for Rocker Back (Depth Adjustable), One Side, Short	1
3b, 12, 14, 16, 22, 23, 24	114180	Stroller Handle Back Post for Removable Stroller Handle Extension for Rocker Back (Depth Adjustable), One Side, Tall	1
4	100804	Tube End Plug 1"	1
6	002039	Depth Adjustable Height Adjustable Rocker Back Tube, Lower	1
7	000034	Sleeve 3/4" x 1 1/2"	1
9	100638	Tube End Plug 3/4"	1
10a	109432	Ergo Push Handle Grip 3/4" Standard with Instruction	1
11	000605	Depth Adjustable Frame Extension Tube, Catalyst/Spark	1
12	101810	M6 x 35 SHCS BLK ZC	2
13	101472	M6 x 45 SHCS BLK ZC	4
14	100746	M6 Flat Washer Blk Zn	13
15	100658	M6 Nylock Nut Blk Zn	2
16	100558	M6 NYL INS Domed Cap L/N ZC	4
17	101811	M6 x 35 BHCS Blk Zn	1
18a, 20	503222	Stroller Handle with Foam Grip, Pediatric, Left <i>Used on 10" - 13" Wide</i>	1
18b, 20	503221	Stroller Handle with Foam Grip, Pediatric, Right <i>Used on 10" - 13" Wide</i>	1
18c, 20	501091	Stroller Handle with Foam Grip, Left <i>Used on 14" - 22" Wide</i>	1
18d, 20	501090	Stroller Handle with Foam Grip, Right <i>Used on 14" - 22" Wide</i>	1
18a, 18b, 19, 20, 21a, 22, 23	112648	Removable Stroller Handle Extension Assembly, 10" Wide, Spark, PAIR <i>This kit does not contain back posts or backrest hardware</i>	1
18a, 18b, 19, 20, 21b, 22, 23	112649	Removable Stroller Handle Extension Assembly, 11" - 13" Wide, Spark, PAIR <i>This kit does not contain back posts or backrest hardware</i>	1
18c, 18d, 19, 20, 21c, 22, 23	112644	Removable Stroller Handle Extension Assembly, 14" - 17" Wide, Catalyst/Spark, PAIR <i>This kit does not contain back posts or backrest hardware</i>	1

Item Number	Part Number	Description	Quantity
18c, 18d, 19, 20, 21d, 22, 23	112645	Removable Stroller Handle Extension Assembly, 18" - 22" Wide, PAIR <i>This kit does not contain back posts or backrest hardware</i>	1
19	100533	Detent Button	1
21a	002032	Growth Strut, Stroller, 10-12 <i>Used on 10" Wide</i>	1
21b	002033	Growth Strut, Stroller, 11-13 <i>Used on 11" - 13" Wide</i>	1
21c	002578	Growth Strut, Stroller, Short <i>Used on 14" - 17" Wide</i>	1
21d	002579	Growth Strut, Stroller, Long <i>Used on 18" - 22" Wide</i>	1
22	101843	M5 x 20 SHCS Blk Zn	2
23	001243	Stroller Handle Adaptor	1