

# Clik Angle Adjustable Footrest with Riser

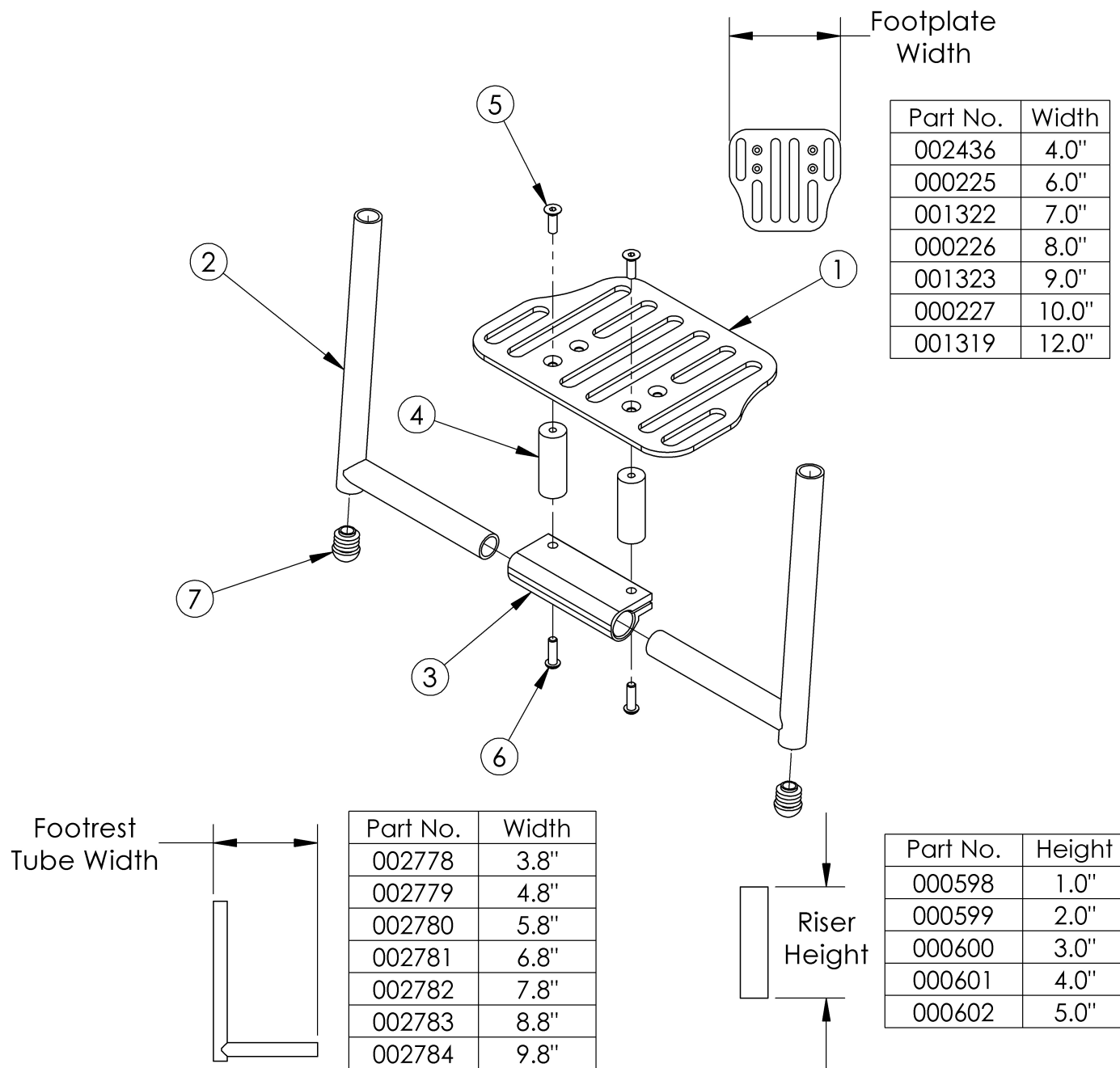

Angle Adjustable Footplate Assemblies do not include Risers. See Riser Assemblies. For attaching footrest hardware, reference the Clik Side Frame pages (serial numbers CLK005270 and after) or Discontinued Clik Side Frame pages (serial numbers prior to CLK005270).

| Item Number    | Part Number | Description   | Quantity |
|----------------|-------------|---|----------|
| 1a, 2a, 3, 5-7 | 502541      | Footrest Assembly Angle Adjustable for Riser 8" Wide Clik | 1        |

| Item Number    | Part Number | Description   | Quantity |
|----------------|-------------|---|----------|
| 1b, 2a, 3, 5-7 | 502542      | Footrest Assembly Angle Adjustable for Riser 9" Wide Klik                         | 1        |
| 1c, 2b, 3, 5-7 | 502543      | Footrest Assembly Angle Adjustable for Riser 10" Wide Klik                        | 1        |
| 1d, 2b, 3, 5-7 | 502544      | Footrest Assembly Angle Adjustable for Riser 11" Wide / 8" Offset Klik            | 1        |
| 1e, 2b, 3, 5-7 | 503093      | Footrest Assembly Angle Adjustable for Riser 9" Wide Offset Klik                  | 1        |
| 1e, 2c, 3, 5-7 | 502545      | Footrest Assembly Angle Adjustable for Riser 12" Wide Klik                        | 1        |
| 1f, 2c, 3, 5-7 | 502546      | Footrest Assembly Angle Adjustable for Riser 13" Wide / 10" Offset Klik           | 1        |
| 1g, 2c, 3, 5-7 | 503094      | Footrest Assembly Angle Adjustable for Riser 11" Wide Offset Klik                 | 1        |
| 1g, 2d, 3, 5-7 | 502547      | Footrest Assembly Angle Adjustable for Riser 14", 15" Wide / 12", 13" Offset Klik | 1        |
| 1g, 2e, 3, 5-7 | 502548      | Footrest Assembly Angle Adjustable for Riser 16" Wide / 14", 15" Offset Klik      | 1        |
| 1g, 2f, 3, 5-7 | 502593      | Footrest Assembly Angle Adjustable for Riser 17", 18" Wide / 16", 17" Offset Klik | 1        |
| 1g, 2g, 3, 5-7 | 503095      | Footrest Assembly Angle Adjustable for Riser 18" Wide Offset Klik                 | 1        |
| 4a, 5, 6       | 502321      | Rigid Footplate Riser 1" w/ Hardware Assembly, PAIR                               | 1        |
| 4b, 5, 6       | 502322      | Rigid Footplate Riser 2" w/ Hardware Assembly, PAIR                               | 1        |
| 4c, 5, 6       | 502323      | Rigid Footplate Riser 3" w/ Hardware Assembly, PAIR                               | 1        |
| 4d, 5, 6       | 502324      | Rigid Footplate Riser 4" w/ Hardware Assembly, PAIR                               | 1        |
| 4e, 5, 6       | 502325      | Rigid Footplate Riser 5" w/ Hardware Assembly, PAIR                               | 1        |
| 1a             | 002436      | Footrest Platform Angle Adjustable 4" Rigid                                       | 1        |
| 1b             | 000225      | Footrest Platform Angle Adjustable 6"   | 1        |
| 1c             | 001322      | Footrest Platform Angle Adjustable 7"   | 1        |
| 1d             | 000226      | Footrest Platform Angle Adjustable 8"   | 1        |
| 1e             | 001323      | Footrest Platform Angle Adjustable 9"   | 1        |
| 1f             | 000227      | Footrest Platform Angle Adjustable 10"  | 1        |
| 1g             | 001319      | Footrest Platform Angle Adjustable 12"  | 1        |
| 2a             | 002778      | Footrest Extension Welded 3.8"  | 2        |
| 2b             | 002779      | Footrest Extension Welded 4.8"  | 2        |
| 2c             | 002780      | Footrest Extension Welded 5.8"  | 2        |
| 2d             | 002781      | Footrest Extension Welded 6.8"  | 2        |

| Item Number | Part Number | Description                                    | Quantity |
|-------------|-------------|--|----------|
| 2e          | 002782      | Footrest Extension Welded 7.8"                 | 2        |
| 2f          | 002783      | Footrest Extension Welded 8.8"                 | 2        |
| 2g          | 002784      | Footrest Extension Welded 9.8"                 | 2        |
| 3           | 100789      | Footrest Adjustable Clamp 5"                   | 1        |
| 4a          | 000598      | Rigid Footplate Riser 1"                       | 2        |
| 4b          | 000599      | Rigid Footplate Riser 2"                       | 2        |
| 4c          | 000600      | Rigid Footplate Riser 3"                       | 2        |
| 4d          | 000601      | Rigid Footplate Riser 4"                       | 2        |
| 4e          | 000602      | Rigid Footplate Riser 5"                       | 2        |
| 5           | 101594      | M6 x 14 CLS10.9 DIN7991 FSHCS BLKZC<br>w/Patch | 2        |
| 6           | 101180      | M6 x 20 SHCS BLK ZC                            | 2        |
| 7           | 002834      | Dome Top Tube End, 3/4"                        | 2        |

Distance between Point A and Point B  
B = Footplate Length

**NOTE:** The yardstick on the top plane of the seat frame must lie flat against frame. The yardstick going from the footplate to the second yardstick must be square against the hanger tube.

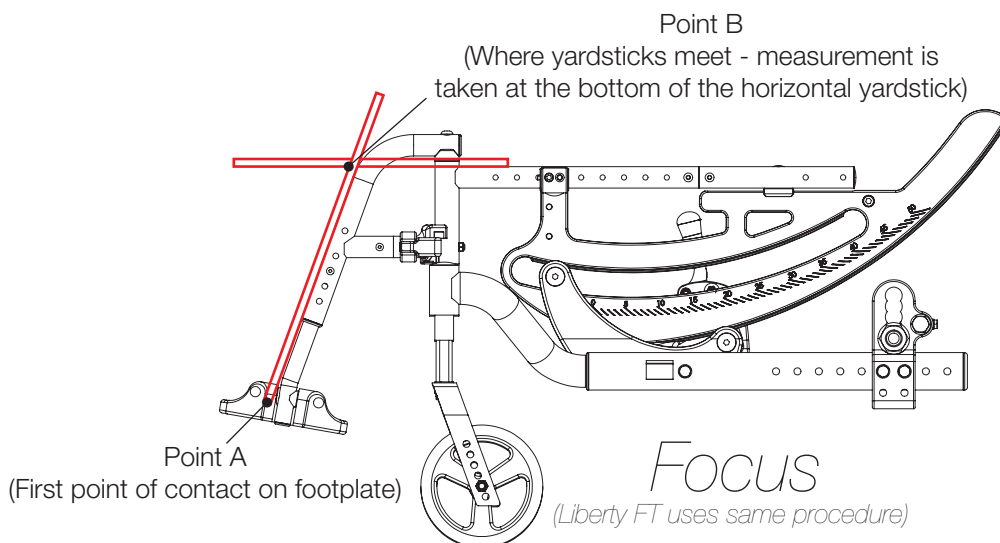

Distance between Point A and Point B  
B = Footplate Length

**NOTE:** The yardstick on the top plane of the seat frame must lie flat against frame. The yardstick going from the footplate to the second yardstick must be square against the front tube.



Distance between Point A and Point B  
B = Footplate Length

**NOTE:** The yardstick on the top plane of the hanger must lie flat against hanger. The yardstick going from the footplate to the second yardstick must be square against the hanger tube.

