

INSTRUCTION SHEET

Foot Wheel Lock/12" Wheel

ITEM	DESCRIPTION
A	BRAKE CLAMP ASSEMBLY
B	FOOTLOCK ASSEMBLY
C	1/4-20 X 1 BHCS W/PATCH (P/N 226061)
D	1/4 AN WASHER FLAT THIN (P/N 262110)
E	FOOTLOCK TUBE W/FOAM (P/N 880710-16)
F	ZIPPIE TS FRAME
G	SLIDE BLOCK
H	REAR STRUT TUBE

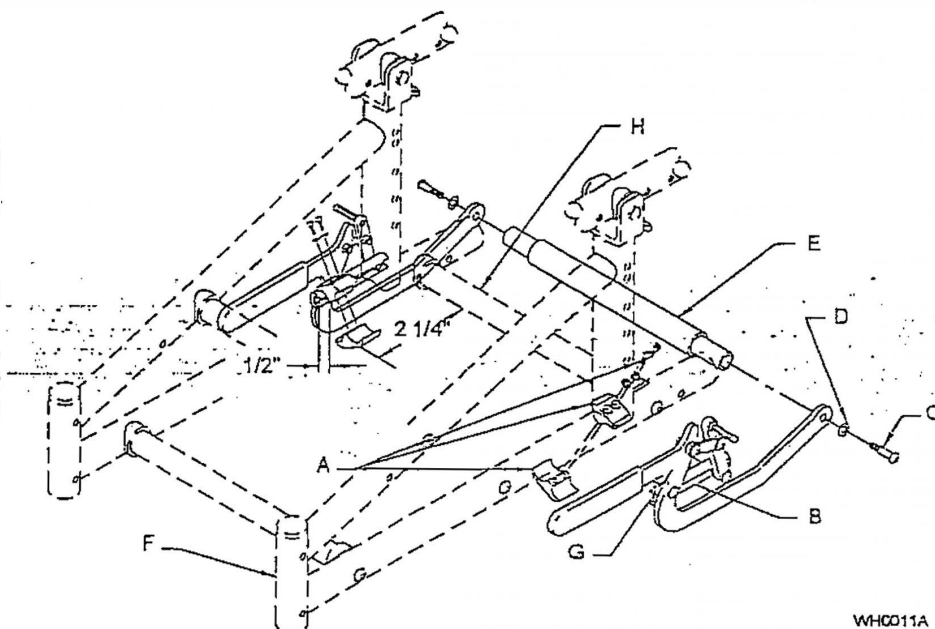

WHC011A

1. Mount brake clamp assembly (A) to the Zippie TS frame (F) just in front of the rear upright. Do not tighten the 1/4-28 x 1" SHCS bolts until step 4.
2. Slide the left and right footlock assemblies (B) into the clamp assemblies (A) with the foam covered lever end toward the front of the chair as shown.
3. Align the footlock/clamp assemblies (A, B) to lock onto the wheels equally and firmly. (Setting: adjust clamps on frame tube to be 2-1/4" forward of the rear frame strut tube (H); adjust footlock (B) to position the slide block (G) to extend 1/2" in front of the clamp assembly (A). See settings as referenced in drawing above.)
4. Lightly tighten the clamp assembly (A) adjusting the footlock assembly (B) to be vertical.
5. Assemble the footlock tube w/foam (E) to the footlock assemblies (B) with the 1/4-20 x 1" BHCS w/ patch (C) and 1/4 washer (D) as shown. Tighten to 85-100 inch-lbs.
6. Adjust the assembly (A-E) to actuate evenly and equally onto the wheels. Note that excessive wheel lock engagement or a loose foot tube (E) assembly will cause uneven actuation and prevent the wheel locks from engaging/locking on both sides when using hand lever actuation. Should the wheel locks be set up with excessive wheel engagement, both hand levers should be set to ensure locking.
7. The final step is to tighten the clamp assembly (A) to 85 inch-lbs.

FOR DEALER USE Installed by: _____ Date: _____ (retain as record of installation)
Chair Model: _____ Serial Number: _____