

Flip Dynamic Back - Growth

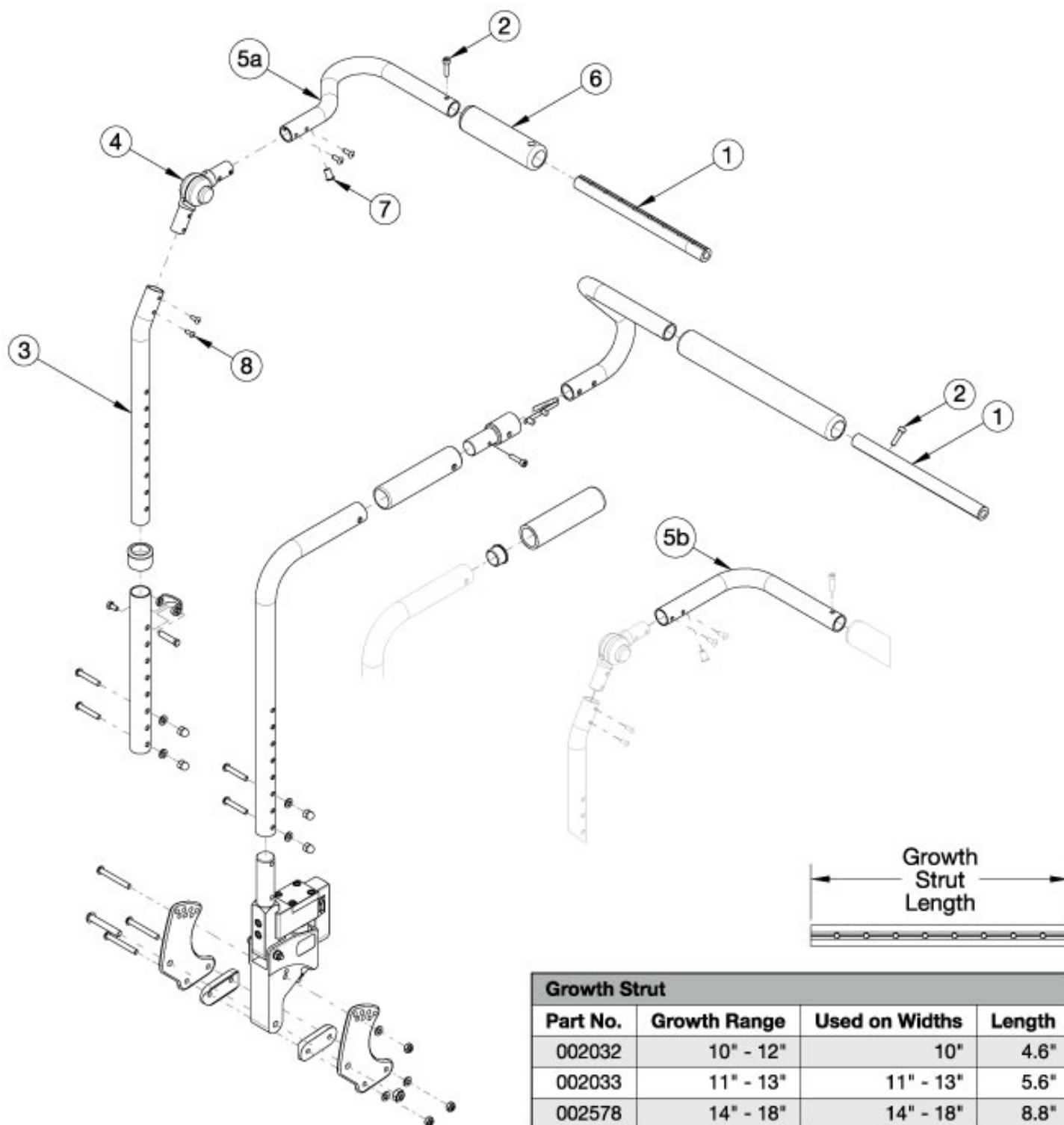

Has your width changed? Will the push handle (#5) and growth strut accommodate your new width? If no, please select the appropriate upper back tube assemblies and growth strut.

| Item Number | Part Number | Description | Quantity |
|--------------------|-------------|--|----------|
| 1a | 002032 | Growth Strut, Stroller, 10-12 <i>Used on 10" chair width</i> | 1 |
| 1b | 002033 | Growth Strut, Stroller, 11-13 <i>Used on 11" - 13" chair widths</i> | 1 |
| 1c | 002578 | Growth Strut, Stroller, Short <i>Used on 14" - 18" chair widths</i> | 1 |
| 2 | 101843 | M5 x 20 SHCS Blk Zn | 2 |
| 3a, 4, 5a, 6, 7, 8 | 504360 | Upper Back Tube Assembly Height Adj, Right Flip <i>Used on 10" - 13" chair widths</i> | 1 |
| 3b, 4, 5a, 6, 7, 8 | 504361 | Upper Back Tube Assembly Height Adj, Left Flip <i>Used on 10" - 13" chair widths</i> | 1 |
| 3a, 4, 5b, 6, 7, 8 | 502665 | Upper Back Tube Assembly Height Adj, Right Focus/Flip <i>Used on 14" - 18" wide with serial numbers prior to FLP010784 and serial numbers starting with FLP011080</i> | 1 |
| 3b, 4, 5b, 6, 7, 8 | 502666 | Upper Back Tube Assembly Height Adj, Left Focus/Flip <i>Used on 14" - 18" wide with serial numbers prior to FLP010784 and serial numbers starting with FLP011080</i> | 1 |