



SEDEO PRO SEAT LIFT ACTUATOR REPLACEMENT INSTRUCTION SHEET



Please read these instructions carefully before beginning the installation. Failure to understand and follow installation instructions may result in injury to installer and/or end user and may void the warranty. If you have any questions call Sunrise Medical Technical Support at 800-333-4000.

Actuator parts:

1. 1 ea Front pivot bolt (B)
2. 1 ea Rear pivot bolt (A)
3. 4 ea Split bushing (D)
4. 1 ea E-clip (C)
5. 1 ea Actuator

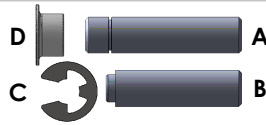

Required tools:

1. 3mm hex key
2. 5mm hex key
3. Pliers
4. Torque wrench

A. REMOVE ACTUATOR:

1. Unplug both the six pin Molex connector (Fig 2), located just to the lower rear of the lift actuator and the four pin bus connector (Fig 3), going from the upper back, down toward the rear of the lift module.
2. Remove the 4 seat screws holding the seat to the adapter and remove the seat (Fig 1). (Use 5mm hex key) **NOTE:** before removing the seat, mark the mounting hole locations for the seat and adapters.
3. Remove the 4 adapter plate screws from the lift module and again, mark the hole locations before removing adapter plates from the lift module (Fig 1). (Use 5mm hex key)

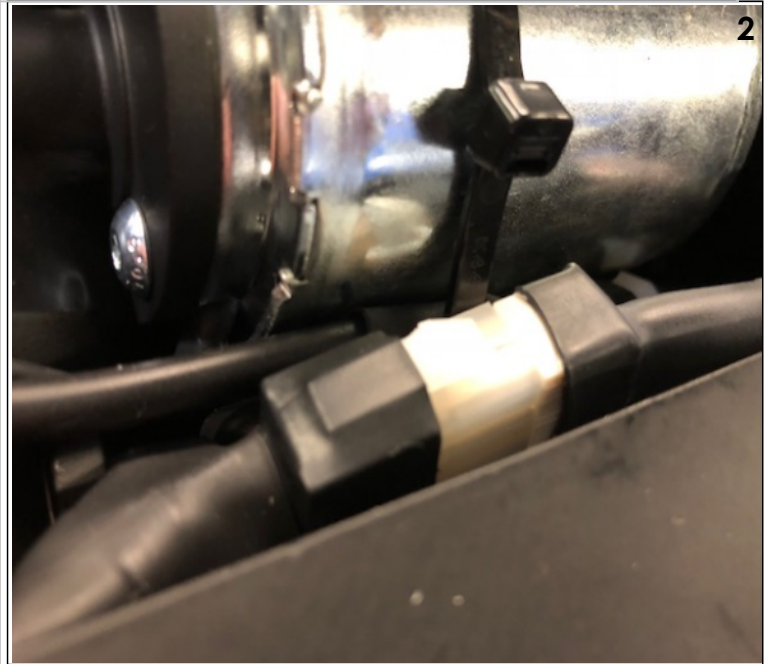
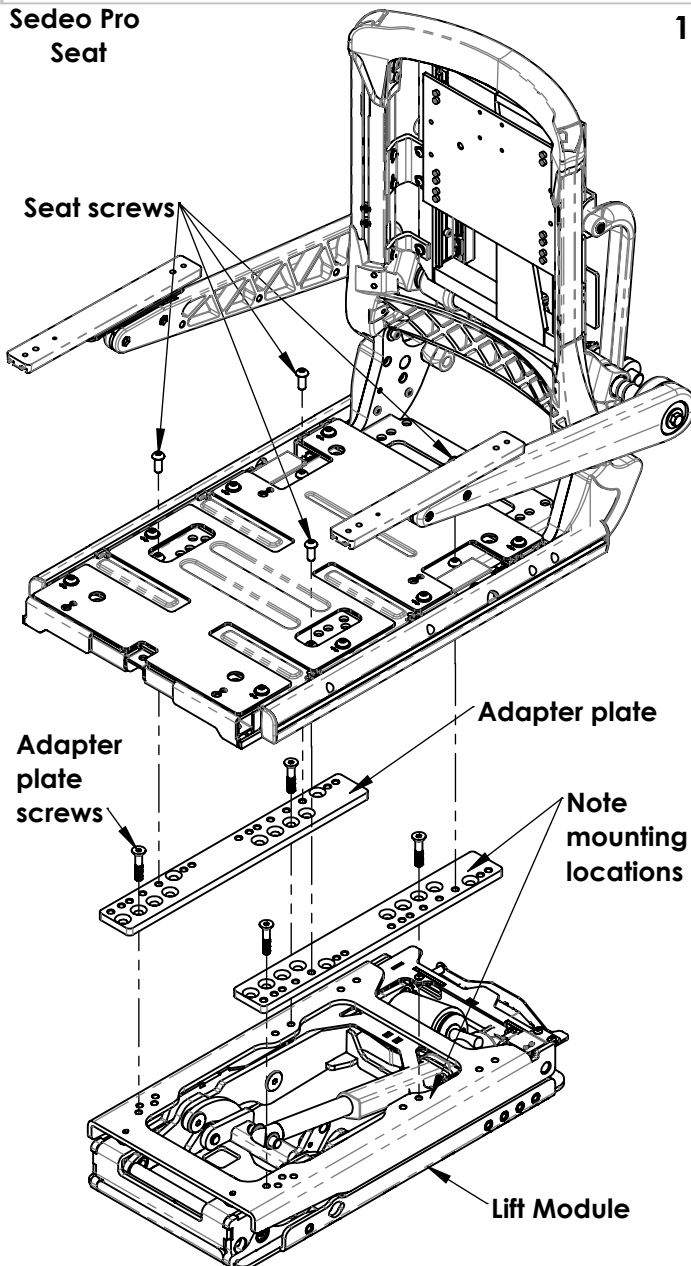

A. REMOVE ACTUATOR (Continued):

4. Remove the front pivot bolt(B)(Fig 6), by removing the cradle(Fig 7). (Use 3mm hex key) Discard front pivot bolt but save the cradle. Then add a wood block inside the scissor mechanism of the module to prevent it from collapsing downward.
5. Remove E-clip (C) from the rear pivot bolt (A) using pliers (Fig 5). Then remove the pivot bolt and discard.
6. Remove the actuator from the lift module. If under warranty, return to Sunrise Medical. Otherwise discard actuator.

B. INSTALL NEW ACTUATOR

1. Install new actuator into the lift module. NOTE: use new mounting hardware included with actuator.
2. Slide rear pivot bolt(A) into rear module mount and install E-clip(C) (Fig 5).
3. Install front of actuator into front of module. Install cradle and secure with rear pivot bolt(B).(Fig 7) (Use 3mm hex key) Torque to 27-32 in-lbs
4. Plug the harness back into the Molex plug & Bus connector to verify the lift module works. Then unplug.
5. Reinstall adapter plates to module and seat to adapter plates. Use the hardware saved from Steps 2 & 3 in Section A and (Fig 1). Note mounting hole locations marked from Steps 2 & 3 in Section A. Torque to 60-70 in-lbs (Use 5mm hex key)
6. Plug harness back into Molex plug and Bus connector. Refer back to (Fig 2 & 3)



C. INSPECT:

1. All torque values with a torque wrench.
2. Seating system to ensure all wire harnesses are out of the way and are not getting pinched.
3. Seating system to verify that the harnesses are not put under tension in any position.
4. Ensure that the cable-ties are not so tight that they deform cable jackets.
5. Where possible cables should be protected and hidden by shrouds.



DEALER/TECHNICIAN WARNING



WARNING

Attention dealers and qualified technicians, do not operate or service this device without first reading the owners manual. If you do not understand the instructions and warnings in the owners manual please contact the Quickie Technical Service Department before operating and/or servicing the Quickie device. Failure to do so may result in damage and/or injury.

Find more information and important warnings see the wheelchair owner's manual or at: www.Sunrisemedical.com.

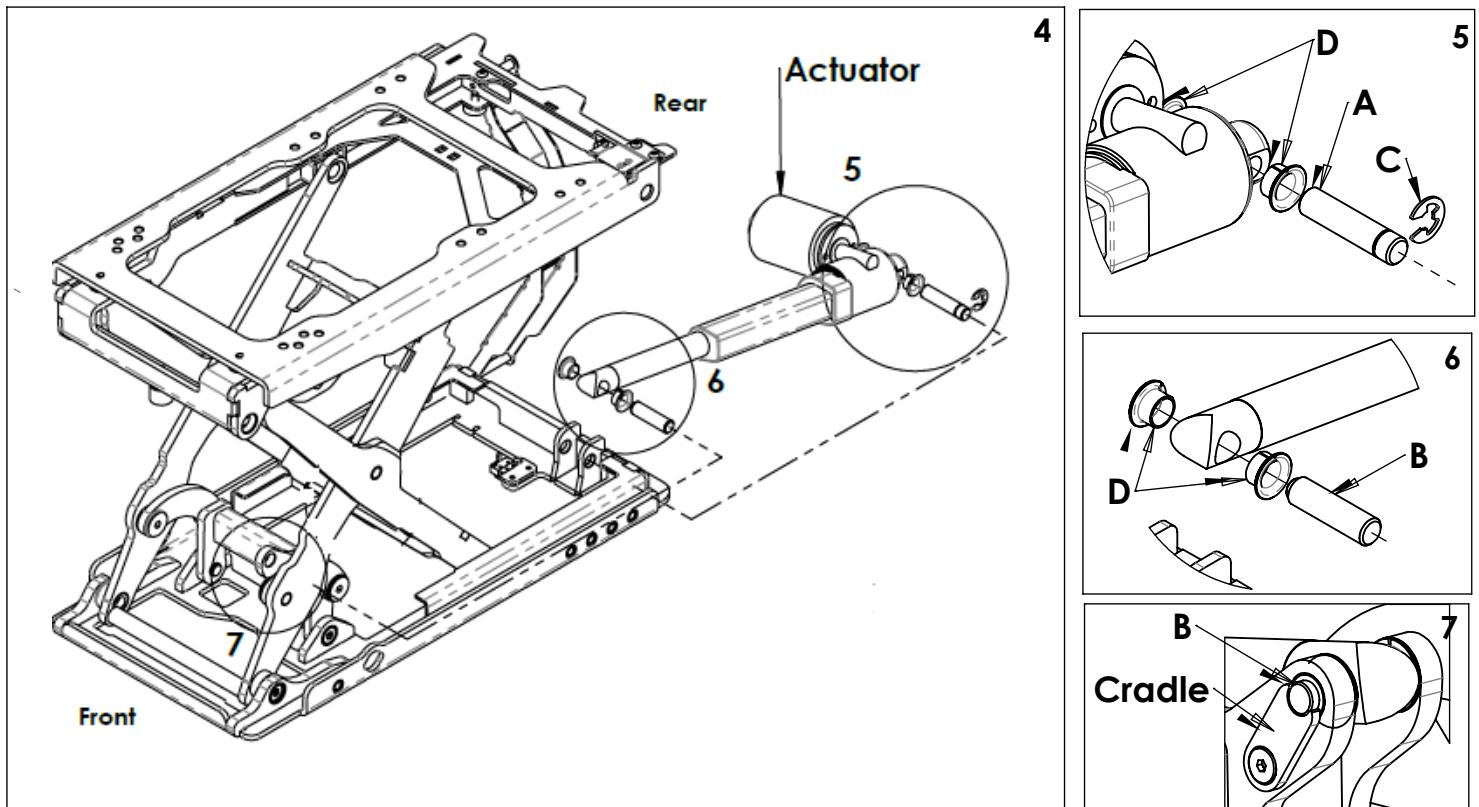

Sunrise Medical 2842 N. Business Park Ave Fresno, CA 93727 USA
In Canada (800) 263-3390