



SEAT DEPTH ADJUSTMENT W/ARMREST LINKAGE



Please read these instructions carefully before beginning the assembly. Failure to understand and follow assembly instructions may result in injury to technician and/or end user and may void the warranty. If you have any questions call Sunrise Medical Technical Support at +1 (800) 333-4000.

Required tools:

1. 5mm hex key
2. Torque wrench

A. Seat Depth/Armrest Linkage Adjustment:

1. With a 5mm hex key, remove the two armrest linkage screws (Fig. 2) and the four screws (2 per side) holding the Shift Pieces inside the Double Tilt Module. (Fig. 3) Save hardware.
2. Adjust the Backrest Assembly by sliding the Shift Pieces to your desired depth. Note the numbers on the Shift Pieces and adjust the Armrest Linkage numbers to match. (Fig. 1 & 4)
3. Reinstall the two saved armrest linkage screws. (Fig. 2) Torque to 97.6-119.3 Nm [72-88 in-lbs].
4. Reinstall the four saved screws (2 per side) holding the Shift Pieces inside the Double Tilt Module. (Fig. 3) Torque to 81.3-94.9 Nm [60-70 in-lbs].

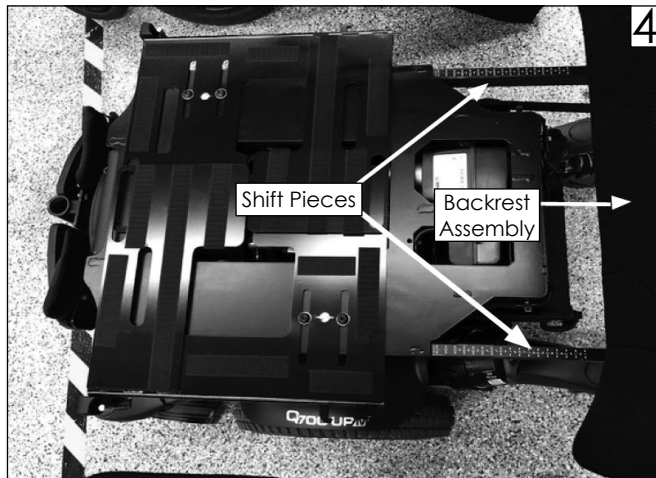
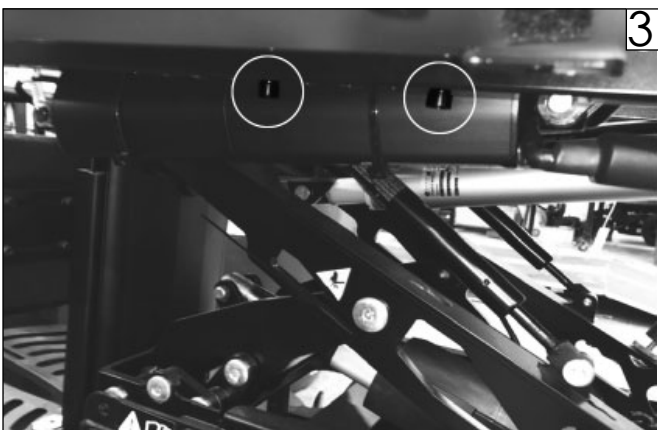
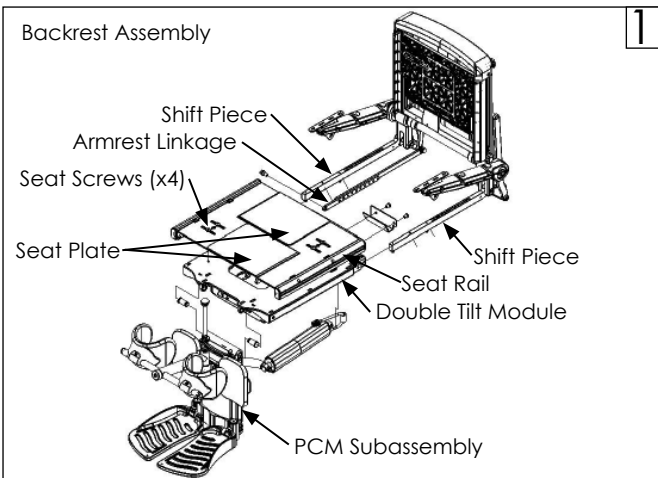

B. Inspect

1. All torque values with a torque wrench.
2. Seating system to ensure all wire harnesses are out of the way and are not getting pinched.
3. Seating system to verify that the harnesses are not put under tension in any position.
4. Ensure that the cable-ties are not so tight that they deform cable jackets.
5. Where possible cables should be protected and hidden by shrouds.

DEALER/TECHNICIAN WARNING

Attention dealers and qualified technicians, do not operate or service this device without first reading the owners manual. If you do not understand the instructions and warnings in the owners manual please contact the Quickie Technical Service Department before operating and/or servicing the Quickie device. Failure to do so may result in damage and/or injury.

Find more information and important warnings in the wheelchair owner's manual or at: www.SunriseMedical.com.

Sunrise Medical 2842 N. Business Park Ave Fresno, CA 93727 USA In Canada: (800) 263-3390



**Customer Service: +1(800) 333-4000
or visit www.SunriseMedical.com**

© 2022 Sunrise Medical (US) LLC
03/2022 249977 Rev. B