

# Flip for x:panda Tilt Mechanism

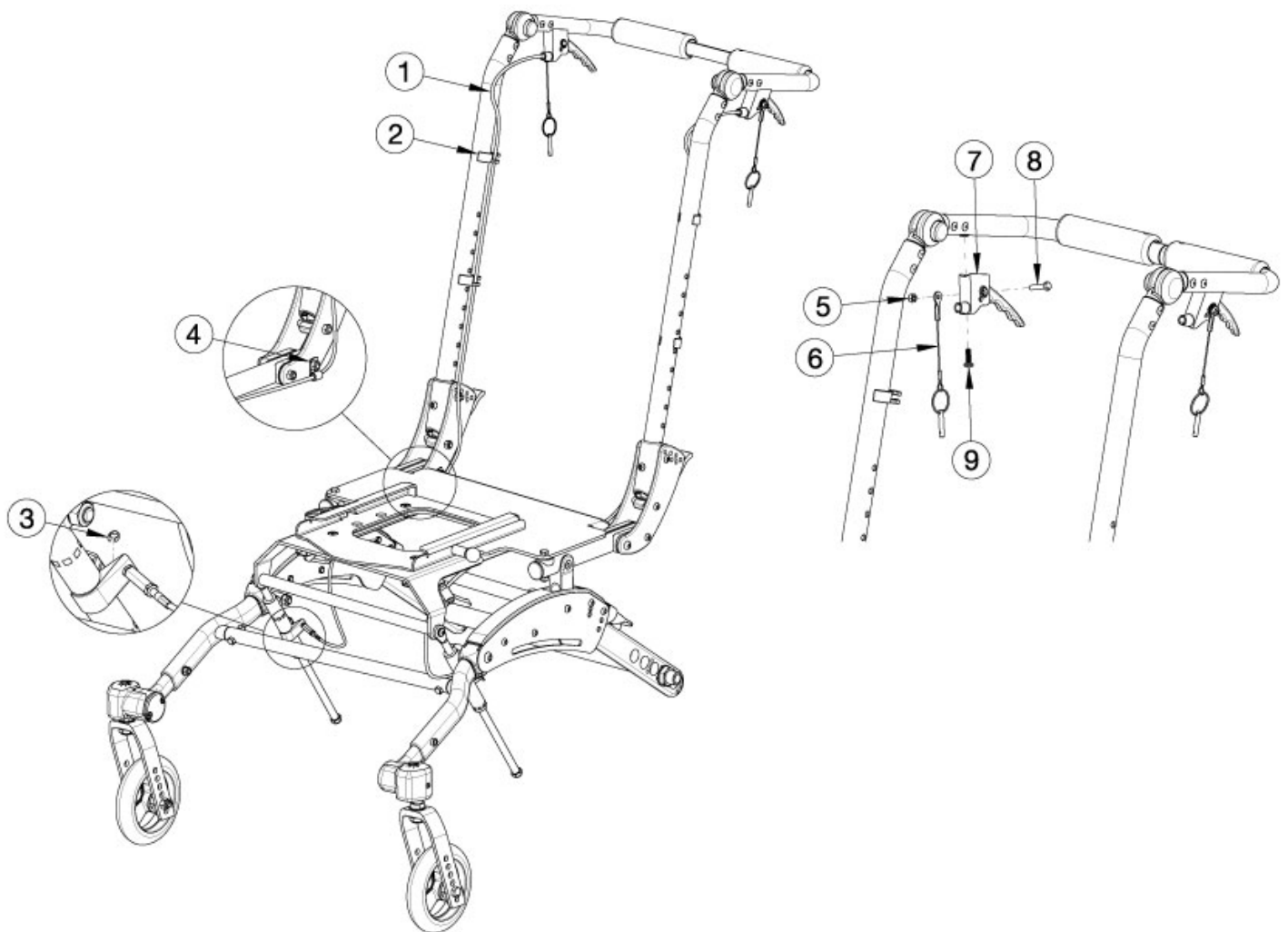

| Item Number | Part Number | Description   | Quantity |
|-------------|-------------|---|----------|
| 1a, 2 - 9   | 111267      | Hand Tilt Kit, Fixed Height with Adjustable Handle, Short, Flip for Leckey                              | 2        |
| 1b, 2 - 9   | 111268      | Hand Tilt Kit, Fixed Height with Adjustable Handle, Tall, Flip for Leckey                               | 2        |
| 5 - 9       | 501112      | Trigger Assembly Horizontal Tilt  | 1        |
| 1a, 3       | 502832      | Cable, Hand Tilt, Long FLIP<br><i>Used with short fixed height with adjustable handle backrest</i>      | 2        |
| 1b, 3       | 502833      | Cable, Hand Tilt, Extra Long FLIP<br><i>Used with tall fixed height with adjustable handle backrest</i> | 2        |
| 2           | 001117      | Cable Clip 1"   | 4        |
| 3           | 102822      | E-Ring, M6, YZ  | 2        |

| <b>Item Number</b> | <b>Part Number</b> | <b>Description</b>                   | <b>Quantity</b> |
|--------------------|--------------------|--------------------------------------|-----------------|
| 4                  | 001239             | P-Clip 3/16"                         | 2               |
| 5                  | 100657             | M5 Nylock Nut Blk Zn                 | 2               |
| 6                  | 001124             | Pin with Lanyard                     | 2               |
| 7                  | 111270             | Horizontal Trigger Mount, No Lockout | 2               |
| 8                  | 101820             | M5 x 22 HHCS Blk Zn                  | 2               |
| 9                  | 100734             | M5 x 16 PHMS ZC                      | 2               |