

Spark Universal Axle Plate

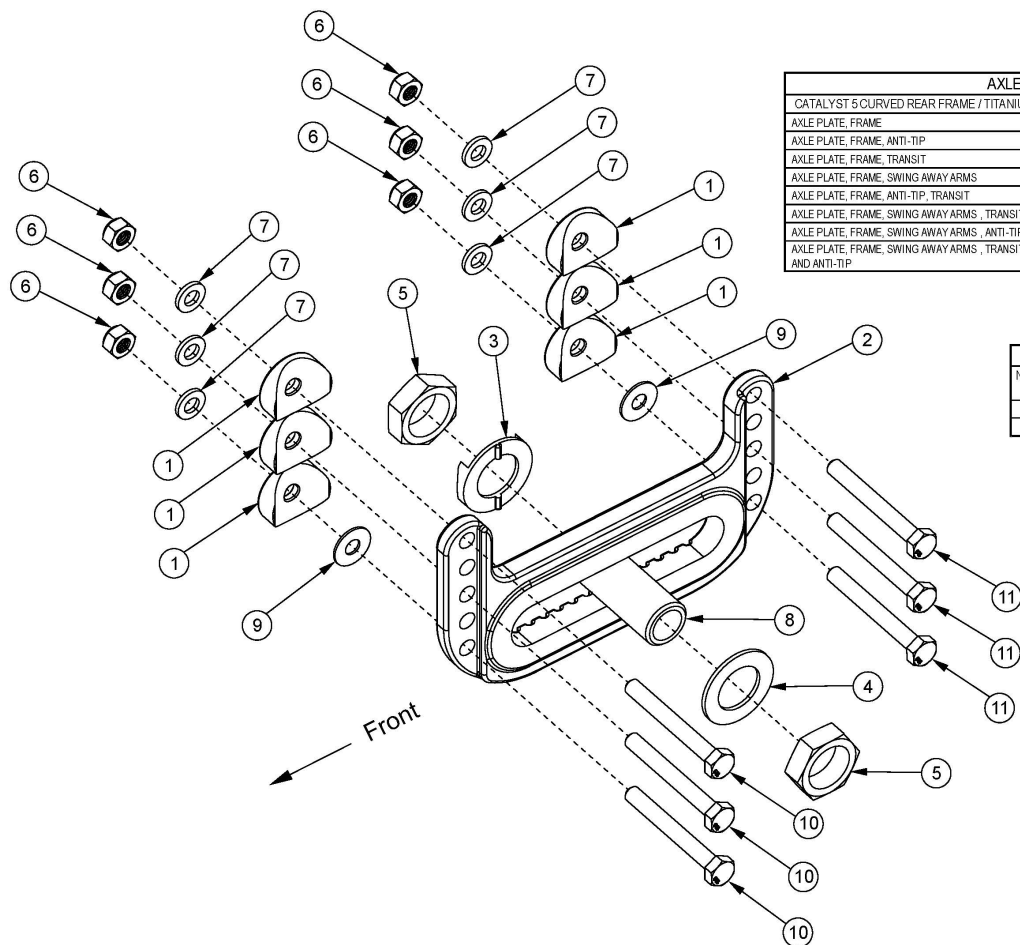

AXLE PLATE BOLT SELECTION GUIDE			
CATALYST 5 CURVED REAR FRAME / TITANIUM FRAME		DEPTH ADJUSTABLE REAR FRAME	
AXLE PLATE, FRAME	10067 4	AXLE PLATE, FRAME	10068 1
AXLE PLATE, FRAME, ANTI-TIP	10182 6	AXLE PLATE, FRAME, ANTI-TIP	10067 4
AXLE PLATE, FRAME, TRANSIT	10182 6	AXLE PLATE, FRAME, TRANSIT	10182 6
AXLE PLATE, FRAME, SWING AWAY ARMS	10182 6	AXLE PLATE, FRAME, SWING AWAY ARMS	10182 6
AXLE PLATE, FRAME, ANTI-TIP, TRANSIT	10067 7	AXLE PLATE, FRAME, ANTI-TIP, TRANSIT	10067 6
AXLE PLATE, FRAME, SWING AWAY ARMS, TRANSIT	10067 7	AXLE PLATE, FRAME, SWING AWAY ARMS, TRANSIT	10067 6
AXLE PLATE, FRAME, SWING AWAY ARMS, ANTI-TIP	10067 7	AXLE PLATE, FRAME, SWING AWAY ARMS, ANTI-TIP	10067 6
AXLE PLATE, FRAME, SWING AWAY ARMS, TRANSIT AND ANTI-TIP	10067 9	AXLE PLATE, FRAME, SWING AWAY ARMS, TRANSIT AND ANTI-TIP	10067 9

6 Screw (Bolt) Configuration	
Number of washers (Item 9) per bottom screw	Degrees of Camber
3 (6 total)	2°
5 (10 total)	4°

If chair was invoiced prior to November 14, 2018 and retrofitting to the universal axle plate and anti-tips are present, new anti-tip receivers are required.

Item Number	Part Number	Description	Quantity
1, 2, 6, 7, 10b, 11a, 11c, 11d, 11e, 12	107415	Universal Axle Plate, Black Anodized with Hardware Kit, Depth Adjustable Rear Frame	1
1, 2, 6, 7, 10b, 11a, 11c, 11d, 11e, 12	107416_ _ _	Color Anodized/Color Accent Universal Axle Plate with Hardware Kit, Depth Adjustable Rear Frame	1
1, 6, 7, 10a, 10b, 11a-11e, 12	107419	Universal Axle Plate Hardware Kit (One Side) <i>Contains hardware for curved, titanium and depth adjustable rear frames</i>	1
2, 3-5, 8a	107412	Universal Axle Plate Assembly 1/2", Black Anodized <i>Used with Quad Quick Release Axles</i>	1
2, 3-5, 8b	117322	Universal Axle Plate Assembly 2.5", Black Anodized <i>Used with Quick Release and Fixed Axles</i>	1

Item Number	Part Number	Description	Quantity
2, 3-5, 8b	117323_ _ _	Color Anodized/Color Accent Universal Axle Plate Assembly 2.5"	1
3-5, 8a	500504	Axle Receiver Assembly 1/2" <i>Used with Quad Quick Release Axles</i>	1
3-5, 8b	117325	Axle Receiver Assembly 2.5" <i>Used with Quick Release and Fixed Axles</i>	1
1	000055	Saddle 1" <i>Used with Transit or Swing Away Arm Bracket</i>	6
2	107417	Universal Axle Plate, Black Anodized with Instruction	1
2	107418_ _ _	Color Anodized/Color Accent Universal Axle Plate with Instruction	1
3	004444	Axle Plate Index Washer	1
4	004445	Axle Plate Flat Washer	1
5	100514	Axle Receiver Nut M18 x D12 x 8mm	2
6	100658	M6 Nylock Nut Blk Zn	6
7	100746	M6 Flat Washer Blk Zn	6
8a	100756	Axle Receiver 1/2" Diameter <i>Used with Quad Quick Release Axles</i>	1
8b	114480	Axle Receiver, 2.5" Length <i>Used with Quick Release and Fixed Axles</i>	1
9	100763	Washer #12 Thin	10
10a	100674	M6 x 45 CLS10.9 DIN931 HHCS ZC	6
10b	100681	M6 x 40 CLS8.8 DIN931 HHCS ZC	6
11a	101826	M6 x 50 HHCS Blk Zn	6
11b	100677	M6 x 60 CLS10.9 DIN931 HHCS ZC	6
11c	100679	M6 x 65 CLS 8.8 DIN931 HHCS ZC	6
11d	100676	M6 x 55 CLS10.9 DIN931 HHCS ZC	6
11e	100674	M6 x 45 CLS10.9 DIN931 HHCS ZC	6

Wheel Size / Tire Profile / Rear Seat Height

Select Rear Seat Height in row corresponding to Wheel Size and Tire Profile. 14" Seat Depth not available with 24", 25" or 26" Rear Wheels.

Requires curved axle plate Any axle plate can be used (Curved, Standard, Amputee, One Arm Drive)

Wheel Size	Tire Profile	Rear Seat Height									
20"	Low	<input type="radio"/> 11.5	<input type="checkbox"/> 12 ¹	<input type="radio"/> 12.5	<input type="checkbox"/> 13 ¹	<input type="radio"/> 13.5	<input type="checkbox"/> 14	<input type="radio"/> 14.5	<input type="checkbox"/> 15	<input type="radio"/> 15.5	<input type="radio"/> 16
	Full	<input type="radio"/> 12	<input type="checkbox"/> 12.5 ¹	<input type="radio"/> 13	<input type="checkbox"/> 13.5 ¹	<input type="radio"/> 14	<input type="checkbox"/> 14.5	<input type="radio"/> 15	<input type="checkbox"/> 15.5	<input type="radio"/> 16	<input type="radio"/> 16.5
22"	Low	<input type="radio"/> 12.5	<input type="checkbox"/> 13 ¹	<input type="radio"/> 13.5	<input type="checkbox"/> 14 ¹	<input type="radio"/> 14.5	<input type="checkbox"/> 15	<input type="radio"/> 15.5	<input type="checkbox"/> 16	<input type="radio"/> 16.5	<input type="radio"/> 17
	Full	<input type="radio"/> 13	<input type="checkbox"/> 13.5 ¹	<input type="radio"/> 14	<input type="checkbox"/> 14.5 ¹	<input type="radio"/> 15	<input type="checkbox"/> 15.5	<input type="radio"/> 16	<input type="checkbox"/> 16.5	<input type="radio"/> 17	<input type="radio"/> 17.5
24"	Low	<input type="radio"/> 13.5	<input type="checkbox"/> 14 ¹	<input type="radio"/> 14.5	<input type="checkbox"/> 15 ¹	<input type="radio"/> 15.5	<input type="checkbox"/> 16	<input type="radio"/> 16.5	<input type="checkbox"/> 17	<input type="radio"/> 17.5	<input type="radio"/> 18
	Full	<input type="radio"/> 14	<input type="checkbox"/> 14.5 ¹	<input type="radio"/> 15	<input type="checkbox"/> 15.5 ¹	<input type="radio"/> 16	<input type="checkbox"/> 16.5	<input type="radio"/> 17	<input type="checkbox"/> 17.5	<input type="radio"/> 18	<input type="radio"/> 18.5
25"	Low	<input type="radio"/> 14	<input type="checkbox"/> 14.5 ¹	<input type="radio"/> 15	<input type="checkbox"/> 15.5 ¹	<input type="radio"/> 16	<input type="checkbox"/> 16.5	<input type="radio"/> 17	<input type="checkbox"/> 17.5	<input type="radio"/> 18	<input type="radio"/> 18.5
26"	Low	<input type="radio"/> 14.5	<input type="checkbox"/> 15 ¹	<input type="radio"/> 15.5	<input type="checkbox"/> 16 ¹	<input type="radio"/> 16.5	<input type="checkbox"/> 17	<input type="radio"/> 17.5	<input type="checkbox"/> 18	<input type="radio"/> 18.5	<input type="radio"/> 19
	Full	<input type="radio"/> 15	<input type="checkbox"/> 15.5 ¹	<input type="radio"/> 16	<input type="checkbox"/> 16.5 ¹	<input type="radio"/> 17	<input type="checkbox"/> 17.5	<input type="radio"/> 18	<input type="checkbox"/> 18.5	<input type="radio"/> 19	<input type="radio"/> 19.5

¹ Not available with Amputee Axle Plate