

## Canada Catalyst 4 Transit

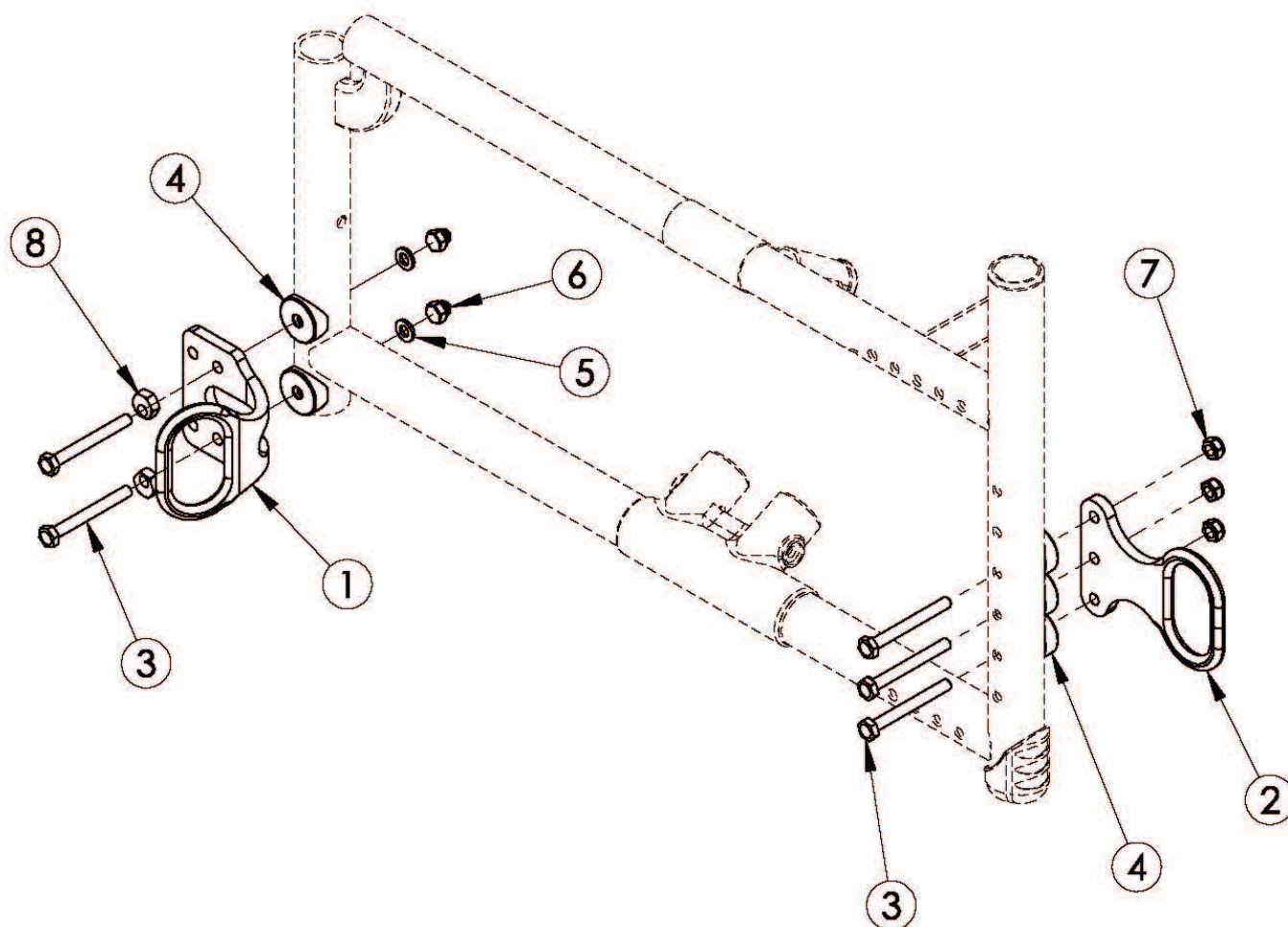

*Notice: Chair configuration review required prior to parts being quoted or ordered. Only available in Canada on Catalyst 4. Not available on Catalyst 4C Not available with 250 lb or 350 lb weight capacity Requires Adjustable Axle Plate and Adjustable Axle Plate Rear Frames*

| Item Number | Part Number | Description  | Quantity |
|-------------|-------------|--|----------|
| 1 - 8       | 111310      | Transit Bracket Retrofit Kit for Adjustable Axle Plate, Catalyst 4   | 1        |
| 3a          | 101826      | M6 x 50 HHCS Blk Zn<br><i>Use quantity 2 if only Transit is present; Use quantity 1 if Transit and Anti-Tip bracket are present</i>  | 4        |
| 3b          | 100676      | M6 x 55 CLS10.9 DIN931 HHCS ZC<br><i>Use quantity 2 if Transit and Anti-Tip bracket are present. Use quantity 1 if Swing Away Arm bracket, Transit, and Anti-Tip bracket are present</i> | 4        |

| Item Number | Part Number | Description   | Quantity |
|-------------|-------------|---|----------|
| 3c          | 100677      | M6 x 60 CLS10.9 DIN931 HHCS ZC<br><i>Used to attach Front Transit Bracket. Use quantity 2 if Transit, Anti-Tip bracket and Swing Away Arm bracket are present</i> | 4        |
| 4           | 000056      | Saddle 1 1/8"   | 10       |
| 5           | 100746      | M6 Flat Washer Blk Zn   | 4        |
| 6           | 100558      | M6 Nyl Ins Domed Cap L/N Zc   | 4        |
| 7           | 100658      | M6 Nylock Nut Blk Zn  | 6        |
| 8           | 100510      | Eccentric Washer  | 4        |