

(Discontinued) Catalyst Aluminum Seat Pan

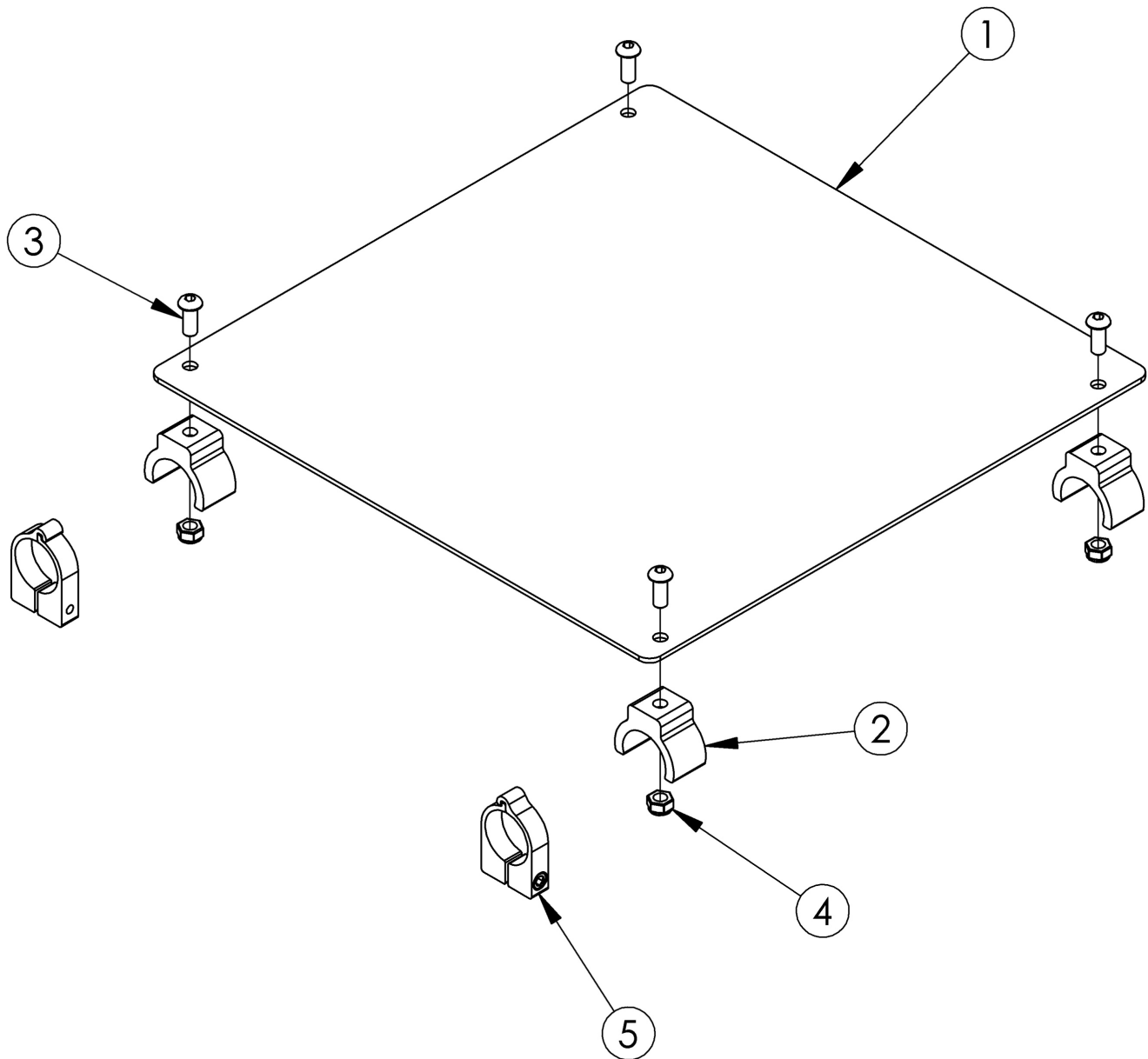

This seat pan was used if Transit is not present on the chair. See Spark / Catalyst Aluminum Seat Pan page.

Item Number	Part Number	Description	Quantity
1h	002110	Seat Pan Cat/ Spark 10 x 17 <i>Replaced with 506016</i>	1
1i	002111	Seat Pan Cat/ Spark 10 x 18 <i>Replaced with 506017</i>	1
1o	001524	Seat Pan Cat/ Spark 11 x 15	1

Item Number	Part Number	Description	Quantity
		<i>Replaced with 506023</i>	
1q	002112	Seat Pan Cat/ Spark 11 x 17 <i>Replaced with 506025</i>	1
1r	002113	Seat Pan Cat/ Spark 11 x 18 <i>Replaced with 506026</i>	1
1u	001528	Seat Pan Cat/ Spark 12 x 12 <i>Replaced with 506029</i>	1
1ao	001548	Seat Pan Cat/ Spark 14 x 14 <i>Replaced with 505780</i>	1
1bp	001575	Seat Pan Cat/ Spark 16 x 19 <i>Replaced with 505799</i>	1
1ce	001590	Seat Pan Cat/ Spark 18 x 16 <i>Replaced with 505814</i>	1
1cl	002114	Seat Pan Cat/ Spark 19 x 14 <i>Replaced with 505821</i>	1
1cu	002115	Seat Pan Cat/ Spark 20 x 14 <i>Replaced with 505830</i>	1
1dd	002116	Seat Pan Cat/ Spark 21 x 14 <i>Replaced with 505839</i>	1
1de	002117	Seat Pan Cat/ Spark 21 x 15 <i>Replaced with 505840</i>	1
1dm	002118	Seat Pan Cat/ Spark 22 x 14 <i>Replaced with 505848</i>	1
1dn	002119	Seat Pan Cat/ Spark 22 x 15 <i>Replaced with 505849</i>	1
2	000990	Seat Pan Clip CAT	4
3	100667	M6 x 12 BTN SHCS BLKZC w/Patch	4
4	100658	M6 Nylock Nut Blk Zn	4
5	102856	Seat Pan Stop Collar	2