

Focus CR Seating Dynamics Rocker Back

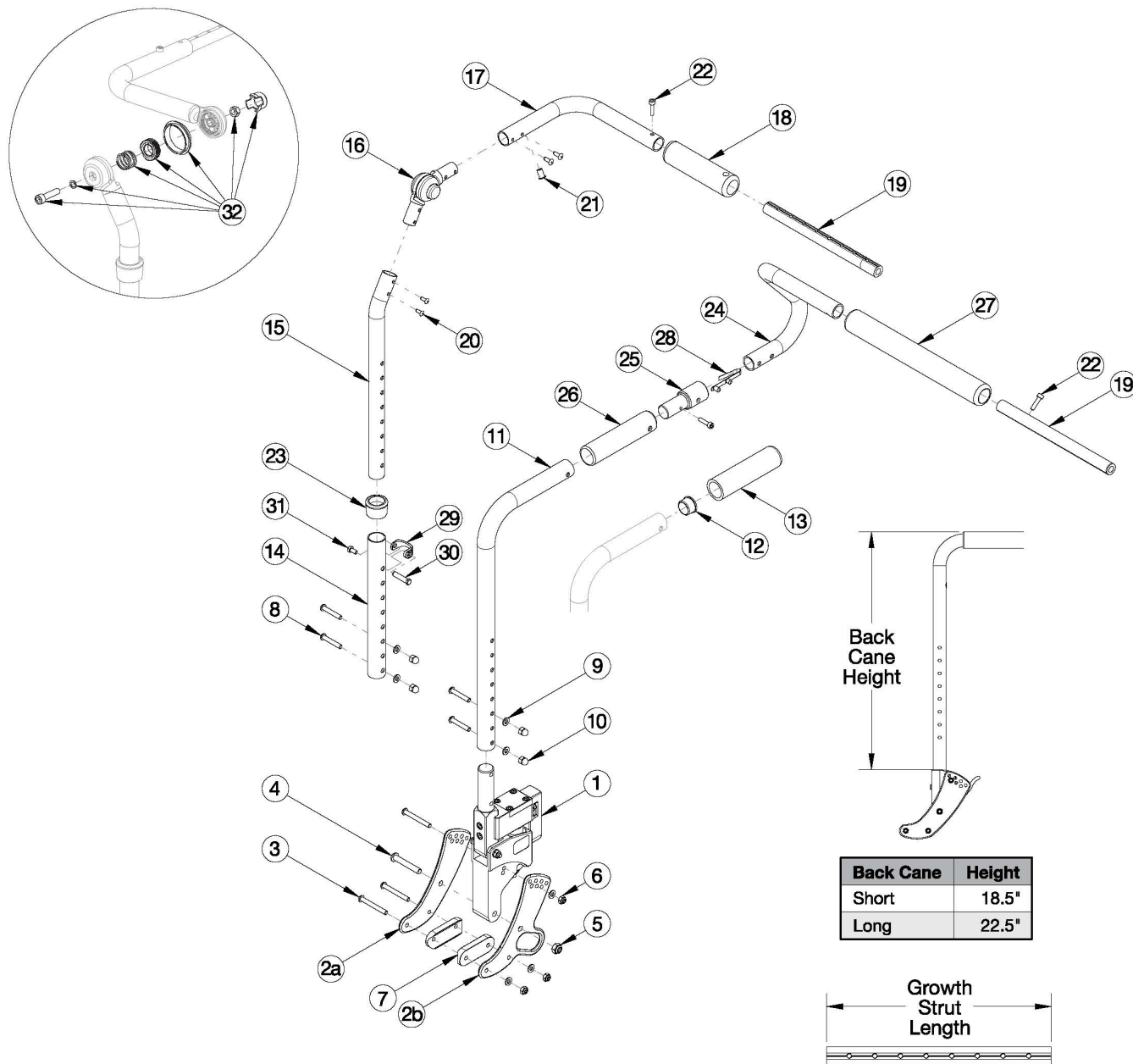

Back Cane	Height
Short	18.5"
Long	22.5"

Part No.	Growth Range	Used on Widths	Length
002578	14"-20"	14"-17"	8.75"
002579	16"-22"	18"-22"	10.75"
112003	18"-24"	23"-24"	12.75"

Used on chairs with serial numbers prior to FCR0026599 and FCHD002333, unless a foot tilt is present. If foot tilt or power tilt is present, this design effective starting with serial numbers FCR0033747 and FCHD002467. <p>

If changing from another style backrest and the hand tilt is present, a new Hand Tilt Cable/Trigger Kit may be required. <p>

If retrofitting from a foot tilt or power tilt to hand tilt and serial number is prior to FCR0033747 and FCHD002467, new back cane assemblies are required in addition to the hand tilt mechanism. <p>

Not available with Heavy Duty Option

Item Number	Part Number	Description	Quantity	Retail
11a, 12, 13	506780	Back Tube Assembly Fixed Stroller with Grip, Rocker Back Short Focus <i>If changing to a new hand tilt mechanism and serial number is prior to FCR0026599 and FCHD002333, this kit is required in addition to the hand tilt mechanism. If replacing this side back tube assembly and foot tilt or power tilt is present and serial number is prior to FCR0033747 and FCHD002467, both left and right back tube assemblies will need to be replaced.</i>	1	\$51.88
11b, 12, 13	506781	Back Tube Assembly Fixed Stroller with Grip, Rocker Back Tall Focus <i>If changing to a new hand tilt mechanism and serial number is prior to FCR0026599 and FCHD002333, this kit is required in addition to the hand tilt mechanism. If replacing this side back tube assembly and foot tilt or power tilt is present and serial number is prior to FCR0033747 and FCHD002467, both left and right back tube assemblies will need to be replaced.</i>	1	\$51.88
11a, 26	506782	Back Cane Assembly Fixed Stroller Short Focus <i>If changing to a new hand tilt mechanism and serial number is prior to FCR0026599 and FCHD002333, this kit is required in addition to the hand tilt mechanism. If replacing this side back tube assembly and foot tilt or power tilt is present and serial number is prior to FCR0033747 and FCHD002467, both left and right back tube assemblies will need to be replaced.</i>	1	\$54.14
11b, 26	506783	Back Cane Assembly Fixed Stroller Tall Focus <i>If changing to a new hand tilt mechanism and serial number is prior to FCR0026599 and FCHD002333, this kit is required in addition to the hand tilt mechanism. If replacing this side back tube assembly and foot tilt or power tilt is present and serial number is prior to FCR0033747 and FCHD002467, both left and right back tube assemblies will need to be replaced.</i>	1	\$54.14
8-10, 14, 23	502518	Height Adjustable Lower Tube Assembly, Rocker Back Tall	1	\$53.18
15a, 16, 17a, 18, 20, 21	506758	Upper Back Tube Assembly Height Adjustable, Right Focus <i>If changing to a new hand tilt mechanism and serial number is prior to FCR0026599 and FCHD002333, this kit is required in addition to the hand tilt mechanism. If replacing this side back tube assembly and foot tilt or power tilt is present and serial number is prior to FCR0033747 and FCHD002467, both left and right back tube assemblies will need to be replaced.</i>	1	\$251.82
15b, 16, 17b, 18, 20, 21	506759	Upper Back Tube Assembly Height Adjustable, Left Focus <i>If changing to a new hand tilt mechanism and serial number is prior to FCR0026599 and FCHD002333, this kit is required in addition to the hand tilt mechanism. If replacing this side back tube assembly and foot tilt or power tilt is present and serial number is prior to FCR0033747 and FCHD002467, both left and right back tube assemblies will need to be replaced.</i>	1	\$251.82
19a, 22, 23, 24a, 24b, 25, 27, 28	503104	Removable Stroller Handle Assm 14-18W Focus/Flip/Liberty	1	\$187.98
19b, 22, 23, 24a, 24b, 25, 27, 28	503105	Removable Stroller Handle Assm 18-22W Focus/Liberty	1	\$190.38
19c, 22, 23, 24a, 24b, 25, 27, 28	114288	Removable Stroller Handle Assm 23-24W Focus	1	\$192.76

Item Number	Part Number	Description	Quantity	Retail
3-7, 9	502520	Frame Attaching Hardware for Rocker Back Assembly, One Side Focus	1	\$23.45
8-10	502521	Tube Attaching Hardware for Rocker Back Assembly, One Side Focus/Flip	1	\$5.72
19a, 22	503107	Growth Strut Assembly Short, Focus/Flip	1	\$26.14
19b, 22	503108	Growth Strut Assembly Long, Flip/Focus	1	\$28.55
19c, 22	114289	Growth Strut Assembly Extra Long, Focus	1	\$31.58
1a, 2a	503217	Dynamic Rocker Back Adj Ht w/ Back Plate PAIR Focus	1	\$2,564.23
1b, 2a	503218	Dynamic Rocker Back Fixed Ht w/ Back Plate PAIR Focus	1	\$2,564.23
1a, 2a, 2b	503219	Dynamic Rocker Back Adj Ht w/ Transit Back Plate PAIR Focus	1	\$2,715.01
1b, 2a, 2b	503220	Dynamic Rocker Back Fixed Ht w/ Transit Back Plate PAIR Focus	1	\$2,715.01
3	101781	M6 x 50mm Partial Thread BHCS Blk ZC	3	\$1.58
4	101815	M8 x 50 BHCS Blk Zn	1	\$3.68
5	100659	M8 Nylock Nut Blk Zn	1	\$1.05
6	100658	M6 Nylock Nut Blk Zn	3	\$1.05
7	002594	Saddle, Dual, 1" OD X 1.75 SP	2	\$3.06
8	101811	M6 x 35 BHCS Blk Zn	2	\$1.05
9	100746	M6 Flat Washer Blk Zn	5	\$1.58
10	100558	M6 NYL INS Domed Cap L/N ZC	2	\$1.05
19a	002578	Growth Strut, Stroller, Short <i>Used on chairs 14" - 17" wide</i>	1	\$25.72
19b	002579	Growth Strut, Stroller, Long <i>Used on chairs 18" - 22" wide</i>	1	\$28.14
19c	112003	Growth Strut, Stroller, Extra Long <i>Used on chairs 23" - 24" wide</i>	1	\$30.52
22	101843	M5 x 20 SHCS Blk Zn	5	\$0.53
23	001083	Bushing Height Adjustable Back Tilt	1	\$6.98
24a, 27	501090	Stroller Handle with Foam Grip, Right	1	\$51.17
24b, 27	501091	Stroller Handle with Foam Grip, Left	1	\$51.17
25	001243	Stroller Handle Adaptor	2	\$32.37
28	100533	Detent Button	2	\$3.59

Item Number	Part Number	Description	Quantity	Retail
29	000988	Fastener Retainer	1	\$3.94
30	000987	Threaded Fastener	1	\$3.78
31	200427	M5 x 10 CLS8.8 HHCS ZC w/Patch DIN933	1	\$0.53
32	110524	Locking Hinge Button Assembly with Instruction <i>This kit contains the contents inside callout # 16. This assembly may not be compatible if chair was invoiced prior to 6/22/16</i>	1	\$36.72