

Rogue2 Caster Forks and Stems

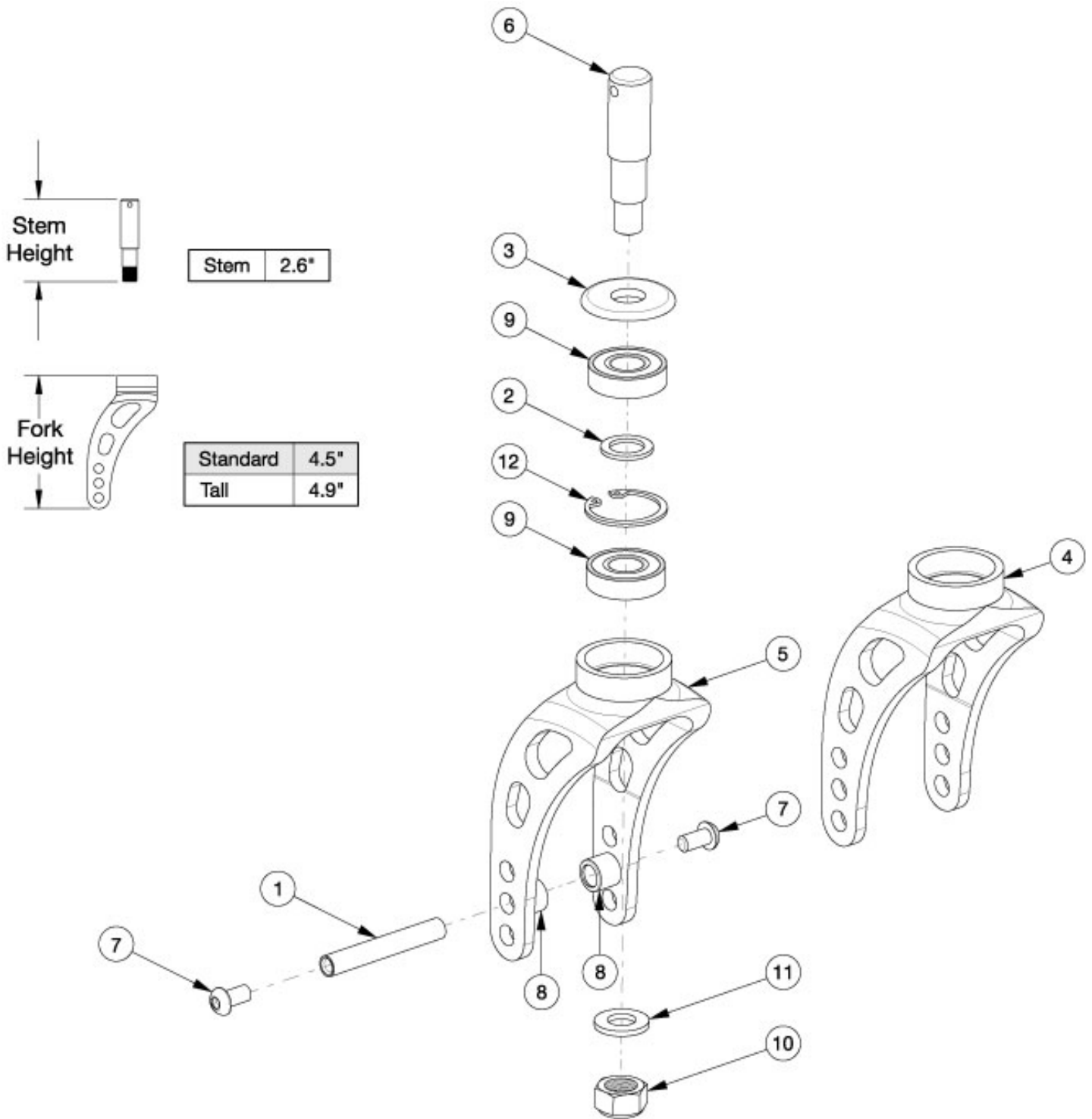

Use the standard fork when a 3-4" caster is present. Use the tall fork when a 5-6" caster is present.

Item Number	Part Number	Description	Quantity
3a, 4a, 6, 10, 11	117512	Standard Rigid Fork Streamline Assembly with Stem, Black Anodized, Rogue2	1

Item Number	Part Number	Description	Quantity
3b, 4b, 6, 10, 11	117513_ _ _	Standard Rigid Fork Streamline Assembly with Stem, Color Anodized, Rogue2	1
3a, 5a, 6, 10, 11	117514	Tall Rigid Fork Streamline Assembly with Stem, Black Anodized, Rogue2	1
3b, 5b, 6, 10, 11	117515_ _ _	Tall Rigid Fork Streamline Assembly with Stem, Color Anodized, Rogue2	1
6, 10	117516	Rigid Fork Stem (113988) with Instruction, Rogue2	1
2, 4a, 6, 9-12	004354INST	Standard Rigid Fork Streamline Assembly, Black Anodized with Instruction	1
2, 4b, 6, 9-12	004354_ _ _	Standard Rigid Fork Streamline Assembly, Color Anodized	1
2, 5a, 6, 9-12	004362INST	Tall Rigid Fork Streamline Assembly, Black Anodized with Instruction	1
2, 5b, 6, 9-12	004362_ _ _	Tall Rigid Fork Streamline Assembly, Color Anodized	1
1, 7, 8	116069	Caster Attachment Hardware Kit, Rigid	1
1	000422	M6 x 56 Threaded Barrel	1
3a	001355	Caster Bearing Cap Black Anodized	1
3b	001355_ _ _	Color Anodized Caster Bearing Cap	1
7	100667	M6 x 12 BTN SHCS BLKZC w/Patch	2
8	100792	Caster Spacer D8 x D12 x 10mm / Close Mount Handrim Spacer	2
10	101840	M10 Nylock Nut Blk Zn	1
11	101859	M10 Flat Washer Blk Zn	1

Color Anodizing Samples

