

Catalyst Caster Forks and Stems

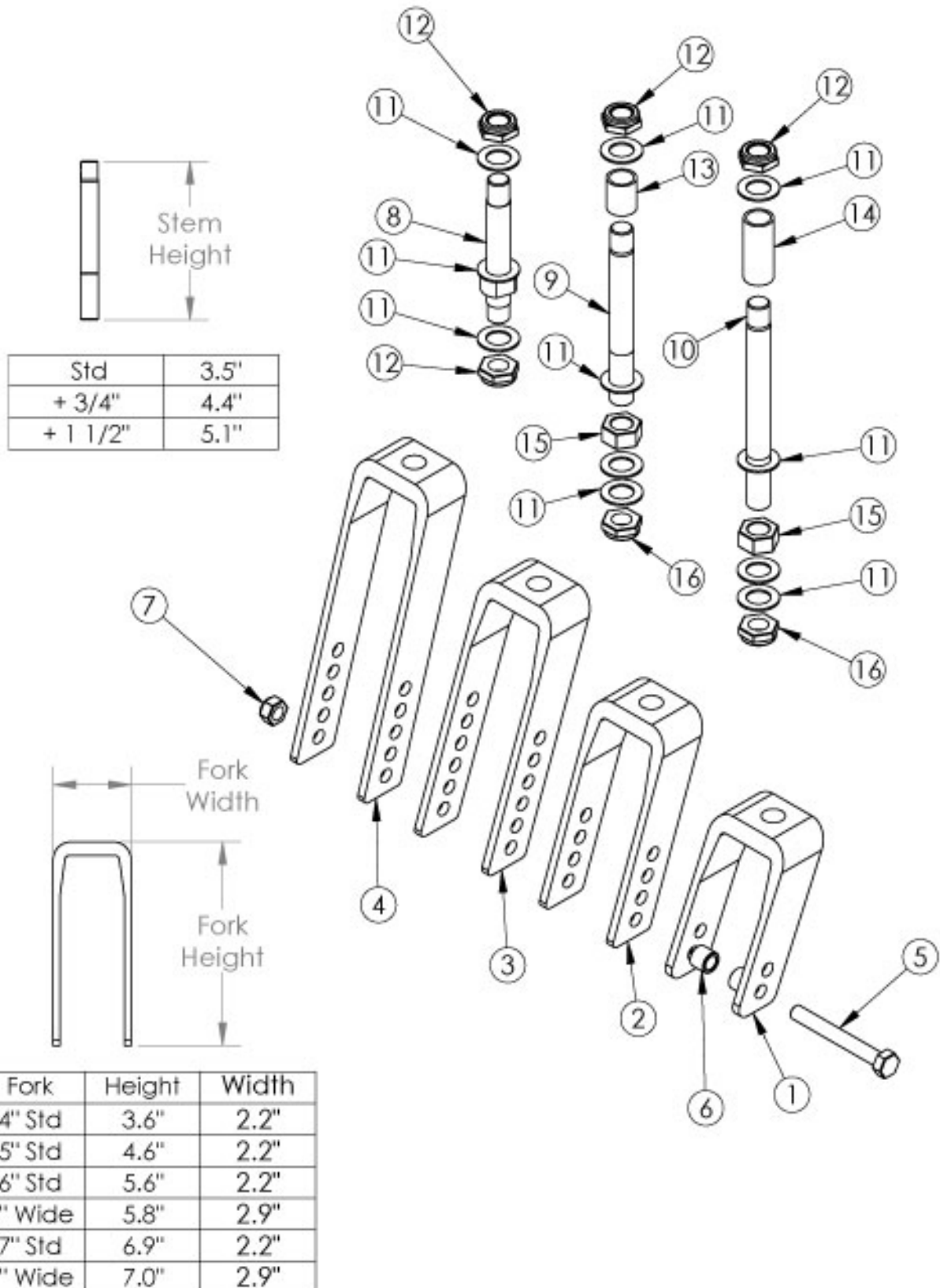

If chair is Heavy Duty (350 lbs weight capacity) and has a serial number of C40043964, C50099247, CVX0099946 or after, see Heavy Duty Catalyst Caster Forks and Stems parts manual page for replacement parts. If changing to 2" casters, wide forks and hardware needed.

Item Number	Part Number	Description	Quantity
5a, 6a, 7	502653	Caster Attachment Hardware Kit CAT/FCS	1
5b, 6b, 7	502654	Caster Attachment Hardware Kit for 6" and 7" Wide Fork, CAT/FCS	1
8, 11, 12	500866	Std Caster Stem Assembly CAT	1
9, 11, 12, 13, 15, 16	500001	+3/4 Caster Stem Assembly CAT	1
10, 11, 12, 14, 15, 16	500002	+1 1/2 Caster Stem Assembly CAT	1
1a, 8, 11, 12	500509	Fork Assembly, Black, 4" Std Stem CAT	1
1b, 8, 11, 12	500509_ _ _	Color Anodized/Color Accent Fork Assembly 4"" Std Stem CAT	1
1a, 9, 11, 12, 13, 15, 16	500510	Fork Assembly, Black, 4" +3/4" Stem CAT	1
1b, 9, 11, 12, 13, 15, 16	500510_ _ _	Color Anodized/Color Accent Fork Assembly 4"" +3/4"" Stem CAT	1
1a, 10, 11, 12, 14, 15, 16	500004	Fork Assembly, Black, 4" +1 1/2" Stem CAT	1
1b, 10, 11, 12, 14, 15, 16	500004_ _ _	Color Anodized/Color Accent Fork Assembly 4"" +1 1/2"" Stem CAT	1
2a, 8, 11, 12	500511	Fork Assembly, Black, 5" Std Stem CAT	1
2b, 8, 11, 12	500511_ _ _	Color Anodized/Color Accent Fork Assembly 5"" Std Stem CAT	1
2a, 9, 11, 12, 13, 15, 16	500005	Fork Assembly, Black, 5" +3/4 Stem CAT	1
2b, 9, 11, 12, 13, 15, 16	500005_ _ _	Color Anodized/Color Accent Fork Assembly 5"" +3/4 Stem CAT	1
2a, 10, 11, 12, 14, 15, 16	500512	Fork Assembly, Black, 5" +1 1/2" Stem CAT	1
2b, 10, 11, 12, 14, 15, 16	500512_ _ _	Color Anodized/Color Accent Fork Assembly 5"" +1 1/2"" Stem CAT	1
3a, 8, 11, 12	500006	Fork Assembly, Black, 6" Std Stem CAT	1
3b, 8, 11, 12	500006_ _ _	Color Anodized/Color Accent Fork Assembly 6"" Std Stem CAT	1
3a, 9, 11, 12, 13, 15, 16	500513	Fork Assembly, Black, 6" +3/4" Stem CAT	1
3b, 9, 11, 12, 13, 15, 16	500513_ _ _	Color Anodized/Color Accent Fork Assembly 6"" +3/4"" Stem CAT	1
3a, 10, 11, 12, 14, 15, 16	500514	Fork Assembly, Black, 6" +1 1/2" Stem CAT	1
3b, 10, 11, 12, 14, 15, 16	500514_ _ _	Color Anodized/Color Accent Fork Assembly 6"" +1 1/2"" Stem CAT	1
4a, 8, 11, 12	500007	Fork Assembly, Black, 7" Std Stem CAT	1
4b, 8, 11, 12	500007_ _ _	Color Anodized/Color Accent Fork Assembly 7"" Std Stem CAT	1

Item Number	Part Number	Description	Quantity
4a, 9, 11, 12, 13, 15, 16	500515	Fork Assembly, Black, 7" +3/4" Stem CAT	1
4b, 9, 11, 12, 13, 15, 16	500515_ _ _	Color Anodized/Color Accent Fork Assembly 7"" +3/4"" Stem CAT	1
4a, 10, 11, 12, 14, 15, 16	500516	Fork Assembly, Black, 7" +1 1/2" Stem CAT	1
4b, 10, 11, 12, 14, 15, 16	500516_ _ _	Color Anodized/Color Accent Fork Assembly 7"" +1 1/2"" Stem CAT	1
3c, 8, 11, 12	501263	Fork Assembly 6" Wide Std Stem CAT <i>Only used with 2" wide casters</i>	1
3c, 9, 11, 12, 13, 15, 16	501416	Fork Assembly 6" Wide +3/4" Stem CAT <i>Only used with 2" wide casters</i>	1
3c, 10, 11, 12, 14, 15, 16	501417	Fork Assembly 6" Wide +1 1/2" Stem CAT <i>Only used with 2" wide casters</i>	1
4c, 8, 11, 12	501264	Fork Assembly 7" Wide Std Stem CAT <i>Only used with 2" wide casters</i>	1
4c, 9, 11, 12, 13, 15, 16	501418	Fork Assembly 7" Wide +3/4" Stem CAT <i>Only used with 2" wide casters</i>	1
4c, 10, 11, 12, 14, 15, 16	501419	Fork Assembly 7" Wide +1 1/2" Stem CAT <i>Only used with 2" wide casters</i>	1
1a, 12, 16	503805	Caster Fork, Black, 4" Catalyst	1
1b, 12, 16	503805_ _ _	Color Anodized/Color Accent Caster Fork 4"" Catalyst	1
2a, 12, 16	503806	Caster Fork, Black, 5" Catalyst	1
2b, 12, 16	503806_ _ _	Color Anodized/Color Accent Caster Fork 5"" Catalyst	1
3a, 12, 16	503807	Caster Fork, Black, 6" Catalyst	1
3b, 12, 16	503807_ _ _	Color Anodized/Color Accent Caster Fork 6"" Catalyst	1
3c, 12, 16	503808	Caster Fork 6" Wide Catalyst <i>Only used with 2" wide casters</i>	1
4a, 12, 16	503809	Caster Fork, Black, 7" Catalyst	1
4b, 12, 16	503809_ _ _	Color Anodized/Color Accent Caster Fork 7"" Catalyst	1
4c, 12, 16	503810	Caster Fork 7" Wide Catalyst <i>Only used with 2" wide casters</i>	1
5a	101829	M8 x 65 HHCS Blk Zn	1
5b	101831	M8 x 80 HHCS Blk Zn <i>Only used with 2" wide casters</i>	1

Item Number	Part Number	Description	Quantity
6a	100792	Caster Spacer D8 x D12 x 10mm / Close Mount Handrim Spacer <i>Used with all casters except 6x2 and 8x2</i>	2
6b	001246	Caster Spacer Black 6 x 2 Poly .472ODX.319IDX.370LG <i>Only used with 6" x 2" casters</i>	2
7	100659	M8 Nylock Nut Blk Zn	1
8, 12	503813	Fork Stem Standard Catalyst	1
9, 16	503812	Fork Stem 3/4" Catalyst	1
10, 16	503811	Fork Stem 1 1/2" Catalyst	1
11	100682	Washer 1/2" .518 x .875 x .047 F/W Black Zinc <i>Use quantity 3 with standard stem</i>	4
12	100529	M12 x 1.25mm Lock Nut Black <i>Use quantity 1 with 3/4" and 1 1/2" stems</i>	2
13	000115	Fork Stem Spacer 3/4"	1
14	000114	Fork Stem Spacer 1 1/2" CAT	1
15	101869	1/2-20 G5 Hex Nut Hxfree Zc	1
16	101459	1/2-20 NTE JAM NYL INS L/N BLK ZC	1

Color Anodizing Samples

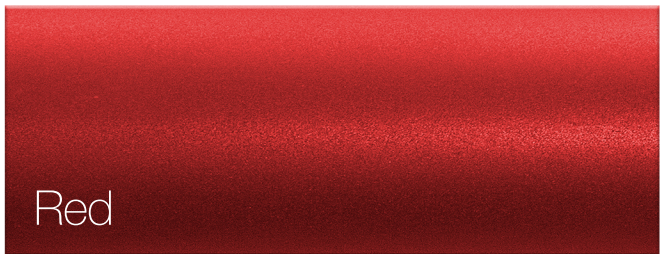
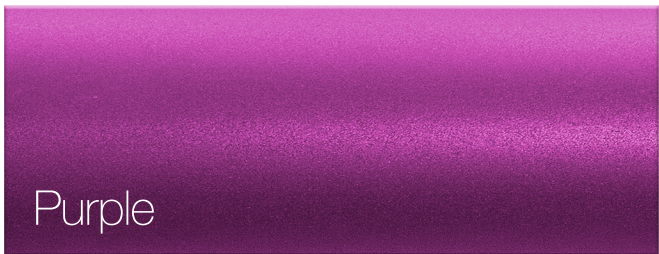
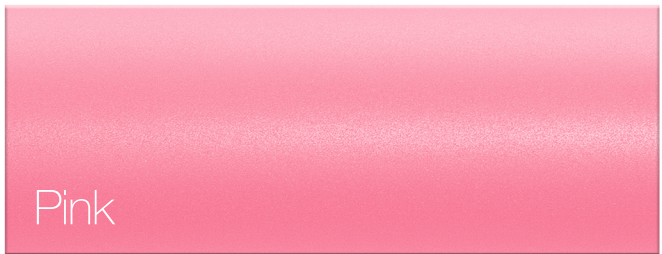
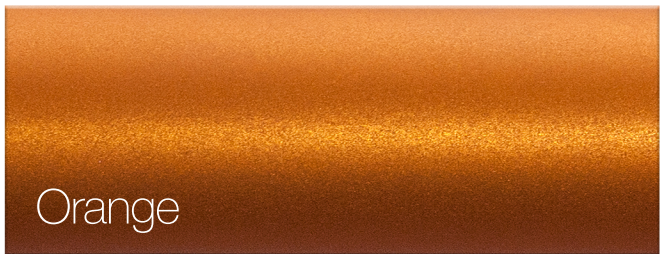
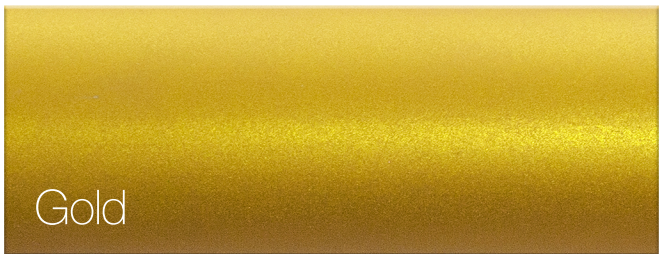
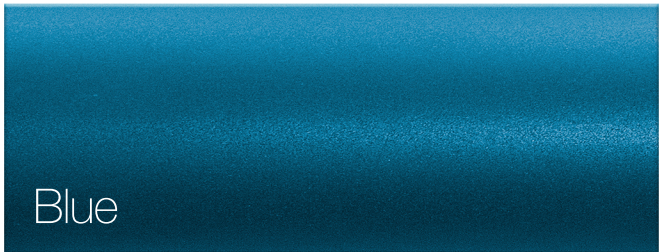
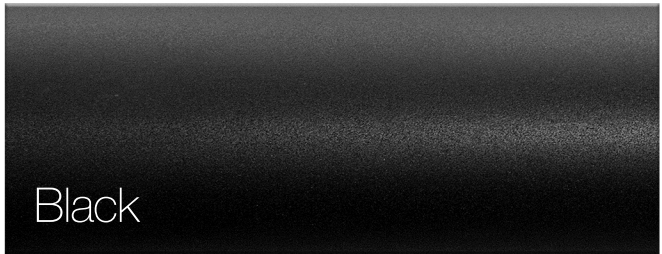

Catalyst/Spark Front Seat Height Matrix																								
3" Caster				4" Caster				5" Caster				6" Caster				7" Caster				8" Caster				
FSH	Super Low	Stem	Fork	FSH	Super Low	Stem	Fork	FSH	Super Low	Stem	Fork	FSH	Super Low	Stem	Fork	FSH	Super Low	Stem	Fork	FSH	Super Low	Stem	Fork	
14.5	13.5	Std	4"	15	13.5	Std	4"	16	14.5	Std	4"	17	15.5	Std	5"	18	16.5	Std	6"	19	17.5	Std	6"	
15	14			15.5	14			16.5	15.5			3/4	17.5			16.5	3/4			18.5	17			19.5
15.5	14	3/4	4"	15.5 ¹	14 ¹	3/4	4"	17.5	16	1 1/2	5"	18.5	17	1 1/2	6"	18.5	17.5	3/4	7"	20.5	n/a	1 1/2	7"	
16	14.5			16	14.5			16	14.5			Std	17.5			16	Std			17.5	16			Std
16	15	1 1/2	4"	16.5 ¹	15 ¹	1 1/2	4"	16.5	15	Std	5"		17.5	16	Std	6"		19.5	18	1 1/2	7"	19.5	18	
16.5	15.5			17	15.5			16.5	15.5			3/4	17.5	16			3/4	17.5	16			3/4	18	16.5
15.5	14.5	Std	5"	15.5	14	Std	5"	17	16	3/4	6"		17.5	16.5	3/4	7"		18.5	17	Std	8"		20.5	19
16	15			16	14.5			16	14.5			1 1/2	17.5	16			1 1/2	18	17			3/4	18.5	17.5
16.5	15	3/4	5"	16	15	3/4	5"	18	16.5	1 1/2	6"		18.5	17.5	3/4	7"		19.5	18	Std	8"		20	19
17	15.5			16.5	15.5			16.5	15.5			1 1/2	17	15.5			Std	17	15.5			Std	18.5	17
17	16	1 1/2	5"	17	15.5	1 1/2	5"	17	15.5	Std	6"		19	17.5	1 1/2	7"		19	18	3/4	8"		21	n/a
17.5	16.5			17.5	16			17.5	16			3/4	17.5	16			3/4	17.5	16			3/4	18	16.5
16.5	15.5	Std	6"	16.5	15	Std	6"	17.5	16	3/4	7"		18	16.5	3/4	8"		18	16.5	Std	9"		20	19
17	16			17	15.5			17	15.5			3/4	18	16.5			1 1/2	18	16.5			1 1/2	18.5	17
17.5	16	3/4	6"	17	16	3/4	6"	18.5	17	1 1/2	7"		18.5	17	1 1/2	8"		19	17.5	3/4	9"		20	18.5
18	16.5			17.5	16.5			17.5	16.5			1 1/2	18	16.5			1 1/2	18	16.5			1 1/2	19.5	18
18	17	1 1/2	6"	18	16.5	1 1/2	6"	18.5	17	1 1/2	7"		18.5	17.5	3/4	8"		18.5	17.5	3/4	9"		21	n/a
18.5	17.5			18.5	17			18.5	17			1 1/2	18.5	17			1 1/2	19	17.5			3/4	19	18
				18	16.5	Std	7"	18	16.5	Std	8"		19.5	18.5	3/4	9"		19.5	18	1 1/2	10"		20.5	19
				18.5	17			3/4	18.5			17	Std	18.5			17	Std	20			19	1 1/2	20
				18.5	17.5	3/4	7"		19	17.5	3/4	8"		19.5	18	1 1/2	9"		19.5	18	1 1/2	10"		20.5
				19	18			1 1/2	7"	18.5			17.5	3/4	8"			20	18.5	1 1/2			9"	20
				19.5	18.5	1 1/2	7"			19.5	18.5	3/4	8"			20.5	19	1 1/2	9"		20.5	19		1 1/2
				20	19			1 1/2	7"	19.5	18			1 1/2	8"	21	n/a			1 1/2	9"	6" x 2" caster not available with 5" fork		
				20	19	1 1/2	7"			20	18.5	1 1/2	8"			21	n/a	1 1/2	9"					
				20.5	19			1 1/2	7"	20.5	19			1 1/2	8"	21	n/a			1 1/2	9"			

¹ Not available with 4 x 1.5" Soft Roll Aluminum

Seat heights with "FSH" heading available with Standard Front Frame. Seat heights with "Super Low" heading available with Super Low Front Frame. Actual seat height may vary depending upon configuration.