

Little Wave XP Adjustable Height Backrest with Non-Adjustable Rigidizer Bar

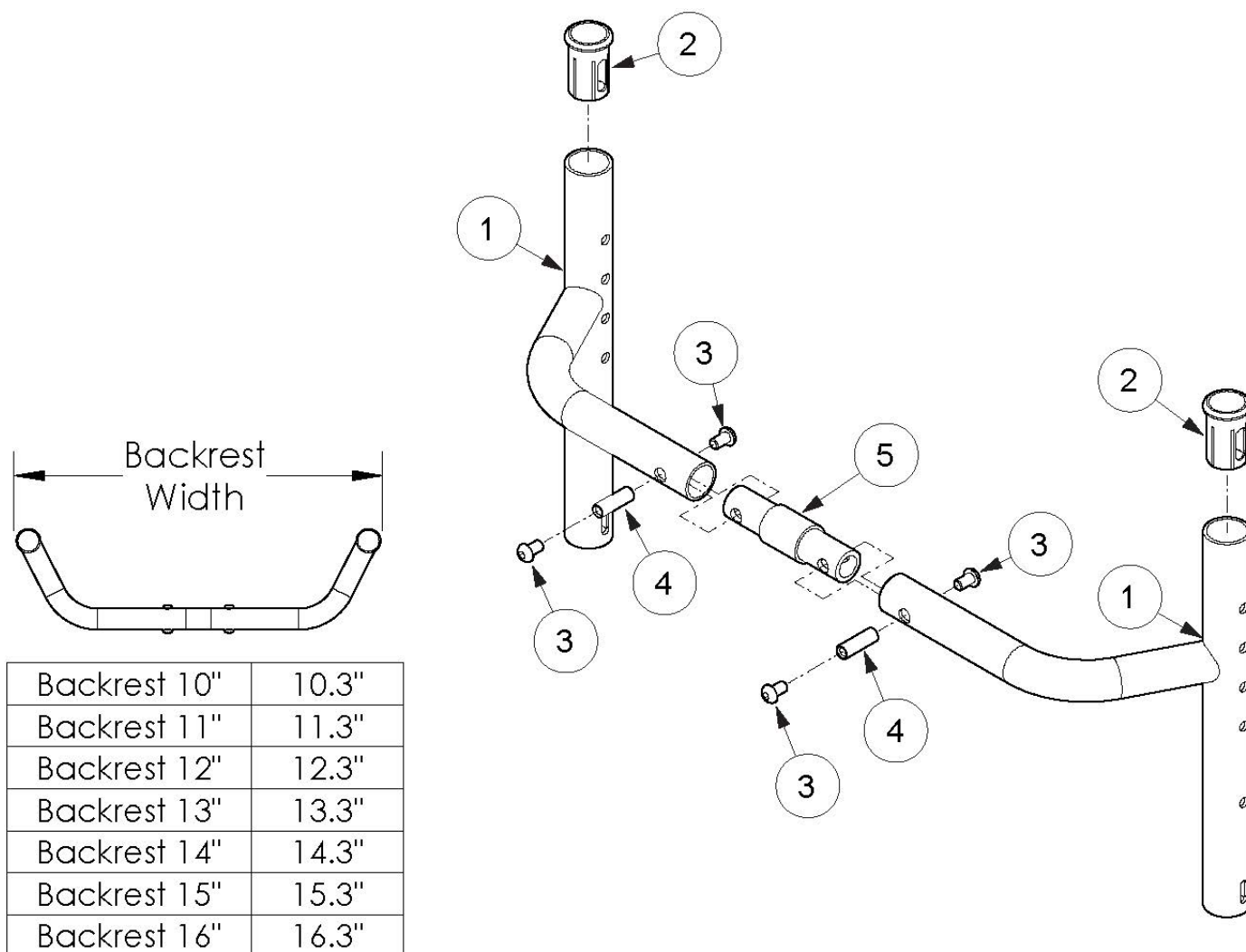

Item Number	Part Number	Description	Quantity
1a, 3, 4, 5a	110296	10" Rigid Backrest, 0" Connector and Hardware <i>Used with standard push handles, low profile push handles or omit push handles in any back height range. Also used with fold down push handles with a tall back height range.</i>	1
1h, 3, 4, 5a	110670	10" Rigid Backrest for Fold Down Push Handles, Short/Medium, 0" Connector and Hardware <i>Used with fold down push handles with a short or medium back height range</i>	1
1a, 3, 4, 5b	110297	10" Rigid Backrest, 1" Connector and Hardware <i>Used with standard push handles, low profile push handles or omit push handles in any back height range. Also used with fold down push handles with a tall back height range.</i>	1
1h, 3, 4, 5b	110671	10" Rigid Backrest for Fold Down Push Handles, Short/Medium, 1" Connector and Hardware	1

Item Number	Part Number	Description	Quantity
		<i>Used with fold down push handles with a short or medium back height range</i>	
1a, 3, 4, 5c	110298	10" Rigid Backrest, 2" Connector and Hardware <i>Used with standard push handles, low profile push handles or omit push handles in any back height range. Also used with fold down push handles with a tall back height range.</i>	1
1h, 3, 4, 5c	110672	10" Rigid Backrest for Fold Down Push Handles, Short/Medium, 2" Connector and Hardware <i>Used with fold down push handles with a short or medium back height range</i>	1
1a, 3, 4, 5d	110299	10" Rigid Backrest, 3" Connector and Hardware <i>Used with standard push handles, low profile push handles or omit push handles in any back height range. Also used with fold down push handles with a tall back height range.</i>	1
1h, 3, 4, 5d	110673	10" Rigid Backrest for Fold Down Push Handles, Short/Medium, 3" Connector and Hardware <i>Used with fold down push handles with a short or medium back height range</i>	1
1b, 3, 4, 5a	110300	11" Rigid Backrest, 0" Connector and Hardware <i>Used with standard push handles, low profile push handles or omit push handles in any back height range. Also used with fold down push handles with a tall back height range.</i>	1
1i, 3, 4, 5a	110674	11" Rigid Backrest for Fold Down Push Handles, Short/Medium, 0" Connector and Hardware <i>Used with fold down push handles with a short or medium back height range</i>	1
1b, 3, 4, 5b	110301	11" Rigid Backrest, 1" Connector and Hardware <i>Used with standard push handles, low profile push handles or omit push handles in any back height range. Also used with fold down push handles with a tall back height range.</i>	1
1i, 3, 4, 5b	110675	11" Rigid Backrest for Fold Down Push Handles, Short/Medium, 1" Connector and Hardware <i>Used with fold down push handles with a short or medium back height range</i>	1
1b, 3, 4, 5c	110302	11" Rigid Backrest, 2" Connector and Hardware <i>Used with standard push handles, low profile push handles or omit push handles in any back height range. Also used with fold down push handles with a tall back height range.</i>	1
1i, 3, 4, 5c	110676	11" Rigid Backrest for Fold Down Push Handles, Short/Medium, 2" Connector and Hardware <i>Used with fold down push handles with a short or medium back height range</i>	1
1b, 3, 4, 5d	110303	11" Rigid Backrest, 3" Connector and Hardware <i>Used with standard push handles, low profile push handles or omit push handles in any back height range. Also used with fold down push handles with a tall back height range.</i>	1
1i, 3, 4, 5d	110677	11" Rigid Backrest for Fold Down Push Handles, Short/Medium, 3" Connector and Hardware <i>Used with fold down push handles with a short or medium back height range</i>	1
1c, 3, 4, 5a	110304	12" Rigid Backrest, 0" Connector and Hardware	1

Item Number	Part Number	Description	Quantity
		<i>Used with standard push handles, low profile push handles or omit push handles in any back height range. Also used with fold down push handles with a tall back height range.</i>	
1j, 3, 4, 5a	110678	12" Rigid Backrest for Fold Down Push Handles, Short/Medium, 0" Connector and Hardware <i>Used with fold down push handles with a short or medium back height range</i>	1
1c, 3, 4, 5b	110305	12" Rigid Backrest, 1" Connector and Hardware <i>Used with standard push handles, low profile push handles or omit push handles in any back height range. Also used with fold down push handles with a tall back height range.</i>	1
1j, 3, 4, 5b	110679	12" Rigid Backrest for Fold Down Push Handles, Short/Medium, 1" Connector and Hardware <i>Used with fold down push handles with a short or medium back height range</i>	1
1c, 3, 4, 5c	110306	12" Rigid Backrest, 2" Connector and Hardware <i>Used with standard push handles, low profile push handles or omit push handles in any back height range. Also used with fold down push handles with a tall back height range.</i>	1
1j, 3, 4, 5c	110680	12" Rigid Backrest for Fold Down Push Handles, Short/Medium, 2" Connector and Hardware <i>Used with fold down push handles with a short or medium back height range</i>	1
1c, 3, 4, 5d	110307	12" Rigid Backrest, 3" Connector and Hardware <i>Used with standard push handles, low profile push handles or omit push handles in any back height range. Also used with fold down push handles with a tall back height range.</i>	1
1j, 3, 4, 5d	110681	12" Rigid Backrest for Fold Down Push Handles, Short/Medium, 3" Connector and Hardware <i>Used with fold down push handles with a short or medium back height range</i>	1
1d, 3, 4, 5a	110308	13" Rigid Backrest, 0" Connector and Hardware <i>Used with standard push handles, low profile push handles or omit push handles in any back height range. Also used with fold down push handles with a tall back height range.</i>	1
1k, 3, 4, 5a	110682	13" Rigid Backrest for Fold Down Push Handles, Short/Medium, 0" Connector and Hardware <i>Used with fold down push handles with a short or medium back height range</i>	1
1d, 3, 4, 5b	110309	13" Rigid Backrest, 1" Connector and Hardware <i>Used with standard push handles, low profile push handles or omit push handles in any back height range. Also used with fold down push handles with a tall back height range.</i>	1
1k, 3, 4, 5b	110683	13" Rigid Backrest for Fold Down Push Handles, Short/Medium, 1" Connector and Hardware <i>Used with fold down push handles with a short or medium back height range</i>	1
1d, 3, 4, 5c	110310	13" Rigid Backrest, 2" Connector and Hardware <i>Used with standard push handles, low profile push handles or omit push handles in any back height range. Also used with fold down push handles with a tall back height range.</i>	1
1k, 3, 4, 5c	110684	13" Rigid Backrest for Fold Down Push Handles, Short/Medium, 2" Connector and Hardware	1

Item Number	Part Number	Description	Quantity
		<i>Used with fold down push handles with a short or medium back height range</i>	
1d, 3, 4, 5d	110311	13" Rigid Backrest, 3" Connector and Hardware <i>Used with standard push handles, low profile push handles or omit push handles in any back height range. Also used with fold down push handles with a tall back height range.</i>	1
1k, 3, 4, 5d	110685	13" Rigid Backrest for Fold Down Push Handles, Short/Medium, 3" Connector and Hardware <i>Used with fold down push handles with a short or medium back height range</i>	1
1e, 3, 4, 5a	110312	14" Rigid Backrest, 0" Connector and Hardware <i>Used with standard push handles, low profile push handles or omit push handles in any back height range. Also used with fold down push handles with a tall back height range.</i>	1
1l, 3, 4, 5a	110686	14" Rigid Backrest for Fold Down Push Handles, Short/Medium, 0" Connector and Hardware <i>Used with fold down push handles with a short or medium back height range</i>	1
1e, 3, 4, 5b	110313	14" Rigid Backrest, 1" Connector and Hardware <i>Used with standard push handles, low profile push handles or omit push handles in any back height range. Also used with fold down push handles with a tall back height range.</i>	1
1l, 3, 4, 5b	110687	14" Rigid Backrest for Fold Down Push Handles, Short/Medium, 1" Connector and Hardware <i>Used with fold down push handles with a short or medium back height range</i>	1
1e, 3, 4, 5c	110314	14" Rigid Backrest, 2" Connector and Hardware <i>Used with standard push handles, low profile push handles or omit push handles in any back height range. Also used with fold down push handles with a tall back height range.</i>	1
1l, 3, 4, 5c	110688	14" Rigid Backrest for Fold Down Push Handles, Short/Medium, 2" Connector and Hardware <i>Used with fold down push handles with a short or medium back height range</i>	1
1e, 3, 4, 5d	110315	14" Rigid Backrest, 3" Connector and Hardware <i>Used with standard push handles, low profile push handles or omit push handles in any back height range. Also used with fold down push handles with a tall back height range.</i>	1
1l, 3, 4, 5d	110689	14" Rigid Backrest for Fold Down Push Handles, Short/Medium, 3" Connector and Hardware <i>Used with fold down push handles with a short or medium back height range</i>	1
1f, 3, 4, 5a	110316	15" Rigid Backrest, 0" Connector and Hardware <i>Used with standard push handles, low profile push handles or omit push handles in any back height range. Also used with fold down push handles with a tall back height range.</i>	1
1m, 3, 4, 5a	110690	15" Rigid Backrest for Fold Down Push Handles, Short/Medium, 0" Connector and Hardware <i>Used with fold down push handles with a short or medium back height range</i>	1
1f, 3, 4, 5b	110317	15" Rigid Backrest, 1" Connector and Hardware	1

Item Number	Part Number	Description	Quantity
		<i>Used with standard push handles, low profile push handles or omit push handles in any back height range. Also used with fold down push handles with a tall back height range.</i>	
1m, 3, 4, 5b	110691	15" Rigid Backrest for Fold Down Push Handles, Short/Medium, 1" Connector and Hardware <i>Used with fold down push handles with a short or medium back height range</i>	1
1f, 3, 4, 5c	110318	15" Rigid Backrest, 2" Connector and Hardware <i>Used with standard push handles, low profile push handles or omit push handles in any back height range. Also used with fold down push handles with a tall back height range.</i>	1
1m, 3, 4, 5c	110692	15" Rigid Backrest for Fold Down Push Handles, Short/Medium, 2" Connector and Hardware <i>Used with fold down push handles with a short or medium back height range</i>	1
1f, 3, 4, 5d	110319	15" Rigid Backrest, 3" Connector and Hardware <i>Used with standard push handles, low profile push handles or omit push handles in any back height range. Also used with fold down push handles with a tall back height range.</i>	1
1m, 3, 4, 5d	110693	15" Rigid Backrest for Fold Down Push Handles, Short/Medium, 3" Connector and Hardware <i>Used with fold down push handles with a short or medium back height range</i>	1
1g, 3, 4, 5a	110320	16" Rigid Backrest, 0" Connector and Hardware <i>Used with standard push handles, low profile push handles or omit push handles in any back height range. Also used with fold down push handles with a tall back height range.</i>	1
1n, 3, 4, 5a	110694	16" Rigid Backrest for Fold Down Push Handles, Short/Medium, 0" Connector and Hardware <i>Used with fold down push handles with a short or medium back height range</i>	1
1g, 3, 4, 5b	110321	16" Rigid Backrest, 1" Connector and Hardware <i>Used with standard push handles, low profile push handles or omit push handles in any back height range. Also used with fold down push handles with a tall back height range.</i>	1
1n, 3, 4, 5b	110695	16" Rigid Backrest for Fold Down Push Handles, Short/Medium, 1" Connector and Hardware <i>Used with fold down push handles with a short or medium back height range</i>	1
1g, 3, 4, 5c	110322	16" Rigid Backrest, 2" Connector and Hardware <i>Used with standard push handles, low profile push handles or omit push handles in any back height range. Also used with fold down push handles with a tall back height range.</i>	1
1n, 3, 4, 5c	110696	16" Rigid Backrest for Fold Down Push Handles, Short/Medium, 2" Connector and Hardware <i>Used with fold down push handles with a short or medium back height range</i>	1
1g, 3, 4, 5d	110323	16" Rigid Backrest, 3" Connector and Hardware <i>Used with standard push handles, low profile push handles or omit push handles in any back height range. Also used with fold down push handles with a tall back height range.</i>	1
1n, 3, 4, 5d	110697	16" Rigid Backrest for Fold Down Push Handles, Short/Medium, 3" Connector and Hardware	1

Item Number	Part Number	Description	Quantity
		<i>Used with fold down push handles with a short or medium back height range</i>	
2	000034	Sleeve 3/4" x 1 1/2"	2
3	101184	M6 x 10 BTN SHCS BLKZC w/Patch	4
4	000669	M6 x 20.5 Threaded Barrel	2
5a	000589	Backrest Connector 0" LW/RG	1
5b	000590	Backrest Connector 1" LW/RG	1
5c	000591	Backrest Connector 2" LW/RG	1
5d	000592	Backrest Connector 3" LW/RG	1
3, 4, 5b	502318	Backrest Connector Assembly 1" w/ Hardware, Rigid	1
3, 4, 5c	502319	Backrest Connector Assembly 2" w/ Hardware, Rigid	1
3, 4, 5d	502320	Backrest Connector Assembly 3" w/ Hardware, Rigid	1