



POWER CENTER-MOUNT ACTUATOR REPLACEMENT INSTRUCTION SHEET



Please read these instructions carefully before beginning the installation. Failure to understand and follow installation instructions may result in injury to installer and/or end user and may void the warranty. If you have any questions call Sunrise Medical Technical support at 800-333-4000.

Legrest parts:

- | | |
|--------------------------------|---------------------|
| 1. 1 ea. Elevation Actuator | 4. 1 ea. Pin |
| 2. 1 ea. Articulation Actuator | 5. 1 ea. Front Clip |
| 3. 1 ea. Rear Clip | |

Tools needed for assembly:

- | | | |
|------------------|-----------------|-----------------------|
| 1. 2.5mm hex key | 4. 10mm hex key | 7. Std. Screwdriver |
| 2. 5mm hex key | 5. 17mm wrench | 8. Torque Wrench |
| 3. 8mm hex key | 6. Pliers | 9. Loctite 243 (Blue) |

A. Remove/Install Elevation Actuator:

1. Disconnect the Elevation Actuator from its harnessing. The harnessing should be located directly behind the Elevation Actuator. (Fig. 1 & 2)
2. With pliers, remove the rear clip and pin, that's holding the Elevation Actuator. (Fig. 3) Discard hardware.
3. With pliers, remove the front clip of the Elevation Actuator. (Fig. 4) Discard hardware.
4. Remove Elevation Actuator from chair. If under warranty, return to Sunrise Medical. Otherwise discard.
5. Attach the new Elevation Actuator to its front mount. Secure new clip with pliers. (Fig. 4)

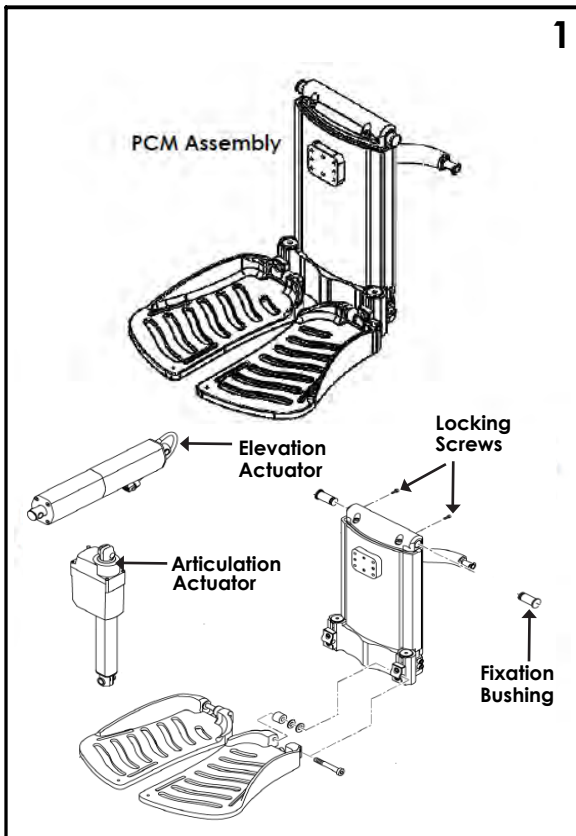

A. Remove/Install Elevation Actuator(Continued):

5. Attach the rear mount of the new Elevation Actuator. With pliers, secure the new pin and clip. (Fig. 3)
6. Reconnect new Elevation Actuator to its harnessing (Fig. 2).
7. Through the electronics test the new Elevation Actuator and adjust harnessing as needed.





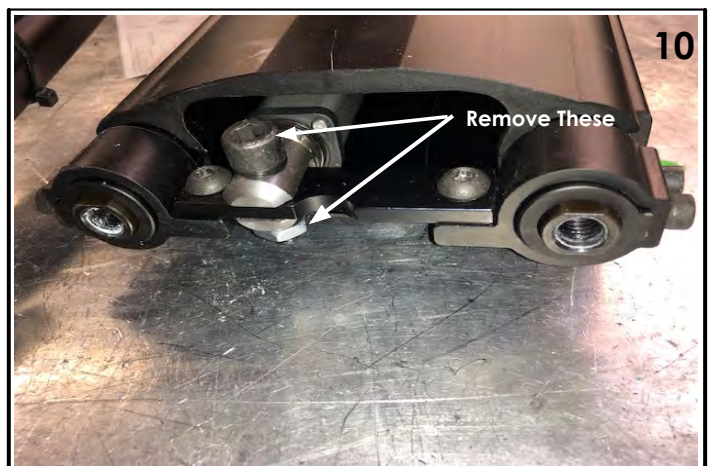
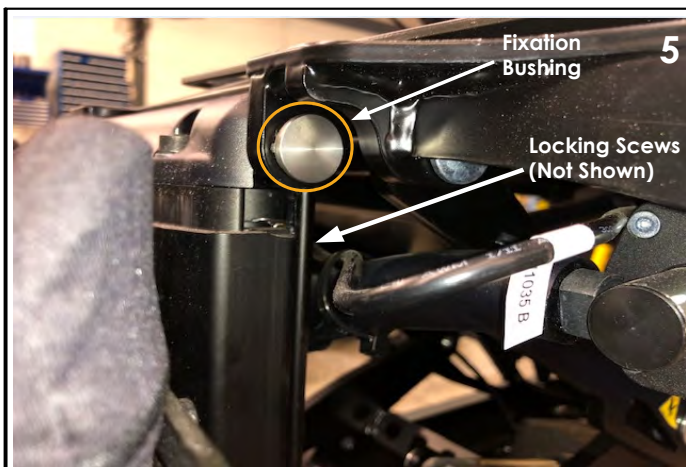

B. Remove/Install Articulation Actuator:

1. Tilt the seat back if possible. This will allow easier access to the back side of the PCM assembly. (Fig. 1)
2. Disconnect both PCM actuators from their harnessing. Both connectors are located behind the elevation actuator. (Fig. 1 & 2)
3. With pliers, remove the pin and clip holding the rear of the elevation actuator. (Fig.3) Save hardware
4. With a 2.5mm hex key, remove both Locking screws on the back of the PCM Assembly. (Fig. 5 & 6) Save hardware.
5. Using a standard screwdriver, remove both Fixation Bushings. (Fig. 1 & 5) Save the hardware.
6. Remove the complete PCM assembly with the Elevation Actuator attached. Place on a solid surface. (Fig. 7)
7. Use a 10mm hex key, and remove both large screws on the bottom edge of the PCM. (Fig. 8)
8. Once the screws are removed from step 7, slide the center section and lower plate off of the main assembly. (Fig. 8 & 9)
9. Use a 8mm hex key and 17mm wrench, to remove the hardware from the lower Articulation Actuator mount. (Fig. 10) Save hardware.
10. With a 5mm hex key, remove the four screws that hold the top portion of the PCM assembly. (Fig. 11) Save hardware.
11. Lift the entire PCM assembly over to it's left side and allow the Top Actuator Pin to fall out. (Fig. 12) Save hardware.
12. Remove the top of the PCM assembly and set it off to the side with the Top Actuator Pin. (Fig. 13)
13. Disconnect the harness from the top of the Articulation Actuator. Then fully remove it through the top of the PCM assembly. (Fig. 14)
14. If the Articulation Actuator is under warranty, please return to Sunrise Medical. Otherwise discard.



B. Remove/Install Articulation Actuator(Continued):

15. Slide the new Articulation Actuator into the top of the PCM assembly. Reconnect the harness to the new Articulation Actuator. Align the lower actuator mount with it's mounting bracket but don't secure yet.
16. Put the top onto the PCM assembly, and then slide the Top Actuator Pin back into the place. (Fig. 12 & 13)
17. With a 5mm hex key, secure down the four top screws saved during removal. (Fig. 11) Torque to 72-88 in-lbs. 
18. Use a 8mm hex key, 17mm wrench and Loctite 243 (Blue) to reattach the hardware to the lower actuator mount. (Fig. 10) Torque to 72-88 in-lbs. 
19. Reattach the lower plate and plastic cover removed during step 8. (Fig. 8 & 9)
20. With a 10mm hex key and Loctite 243 (Blue), reattach the two large screws into the bottom plate of the PCM assembly. (Fig. 8) Torque to 53-65 ft/lbs. 
21. Attach the PCM assembly into the front of the Double Tilt Module with the two saved Fixation Bushings. (Fig. 5)
22. Take a 2.5mm hex key, and secure the two saved Locking Screws to the PCM assembly. (Fig. 5 & 6) Torque to 6-8 in-lbs. 
23. With pliers, reattach the saved pin and clip holding the rear mount of the Elevation Actuator and the Double Tilt Module. (Fig. 3)
24. Reconnect both PCM assembly actuators to their harnesses. (Fig. 2)
25. Re-secure the harnessing to the chair as needed.
26. Through the electronics, test for the full and accurate function of the PCM assembly.

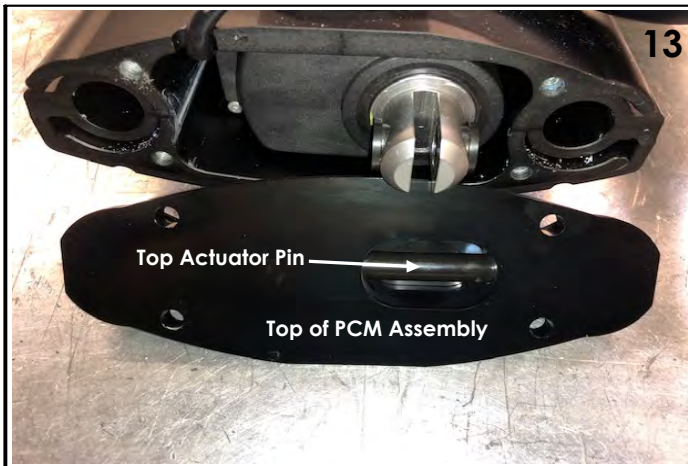
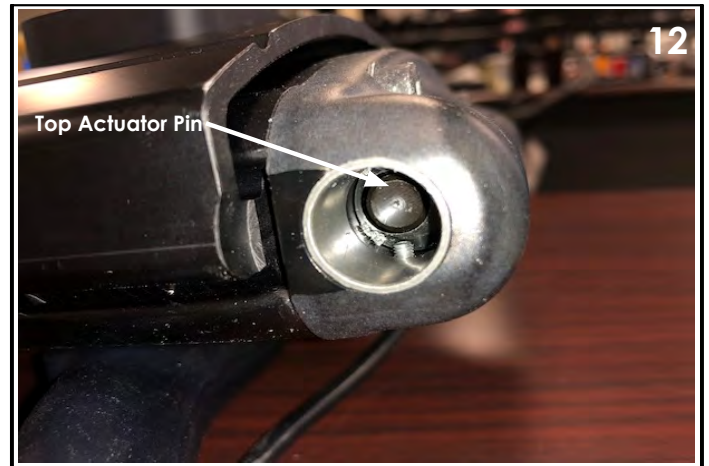

C. INSPECT:

1. All torque values with a torque wrench.
2. Seating system to ensure all wire harnesses are out of the way and are not getting pinched.
3. Seating system to verify that the harnesses are not put under tension in any position.
4. Ensure that the cable-ties are not so tight that they deform cable jackets.
5. Where possible cables should be protected and hidden by shrouds.

DEALER/TECHNICIAN WARNING**WARNING**

Attention dealers and qualified technicians, do not operate or service this device without first reading the owners manual. If you do not understand the instructions and warnings in the owners manual please contact the Quickie Technical Service Department before operating and/or servicing the Quickie device. Failure to do so may result in damage and/or injury.

Find more information and important warnings see the wheelchair owner's manual or at: www.SunriseMedical.com.

**Sunrise Medical 2842 Business Park Ave Fresno, CA 93727 USA
In Canada (800) 263-3390**