

# (Discontinued 3) Focus CR Hand Tilt Mechanism Fixed Height with Adjustable Handle Back

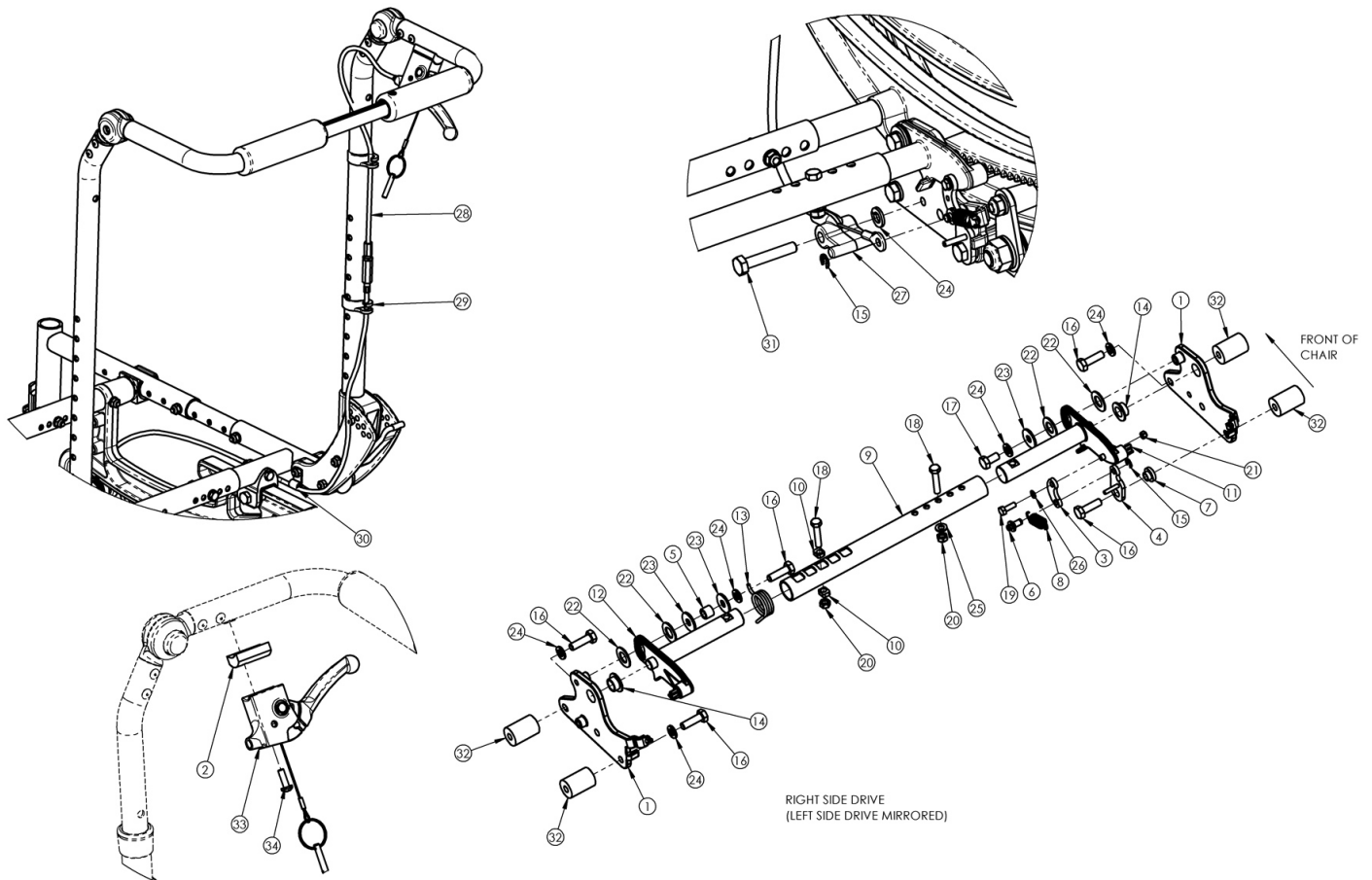

*This Focus CR Hand Tilt is discontinued and was used on chairs prior to a March 5th, 2018 invoice date.*

Item Number	Part Number	Description	Quantity
1a, 14	501162	Tilt Lock Mount Bracket w/ Bearing Kit, Right, Focus, Height Adjustable	1
1b, 14	501163	Tilt Lock Mount Bracket w/ Bearing Kit, Left, Focus, Height Adjustable	1
2	003367	Spacer, Tilt Lever	1
4a	002084	Toggle, Drive, Tilt, R	1
4b	002085	Toggle, Drive, Tilt, L	1
5	002086	Spacer, .38ODx.24IDx.31LG	1
6	003364	Pin, Toggle, Tilt	1
9a	002094	Growth Strut, Tilt Lock, Small	1

Item Number	Part Number	Description	Quantity
9b	002095	Growth Strut, Tilt Lock, Med	1
9c	002096	Growth Strut, Tilt Lock, Large	1
10	002097	Insert, Drive, Tilt	2
13a	001109	Spring Tilt Lock Right TILT <i>Used with left side assembly</i>	1
13b	001110	Spring Tilt Lock Left TILT <i>Used with right side assembly</i>	1
16a	101823	M6 X 20 Hhcs Blk Zn <i>Standard weight capacity requires qty 5; Heavy Duty requires qty of 1</i>	5
16b	100674	M6 x 45 CLS10.9 DIN931 HHCS ZC <i>Used with Heavy Duty option/spacer</i>	3
16c	101826	M6 x 50 HHCS Blk Zn <i>Used on drive side tilt with Heavy Duty option/spacer</i>	1
17	101822	M6 x 12 HHCS BLKZC w/Patch	1
18	101821	M5 x 25 HHCS Blk Zn	2
19	102783	M3 x 12 HHCS, CL8.8, Blk Zn	1
20	100657	M5 Nylock Nut Blk Zn	2
21	102784	Nut, Nylock, M3, Blk	2
22	102082	Washer Nylon .406IDX.75ODX.040	4
23	101853	M6 Washer Blk Zn	3
24	101835	M6 Lock Washer Blk Zn	5
25	101856	Flat Washer, M5, Blk Zn	1
26	102785	Flat Washer, M3, Blk Zn	1
27	003387	Cable Mount, Tilt	1
28a	002102	Cable, Tilt, Long	1
28b	002103	Cable, Tilt, XL	1
29	001117	Cable Clip 1"	1
30	001239	P-Clip 3/16"	1
31	101824	M6 X 30 Hhcs Blk Zn	1
33	002801	Lever Assembly Horizontal Tilt	1

<b>Item Number</b>	<b>Part Number</b>	<b>Description</b>	<b>Quantity</b>
34	100696	M5 x 30mm PPH Capscrew	1
35	001405	Spacer, .69OD x .24ID x .1.01Lg <i>Only used with Heavy Duty Option</i>	4