

CR45 Foot Tilt

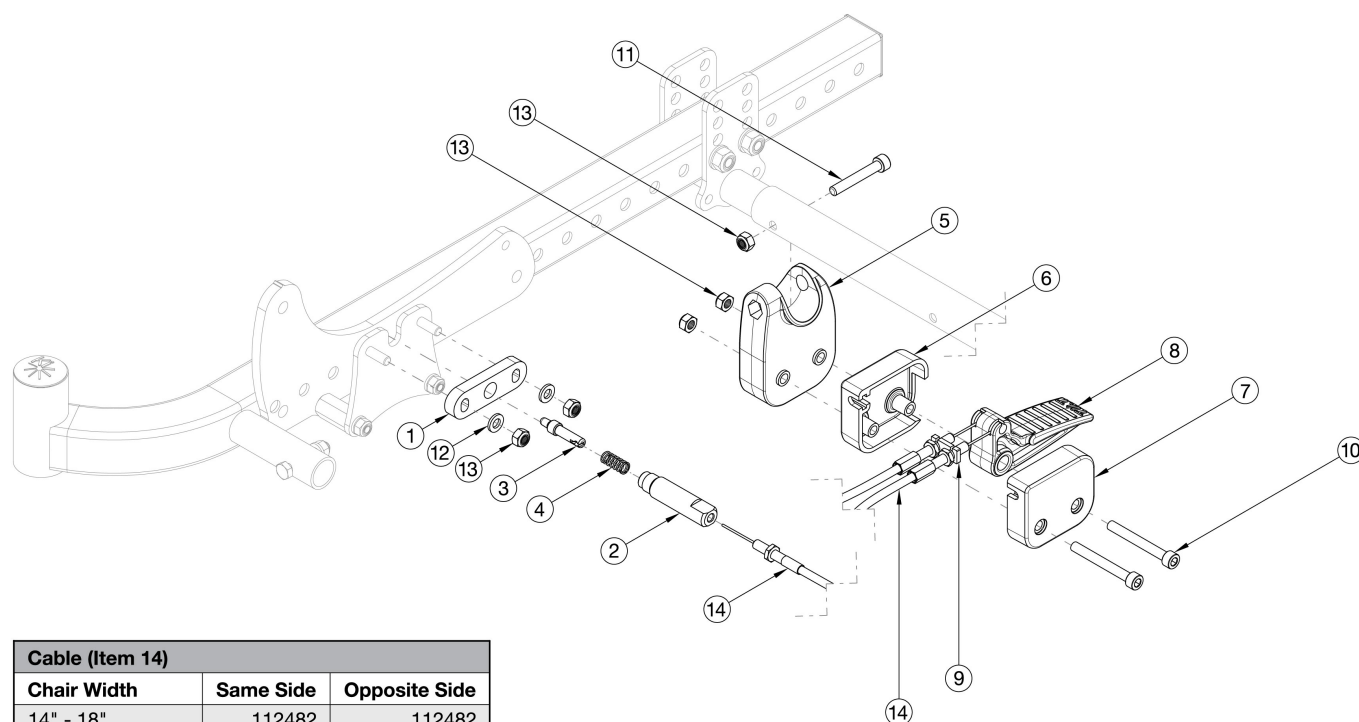

Cable (Item 14)		
Chair Width	Same Side	Opposite Side
14" - 18"	112482	112482
19" - 22"	112482	112483
14" - 18" (Recline)	112483	112483
19" - 22" (Recline)	112483	112484

Cables are determined based on width of chair. Please see chart within diagram to determine which cables are used. If retrofitting from Hand Tilt, the complete Foot Tilt Kit is recommended. Cables are determined based on the width of the chair and which side the tilt mechanism is mounted to. If right side mounted, same side = right; opposite side = left.

Item Number	Part Number	Description	Quantity
1-13,14a	116292	Foot Tilt Kit, 14-18 Wide	1
1-13,14a,14b	116293	Foot Tilt Kit, 19-22 Wide	1
1-13,14b	116294	Foot Tilt Kit, Recline, 14-18 Wide	1
1-13,14b,14c	116295	Foot Tilt Kit, Recline, 19-22 Wide	1
1	112477	Tilt Lock Plunger Adapter	2
2	112478	Plunger Housing	2
3	112479	Plunger Pin	2
4	112480	Spring, Comp, .312ODx.81LGx.032W	2
5	112481	Foot Tilt Pedal Mount	1

Item Number	Part Number	Description	Quantity
9	110226	Nut Plate, Cable, M6, .50SP	2
10	102473	M6 X 50 CLS12.9 SHCS BLK ZC	2
11	101847	M6 x 40 SHCS Blk Zn	1
12	100746	M6 Flat Washer Blk Zn	4
13	100658	M6 Nylock Nut Blk Zn	7
14a	112482	Foot Tilt Cable Short, CR45	2
14b	112483	Foot Tilt Cable Medium, CR45	2
14c	112484	Foot Tilt Cable Long, CR45	1