



Evolution Back™

The back system of choice for wheelchair users with moderate to maximum support needs.

Therapists recommend the Evolution Back because it is easy to mount and remove with one hand, even for the user without fine motor skills. The system is lightweight to conserve energy expenditure for the client who manually propels. Mounting hardware, which comes pre-installed, provides a wide range of lateral, seat-to-back angle, and seat-depth adjustment.



Users and caregivers value the Evolution Back's comfort and effective support. Sleek and strong. Lightweight and user friendly.



Evolution Back™

Pin bars for VARILITE Evolution Back systems are available in regular or extended lengths. Extended pin bars allow for even greater seat depth and angle adjustability. Extended pin bars are standard with the Evolution Back Deep and optional on Evolution Back regular and tall sizes.

Regular Pin Bar



Extended Pin Bar



Upper Pin Bars



Extended Pin Bar

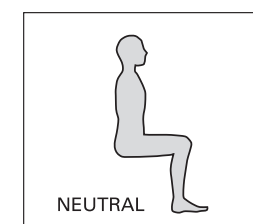

NEUTRAL

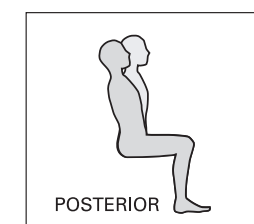

POSTERIOR

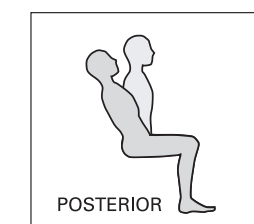

POSTERIOR

Lower Pin Bars

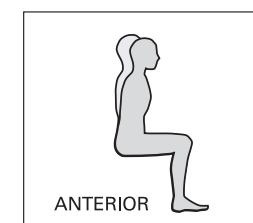
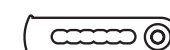

ANTERIOR

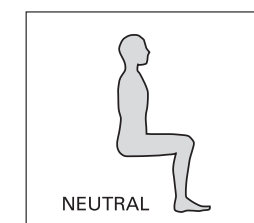

NEUTRAL

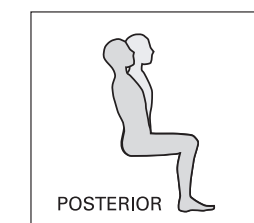

POSTERIOR

Front of Chair →



4000 1st Avenue South
Seattle, WA 98134
Phone: (800) 827-4548
Fax: (206) 343-5795
www.varilite.com

Authorized EU Representative:
Cascade Designs, Limited
Dwyer Road, Midleton, Co. Cork
Republic of Ireland



Evolution Back™

Effective postural support, adjustability, comfort and simplicity have made the Evolution Back a favorite of seating specialists. It handles third-party secondary supports with ease and works with VARILITE Lateral Supports to provide elegant, low-profile, integrated back and lateral support. VARILITE Evolution Back systems are available in a range of widths, from pediatric to bariatric, and in regular, tall and deep sizes.

1. Hardware

All-metal Evolution Back Hardware offers adjustability at all four attachment points. To allow for client growth, aluminum brackets permit 1 inch (2.5 cm) of lateral adjustment. Steel pin bars slide anteriorly and posteriorly to allow for back angle and seat depth adjustment. Pin bars simply slide in the receiving cane clip and click the system into place. Quick, easy, and no unsightly J-hooks.

2. Shell

Made from aluminum and trimmed with protective edging, the VARILITE Evolution Back shell is one of the lightest in the industry. Back panel is flat for flush mounting of headrest hardware. Contoured sides provide lateral support and attachment area for hip belts, laterals and hip guides. Shell has a handle cutout for easy shell removal by individuals with limited hand function. Slots accommodate different chair and mounting configurations. Shell supports users up to 250 lbs (115kg).

3. Cushion

VARILITE air-foam floatation. A two-way valve allows air in and out of the cushion for a custom fit. Sculpted foam fits shell contour without bunching. Cushion foam is thickest along the vertebral column for added comfort and protection. Four-way-stretch knit fabric for compliance is bonded to the foam. Fabric is water-resistant. Cushion is oversized to protect the user during reaching or weight-shifting activities.

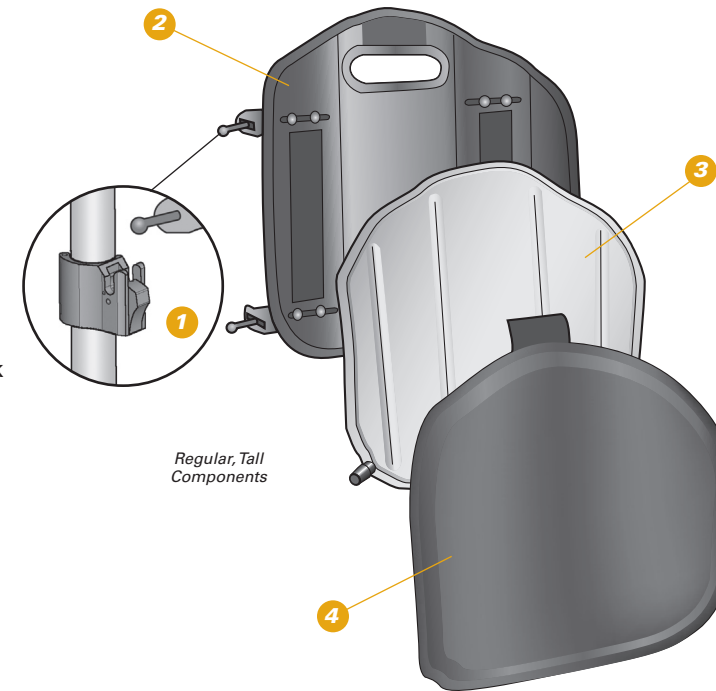

4. Cover

Provides maximum padding and protection. Four-way-stretch mesh top fabric wicks moisture away from the body. A large loop panel on the backside of the cover securely attaches to hook strips on the shell, while a wrap around handle flap prevents downward slippage for even the most active user. Reticulated foam inside the cover promotes air exchange and improves pressure distribution. Evolution Back cover meets ISO 7176-16 ignition resistance standards for upholstered wheelchair components. Machine washable.

Evolution Back Deep™

The VARILITE Evolution Back Deep has the added benefit of deeper contouring and extra lateral support. Available in tall sizes and a variety of widths, it is the ideal back system for the geriatric user, or anyone with fair to poor trunk control.

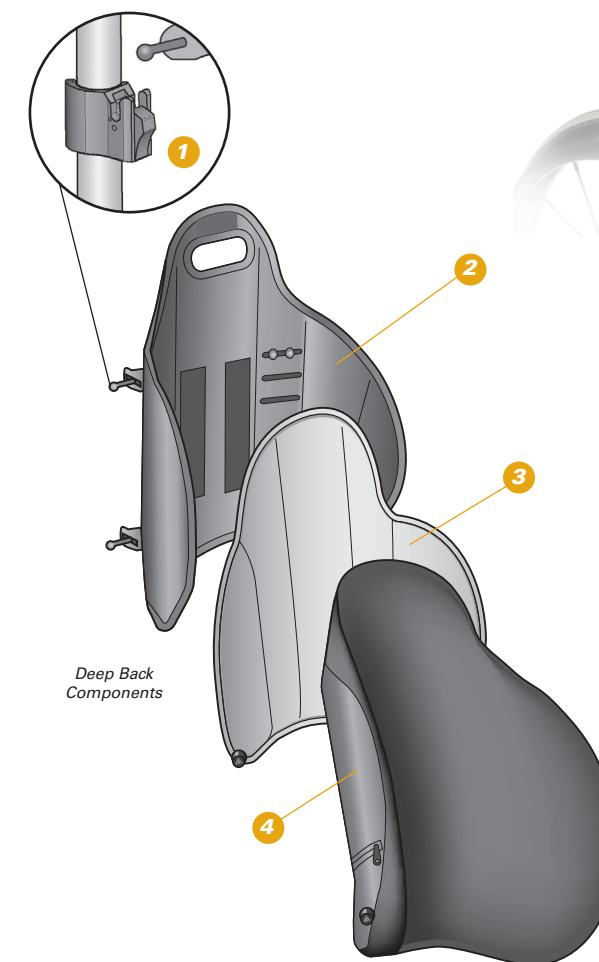

Evolution Back Deep systems include a PSIS block and Supplemental Lateral Pads. These accessory pieces are made from closed-cell foam that will not absorb water and is resistant to bacteria. They attach to the Evolution Back Deep shell with adhesive hook and loop for placement based on individual client needs.

The PSIS (posterior superior iliac spine) block provides support to the sacrum at the PSIS level, promoting an anterior pelvic tilt and spinal extension. The Supplemental Lateral Pads help users who lean to one side maintain an upright position, and are especially beneficial for geriatric clients.



Evolution Back™ is available with the following options:

Cover: Mesh
Height: Regular and Tall
See price list for size availability
HCPCS Code E2613/E2614

Evolution Back Deep™ is available with the following options:

Cover: Mesh
Height: Tall
See price list for size availability
HCPCS Code E2620