



Please read these instructions carefully before beginning the assembly. Failure to understand and follow assembly instructions may result in injury to technician and/or end user and may void the warranty. If you have any questions call Sunrise Medical Technical Support at +1 (800) 333-4000.

Tools needed:

- | | |
|----------------|------------------|
| 1. 3mm hex key | 3. Wire cutter |
| 2. 4mm hex key | 4. Torque wrench |

CxSM mounting parts:

1. CxSM (x1)
2. Cable-tie (x2)

A. Removing the CxSM (Fig. 1 - Fig. 3)

1. Remove the rear shroud by following the process in instruction sheet p/n 255937 for Rear Shroud Removal.
2. With the wire cutter, cut the cable-tie (A) holding the wires to the plate. (Fig. 1, Detail 1a)
3. Unplug all the wires from the CxSM. Note positions, ensure that the labels on the wires are not disturbed. (Fig 3)
4. Using the 4mm hex key remove the 2 screws (B) at the bottom of the plate holding the CxSM (Fig 1). Set screws aside.
5. Loosen the 2 screws (C) at the top of the plate. Then slide the plate with the CxSM attached to it down and away from the chair. The distribution block will come away also; let it hang free for now. (Fig 1)
6. Using the 3mm hex key, remove the 2 screws (D) from the back of the plate (Fig 2). Set screws aside.

B. Installing the CxSM (Fig. 1 - Fig. 7)

1. Install the new CxSM to the plate using the saved 5mm screws (D) (Fig 2). Ensure the CxSM is facing in the correct direction. Torque to 2.3 - 2.7 ft-lbs [3.1 - 3.7Nm].
2. Slide the plate behind the top loosened screws (C). Ensure you include the distribution block also (Fig 1, Detail 1b). Torque to 2.3 - 2.7 ft-lbs [3.1 - 3.7Nm].
3. Reinstall the 2 bottom screws (B). Torque to 2.3 - 2.7 ft-lbs [3.1 - 3.7Nm].
4. Plug the bottom row of harnesses into the CxSM first in this order: Caster Lock (Black Label - Q700 UP M only) First, Leg Extend (White Label) second, Leg Lift (Yellow Label) third, Lift/Forward Tilt (Green Label) fourth, Tilt (Purple Label) fifth, and Recline (Red Label) last. (Fig 3 & 4)
5. Plug in the inhibit harnesses (top row) in this order: Recline (label 1) first; Tilt, Tilt/Lift or Double Tilt (label 2) second; Leg (label 3) third; and Caster Lock (label 7) last (Fig 5). Inhibit 6 and 8 are optional. Ensure the graphic or number label on the wires match the corresponding graphic or number labels on the CxSM.

Note: Not all chairs will have the same amount of wires. Yours may differ from the one shown (Fig 3 - Fig 5).

6. Ensure that the wires are tucked in out of the way (Fig 6, Fig 7).
7. Use supplied cable-tie (A) to secure recline, tilt/lift and leg harnesses to the plate. (Fig 1, Detail 1a and Fig 7)
8. Last, plug in the bus harnesses, then tuck them inside of the recline bracket. Use supplied cable-tie to secure all the bus harnesses to leg, or recline, or tilt, or tilt/lift harnesses just below the first cable-tie (doesn't need to tie to the plate). (Fig 6, Fig 7)
9. Reference Q700-UP M Seating owner's manual, section 7.7 for setting memory position. Reset to manufacturer default.
10. Reinstall the rear shroud by following the process in instruction sheet p/n 255937 for Rear Shroud Removal.

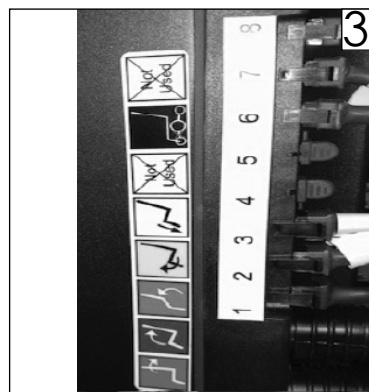
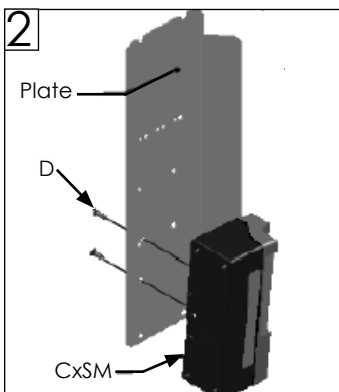
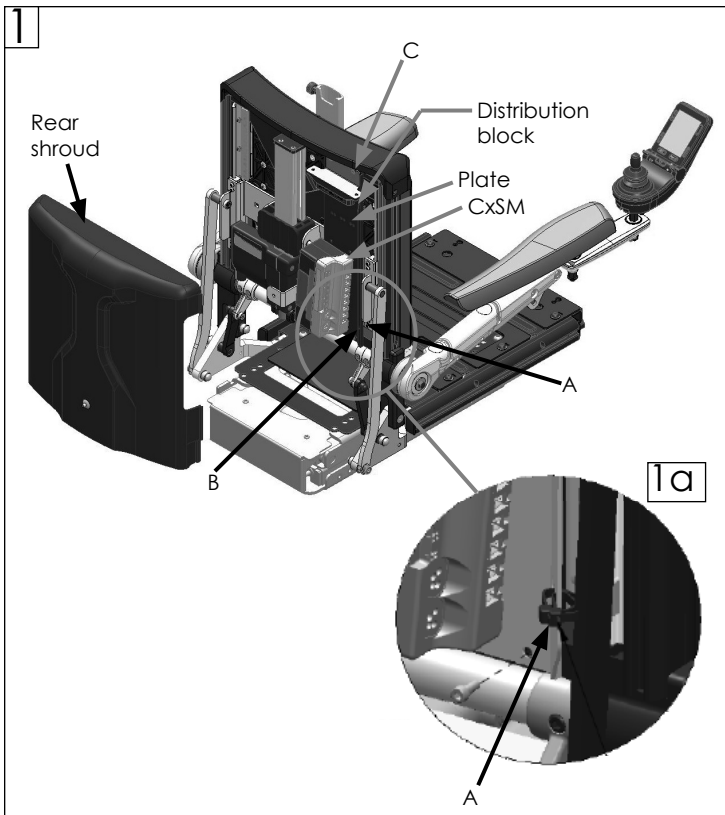
⚠ DEALER/TECHNICIAN WARNING

Attention dealers and qualified technicians, do not operate or service this device without first reading the owners manual. If you do not understand the instructions and warnings in the owners manual please contact the Quickie Technical Service Department before operating and/or servicing the Quickie device. Failure to do so may result in damage and/or injury.

Find more information and important warnings in the wheelchair owner's manual or at: www.SunriseMedical.com.

Sunrise Medical 2842 N. Business Park Ave Fresno, CA 93727 USA In Canada: (800) 263-3390

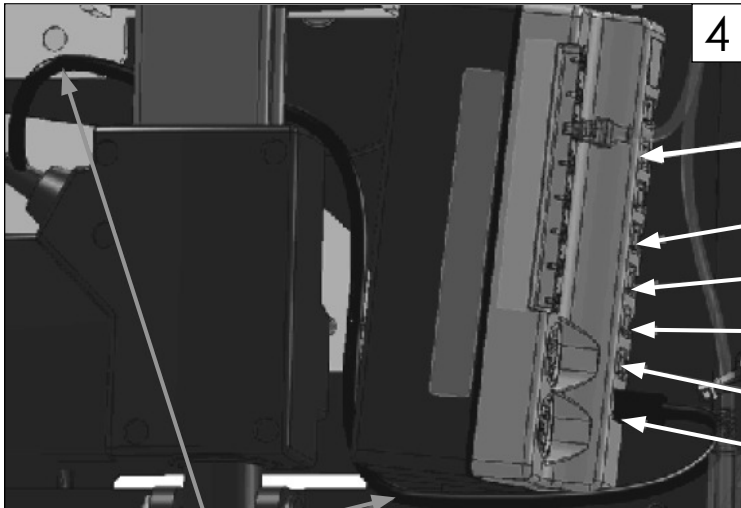

- 4 CASTER LOCK-UP (Black)
- LEG EXTEND (White)
- LEG LIFT (Yellow)
- LIFT/FWD TILT (Green)
- TILT (Purple)
- RECLINE (Red)

Recline Actuator has one harness that contains Actuator Harness and Feedback Harness. Route Harness behind actuator and below CxSM. Connect actuator to port with Red Recline label as shown above and inhibit to port 1.



- 5 CASTER LOCK-UP (7)
- LEGS (3)
- TILT, TILT/LIFT, or DOUBLE TILT (2)
- RECLINE (1)

Cable-tie all component harnesses, except recline inhibit, along with the actuator harness together to prevent actuator harness from being pinched.

C. INSPECT

1. All torque values with a torque wrench.
2. Seating system to ensure all wire harnesses are out of the way and are not getting pinched.
3. Seating system to verify that the harnesses are not put under tension in any position.
4. Ensure that the cable-ties are not so tight that they deform cable jackets.
5. Where possible cables should be protected and hidden by shrouds.