

# Flip Reclining Backrest

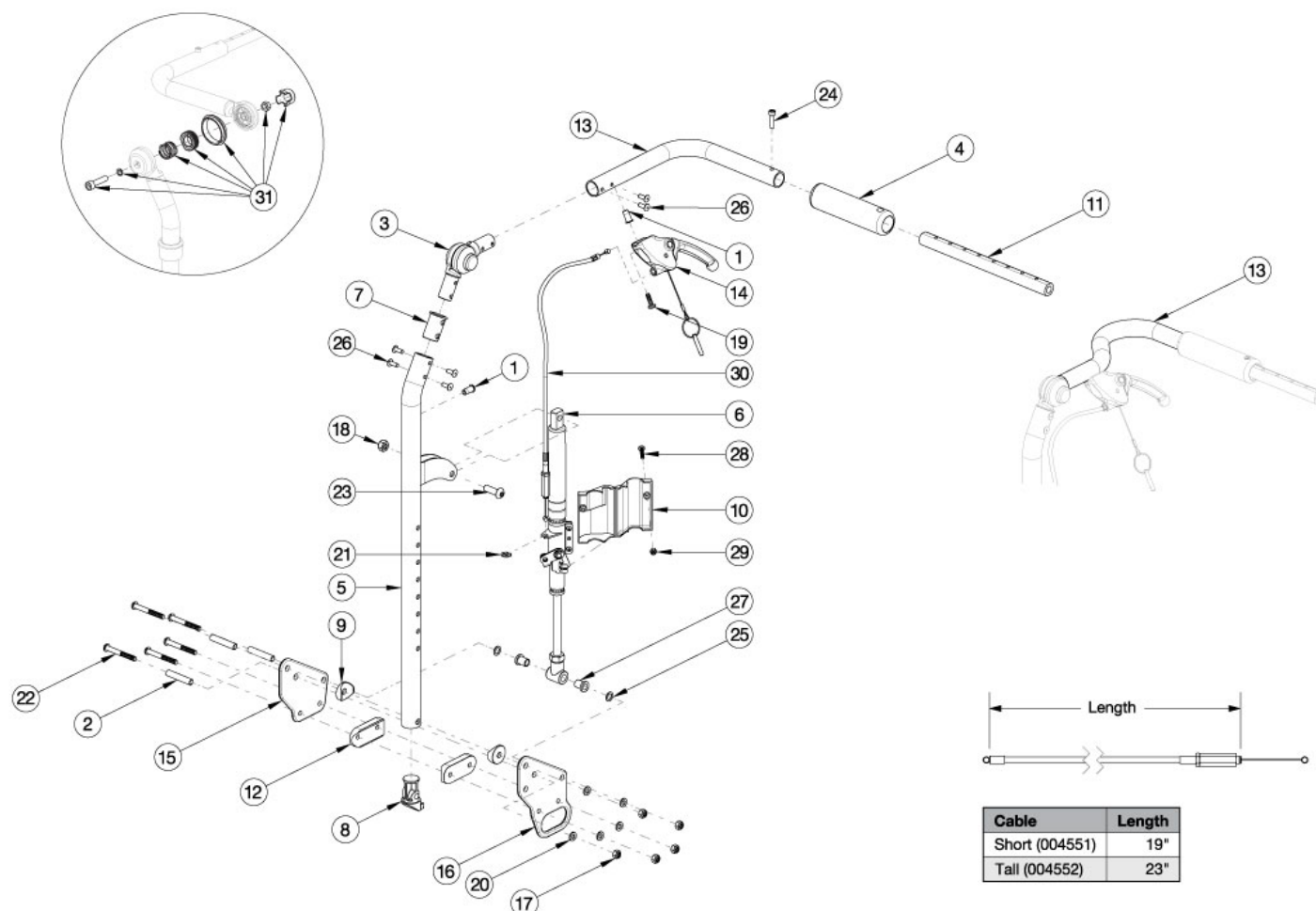

If chair was invoiced prior to 12/18/23, an upper back tube assembly is required. If chair was invoiced after to 12/18/23, parts 3, 5, 7, 13 and 26 shown in the diagram above can now be purchased individually Call Out #13: 10"-13" widths (Pediatric) receive the curved handle and 14"-18" widths receive the "L" shaped handle. Note: Tilt Mechanism parts may be required if changing to a different backrest style. Please see the applicable tilt mechanism parts manual page for verification. If retrofitting, part 003838 found on 'Flip Base Frame' page is required and please select one of the complete kits available below (107689-107696).

Item Number	Part Number	Description	Quantity
2, 9, 12, 15, 17, 20, 22, 25, 27	107697	Reclining Backrest Hardware Kit (one side), Std, Flip	1
2, 9, 12, 15-17, 20, 22, 25, 27	107698	Reclining Backrest Hardware Kit (one side), Transit, Flip	1
1, 3, 4, 5a, 7, 13a, 26	107685	Recline Back Tube Subassembly, Ped, Short, 10-13" Wide, Right Flip	1
1, 3, 4, 5a, 7, 13b, 26	107686	Recline Back Tube Subassembly, Ped, Short, 10-13" Wide, Left Flip	1
1, 3, 4, 5b, 7, 13a, 26	107687	Recline Back Tube Subassembly, Ped, Tall, 10-13" Wide, Right Flip	1
1, 3, 4, 5b, 7, 13b, 26	107688	Recline Back Tube Subassembly, Ped, Tall, 10-13" Wide, Left Flip	1

Item Number	Part Number	Description	Quantity
1, 3, 4, 5a, 7, 13c, 26	107681	Recline Back Tube Subassembly, Short, 14-18" Wide, Right Flip	1
1, 3, 4, 5a, 7, 13d, 26	107682	Recline Back Tube Subassembly, Short, 14-18" Wide, Left Flip	1
1, 3, 4, 5b, 7, 13c, 26	107683	Recline Back Tube Subassembly, Tall, 14-18" Wide, Right Flip	1
1, 3, 4, 5b, 7, 13d, 26	107684	Recline Back Tube Subassembly, Tall, 14-18" Wide, Left Flip	1
1-15, 17-30	107689	Recline Back Kit, Short, 10-13" Wide Flip <i>Kit includes parts for both sides</i>	1
1-15, 17-30	107690	Recline Back Kit, Tall, 10-13" Wide Flip <i>Kit includes parts for both sides</i>	1
1-15, 17-30	107691	Recline Back Kit, Short, 14-18" Wide Flip <i>Kit includes parts for both sides</i>	1
1-15, 17-30	107692	Recline Back Kit, Tall, 14-18" Wide Flip <i>Kit includes parts for both sides</i>	1
1-30	107693	Recline Back Kit, Short, 10-13" Wide, Transit Flip <i>Kit includes parts for both sides</i>	1
1-30	107694	Recline Back Kit, Tall, 10-13" Wide, Transit Flip <i>Kit includes parts for both sides</i>	1
1-30	107695	Recline Back Kit, Short, 14-18" Wide, Transit Flip <i>Kit includes parts for both sides</i>	1
1-30	107696	Recline Back Kit, Tall, 14-18" Wide, Transit Flip <i>Kit includes parts for both sides</i>	1
1, 4, 13d, 24, 26	122918	Push Handle Tube w/ Grip and Hardware, Left	1
1, 4, 13c, 24, 26	122920	Push Handle Tube w/ Grip and Hardware, Right	1
2	001075	Stop Pin Backrest Tilt	3
3	116066	Locking Hinge Assembly <i>Used on chairs starting 12/18/23</i>	1
1, 5a	122738	Back Tube Weld Recline Short <i>Used on chairs starting 12/18/23</i>	1
1, 5b	122739	Back Tube Weld Recline Tall <i>Used on chairs starting 12/18/23</i>	1
6a	001264	Gas Spring Lock 92mm 20kg, Left (Standard Weight Capacity)	1
6b	001265	Gas Spring Lock 92mm 20kg, Right (Standard Weight Capacity)	1
7	001266	Bushing .832 OD x .720 ID	0

Item Number	Part Number	Description	Quantity
8	001267	Plug, Back Tube, Lower, Recline	1
9	001271	1" Saddle, .323 Hole	2
10a	001299	Cover, Gas Spring, Right	1
10b	001298	Cover, Gas Spring, Left	1
11	002578	Growth Strut, Stroller, Short	1
12	002595	Saddle, Dual, 1" OD X 1.5 SP	2
13a	002006	Push Handle, Ped, R <i>Used on chairs starting 12/18/23</i>	1
13b	002007	Push Handle, Ped, L <i>Used on chairs starting 12/18/23</i>	1
14	003492	Lever Assembly, Straight	1
15	003836	Back Plate, Recline, Ped	1
16	003837	Back Plate, Recline, Ped, Transit	1
17	100658	M6 Nylock Nut Blk Zn	5
18	100659	M8 Nylock Nut Blk Zn	1
19	100734	M5 x 16 PHMS ZC	1
20	100746	M6 Flat Washer Blk Zn	5
21	101076	1/4" E Ring	1
22	101781	M6 x 50mm Partial Thread BHCS Blk ZC	5
23	101814	M8 x 25 BHCS Blk Zn	1
24	101843	M5 x 20 SHCS Blk Zn	1
25	101861	Nylon Washer 5/16 x 1/2 x .03	2
26	100669	M5 x 10 BTN SHCS BLKZC w/Patch <i>Used on chairs starting 12/18/23</i>	6
27	102081	Bushing Flange .319 IDx.394 OD	2
28	102328	M4 x 25 Pan Head Phil Blk Zn	1
29	102329	M4 Nylock Nut Blk Zn	1
30a	004551	Cable, Recline, Short Tilt	1
30b	004552	Cable, Recline, Tall Tilt	1

Item Number	Part Number	Description	Quantity
31	110524	Locking Hinge Button Assembly with Instruction <i>This kit contains the contents inside callout # 3. This assembly may not be compatible if chair was invoiced prior to 6/22/16</i>	1