

Focus CR Reclining Backrest

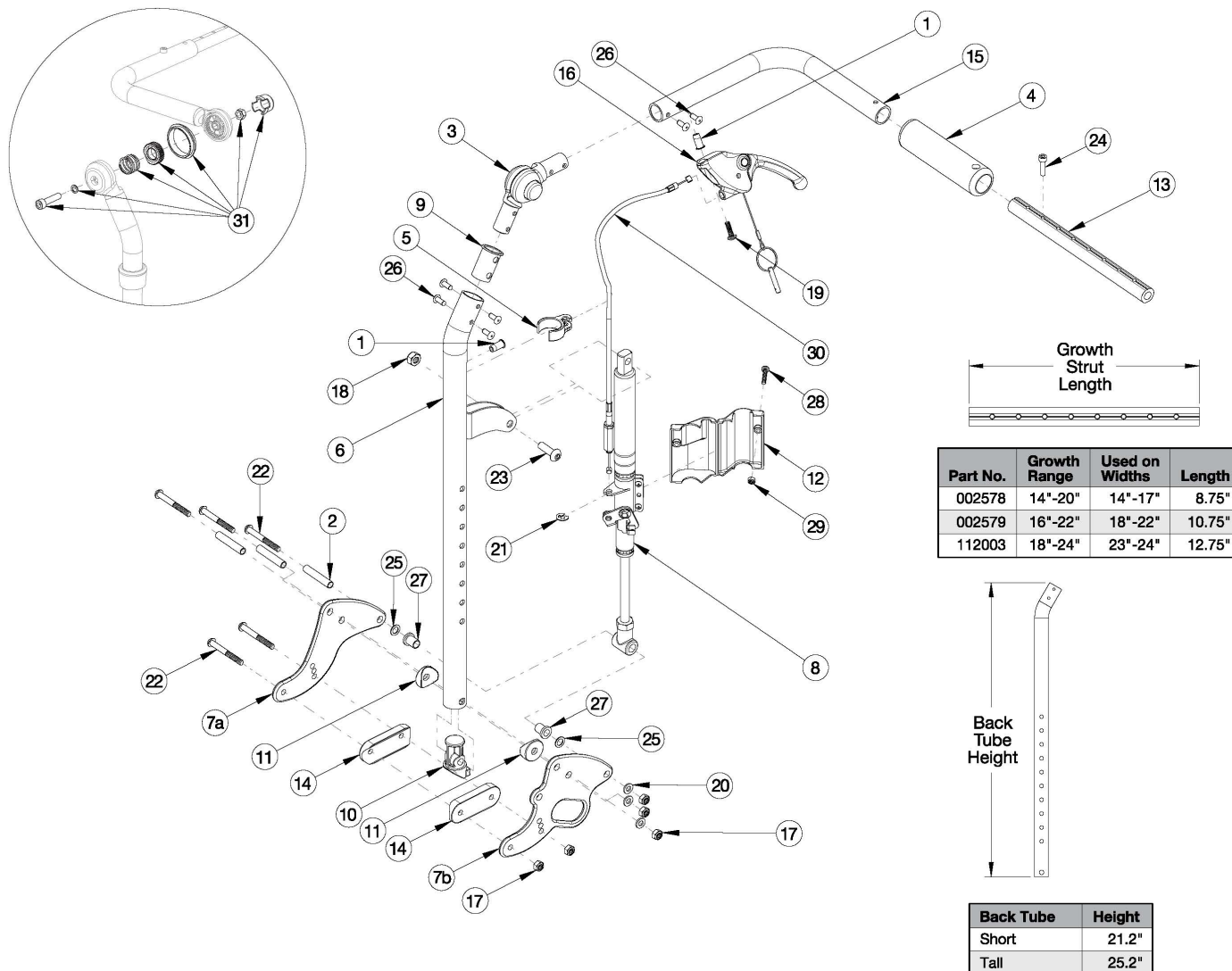

Part No.	Growth Range	Used on Widths	Length
002578	14"-20"	14"-17"	8.75"
002579	16"-22"	18"-22"	10.75"
112003	18"-24"	23"-24"	12.75"

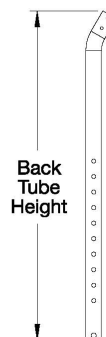

Back Tube	Height
Short	21.2"
Tall	25.2"

If chair was invoiced prior to 12/18/23, an upper back tube assembly is required. If chair was invoiced after to 12/18/23, parts 3, 6, 9, 15 and 26 shown in the diagram above can now be purchased individually. This design effective starting with serial numbers FCR0026599 and FCHD002333. If changing from another style backrest or changing back cane height and the hand tilt is present, a new Hand Tilt Cable/Trigger Kit may be required. If retrofitting to a reclining backrest, and the configuration contains a foot tilt mechanism, a new foot tilt pedal kit is required. If changing from another style and Drum Brake present, Brake Lever may be needed.

Item Number	Part Number	Description	Quantity
1-5, 6a, 7a, 8a, 8b, 9-11, 12a, 12b, 13a, 14, 15a, 15b, 16-29, 30a	506764	Recline Back Kit, Short, 14-20" Width, Standard Gas Spring <i>Kit includes parts for both sides</i>	1

Item Number	Part Number	Description	Quantity
1-5, 6a, 7b, 8a, 8b, 9-11, 12a, 12b, 13a, 14, 15a, 15b, 16-29, 30a	506772	Recline Back Kit, Short, 14-20" Width, Standard Gas Spring, Transit <i>Kit includes parts for both sides</i>	1
1-5, 6a, 7a, 8a, 8b, 9-11, 12a, 12b, 13b, 14, 15a, 15b, 16-29, 30a	506765	Recline Back Kit, Short, 16-22" Width, Standard Gas Spring <i>Kit includes parts for both sides</i>	1
1-5, 6a, 7b, 8a, 8b, 9-11, 12a, 12b, 13b, 14, 15a, 15b, 16-29, 30a	506773	Recline Back Kit, Short, 16-22" Width, Standard Gas Spring, Transit <i>Kit includes parts for both sides</i>	1
1-5, 6a, 7a, 8a, 8b, 9-11, 12a, 12b, 13c, 14, 15a, 15b, 16-29, 30a	114290	Recline Back Kit, Short, 23-24" Width, Standard Gas Spring <i>Kit includes parts for both sides</i>	1
1-5, 6a, 7b, 8a, 8b, 9-11, 12a, 12b, 13c, 14, 15a, 15b, 16-29, 30a	114294	Recline Back Kit, Short, 23-24" Width, Standard Gas Spring, Transit <i>Kit includes parts for both sides</i>	1
1-5, 6b, 7a, 8a, 8b, 9-11, 12a, 12b, 13a, 14, 15a, 15b, 16-29, 30b	506766	Recline Back Kit, Tall, 14-20" Width, Standard Gas Spring <i>Kit includes parts for both sides</i>	1
1-5, 6b, 7b, 8a, 8b, 9-11, 12a, 12b, 13a, 14, 15a, 15b, 16-29, 30b	506774	Recline Back Kit, Tall, 14-20" Width, Standard Gas Spring, Transit <i>Kit includes parts for both sides</i>	1
1-5, 6b, 7a, 8a, 8b, 9-11, 12a, 12b, 13b, 14, 15a, 15b, 16-29, 30b	506767	Recline Back Kit, Tall, 16-22" Width, Standard Gas Spring <i>Kit includes parts for both sides</i>	1
1-5, 6b, 7b, 8a, 8b, 9-11, 12a, 12b, 13b, 14, 15a, 15b, 16-29, 30b	506775	Recline Back Kit, Tall, 16-22" Width, Standard Gas Spring, Transit <i>Kit includes parts for both sides</i>	1
1-5, 6b, 7a, 8a, 8b, 9-11, 12a, 12b, 13c, 14, 15a, 15b, 16-29, 30b	114291	Recline Back Kit, Tall, 23-24" Width, Standard Gas Spring <i>Kit includes parts for both sides</i>	1

Item Number	Part Number	Description	Quantity
1-5, 6b, 7b, 8a, 8b, 9-11, 12a, 12b, 13c, 14, 15a, 15b, 16-29, 30b	114295	Recline Back Kit, Tall, 23-24" Width, Standard Gas Spring, Transit <i>Kit includes parts for both sides</i>	1
1-5, 6a, 7a, 8c, 8d, 9-11, 12a, 12b, 13a, 14, 15a, 15b, 16-29, 30a	506768	Recline Back Kit, Short, 14-20" Width, Heavy Duty Gas Spring <i>Kit includes parts for both sides</i>	1
1-5, 6a, 7b, 8c, 8d, 9-11, 12a, 12b, 13a, 14, 15a, 15b, 16-29, 30a	506776	Recline Back Kit, Short, 14-20" Width, Heavy Duty Gas Spring, Transit <i>Kit includes parts for both sides</i>	1
1-5, 6a, 7a, 8c, 8d, 9-11, 12a, 12b, 13b, 14, 15a, 15b, 16-29, 30a	506769	Recline Back Kit, Short, 16-22" Width, Heavy Duty Gas Spring <i>Kit includes parts for both sides</i>	1
1-5, 6a, 7b, 8c, 8d, 9-11, 12a, 12b, 13b, 14, 15a, 15b, 16-29, 30a	506777	Recline Back Kit, Short, 16-22" Width, Heavy Duty Gas Spring, Transit <i>Kit includes parts for both sides</i>	1
1-5, 6a, 7a, 8c, 8d, 9-11, 12a, 12b, 13c, 14, 15a, 15b, 16-29, 30a	114292	Recline Back Kit, Short, 23-24" Width, Heavy Duty Gas Spring <i>Kit includes parts for both sides</i>	1
1-5, 6a, 7b, 8c, 8d, 9-11, 12a, 12b, 13c, 14, 15a, 15b, 16-29, 30a	114296	Recline Back Kit, Short, 23-24" Width, Heavy Duty Gas Spring, Transit <i>Kit includes parts for both sides</i>	1
1-5, 6b, 7a, 8c, 8d, 9-11, 12a, 12b, 13a, 14, 15a, 15b, 16-29, 30b	506770	Recline Back Kit, Tall, 14-20" Width, Heavy Duty Gas Spring <i>Kit includes parts for both sides</i>	1
1-5, 6b, 7b, 8c, 8d, 9-11, 12a, 12b, 13a, 14, 15a, 15b, 16-29, 30b	506778	Recline Back Kit, Tall, 14-20" Width, Heavy Duty Gas Spring, Transit <i>Kit includes parts for both sides</i>	1
1-5, 6b, 7a, 8c, 8d, 9-11, 12a, 12b, 13b, 14, 15a, 15b, 16-29, 30b	506771	Recline Back Kit, Tall, 16-22" Width, Heavy Duty Gas Spring <i>Kit includes parts for both sides</i>	1

Item Number	Part Number	Description	Quantity
1-5, 6b, 7b, 8c, 8d, 9-11, 12a, 12b, 13b, 14, 15a, 15b, 16-29, 30b	506779	Recline Back Kit, Tall, 16-22" Width, Heavy Duty Gas Spring, Transit <i>Kit includes parts for both sides</i>	1
1-5, 6b, 7a, 8c, 8d, 9-11, 12a, 12b, 13c, 14, 15a, 15b, 16-29, 30b	114293	Recline Back Kit, Tall, 23-24" Width, Heavy Duty Gas Spring <i>Kit includes parts for both sides</i>	1
1-5, 6b, 7b, 8c, 8d, 9-11, 12a, 12b, 13c, 14, 15a, 15b, 16-29, 30b	114297	Recline Back Kit, Tall, 23-24" Width, Heavy Duty Gas Spring, Transit <i>Kit includes parts for both sides</i>	1
1, 3, 4, 6a, 9, 15a, 26	506760	Recline Back Tube Subassembly, Short, Right	1
1, 3, 4, 6a, 9, 15b, 26	506761	Recline Back Tube Subassembly, Short, Left	1
1, 3, 4, 6b, 9, 15a, 26	506762	Recline Back Tube Subassembly, Tall, Right	1
1, 3, 4, 6b, 9, 15b, 26	506763	Recline Back Tube Subassembly, Tall, Left	1
2, 7a, 11, 14, 17, 20, 22, 25, 27	505857	Reclining Backrest Hardware Assembly (One Side), Std Focus	1
2, 7b, 11, 14, 17, 20, 22, 25, 27	505858	Reclining Backrest Hardware Assembly (One Side), Transit Focus	1
1, 4, 15b, 24, 26	122918	Push Handle Tube w/ Grip and Hardware, Left	1
1, 4, 15a, 24, 26	122920	Push Handle Tube w/ Grip and Hardware, Right	1
2	001075	Stop Pin Backrest Tilt	3
3	116066	Locking Hinge Assembly <i>Used on chairs starting 12/18/23</i>	1
5	001117	Cable Clip 1"	1
1, 6a	122738	Back Tube Weld Recline Short <i>Used on chairs starting 12/18/23</i>	1
1, 6b	110122	Back Tube Weld, Recline, Tall	1
7a	001262	Back Plate, Recline Tilt <i>Quantity of 4 used with non-transit. Quantity of 2 used with transit.</i>	2
7b	001263	Back Plate, Recline, Transit Tilt <i>Quantity of 2 used with transit.</i>	2
8a	001264	Gas Spring Lock 92mm 20kg, Left (Standard Weight Capacity)	1

Item Number	Part Number	Description	Quantity
8b	001265	Gas Spring Lock 92mm 20kg, Right (Standard Weight Capacity)	1
8c	001375	Gas Spring Lock 92mm 40kg, Left (Heavy Duty)	1
8d	001376	Gas Spring Lock 92mm 40kg, Right (Heavy Duty)	1
9	001266	Bushing .832 OD x .720 ID <i>Used on chairs starting 12/18/23</i>	1
10	001267	Plug, Back Tube, Lower, Recline	1
11	001271	1" Saddle, .323 Hole	2
12a	001298	Cover, Gas Spring, Left	1
12b	001299	Cover, Gas Spring, Right	1
13a	002578	Growth Strut, Stroller, Short <i>Used on chairs 14"-17" wide</i>	1
13b	002579	Growth Strut, Stroller, Long <i>Used on chairs 18"-22" wide</i>	1
13c	112003	Growth Strut, Stroller, Extra Long <i>Used on chairs 23"-24" wide</i>	1
14	002594	Saddle, Dual, 1" OD X 1.75 SP	2
16	003492	Lever Assembly, Straight	1
17	100658	M6 Nylock Nut Blk Zn	5
18	100659	M8 Nylock Nut Blk Zn	1
19	100734	M5 x 16 PHMS ZC	1
20	100746	M6 Flat Washer Blk Zn	3
21	101076	1/4" E Ring	1
22	101781	M6 x 50mm Partial Thread BHCS Blk ZC	5
23	101814	M8 x 25 BHCS Blk Zn	1
24	101843	M5 x 20 SHCS Blk Zn	1
25	101861	Nylon Washer 5/16 x 1/2 x .03	2
26	100669	M5 x 10 BTN SHCS BLKZC w/Patch <i>Used on chairs starting 12/18/23</i>	6
27	102081	Bushing Flange .319 IDx.394 OD	2
28	102328	M4 x 25 Pan Head Phil Blk Zn	1

Item Number	Part Number	Description	Quantity
29	102329	M4 Nylock Nut Blk Zn	1
30a	004551	Cable, Recline, Short Tilt	1
30b	004552	Cable, Recline, Tall Tilt	1
31	110524	Locking Hinge Button Assembly with Instruction <i>This kit contains the contents inside callout # 3. This assembly may not be compatible if chair was invoiced prior to 6/22/16</i>	1