

# Flip Hand Tilt

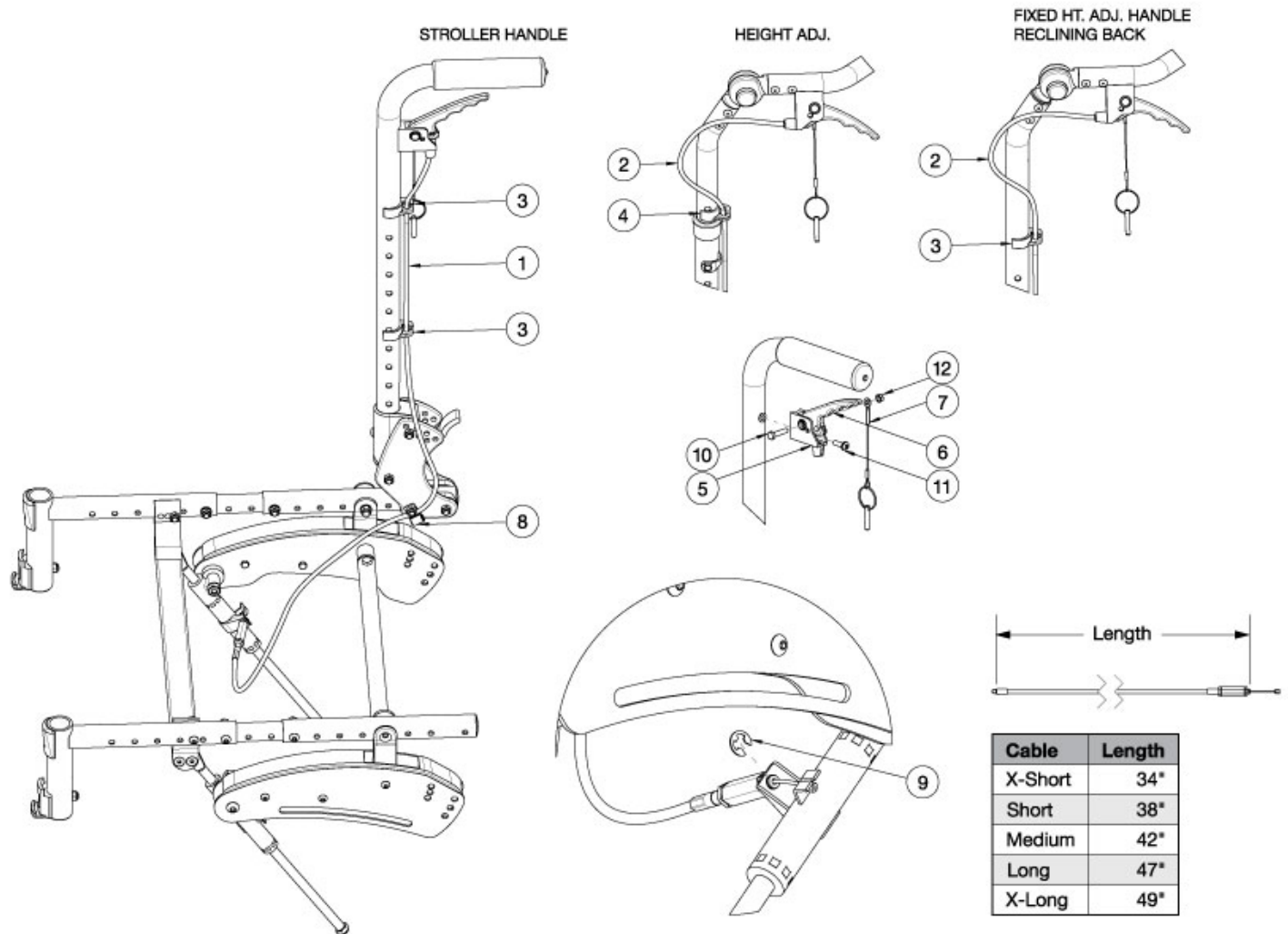

See Flip for Leckey Hand Tilt page if replacing parts for this model. If drum brake is present, see Flip Drum Brake (Hand Tilt) parts manual page. Please Note: Hand Tilt Kits are complete full assemblies containing both sides.

Item Number	Part Number	Description	Quantity
1a, 3, 5, 6a, 7 - 12	502823	Hand Tilt Kit, Short Stroller Handle Backrest, 12-13" Depth, FLIP	1
1b, 3, 5, 6a, 7 - 12	502824	Hand Tilt Kit, Short Stroller Handle Backrest, 14-20" Depth, FLIP	1
1b, 3, 5, 6a, 7 - 12	114426	Hand Tilt Kit, Tall Stroller Handle Backrest, 12-16" Depth, FLIP	1
1c, 3, 5, 6a, 7 - 12	503165	Hand Tilt Kit, Tall Stroller Handle Backrest, 17-19" Depth, FLIP	1
2a, 3, 5, 6a, 7 - 12	503079	Hand Tilt Kit, Tall Stroller Handle Backrest, 20" Depth, FLIP	1
1a, 3, 5, 6a, 7 - 12	114427	Hand Tilt Kit, Short Reclining Backrest, 12-13" Depth, FLIP	1
1b, 3, 5, 6a, 7 - 12	114428	Hand Tilt Kit, Short Reclining Backrest, 14-20" Depth, FLIP	1

Item Number	Part Number	Description	Quantity
1b, 3, 5, 6a, 7 - 12	114429	Hand Tilt Kit, Tall Reclining Backrest, 12-16" Depth, FLIP	1
1c, 3, 5, 6a, 7 - 12	114430	Hand Tilt Kit, Tall Reclining Backrest, 17-19" Depth, FLIP	1
2a, 3, 5, 6a, 7 - 12	114431	Hand Tilt Kit, Tall Reclining Backrest, 20" Depth, FLIP	1
2a, 3, 5, 6b, 7 - 12	505250	Hand Tilt Kit, Short Fixed Height w/ Adjustable Handle Backrest, FLIP	1
2b, 3, 5, 6b, 7 - 12	505251	Hand Tilt Kit, Tall Fixed Height w/ Adjustable Handle Backrest, FLIP	1
2a, 3 - 5, 6b, 7 - 12	502825	Hand Tilt Kit, Short Adjustable Height w/ Adjustable Handle Backrest, FLIP	1
2b, 3 - 5, 6b, 7 - 12	502826	Hand Tilt Kit, Tall Adjustable Height w/ Adjustable Handle Backrest, FLIP	1
5, 6a, 7, 10 - 12	501111	Trigger Assembly Vertical Tilt <i>Used with Stroller Handle backrests and Reclining backrests.</i>	1
5, 6b, 7, 10 - 12	501112	Trigger Assembly Horizontal Tilt <i>Used with Adjustable Height w/ Adjustable Handle and Fixed Height w/ Adjustable Handle backrests.</i>	1
1a, 9	502830	Cable, Hand Tilt, Extra Short FLIP <i>Used on 12-13" deep chairs with Short Stroller Handle backrests or 12-13" deep chairs with Short Reclining backrest.</i>	1
1b, 9	502831	Cable, Hand Tilt, Short FLIP <i>Used on 12-16" deep chairs with Tall Stroller Handle backrests or 12-16" deep chairs with Tall Reclining backrests. Used on 14-20" deep chairs with Short Stroller Handle backrests or 14-20" deep chairs with Short Reclining backrests.</i>	1
1c, 9	503164	Cable, Hand Tilt, Medium FLIP <i>Used on 17-19" deep chairs with Tall Stroller Handle backrests or 17-19" deep chairs with Tall Reclining backrest.</i>	1
2a, 9	502832	Cable, Hand Tilt, Long FLIP <i>Used on 20" deep chairs with Tall Stroller Handle backrests or 20" deep chairs with Tall Reclining backrest. Used on Short Adjustable Height w/ Adjustable Handle backrests and Short Fixed Height w/ Adjustable Handle backrests.</i>	1
2b, 9	502833	Cable, Hand Tilt, Extra Long FLIP <i>Used on Tall Adjustable Height w/ Adjustable Handle backrests and Tall Fixed Height w/ Adjustable Handle backrests.</i>	1
3	001117	Cable Clip 1"	4
4	001118	Cable Clip 7/8"	2
5	003638	Trigger Mount, No Lockout	2
6a	001122	Trigger Vertical TILT	2

Item Number	Part Number	Description	Quantity
		<i>Used with Stroller Handle backrests and Reclining backrests.</i>	
6b	001123	Trigger Horizontal <i>Used with Adjustable Height w/ Adjustable Handle backrests and Fixed Height w/ Adjustable Handle backrests.</i>	2
7	001124	Pin with Lanyard	2
8	001239	P-Clip 3/16"	2
9	102822	E-Ring, M6, YZ	2
10	101820	M5 x 22 HHCS Blk Zn	2
11	100734	M5 x 16 PHMS ZC	2
12	100657	M5 Nylock Nut Blk Zn	2