

CR45 Fixed Height with Adjustable Handle Backrest - Growth

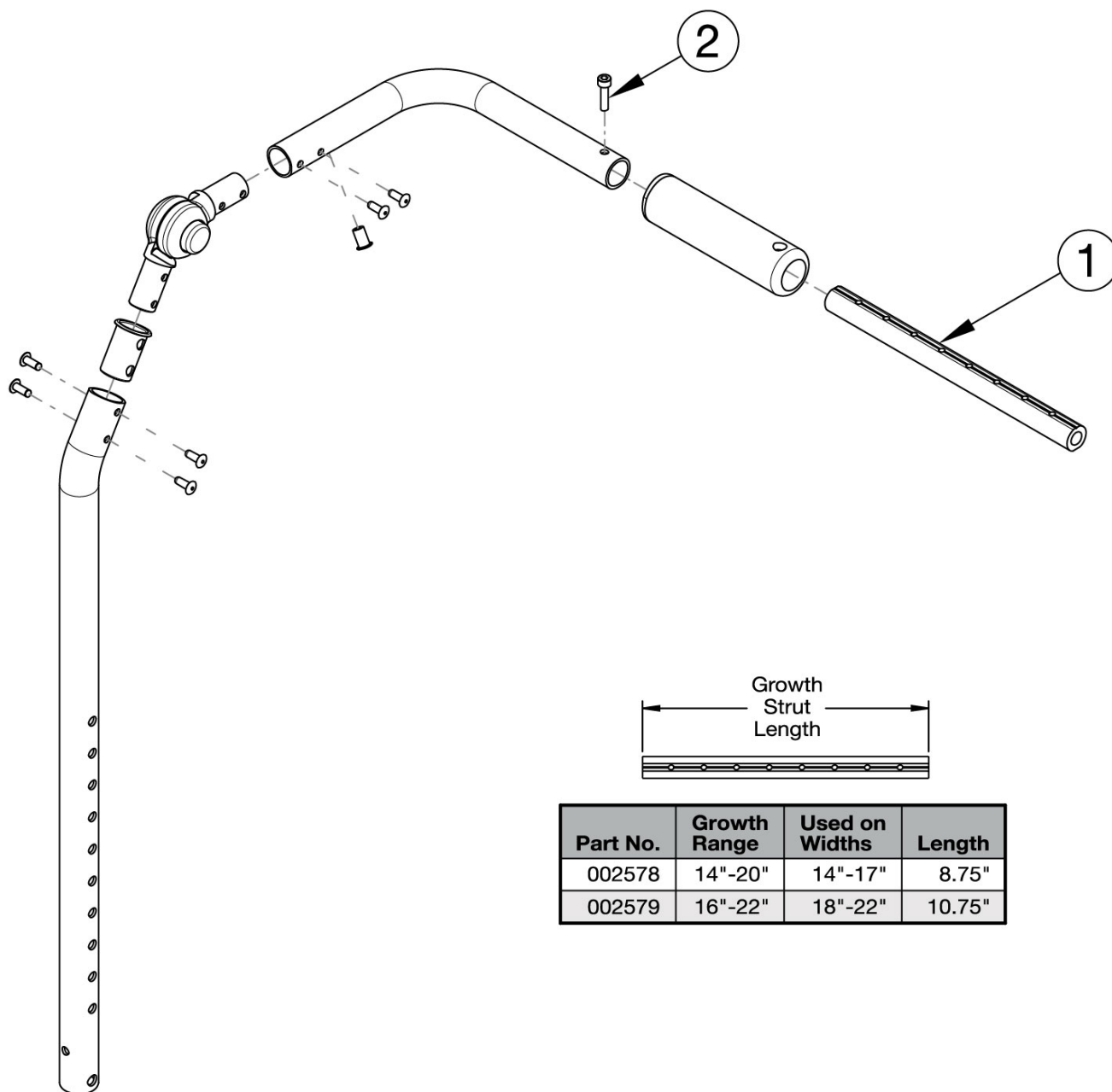

Part No.	Growth Range	Used on Widths	Length
002578	14"-20"	14"-17"	8.75"
002579	16"-22"	18"-22"	10.75"

Has your width changed? If yes, verify the current growth strut will work or select appropriately below. If chair was invoiced prior to 12/18/23, an upper back tube assembly is required. If chair was invoiced after to 12/18/23, upper back tube assembly parts can now be purchased individually

Item Number	Part Number	Description	Quantity
1a, 2	503107	Growth Strut Assembly Short, Focus/Flip <i>Used on chairs 14"-17" wide</i>	1

Item Number	Part Number	Description	Quantity
1b, 2	503108	Growth Strut Assembly Long, Flip/Focus <i>Used on chairs 18"-22" wide</i>	1