

Catalyst 4 Cross Braces - Open Seating (Seating System) - Growth

USED ON 21"-22" WIDE OR HEAVY DUTY

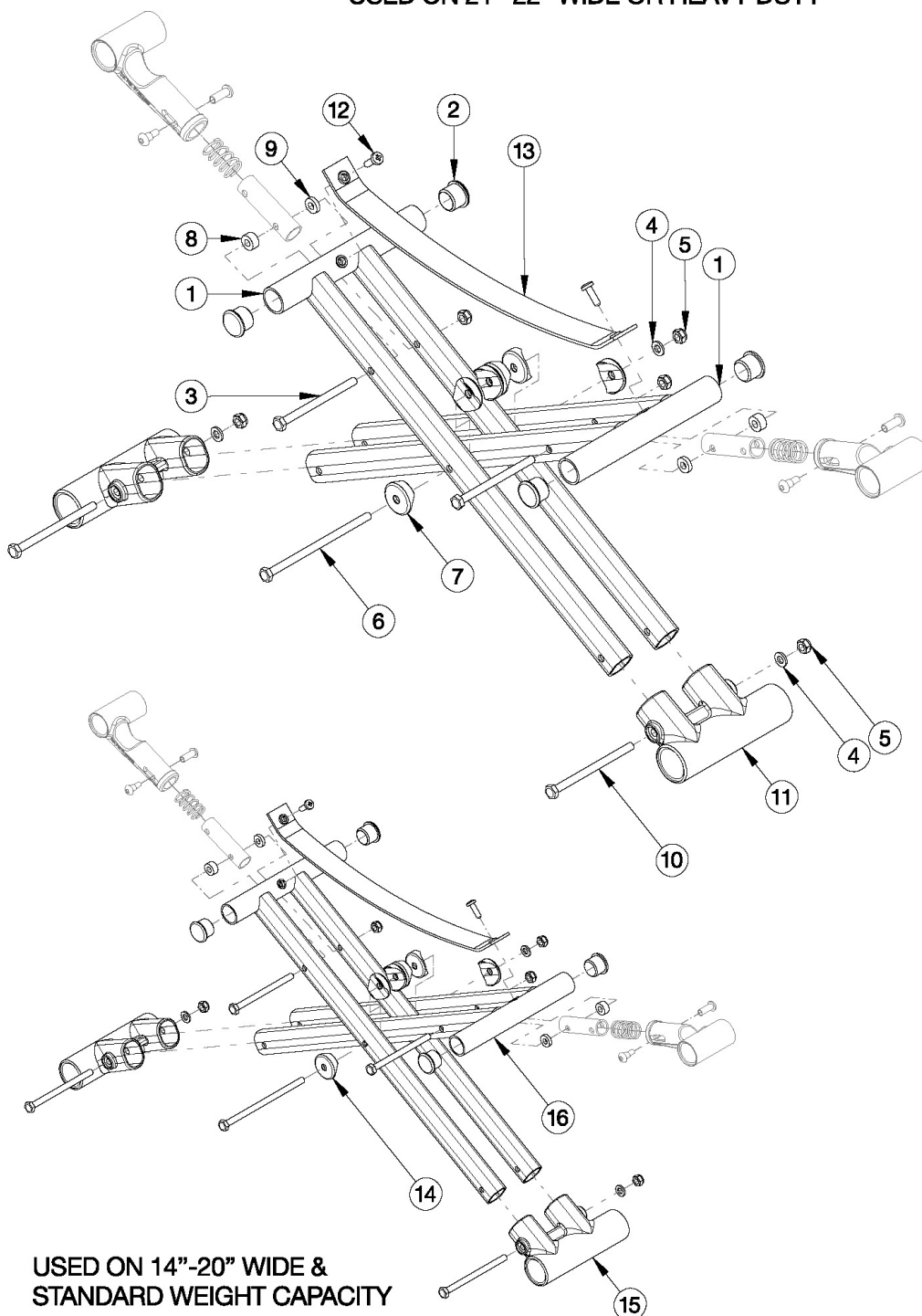

Oval-style cross braces effective 6/15/16 on 21" - 22" wide chairs and chairs with Heavy Duty option. Starting with serial numbers C4018744, C4HD002701. Round-style cross braces are used on 14" - 20" wide chairs with the Standard Weight Capacity. When changing from round-style to oval-style cross braces, lower frame pivots and cross brace hardware are required. Order kit 502177.

| Item Number | Part Number | Description | Quantity |
|-------------|-------------|--|----------|
| 3-10 | 501398 | Round-Style Cross Brace Hardware Kit CAT <i>Used on 14" - 20" Wide and Standard Weight Capacity</i> | 1 |
| 3-10 | 503320 | Catalyst Cross Brace Hardware Kit <i>Used on 21" -22" Wide or Heavy Duty Option</i> | 1 |
| 16a, 2 | 101747 | Open Seat Cross Tube 14" Wide CAT <i>Used with Standard Weight Capacity</i> | 1 |
| 1a, 2 | 003353 | Seating System Cross Brace 14" Wide CAT <i>Used with Heavy Duty Option</i> | 1 |
| 16b, 2 | 101748 | Open Seat Cross Tube 15" Wide CAT <i>Used with Standard Weight Capacity</i> | 1 |
| 1b, 2 | 003354 | Seating System Cross Brace 15" Wide CAT <i>Used with Heavy Duty Option</i> | 1 |
| 16c, 2 | 101749 | Open Seat Cross Tube 16" Wide CAT <i>Used with Standard Weight Capacity</i> | 1 |
| 1c, 2 | 003355 | Seating System Cross Brace 16" Wide CAT <i>Used with Heavy Duty Option</i> | 1 |
| 16d, 2 | 101750 | Open Seat Cross Tube 17" Wide CAT <i>Used with Standard Weight Capacity</i> | 1 |
| 1d, 2 | 003356 | Seating System Cross Brace 17" Wide CAT <i>Used with Heavy Duty Option</i> | 1 |
| 16e, 2 | 101751 | Open Seat Cross Tube 18" Wide CAT <i>Used with Standard Weight Capacity</i> | 1 |
| 1e, 2 | 003357 | Seating System Cross Brace 18" Wide CAT <i>Used with Heavy Duty Option</i> | 1 |
| 16f, 2 | 101752 | Open Seat Cross Tube 19" Wide CAT <i>Used with Standard Weight Capacity</i> | 1 |
| 1f, 2 | 003358 | Seating System Cross Brace 19" Wide CAT <i>Used with Heavy Duty Option</i> | 1 |
| 16g, 2 | 101753 | Open Seat Cross Tube 20" Wide CAT <i>Used with Standard Weight Capacity</i> | 1 |
| 1g, 2 | 003359 | Seating System Cross Brace 20" Wide CAT <i>Used with Heavy Duty Option</i> | 1 |
| 16h, 2 | 101754 | Open Seat Cross Tube 21" Wide CAT | 1 |

| Item Number | Part Number | Description | Quantity |
|-------------|-------------|--|----------|
| | | <i>This round style cross brace is no longer used, effective 6/15/16</i> | |
| 1h, 2 | 003360 | Seating System Cross Brace 21" Wide CAT | 1 |
| 16i, 2 | 101755 | Open Seat Cross Tube 22" Wide CAT <i>This round style cross brace is no longer used, effective 6/15/16</i> | 1 |
| 1i, 2 | 003361 | Seating System Cross Brace 22" Wide CAT | 1 |
| 2 | 101162 | 7/8 OD End Plug BLK | 2 |
| 3 | 100660 | M6 x 80mm CLS8.8 DIN931 HHCS ZC | 2 |
| 4 | 100746 | M6 Flat Washer Blk Zn | 1 |
| 5 | 100658 | M6 Nylock Nut Blk Zn | 3 |
| 6 | 100678 | M6 x 110 CLS8.8 DIN931 HHCS ZC | 1 |
| 7 | 002807 | Cross Tube Saddle CAT <i>Used on 21" -22" Wide or Heavy Duty Option</i> | 6 |
| 8 | 100880 | 1/4" Plastic Spacer <i>Not used on 14" wide chairs</i> | 2 |
| 9 | 105019 | 3/16" Plastic Spacer <i>Not used on 14" wide chairs</i> | 2 |
| 10 | 100704 | M6 x 90 CLS8.8 DIN931 HHCS ZC | 2 |
| 11 | 002806 | Lower Frame Pivot CAT <i>Used on 21" -22" Wide or Heavy Duty Option</i> | 1 |
| 3-7, 10, 11 | 107296 | Lower Frame Pivot and Catalyst Oval-Style Cross Brace Hardware Kit 14" Wide (Pair) <i>Used on 14" Wide with Heavy Duty Option</i> | 1 |
| 3-11 | 502177 | Lower Frame Pivot and Catalyst Oval-Style Cross Brace Hardware Kit (Pair) <i>Used on 21" -22" Wide or Heavy Duty Option</i> | 1 |
| 12 | 100734 | M5 x 16 PHMS ZC | 2 |
| 13a | 200233 | Seat Strap Open Frame 14" Wide CAT | 1 |
| 13b | 200234 | Seat Strap Open Frame 15" Wide CAT | 1 |
| 13c | 200235 | Seat Strap Open Frame 16" Wide CAT | 1 |
| 13d | 200236 | Seat Strap Open Frame 17" Wide CAT | 1 |
| 13e | 200237 | Seat Strap Open Frame 18" Wide CAT | 1 |
| 13f | 200238 | Seat Strap Open Frame 19" / 21" Wide CAT | 1 |
| 13g | 200239 | Seat Strap Open Frame 20"/22" Wide CAT | 1 |

| Item Number | Part Number | Description | Quantity |
|-------------|-------------|---|----------|
| 14 | 000054 | Saddle 7/8" <i>Used on 14" - 20" Wide and Standard Weight Capacity</i> | 4 |
| 15 | 000001 | Lower Frame Pivot CAT <i>Used on 14" - 20" Wide and Standard Weight Capacity</i> | 1 |