

Catalyst 5 Anti-Tip Receiver

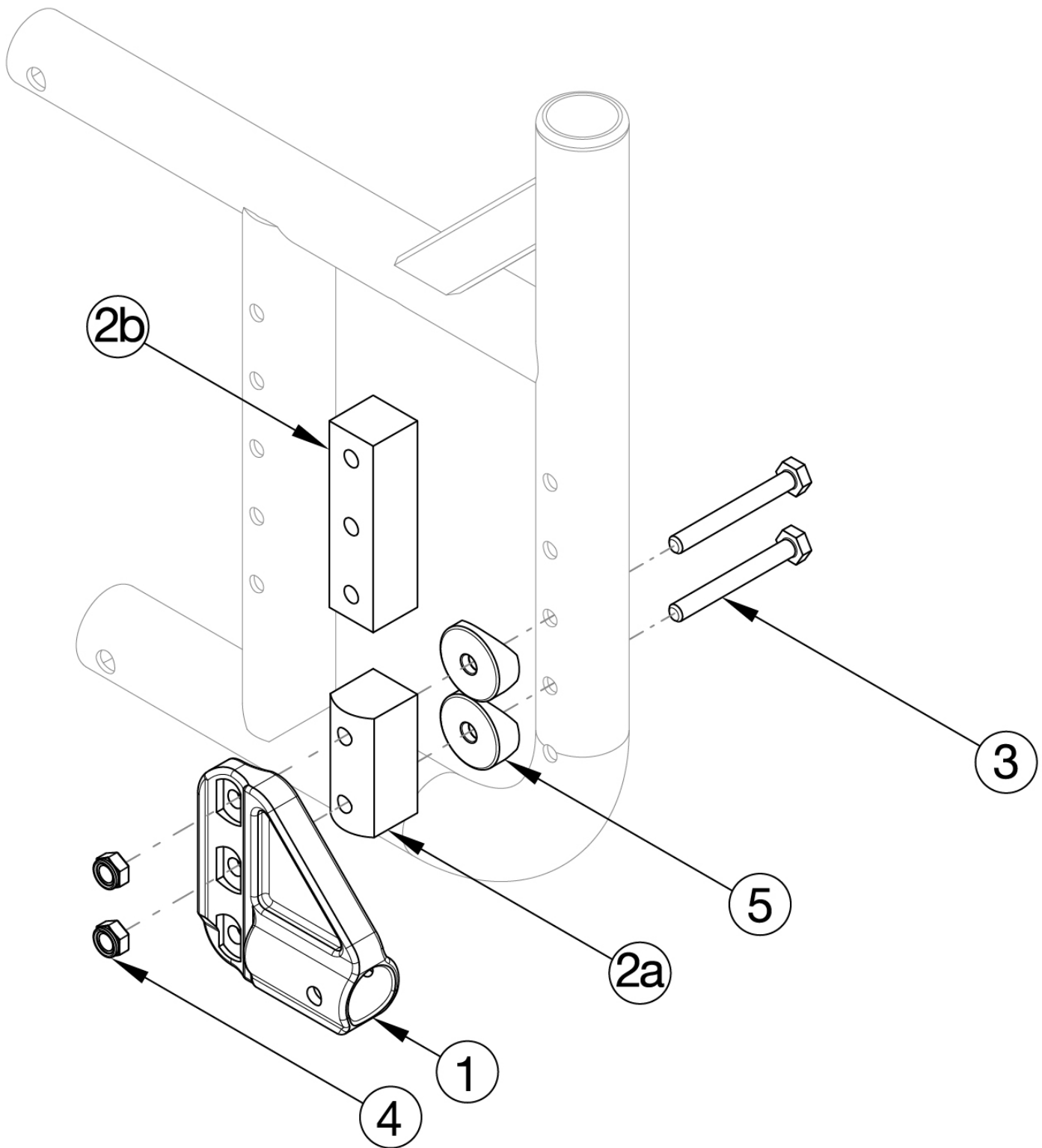

For other hardware options, please reference the Catalyst 5 Axle Plate pages. If retrofitting to universal axle plates and the chair was invoiced prior to November 14, 2018, new anti-tip receivers are required. If retrofitting to a Reclining Rear Frame, Amputee Anti-Tip Spacers and Saddles are required. Please see the Catalyst 5 Swing-In Anti-Tip page for Swing-In Anti-Tip replacements

| Item Number | Part Number | Description | Quantity |
|------------------|-------------|--|----------|
| 1, 3a, 4 | 123854 | Anti Tip Hardware with Universal Axle Plate and Receiver | 1 |
| 1, 2a, 3b, 4, 5a | 123855 | Anti Tip Hardware with Amputee Axle Plate and Receiver, Standard Rear Frame, No Transit | 1 |
| 1, 2a, 3b, 4, 5b | 123856 | Anti Tip Hardware with Amputee Axle Plate and Receiver, Depth Adjustable / Reclining Rear Frame, No Transit | 1 |
| 1, 2b, 3b, 4, 5a | 123857 | Anti Tip Hardware with Amputee Axle Plate and Receiver, Standard Rear Frame, with Transit | 1 |
| 1, 2b, 3b, 4, 5b | 123858 | Anti Tip Hardware with Amputee Axle Plate and Receiver, Depth Adjustable / Reclining Rear Frame, with Transit | 1 |
| 1 | 004539 | Anti Tip Receiver, Catalyst <i>Used with Universal Axle Plate or if chair has an invoice date after November 13, 2018. Replacement for 000046</i> | 1 |
| 2a | 002329 | Amputee Anti-Tip Spacer CAT <i>Used when Transit not present and Anti-Tips are present with Amputee Axle Plate</i> | 1 |
| 2b | 003341 | Amputee Anti-Tip Spacer w/ Transit CAT <i>Used when Transit and Anti-Tips are present with Amputee Axle Plate</i> | 1 |
| 3a | 101826 | M6 x 50 HHCS Blk Zn <i>Used when Amputee Anti-Tip Spacers are not present</i> | 2 |
| 3b | 100544 | M6 x 75 CLS 8.8 DIN931 HHCS ZC <i>Used with Amputee Anti-Tip Spacers</i> | 2 |
| 4 | 100658 | M6 Nylock Nut Blk Zn | 2 |
| 5a | 000056 | Saddle 1 1/8" <i>Used with Amputee Anti-Tip Spacers and Standard Rear Frame</i> | 3 |
| 5b | 000055 | Saddle 1" <i>Used with Amputee Anti-Tip Spacers and Depth Adjustable or Reclining Rear Frame</i> | 3 |