

Tsunami Little Wave Caster Mount

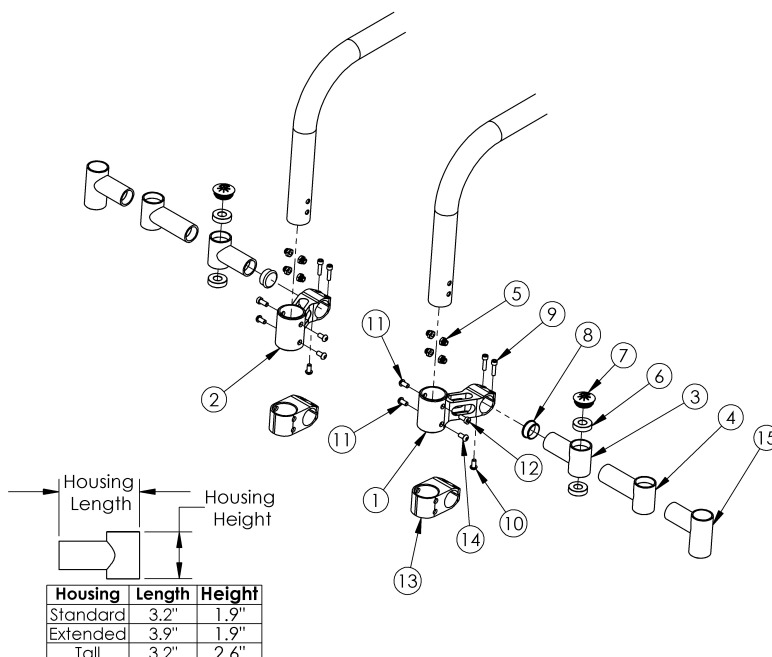

If quoting a replacement frame, caster mounts are included with the new frame. If transit is present, we cannot change from pediatric to standard without replacing the frame as the mounts require different holes to be drilled.

Item Number	Part Number	Description	Quantity
1, 5, 11a, 11b, 12a, 12b	502648	Caster Mount Assembly With Hardware Left, RG ALX/LW XP	1
2, 5, 11a, 11b, 12a, 12b	502649	Caster Mount Assembly With Hardware Right, RG ALX/LW XP	1
3, 6 - 8, 9a, 10	502650	Caster Housing Assembly With Hardware Standard Left, RG ALX/LW XP	1
3, 6 - 8, 9a, 10	505239	Caster Housing Assembly With Hardware Standard Right, RG ALX/LW XP	1
4, 6 - 8, 9b, 10	502651	Caster Housing Assembly With Hardware Extended Left, RG ALX/LW XP	1
4, 6 - 8, 9b, 10	505240	Caster Housing Assembly With Hardware Extended Right, RG ALX/LW XP	1

Item Number	Part Number	Description	Quantity
1, 3, 5 - 12	501178	Caster Mount Assembly With Standard Housing Left, RG ALX/LW XP	1
2, 3, 5 - 12	501179	Caster Mount Assembly With Standard Housing Right, RG ALX/LW XP	1
1-3, 5 - 12	501180	Caster Mount Assembly With Standard Housing Pair, RG ALX/LW XP	1
1, 4 - 12	501181	Caster Mount Assembly With Ext Housing Left, RG ALX/LW XP	1
2, 4 - 12	501182	Caster Mount Assembly With Ext Housing Right, RG ALX/LW XP	1
1, 2, 4 - 12	501183	Caster Mount Assembly With Ext Housing Pair, RG ALX/LW XP	1
5, 11a, 11b, 12a, 12b, 13, 14	502652	Caster Mount Assembly Pediatric With Hardware One Side, RG ALX/LW XP	1
3, 5, 7, 8, 9b, 10, 11a, 11b, 12a, 12b, 13, 14	501184	Caster Mount Assembly Pediatric w/ Standard Housing Left, LW XP	1
3, 5, 7, 8, 9b, 10, 11a, 11b, 12a, 12b, 13, 14	505237	Caster Mount Assembly Pediatric w/ Standard Housing Right, LW XP	1
3, 5, 7, 8, 9b, 10, 11a, 11b, 12a, 12b, 13, 14	501185	Caster Mount Assembly Pediatric w/ Standard Housing Pair, LW XP	1
4, 5, 7, 8, 9b, 10, 11a, 11b, 12a, 12b, 13, 14	501186	Caster Mount Assembly Pediatric w/ Ext Housing Left, LW XP	1
4, 5, 7, 8, 9b, 10, 11a, 11b, 12a, 12b, 13, 14	505238	Caster Mount Assembly Pediatric w/ Ext Housing Right, LW XP	1
4, 5, 7, 8, 9b, 10, 11a, 11b, 12a, 12b, 13, 14	501187	Caster Mount Assembly Pediatric w/ Ext Housing Pair, LW XP	1
1	000390L	Caster Mount AL Left, RG ALX/LW XP	1
2	000390R	Caster Mount AL Right, RG ALX/LW XP	1
3, 6	000251	Caster Housing, RG ALX/LW XP	2
4, 6	000458	Caster Housing Extended, RG ALX/LW XP	2
5	000491	Caster T-Nut, RG ALX/LW XP	8
6	100530	Bearing M28 x 1/2" 6001RS	4
7	102005	Ki Caster Housing Cap	2
8	100532	Tube End Plug 1 1/8"	2

Item Number	Part Number	Description	Quantity
9a	101843	M5 x 20 SHCS Blk Zn <i>Used with standard caster mount.</i>	4
9b	101120	M5 x 16 SHCS BLZ <i>Used with pediatric caster mount.</i>	4
10	100667	M6 x 12 BTN SHCS BLKZC w/Patch	2
11a	101184	M6 x 10 BTN SHCS BLKZC w/Patch <i>Used when transit brackets not present.</i>	4
11b	101708	M6 x 14 BTN SHCS BLKZC w/Patch <i>Used with transit brackets.</i>	4
12a	101185	M6 x 14 CLS8.8 DIN7984 Low SHCS BLKZC <i>Used when footrest is not high-mounted.</i>	2
12b	101184	M6 x 10 BTN SHCS BLKZC w/Patch <i>Used with high-mounted footrests.</i>	2
13	000547	Pediatric Caster Mount	2
14	101184	M6 x 10 BTN SHCS BLKZC w/Patch	2