

(Discontinued) Rigid Stroller Handle

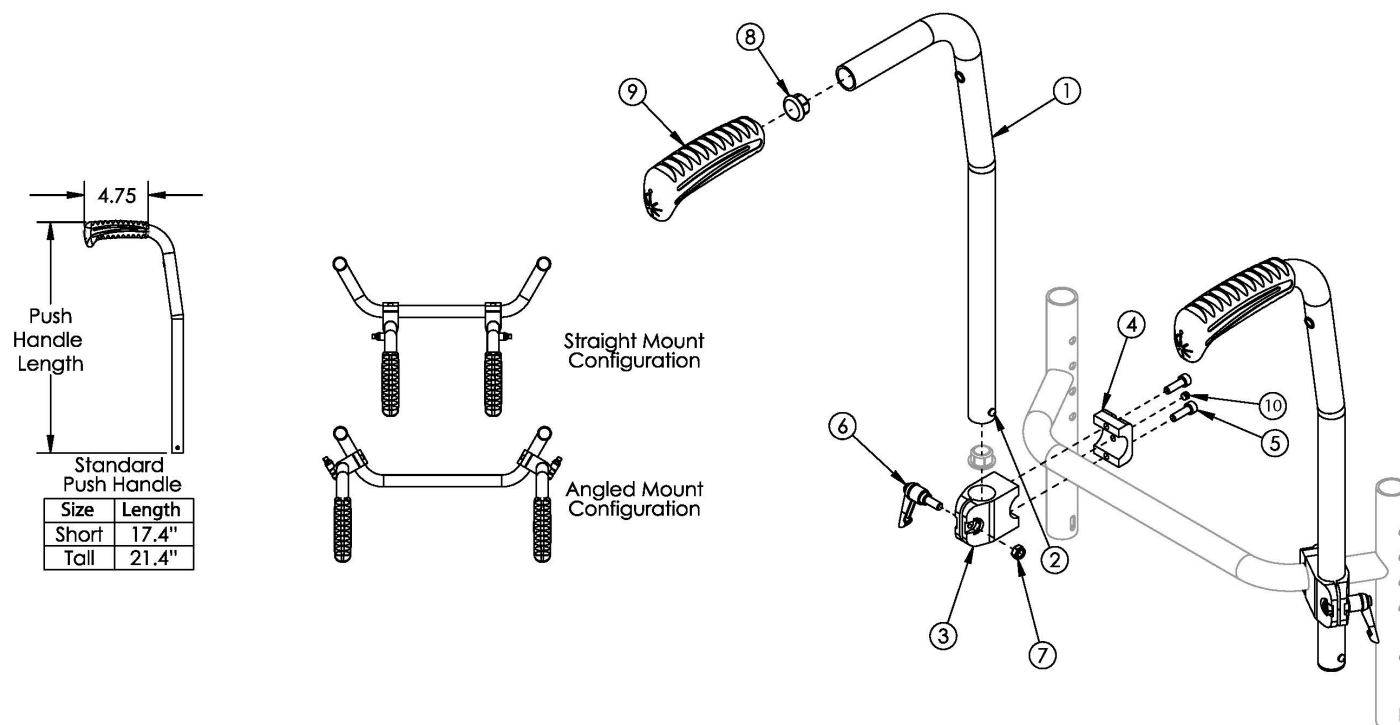

If changing from another style push handle and the Drum Brake is present, a new Drum Brake Cable Kit may be required. If quoting a Clamp On Rigidizer Mounted Stroller Handle after 7/1/2025, please refer to the new Single Rigid Stroller Handle or Dual Rigid Stroller Handle Pages for the correct Handles and corresponding Rigidizer Bars.

Item Number	Part Number	Description	Quantity
1c, 2, 8, 9	113197	Stroller Handle Back Post 8° Bend Short with Backcane Extension, Drum Brake <i>Used on chairs with 15" or greater rear seat height and drum brake is present. To view the backcane extension included in this kit, see Rogue XP / Klik / Little Wave XP Drum Brake page.</i>	1
2	100534	Detent Button Lower	1
3	000540	Stroller Handle Clamp Rigid	1
4, 5, 10	503802	Push Handle Half Clamp w/ Set Screw <i>Replaced part number 000474</i>	1
5	101180	M6 x 20 SHCS BLK ZC	2
6	102734	Stroller Handle Clamp Handle (16mm) Rigid/Flip/Tyke	1
7	100658	M6 Nylock Nut Blk Zn	1
3 - 7, 10	501468	Stroller Handle Clamp Assembly Each Rigid	1
8	100803	Tube End Plug 7/8"	2

Item Number	Part Number	Description	Quantity
9	109433	Ergo Push Handle Grip 7/8" Standard with Instruction	1