

(Discontinued 2) Ethos / Rogue Height Adjustable Back Post with Non-Adjustable Height Rigidizer Bar

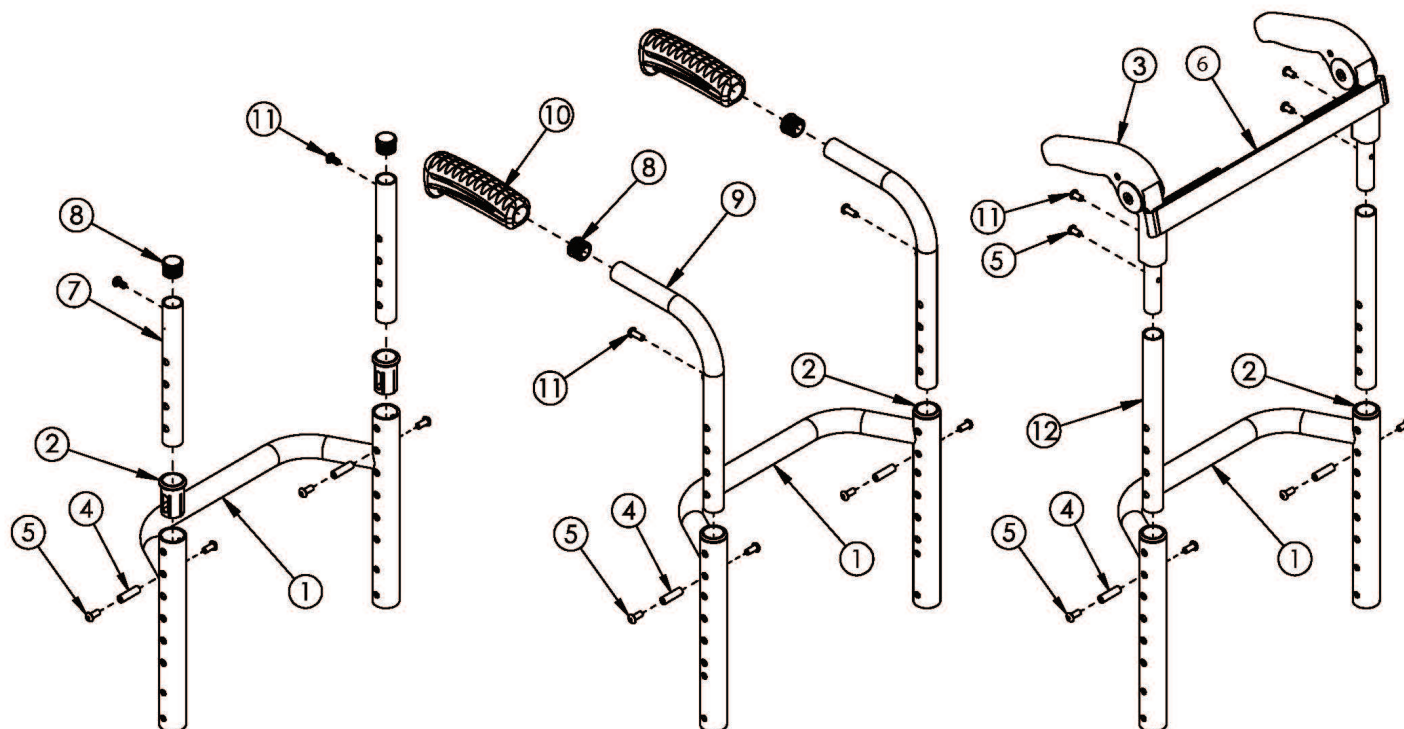

If chair was ordered with Rigid Locking Fold Down Back, please see Rigid Height Adjustable Back Post with Non-Adjustable Height Rigidizer Bar page. Effective on Rogue starting with serial number RG0016612. If retrofitting to this backrest on Rogue, a new backrest mount and hardware may be required. Tension Straps (#6) are based on seat width and used in combination with back upholstery.

Item Number	Part Number	Description	Quantity
1a	003719	Rigid Backrest, 8.063", 12" Wide <i>Used with standard push handles, low push handles or omit push handles in any back height range or used with fold down push handles with tall back height range</i>	1
1b	108672	Rigid Backrest, 6.063", 12" Wide <i>Used with fold down push handles with short back height range</i>	1
1c	108659	Rigid Backrest, 7.063", 12" Wide <i>Used with fold down push handles with medium back height range</i>	1
1d	003720	Rigid Backrest, 8.063", 13" Wide <i>Used with standard push handles, low push handles or omit push handles in any back height range or used with fold down push handles with tall back height range</i>	1
1e	108673	Rigid Backrest, 6.063", 13" Wide	1

Item Number	Part Number	Description	Quantity
		<i>Used with fold down push handles with short back height range</i>	
1f	108660	Rigid Backrest, 7.063", 13" Wide <i>Used with fold down push handles with medium back height range</i>	1
1g	003721	Rigid Backrest, 8.063", 14" Wide <i>Used with standard push handles, low push handles or omit push handles in any back height range or used with fold down push handles with tall back height range</i>	1
1h	108674	Rigid Backrest, 6.063", 14" Wide <i>Used with fold down push handles with short back height range</i>	1
1i	108661	Rigid Backrest, 7.063", 14" Wide <i>Used with fold down push handles with medium back height range</i>	1
1j	003722	Rigid Backrest, 8.063", 15" Wide <i>Used with standard push handles, low push handles or omit push handles in any back height range or used with fold down push handles with tall back height range</i>	1
1k	108675	Rigid Backrest, 6.063", 15" Wide <i>Used with fold down push handles with short back height range</i>	1
1l	108662	Rigid Backrest, 7.063", 15" Wide <i>Used with fold down push handles with medium back height range</i>	1
1m	003723	Rigid Backrest, 8.063", 16" Wide <i>Used with standard push handles, low push handles or omit push handles in any back height range or used with fold down push handles with tall back height range</i>	1
1n	108676	Rigid Backrest, 6.063", 16" Wide <i>Used with fold down push handles with short back height range</i>	1
1o	108663	Rigid Backrest, 7.063", 16" Wide <i>Used with fold down push handles with medium back height range</i>	1
1p	003724	Rigid Backrest, 8.063", 17" Wide <i>Used with standard push handles, low push handles or omit push handles in any back height range or used with fold down push handles with tall back height range</i>	1
1q	108677	Rigid Backrest, 6.063", 17" Wide <i>Used with fold down push handles with short back height range</i>	1
1r	108664	Rigid Backrest, 7.063", 17" Wide <i>Used with fold down push handles with medium back height range</i>	1
1s	003725	Rigid Backrest, 8.063", 18" Wide	1

Item Number	Part Number	Description	Quantity
		<i>Used with standard push handles, low push handles or omit push handles in any back height range or used with fold down push handles with tall back height range</i>	
1t	108678	Rigid Backrest, 6.063", 18" Wide <i>Used with fold down push handles with short back height range</i>	1
1u	108665	Rigid Backrest, 7.063", 18" Wide <i>Used with fold down push handles with medium back height range</i>	1
1v	003726	Rigid Backrest, 8.063", 19" Wide <i>Used with standard push handles, low push handles or omit push handles in any back height range or used with fold down push handles with tall back height range</i>	1
1w	108679	Rigid Backrest, 6.063", 19" Wide <i>Used with fold down push handles with short back height range</i>	1
1x	108666	Rigid Backrest, 7.063", 19" Wide <i>Used with fold down push handles with medium back height range</i>	1
1y	003727	Rigid Backrest, 8.063", 20" Wide <i>Used with standard push handles, low push handles or omit push handles in any back height range or used with fold down push handles with tall back height range</i>	1
1z	108680	Rigid Backrest, 6.063", 20" Wide <i>Used with fold down push handles with short back height range</i>	1
1aa	108667	Rigid Backrest, 7.063", 20" Wide <i>Used with fold down push handles with medium back height range</i>	1
1a, 2	107229	Height Adjustable Rigid Backrest with Sleeves 12" Assembly <i>Used with standard push handles, low push handles or omit push handles in any back height range or used with fold down push handles with tall back height range</i>	1
1d, 2	107230	Height Adjustable Rigid Backrest with Sleeves 13" Assembly <i>Used with standard push handles, low push handles or omit push handles in any back height range or used with fold down push handles with tall back height range</i>	1
1g, 2	107231	Height Adjustable Rigid Backrest with Sleeves 14" Assembly <i>Used with standard push handles, low push handles or omit push handles in any back height range or used with fold down push handles with tall back height range</i>	1
1j, 2	107232	Height Adjustable Rigid Backrest with Sleeves 15" Assembly <i>Used with standard push handles, low push handles or omit push handles in any back height range or used with fold down push handles with tall back height range</i>	1
1m, 2	107233	Height Adjustable Rigid Backrest with Sleeves 16" Assembly	1

Item Number	Part Number	Description	Quantity
		<i>Used with standard push handles, low push handles or omit push handles in any back height range or used with fold down push handles with tall back height range</i>	
1p, 2	107234	Height Adjustable Rigid Backrest with Sleeves 17" Assembly <i>Used with standard push handles, low push handles or omit push handles in any back height range or used with fold down push handles with tall back height range</i>	1
1s, 2	107235	Height Adjustable Rigid Backrest with Sleeves 18" Assembly <i>Used with standard push handles, low push handles or omit push handles in any back height range or used with fold down push handles with tall back height range</i>	1
1v, 2	107236	Height Adjustable Rigid Backrest with Sleeves 19" Assembly <i>Used with standard push handles, low push handles or omit push handles in any back height range or used with fold down push handles with tall back height range</i>	1
1y, 2	107237	Height Adjustable Rigid Backrest with Sleeves 20" Assembly <i>Used with standard push handles, low push handles or omit push handles in any back height range or used with fold down push handles with tall back height range</i>	1
2	000034	Sleeve 3/4" x 1 1/2"	2
3	001735	Folding Handle Assembly Rigid <i>This is to replace an existing Fold Down Push Handle. If wanting to retrofit to the Fold Down Push Handle, order one of the following complete assemblies based on the desired back height: 110363, 107211 or 107212</i>	1
3, 5, 11, 12a	110363	Fold Down Push Handle Assembly, Height Adjustable, Short <i>Used with short back height range</i>	1
3, 5, 11, 12b	107211	Fold Down Push Handle Assembly, Height Adjustable, Medium <i>Used with medium back height range</i>	1
3, 5, 11, 12c	107212	Fold Down Push Handle Assembly, Height Adjustable, Tall <i>Used with tall back height range</i>	1
4	000073	M5 x 24 Threaded Barrel	2
5	100669	M5 x 10 BTN SHCS BLKZC w/Patch	4
6a	001749	Tension Strap Folding Handle 12-13 Wide	1
6b	001750	Tension Strap Folding Handle 14-15 Wide	1
6c	001751	Tension Strap Folding Handle 16-17 Wide	1
6d	001752	Tension Strap Folding Handle 18-19 Wide	1
6e	001753	Tension Strap Folding Handle 20-22 Wide	1
7a, 8	110360	Straight Upper Back Tube Assembly, Short <i>Use with short back height range</i>	1
7b, 8	110361	Straight Upper Back Tube Assembly, Medium	1

Item Number	Part Number	Description	Quantity
		<i>Used with medium back height range</i>	
7c, 8	110362	Straight Upper Back Tube Assembly, Tall <i>Used with tall back height range</i>	1
8	100638	Tube End Plug 3/4"	2
8, 9a, 10a	502602	Standard Push Handle Assembly, Short <i>Used with short back height range</i>	1
8, 9b, 10a	107225	Standard Push Handle Assembly, Medium <i>Used with medium back height range</i>	1
8, 9c, 10a	107227	Standard Push Handle Assembly, Tall <i>Used with tall back height range</i>	1
8, 9d, 10b	107205	Low Profile Push Handle Assembly, Short <i>Used with short back height range</i>	1
8, 9e, 10b	107226	Low Profile Push Handle Assembly, Medium <i>Used with medium back height range</i>	1
8, 9f, 10b	107228	Low Profile Push Handle Assembly, Tall <i>Used with tall back height range</i>	1
10a	109432	Ergo Push Handle Grip 3/4" Standard with Instruction	1
10b	109430	Ergo Push Handle Grip 3/4" Low Profile with Instruction	1
11	100734	M5 x 16 PHMS ZC <i>Used to mount back upholstery and/or Fold Down Push Handle</i>	2