

Catalyst Height Adjustable Straight with Push Handle (Depth Adjustable)

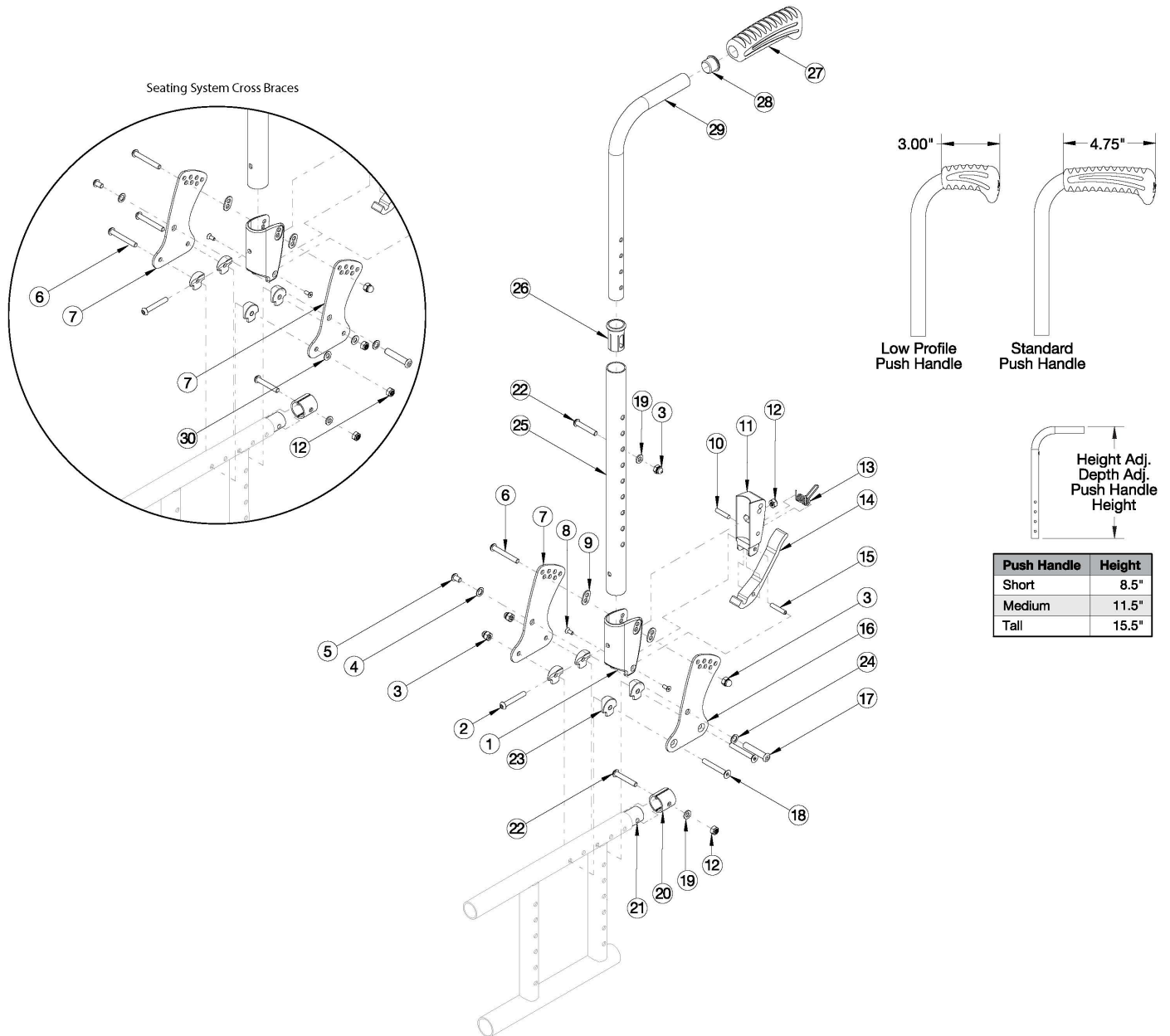

This backrest style was released February 8th, 2021 <p>

Low Profile Push Handles are not available with Heavy Duty Option or Drum Brake <p>

If changing from another style backrest and the Drum Brake is present, a new Drum Brake Cable Kit may be required

Item Number	Part Number	Description	Quantity	Retail
1-15, 16a, 17-20, 22-24, 25a, 26, 27a, 28, 29a	112616	Height Adjustable Straight with Push Handle Assembly, Short, Standard Grip, Attaching Hardware for Std Cross Braces, Left	1	\$252.51

Item Number	Part Number	Description	Quantity	Retail
1-15, 16b, 17-20, 22-24, 25a, 26, 27a, 28, 29a	112617	Height Adjustable Straight with Push Handle Assembly, Short, Standard Grip, Attaching Hardware for Std Cross Braces, Right	1	\$252.51
1-15, 16a, 17-20, 22-24, 25b, 26, 27a, 28, 29b	112618	Height Adjustable Straight with Push Handle Assembly, Medium, Standard Grip, Attaching Hardware for Std Cross Braces, Left	1	\$252.51
1-15, 16b, 17-20, 22-24, 25b, 26, 27a, 28, 29b	112619	Height Adjustable Straight with Push Handle Assembly, Medium, Standard Grip, Attaching Hardware for Std Cross Braces, Right	1	\$252.51
1-15, 16a, 17-20, 22-24, 25b, 26, 27a, 28, 29c	112620	Height Adjustable Straight with Push Handle Assembly, Tall, Standard Grip, Attaching Hardware for Std Cross Braces, Left	1	\$252.51
1-15, 16b, 17-20, 22-24, 25b, 26, 27a, 28, 29c	112621	Height Adjustable Straight with Push Handle Assembly, Tall, Standard Grip, Attaching Hardware for Std Cross Braces, Right	1	\$252.51
1-15, 16a, 17-20, 22-24, 25a, 26, 27b, 28, 29a	112622	Height Adjustable Straight with Push Handle Assembly, Short, Low Profile Grip, Attaching Hardware for Std Cross Braces, Left	1	\$252.51
1-15, 16b, 17-20, 22-24, 25a, 26, 27b, 28, 29a	112623	Height Adjustable Straight with Push Handle Assembly, Short, Low Profile Grip, Attaching Hardware for Std Cross Braces, Right	1	\$252.51
1-15, 16a, 17-20, 22-24, 25b, 26, 27b, 28, 29b	112624	Height Adjustable Straight with Push Handle Assembly, Medium, Low Profile Grip, Attaching Hardware for Std Cross Braces, Left	1	\$252.51
1-15, 16b, 17-20, 22-24, 25b, 26, 27b, 28, 29b	112625	Height Adjustable Straight with Push Handle Assembly, Medium, Low Profile Grip, Attaching Hardware for Std Cross Braces, Right	1	\$252.51
1-15, 16a, 17-20, 22-24, 25b, 26, 27b, 28, 29c	112626	Height Adjustable Straight with Push Handle Assembly, Tall, Low Profile Grip, Attaching Hardware for Std Cross Braces, Left	1	\$252.51
1-15, 16b, 17-20, 22-24, 25b, 26, 27b, 28, 29c	112627	Height Adjustable Straight with Push Handle Assembly, Tall, Low Profile Grip, Attaching Hardware for Std Cross Braces, Right	1	\$252.51
1-15, 17-20, 22, 23, 25a, 26, 27a, 28, 29a, 30	112628	Height Adjustable Straight with Push Handle Assembly, Short, Standard Grip, Attaching Hardware for Seating Cross Braces, One Side	1	\$257.24
1-15, 17-20, 22, 23, 25a, 26, 27a, 28, 29a, 30	112629	Height Adjustable Straight with Push Handle Assembly, Short, Standard Grip, Attaching Hardware for Seating Cross Braces, PAIR	1	\$514.49
1-15, 17-20, 22, 23, 25b, 26, 27a, 28, 29b, 30	112630	Height Adjustable Straight with Push Handle Assembly, Medium, Standard Grip, Attaching Hardware for Seating Cross Braces, One Side	1	\$257.24

Item Number	Part Number	Description	Quantity	Retail
1-15, 17-20, 22, 23, 25b, 26, 27a, 28, 29b, 30	112631	Height Adjustable Straight with Push Handle Assembly, Medium, Standard Grip, Attaching Hardware for Seating Cross Braces, PAIR	1	\$514.49
1-15, 17-20, 22, 23, 25b, 26, 27a, 28, 29c, 30	112632	Height Adjustable Straight with Push Handle Assembly, Tall, Standard Grip, Attaching Hardware for Seating Cross Braces, One Side	1	\$257.24
1-15, 17-20, 22, 23, 25b, 26, 27a, 28, 29c, 30	112633	Height Adjustable Straight with Push Handle Assembly, Tall, Standard Grip, Attaching Hardware for Seating Cross Braces, PAIR	1	\$514.49
1-15, 17-20, 22, 23, 25a, 26, 27b, 28, 29a, 30	112634	Height Adjustable Straight with Push Handle Assembly, Short, Low Profile Grip, Attaching Hardware for Seating Cross Braces, One Side	1	\$257.24
1-15, 17-20, 22, 23, 25a, 26, 27b, 28, 29a, 30	112635	Height Adjustable Straight with Push Handle Assembly, Short, Low Profile Grip, Attaching Hardware for Seating Cross Braces, PAIR	1	\$514.49
1-15, 17-20, 22, 23, 25b, 26, 27b, 28, 29b, 30	112636	Height Adjustable Straight with Push Handle Assembly, Medium, Low Profile Grip, Attaching Hardware for Seating Cross Braces, One Side	1	\$257.24
1-15, 17-20, 22, 23, 25b, 26, 27b, 28, 29b, 30	112637	Height Adjustable Straight with Push Handle Assembly, Medium, Low Profile Grip, Attaching Hardware for Seating Cross Braces, PAIR	1	\$514.49
1-15, 17-20, 22, 23, 25b, 26, 27b, 28, 29c, 30	112638	Height Adjustable Straight with Push Handle Assembly, Tall, Low Profile Grip, Attaching Hardware for Seating Cross Braces, One Side	1	\$257.24
1-15, 17-20, 22, 23, 25b, 26, 27b, 28, 29c, 30	112639	Height Adjustable Straight with Push Handle Assembly, Tall, Low Profile Grip, Attaching Hardware for Seating Cross Braces, PAIR	1	\$514.49
3, 19, 22, 25a, 26, 27a, 28, 29a	112610	Height Adjustable Straight with Push Handle Assembly, Short, Standard Grip	1	\$118.91
3, 19, 22, 25b, 26, 27a, 28, 29b	112611	Height Adjustable Straight with Push Handle Assembly, Medium, Standard Grip	1	\$118.91
3, 19, 22, 25b, 26, 27a, 28, 29c	112612	Height Adjustable Straight with Push Handle Assembly, Tall, Standard Grip	1	\$118.91
3, 19, 22, 25a, 26, 27b, 28, 29a	112613	Height Adjustable Straight with Push Handle Assembly, Short, Low Profile Grip	1	\$118.91
3, 19, 22, 25b, 26, 27b, 28, 29b	112614	Height Adjustable Straight with Push Handle Assembly, Medium, Low Profile Grip	1	\$118.91
3, 19, 22, 25b, 26, 27b, 28, 29c	112615	Height Adjustable Straight with Push Handle Assembly, Tall, Low Profile Grip	1	\$118.91
27a, 28, 29a	501654	Depth Adjustable Height Adjustable Upper Push Handle Short Assembly w/ Standard Grip	1	\$75.87

Item Number	Part Number	Description	Quantity	Retail
27a, 28, 29b	501655	Depth Adjustable Height Adjustable Upper Push Handle Medium Assembly w/ Standard Grip	1	\$75.87
27a, 28, 29c	501656	Depth Adjustable Height Adjustable Upper Push Handle Tall Assembly w/ Standard Grip	1	\$75.87
27b, 28, 29a	002762	Depth Adjustable Height Adjustable Upper Push Handle Short Assembly w/ Low Profile Grip	1	\$75.87
27b, 28, 29b	002763	Depth Adjustable Height Adjustable Upper Push Handle Medium Assembly w/ Low Profile Grip	1	\$75.87
27b, 28, 29c	002764	Depth Adjustable Height Adjustable Upper Push Handle Tall Assembly w/ Low Profile Grip	1	\$75.87
1-15, 16a, 17-20, 22-24	112603	Depth Adjustable Backrest Hardware Assembly, for Std Cross Braces, Left Side	1	\$133.60
1-15, 16b, 17-20, 22-24	112604	Depth Adjustable Backrest Hardware Assembly, for Std Cross Braces, Right Side	1	\$133.60
1-15, 17-20, 22-23, 30	112605	Depth Adjustable Backrest Hardware Assembly, for Seating Cross Braces, One Side	1	\$138.33
1-15, 17-20, 22-23, 30	112606	Depth Adjustable Backrest Hardware Assembly, for Seating Cross Braces, PAIR	1	\$276.66
1, 9	503834	Cover Plate, Latch Insert Kit	1	\$25.33
2	100797	M6 x 40 BHCS BLK ZC	1	\$1.05
3	100558	M6 NYL INS Domed Cap L/N ZC	3	\$1.05
4	101701	Washer 3.315/.350 x .425/.525 x .059/.067 18-8 F/W	1	\$2.63
5	101184	M6 x 10 BTN SHCS BLKZC w/Patch	1	\$1.58
6	100670	M6 x 45 BTN SHCS BLK ZC	1	\$1.58
7	111833	Depth Adjustable Back Plate, Folding <i>Use quantity 1 per side if standard cross braces are present. Use quantity 2 per side if seating system cross braces are present.</i>	1	\$23.21
8	101818	M4 x 10 FHCS BLKZC w/Patch	2	\$1.05
9	001897	Washer, Dual, PSA	2	\$2.09
10	102694	Dowel Pin, M5 X 24, Blk Zn	1	\$1.58
11	001895	Latch Insert, Folding Backrest	1	\$6.60
12	100658	M6 Nylock Nut Blk Zn <i>Use quantity 2 per side if standard cross braces are present. Use quantity 4 per side if seating system cross braces are present.</i>	2	\$1.05
13	001896	Spring, Backrest Latch	1	\$0.53
14	001893	Latch Lever, Backrest	1	\$13.34
15	002513	Threaded Barrel, 5mm OD x M4	1	\$1.94
16a	111835	Depth Adjustable Back Plate, Inner, Folding, Left	1	\$23.21

Item Number	Part Number	Description	Quantity	Retail
		<i>Only used when standard cross braces are present</i>		
16b	111834	Depth Adjustable Back Plate, Inner, Folding, Right <i>Only used when standard cross braces are present</i>	1	\$23.21
17	003284	Binding Post, 8mm x 40mm x M6	1	\$1.46
18	101592	M6 x 45 CLS10.9 DIN7991 FHCS BLKZC	2	\$2.63
19	100746	M6 Flat Washer Blk Zn	1	\$1.58
20	113140	Tube Spacer .88 x .083 <i>Replacement for part number 001230</i>	2	\$3.37
21	000605	Depth Adjustable Frame Extension Tube, Catalyst/Spark	1	\$37.14
22	101811	M6 x 35 BHCS Blk Zn	1	\$1.05
23	000612	1" Half Saddle Washer	4	\$1.92
24	101861	Nylon Washer 5/16 x 1/2 x .03 <i>Only used when standard cross braces are present</i>	1	\$0.53
26	000034	Sleeve 3/4" x 1 1/2"	1	\$3.66
27a	109432	Ergo Push Handle Grip 3/4" Standard with Instruction	1	\$7.14
27b	109430	Ergo Push Handle Grip 3/4" Low Profile with Instruction	1	\$7.14
28	100638	Tube End Plug 3/4"	1	\$2.10
30	102803	Washer Flat .250 x .500 x .027 HX BLZ <i>Only used when seating system cross braces are present</i>	2	\$1.58