

Flip Adjustable Height with Adjustable Handle Backrest - Growth

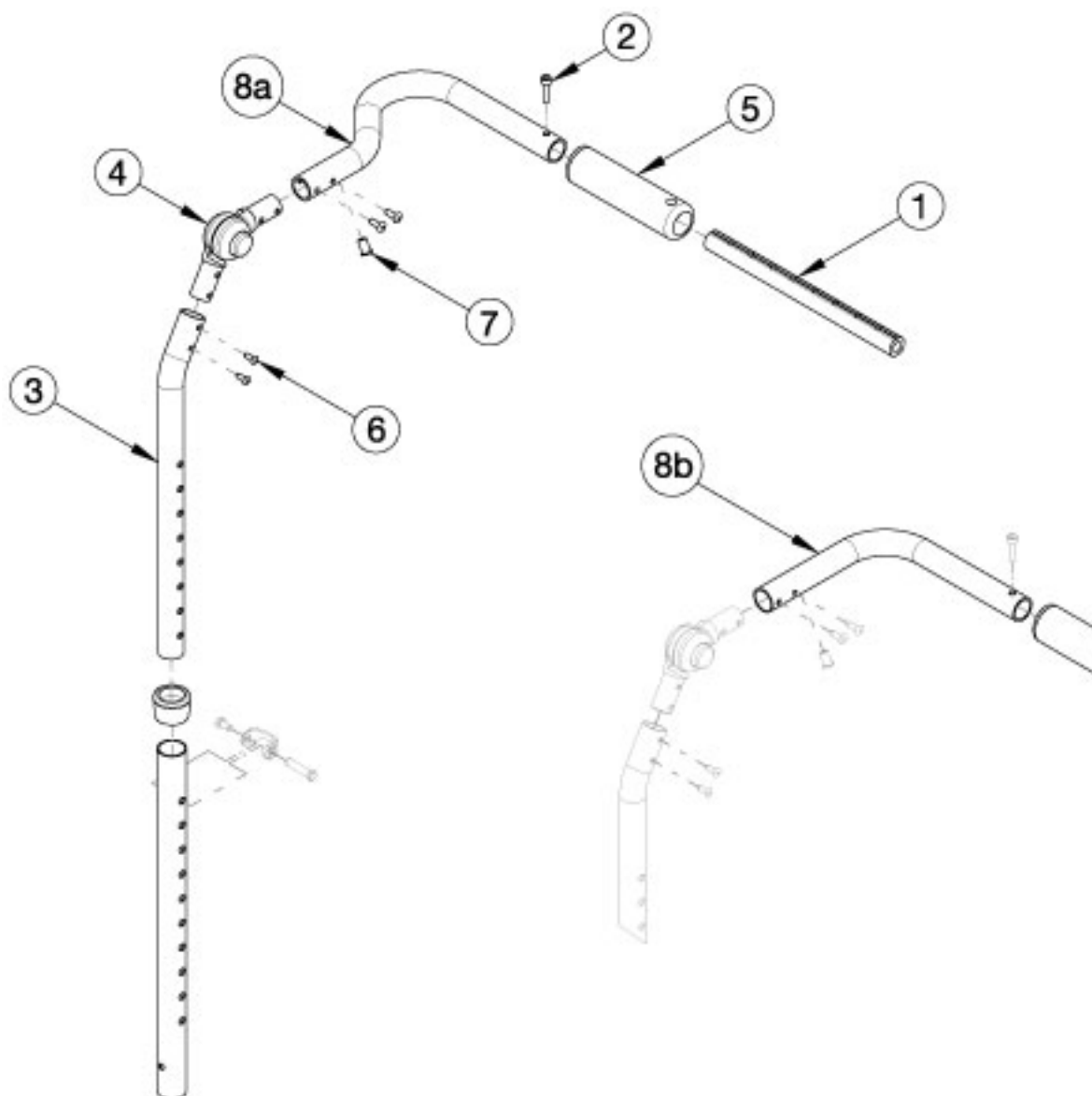

Has your width changed? Will the push handle (#8) accommodate your new width? If no, please select the appropriate upper back tube assemblies.

Item Number	Part Number	Description	Quantity
3, 4, 5, 6, 7, 8a	502813	Upper Back Tube Assembly, Height Adj, 10-13W, Right FLIP	1
3, 4, 5, 6, 7, 8a	502814	Upper Back Tube Assembly, Height Adj, 10-13W Left FLIP	1
3, 4, 5, 6, 7, 8b	502665	Upper Back Tube Assembly Height Adj, Right Focus/Flip <i>Used on 14-18 wide with serial numbers prior to FLP010784 and serial numbers starting with FLP011080</i>	1

Item Number	Part Number	Description	Quantity
3, 4, 5, 6, 7, 8b	502666	Upper Back Tube Assembly Height Adj, Left Focus/Flip <i>Used on 14-18 wide with serial numbers prior to FLP010784 and serial numbers starting with FLP011080</i>	1
1a	002578	Growth Strut, Stroller, Short	1
1a, 2	503107	Growth Strut Assembly Short, Focus/Flip	1
1b	002579	Growth Strut, Stroller, Long <i>Used only if growing chair from 13" wide or less to 14" wide or greater</i>	1
2	101843	M5 x 20 SHCS Blk Zn	1