

# (Discontinued) Catalyst Height Adjustable Depth Adjustable Backrest with Hardware

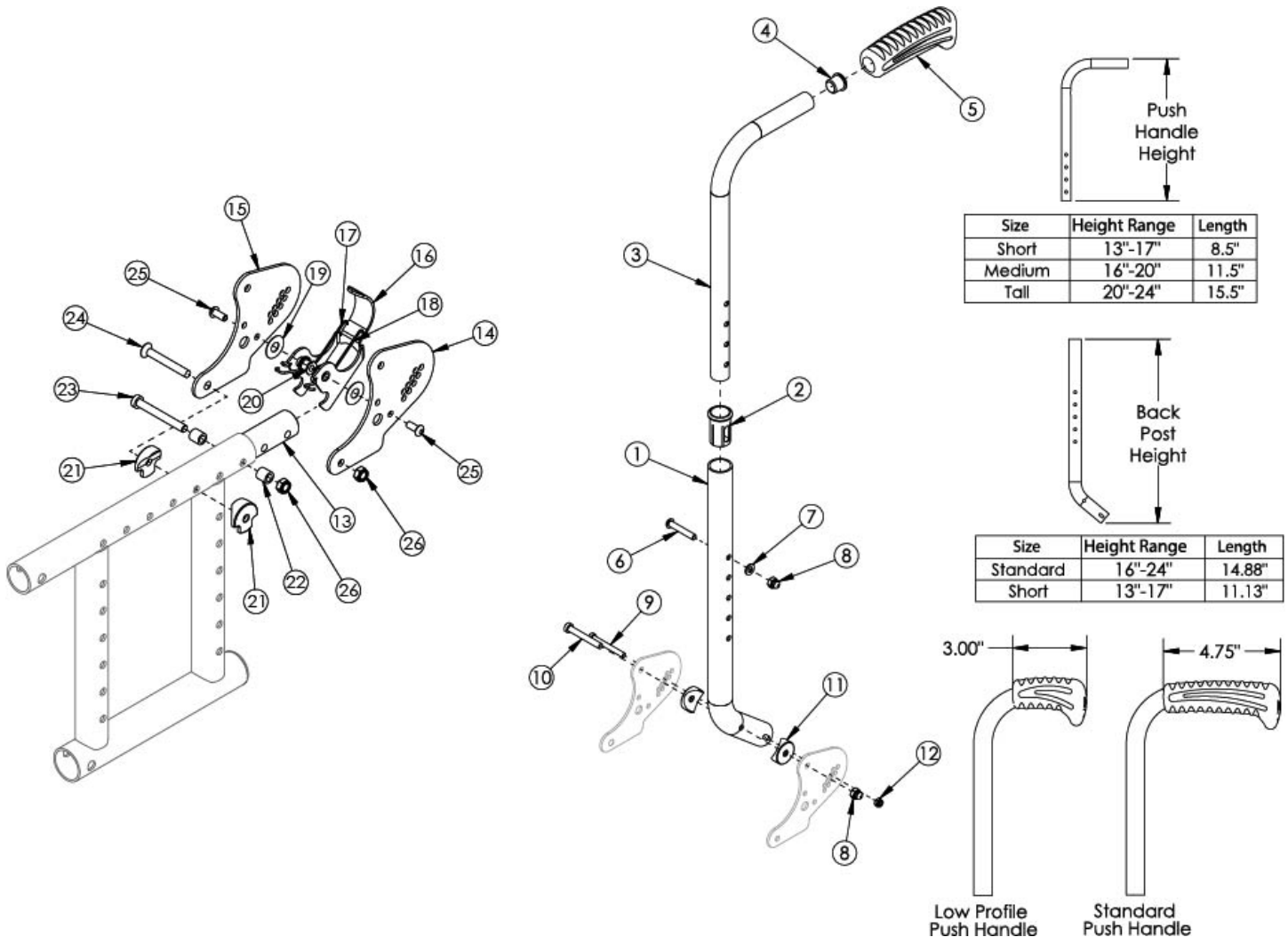

*This backrest style discontinued February 8th, 2021 Not compatible with Drum Brake. A backrest retrofit to the Catalyst Height Adjustable Straight with Push Handle (Depth Adjustable) is required if retrofitting Drum Brake.*

| Item Number                       | Part Number | Description  | Quantity |
|-----------------------------------|-------------|--|----------|
| 1a, 2, 3b, 4, 5a - 13, 14b, 15-26 | 111320      | Backrest Assembly Depth Adjustable Height Adjustable Medium w/ Standard Grip w/ Attaching Hardware - Right Side    | 1        |
| 1a, 2, 3c, 4, 5a - 13, 14b, 15-26 | 111322      | Backrest Assembly Depth Adjustable Height Adjustable Tall w/ Standard Grip w/ Attaching Hardware - Right Side      | 1        |
| 1a, 2, 3b, 4, 5b - 13, 14b, 15-26 | 111326      | Backrest Assembly Depth Adjustable Height Adjustable Medium w/ Low Profile Grip w/ Attaching Hardware - Right Side | 1        |
| 1a, 2, 3c, 4, 5b - 13, 14b, 15-26 | 111328      | Backrest Assembly Depth Adjustable Height Adjustable Tall w/ Low Profile Grip w/ Attaching Hardware - Right Side   | 1        |

| Item Number          | Part Number | Description  | Quantity |
|----------------------|-------------|--|----------|
| 1a, 2, 3b, 4, 5a - 8 | 501257      | Backrest Assembly Depth Adjustable Height Adjustable Medium w/ Standard Grip             | 1        |
| 1a, 2, 3c, 4, 5a - 8 | 501258      | Backrest Assembly Depth Adjustable Height Adjustable Tall w/ Standard Grip               | 1        |
| 1a, 2, 3b, 4, 5b - 8 | 503296      | Backrest Assembly Depth Adjustable Height Adjustable Medium w/ Low Profile Grip          | 1        |
| 1a, 2, 3c, 4, 5b - 8 | 503297      | Backrest Assembly Depth Adjustable Height Adjustable Tall w/ Low Profile Grip            | 1        |
| 3a, 4, 5a            | 501654      | Depth Adjustable Height Adjustable Upper Push Handle Short Assembly w/ Standard Grip     | 1        |
| 3b, 4, 5a            | 501655      | Depth Adjustable Height Adjustable Upper Push Handle Medium Assembly w/ Standard Grip    | 1        |
| 3c, 4, 5a            | 501656      | Depth Adjustable Height Adjustable Upper Push Handle Tall Assembly w/ Standard Grip      | 1        |
| 3a, 4, 5b            | 002762      | Depth Adjustable Height Adjustable Upper Push Handle Short Assembly w/ Low Profile Grip  | 1        |
| 3b, 4, 5b            | 002763      | Depth Adjustable Height Adjustable Upper Push Handle Medium Assembly w/ Low Profile Grip | 1        |
| 3c, 4, 5b            | 002764      | Depth Adjustable Height Adjustable Upper Push Handle Tall Assembly w/ Low Profile Grip   | 1        |
| 13, 14b, 15-26       | 500739      | Depth Adjustable Backrest Hardware Assm Right CAT  | 1        |
| 13, 15-26            | 501227      | Depth Adjustable Backrest Hardware Assm SPARK/ OPEN SEAT                                 | 1        |
| 8-12                 | 111164      | Depth Adjustable Backrest Attaching Hardware Kit   | 1        |
| 1a                   | 000986      | Depth Adjustable Straight Back Tube Medium/Tall CAT/ SPARK                               | 1        |
| 2                    | 000034      | Sleeve 3/4" x 1 1/2"   | 1        |
| 4                    | 100638      | Tube End Plug 3/4"   | 1        |
| 5a                   | 109432      | Ergo Push Handle Grip 3/4" Standard with Instruction                                     | 1        |
| 5b                   | 109430      | Ergo Push Handle Grip 3/4" Low Profile with Instruction                                  | 1        |
| 6                    | 101811      | M6 x 35 BHCS Blk Zn  | 1        |
| 7                    | 100746      | M6 Flat Washer Blk Zn  | 1        |
| 8                    | 100558      | M6 Nyl Ins Domed Cap L/N Zc  | 1        |
| 9                    | 101186      | M5 X 45 CLS12.9 DIN912 SHCS P/THD BLZ  | 1        |
| 10                   | 101123      | M6 x 45 Low SHCS BLK ZC  | 1        |
| 11                   | 000055      | Saddle 1"  | 2        |
| 12                   | 100657      | M5 Nylock Nut Blk Zn   | 1        |
| 13                   | 000605      | Depth Adjustable Frame Extension Tube, Catalyst/Spark                                    | 1        |
| 14b                  | 000604R     | Depth Adjustable Backrest Plate Inside Right CAT/ SPARK                                  | 1        |

| Item Number | Part Number | Description  | Quantity |
|-------------|-------------|--|----------|
| 15          | 000611      | Depth Adjustable Backrest Side Plate CAT/ SPARK            | 2        |
| 16          | 000670      | Depth Adjustable Backrest Latch CAT/ SPARK                 | 1        |
| 17          | 000613R     | Depth Adjustable Backrest Latch Spring Right CAT/ SPARK    | 1        |
| 18          | 000613L     | Depth Adjustable Backrest Latch Spring Left CAT/ SPARK     | 1        |
| 19          | 000428      | Wear Washer  | 2        |
| 20          | 000420      | Backrest Latch Pivot Bushing                               | 2        |
| 21          | 000612      | 1" Half Saddle Washer                                      | 2        |
| 22          | 000240      | Backrest Latch Strike Bushing / Close Mount Handrim Spacer | 2        |
| 23          | 101124      | M6 x 50 Low SHCS BLK ZC                                    | 1        |
| 24          | 101592      | M6 x 45 CLS10.9 DIN7991 FHCS BLKZC                         | 1        |
| 25          | 100669      | M5 x 10 BTN SHCS BLKZC w/Patch                             | 2        |
| 26          | 100658      | M6 Nylock Nut Blk Zn                                       | 2        |