

Catalyst Height Adjustable Straight with Push Handle (Depth Adjustable)

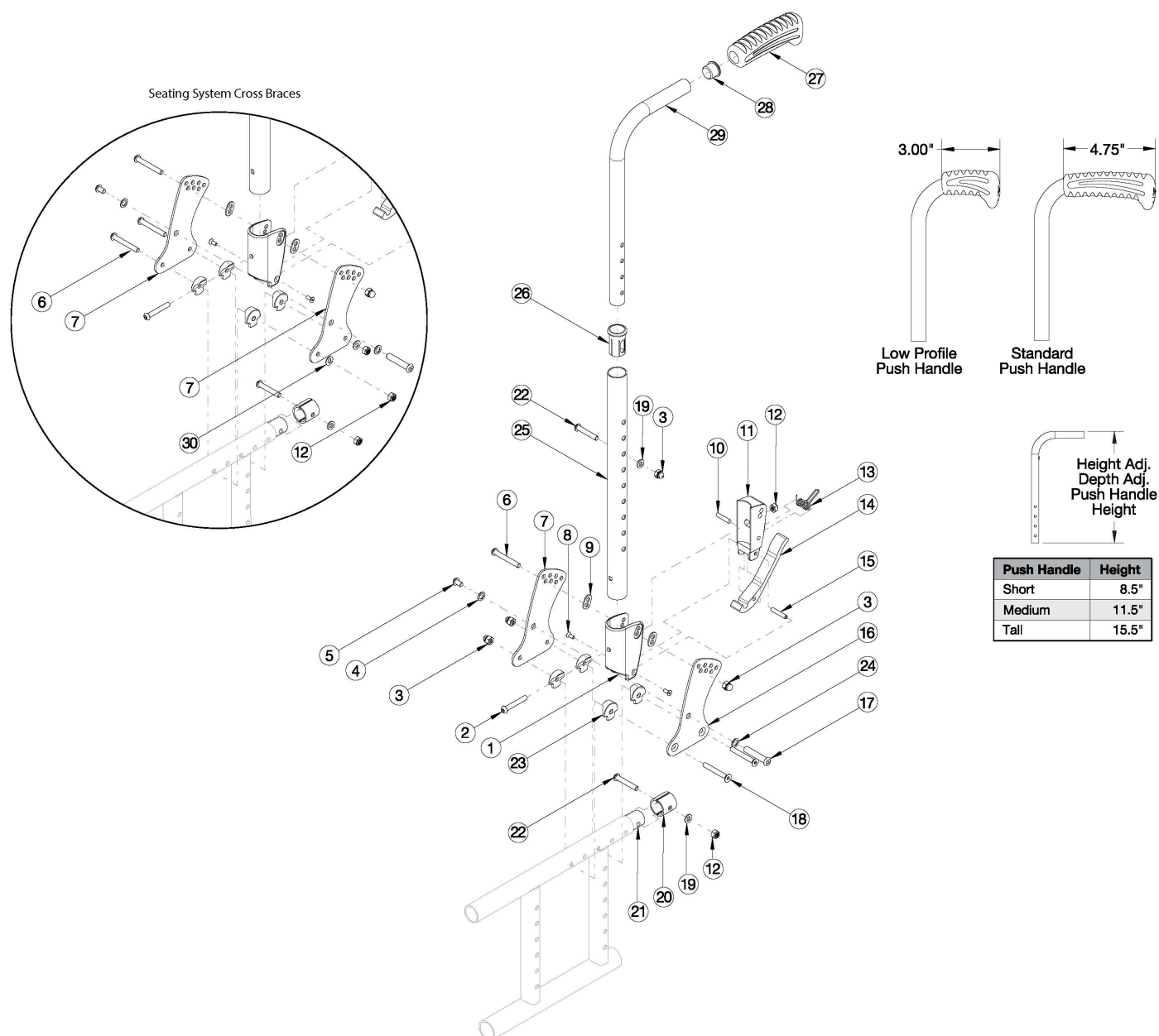

This backrest style was released February 8th, 2021 Low Profile Push Handles are not available with Heavy Duty Option or Drum Brake If the Drum Brake is present, see Drum Brake page for back Cane replacements If Anti-Rollback is present, see Back Tubes for Anti-Rollback System

Item Number	Part Number	Description	Quantity
1-15, 16a, 17-20, 22-24, 25a, 26, 27a, 28, 29a	112616	Height Adjustable Straight with Push Handle Assembly, Short, Standard Grip, Attaching Hardware for Std Cross Braces, Left	1

Item Number	Part Number	Description	Quantity
1-15, 16b, 17-20, 22-24, 25a, 26, 27a, 28, 29a	112617	Height Adjustable Straight with Push Handle Assembly, Short, Standard Grip, Attaching Hardware for Std Cross Braces, Right	1
1-15, 16a, 17-20, 22-24, 25b, 26, 27a, 28, 29b	112618	Height Adjustable Straight with Push Handle Assembly, Medium, Standard Grip, Attaching Hardware for Std Cross Braces, Left	1
1-15, 16b, 17-20, 22-24, 25b, 26, 27a, 28, 29b	112619	Height Adjustable Straight with Push Handle Assembly, Medium, Standard Grip, Attaching Hardware for Std Cross Braces, Right	1
1-15, 16a, 17-20, 22-24, 25b, 26, 27a, 28, 29c	112620	Height Adjustable Straight with Push Handle Assembly, Tall, Standard Grip, Attaching Hardware for Std Cross Braces, Left	1
1-15, 16b, 17-20, 22-24, 25b, 26, 27a, 28, 29c	112621	Height Adjustable Straight with Push Handle Assembly, Tall, Standard Grip, Attaching Hardware for Std Cross Braces, Right	1
1-15, 16a, 17-20, 22-24, 25a, 26, 27b, 28, 29a	112622	Height Adjustable Straight with Push Handle Assembly, Short, Low Profile Grip, Attaching Hardware for Std Cross Braces, Left	1
1-15, 16b, 17-20, 22-24, 25a, 26, 27b, 28, 29a	112623	Height Adjustable Straight with Push Handle Assembly, Short, Low Profile Grip, Attaching Hardware for Std Cross Braces, Right	1
1-15, 16a, 17-20, 22-24, 25b, 26, 27b, 28, 29b	112624	Height Adjustable Straight with Push Handle Assembly, Medium, Low Profile Grip, Attaching Hardware for Std Cross Braces, Left	1
1-15, 16b, 17-20, 22-24, 25b, 26, 27b, 28, 29b	112625	Height Adjustable Straight with Push Handle Assembly, Medium, Low Profile Grip, Attaching Hardware for Std Cross Braces, Right	1
1-15, 16a, 17-20, 22-24, 25b, 26, 27b, 28, 29c	112626	Height Adjustable Straight with Push Handle Assembly, Tall, Low Profile Grip, Attaching Hardware for Std Cross Braces, Left	1
1-15, 16b, 17-20, 22-24, 25b, 26, 27b, 28, 29c	112627	Height Adjustable Straight with Push Handle Assembly, Tall, Low Profile Grip, Attaching Hardware for Std Cross Braces, Right	1
1-15, 17-20, 22, 23, 25a, 26, 27a, 28, 29a, 30	112628	Height Adjustable Straight with Push Handle Assembly, Short, Standard Grip, Attaching Hardware for Seating Cross Braces, One Side	1
1-15, 17-20, 22, 23, 25a, 26, 27a, 28, 29a, 30	112629	Height Adjustable Straight with Push Handle Assembly, Short, Standard Grip, Attaching Hardware for Seating Cross Braces, PAIR	1
1-15, 17-20, 22, 23, 25b, 26, 27a, 28, 29b, 30	112630	Height Adjustable Straight with Push Handle Assembly, Medium, Standard Grip, Attaching Hardware for Seating Cross Braces, One Side	1

Item Number	Part Number	Description	Quantity
1-15, 17-20, 22, 23, 25b, 26, 27a, 28, 29b, 30	112631	Height Adjustable Straight with Push Handle Assembly, Medium, Standard Grip, Attaching Hardware for Seating Cross Braces, PAIR	1
1-15, 17-20, 22, 23, 25b, 26, 27a, 28, 29c, 30	112632	Height Adjustable Straight with Push Handle Assembly, Tall, Standard Grip, Attaching Hardware for Seating Cross Braces, One Side	1
1-15, 17-20, 22, 23, 25b, 26, 27a, 28, 29c, 30	112633	Height Adjustable Straight with Push Handle Assembly, Tall, Standard Grip, Attaching Hardware for Seating Cross Braces, PAIR	1
1-15, 17-20, 22, 23, 25a, 26, 27b, 28, 29a, 30	112634	Height Adjustable Straight with Push Handle Assembly, Short, Low Profile Grip, Attaching Hardware for Seating Cross Braces, One Side	1
1-15, 17-20, 22, 23, 25a, 26, 27b, 28, 29a, 30	112635	Height Adjustable Straight with Push Handle Assembly, Short, Low Profile Grip, Attaching Hardware for Seating Cross Braces, PAIR	1
1-15, 17-20, 22, 23, 25b, 26, 27b, 28, 29b, 30	112636	Height Adjustable Straight with Push Handle Assembly, Medium, Low Profile Grip, Attaching Hardware for Seating Cross Braces, One Side	1
1-15, 17-20, 22, 23, 25b, 26, 27b, 28, 29b, 30	112637	Height Adjustable Straight with Push Handle Assembly, Medium, Low Profile Grip, Attaching Hardware for Seating Cross Braces, PAIR	1
1-15, 17-20, 22, 23, 25b, 26, 27b, 28, 29c, 30	112638	Height Adjustable Straight with Push Handle Assembly, Tall, Low Profile Grip, Attaching Hardware for Seating Cross Braces, One Side	1
1-15, 17-20, 22, 23, 25b, 26, 27b, 28, 29c, 30	112639	Height Adjustable Straight with Push Handle Assembly, Tall, Low Profile Grip, Attaching Hardware for Seating Cross Braces, PAIR	1
3, 19, 22, 25a, 26, 27a, 28, 29a	112610	Height Adjustable Straight with Push Handle Assembly, Short, Standard Grip	1
3, 19, 22, 25b, 26, 27a, 28, 29b	112611	Height Adjustable Straight with Push Handle Assembly, Medium, Standard Grip	1
3, 19, 22, 25b, 26, 27a, 28, 29c	112612	Height Adjustable Straight with Push Handle Assembly, Tall, Standard Grip	1
3, 19, 22, 25a, 26, 27b, 28, 29a	112613	Height Adjustable Straight with Push Handle Assembly, Short, Low Profile Grip	1
3, 19, 22, 25b, 26, 27b, 28, 29b	112614	Height Adjustable Straight with Push Handle Assembly, Medium, Low Profile Grip	1
3, 19, 22, 25b, 26, 27b, 28, 29c	112615	Height Adjustable Straight with Push Handle Assembly, Tall, Low Profile Grip	1
3, 19, 22, 25a, 26	118429	Height Adjustable Straight with Push Handle Assembly, Lower, Short, Standard Grip	1

Item Number	Part Number	Description	Quantity
3, 19, 22, 25b, 26	118430	Height Adjustable Straight with Push Handle Assembly, Lower, Medium, Standard Grip	1
3, 19, 22, 25b, 26	118431	Height Adjustable Straight with Push Handle Assembly, Lower, Tall, Standard Grip	1
27a, 28, 29a	501654	Depth Adjustable Height Adjustable Upper Push Handle Short Assembly w/ Standard Grip	1
27a, 28, 29b	501655	Depth Adjustable Height Adjustable Upper Push Handle Medium Assembly w/ Standard Grip	1
27a, 28, 29c	501656	Depth Adjustable Height Adjustable Upper Push Handle Tall Assembly w/ Standard Grip	1
27b, 28, 29a	002762	Depth Adjustable Height Adjustable Upper Push Handle Short Assembly w/ Low Profile Grip	1
27b, 28, 29b	002763	Depth Adjustable Height Adjustable Upper Push Handle Medium Assembly w/ Low Profile Grip	1
27b, 28, 29c	002764	Depth Adjustable Height Adjustable Upper Push Handle Tall Assembly w/ Low Profile Grip	1
1-15, 16a, 17-20, 22-24	112603	Depth Adjustable Backrest Hardware Assembly, for Std Cross Braces, Left Side	1
1-15, 16b, 17-20, 22-24	112604	Depth Adjustable Backrest Hardware Assembly, for Seating Cross Braces Right	1
1-15, 16a, 16b, 17-20, 22-24	122900	Depth Adjustable Backrest Hardware Assembly, for Std Cross Braces Pair	1
1-15, 17-20, 22-23, 30	112605	Depth Adjustable Backrest Hardware Assembly, for Seating Cross Braces Left	1
1-15, 17-20, 22-23, 30	122899	Depth Adjustable Backrest Hardware Assembly, for Seating Cross Braces Right	1
1-15, 17-20, 22-23, 30	112606	Depth Adjustable Backrest Hardware Assembly, for Seating Cross Braces, PAIR	1
1, 9	503834	Cover Plate, Latch Insert Kit	1
2	100797	M6 x 40 BHCS BLK ZC	1
3	100558	M6 Nyl Ins Domed Cap L/N Zc	3
4	101701	Washer 3.315/.350 x .425/.525 x .059/.067 18-8 F/W	1
5	101184	M6 x 10 BTN SHCS BLKZC w/Patch	1
6	100670	M6 x 45 BTN SHCS BLK ZC	1
7	111833	Depth Adjustable Back Plate, Folding <i>Use quantity 1 per side if standard cross braces are present. Use quantity 2 per side if seating system cross braces are present.</i>	1
8	101818	M4 x 10 FHCS BLKZC w/Patch	2
9	001897	Washer, Dual, PSA	2
10	102694	Dowel Pin, M5 X 24, Blk Zn	1
11	001895	Latch Insert, Folding Backrest	1
12	100658	M6 Nylock Nut Blk Zn	2

Item Number	Part Number	Description	Quantity
		<i>Use quantity 2 per side if standard cross braces are present. Use quantity 4 per side if seating system cross braces are present.</i>	
13	001896	Spring, Backrest Latch	1
14	001893	Latch Lever, Backrest	1
15	002513	Threaded Barrel, 5mm OD x M4	1
16a	111835	Depth Adjustable Back Plate, Inner, Folding, Left <i>Only used when standard cross braces are present</i>	1
16b	111834	Depth Adjustable Back Plate, Inner, Folding, Right <i>Only used when standard cross braces are present</i>	1
17	003284	Binding Post, 8mm x 40mm x M6	1
18	101592	M6 x 45 CLS10.9 DIN7991 FHCS BLKZC	2
19	100746	M6 Flat Washer Blk Zn	1
20	114443	Tube Spacer, Black, 1" OD x .083" x .80 LG <i>Replacement for part number 001230</i>	2
21	000605	Depth Adjustable Frame Extension Tube, Catalyst/Spark	1
22	101811	M6 x 35 BHCS Blk Zn	1
23	000612	1" Half Saddle Washer	4
24	101861	Nylon Washer 5/16 x 1/2 x .03 <i>Only used when standard cross braces are present</i>	1
26	000034	Sleeve 3/4" x 1 1/2"	1
27a	109432	Ergo Push Handle Grip 3/4" Standard with Instruction	1
27b	109430	Ergo Push Handle Grip 3/4" Low Profile with Instruction	1
28	100638	Tube End Plug 3/4"	1
30	102803	Washer Flat .250 X .500 X .027 Hx Blz <i>Only used when seating system cross braces are present</i>	2