

## Focus Axles

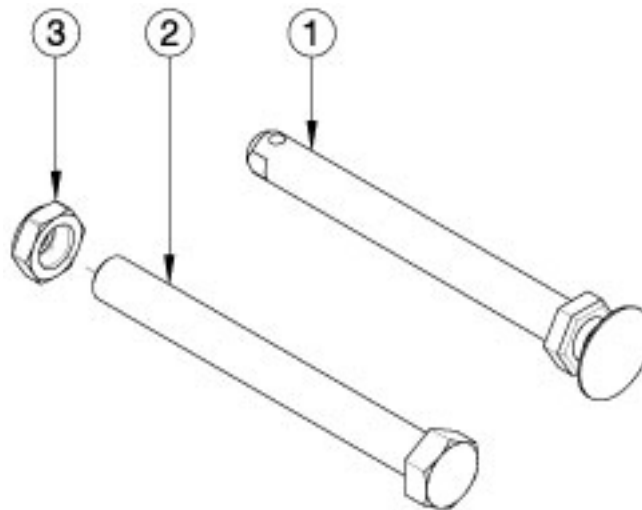

| Item Number | Part Number | Description   | Quantity |
|-------------|-------------|---|----------|
| 1a          | 101108      | Axle Quick Release w/ Button 1/2" x 99MM  | 1        |
| 1b          | 101191      | Axle Quick Release w/ Button 1/2" x 110MM   | 1        |
| 1c          | 102371      | Axle Quick Release w/ Button 1/2" x 122mm   | 1        |
| 2a          | 102612      | Fixed Axle HHCS 1/2-20 X 5 GRD 8 BLK ZN<br><i>If retrofitting, 101459 is needed as well.</i>  | 1        |
| 2b          | 102086      | Fixed Axle 1/2-20 x 5 1/2 LG HHCS Blk Zn<br><i>If retrofitting, 101459 is needed as well.</i> | 1        |
| 3           | 101459      | 1/2-20 NTE JAM NYL INS L/N BLK ZC   | 1        |

## Focus Axle Reference

| Quick Release Axles   |           |        |
|---|-----------|--------|
| Wheel   | Receivers |        |
|   | 001419*   | 114479 |
| X Core Mag  | 102371    | N/A    |
| 12" and 16" Mag / MAXX Performance Spoke / Spoke / MAXX Mag | 101191    | 102371 |

\*The MAXX Mag is not compatible with receiver 001419.

| Drum Brake Quick Release Axles |        |
|--------------------------------|--------|
| 12" and 16" Mag                | 101108 |
| 24" MAXX Performance Spoke     | 101191 |

| Fixed Axles |        |
|-------------|--------|
| All Wheels  | 102086 |

| Axle Part Numbers     |                        |
|-----------------------|------------------------|
| Push Button Style     | Threaded (Fixed)       |
| 101108 (1/2" x 99mm)  | 102612 (1/2" x 5")     |
| 101191 (1/2" x 110mm) | 102086 (1/2" x 5-1/2") |
| 102371 (1/2" x 122mm) |                        |

## **Focus Axles and Receivers**

To find the appropriate axle, first establish the axle receiver according to the RECEIVERS section and then determine the axle using the AXLES section.

### **RECEIVERS**

Receiver: 001419 (Discontinued)

Description: HD Axle Receiver Tilt

Used When: All Wheel except MAXX Mag wheels

Receiver: 114479

Description: Axle Sleeve Bushing 3", Focus

Used When: All Wheels

### **AXLES**

#### **001419 Receiver**

Quick Release Axles:

Use 102371 with X Core Mag and MAXX Mag wheels

Use 101191 with 12" and 16" Mag wheels, MAXX Performance Spoke, and Spoke wheels

Fixed Axles:

Use 102612 with 12" and 16" Mag wheels, MAXX Performance Spoke, and Spoke wheels

Use 102086 with X Core Mag and MAXX Mag wheels

#### **114479 Receiver**

Quick Release Axles:

Use 102371 with All wheels

Fixed Axles:

Use 102086 with All wheels

### **Drum Brake**

See designated Drum Brake parts manual pages for Drum Brake Rotor / Axle Sleeve information.

Quick Release Axles:

Use 101108 with 12" and 16" Mag wheels

Use 101191 with 24" MAXX Performance Spoke wheels

# Quick Release Axle Measuring Guide

**To identify which axle you have:** Set your axle on the printed copy of this page (do not scale when printing) or take the measurement as shown and locate which overall dimension matches that of the axle you have.

**Note:** The overall length is not the same as the “useable length” which is the length used in the part description. Images of all axles are shown below.

