

Catalyst E Handrims - Aluminum Anodized

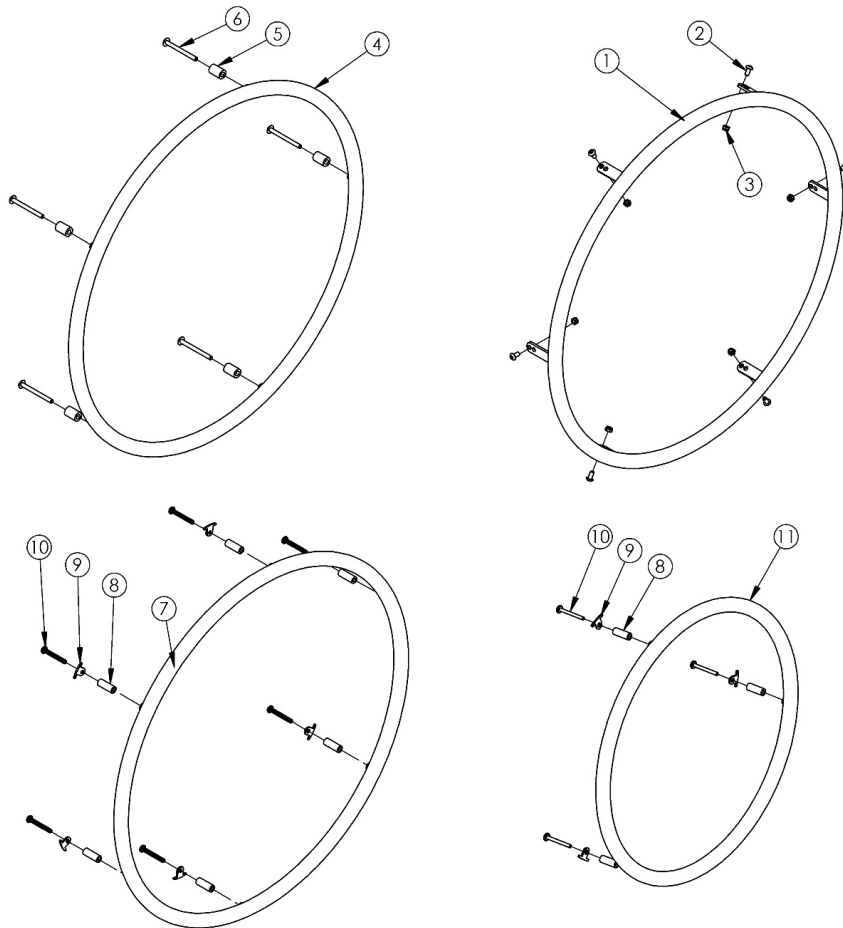

Aluminum Handrim with Micro Grip

For more information see [Handrim Hardware Chart](#). Quantity in Handrim Hardware Kits are for one wheel. <p>Tab mounted handrims must be installed prior to the tire being installed.

Item Number	Part Number	Description	Quantity	Retail
8, 9, 10	502168	Handrim Hardware Kit, 6 Rivet Nut, EACH <i>Used with MAXX Spoke wheels</i>	1	\$38.61
7a	200536	Handrim Aluminum Anodized 6 Rivet Nut 20" <i>Used with 20" MAXX Spoke wheels</i>	1	\$84.95
7a	502246	Handrim Aluminum Anodized 6 Rivet Nut 20" w/ Micro Grip <i>Used with 20" MAXX Spoke wheels</i>	1	\$133.11
7b	100560	Handrim Aluminum Anodized 6 Rivet Nut 22" <i>Used with 22" MAXX Spoke wheels</i>	1	\$77.22
7b	502247	Handrim Aluminum Anodized 6 Rivet Nut 22" w/ Micro Grip <i>Used with 22" MAXX Spoke wheels</i>	1	\$112.35
7c	200349	Handrim Hard Anodized 6 Rivet Nut 24" <i>Used with 24" MAXX Spoke wheels</i>	1	\$82.74

Item Number	Part Number	Description	Quantity	Retail
7c	502248	Handrim Aluminum Hard Anodized 6 Rivet Nut 24" w/ Micro Grip <i>Used with 24" MAXX Spoke wheels</i>	1	\$124.53
7d	200350	Handrim Hard Anodized 6 Rivet Nut 25" <i>Used with 25" MAXX Spoke wheels</i>	1	\$82.74
7d	502249	Handrim Aluminum Hard Anodized 6 Rivet Nut 25" w/ Micro Grip <i>Used with 25" MAXX Spoke wheels</i>	1	\$112.35
7e	200351	Handrim Hard Anodized 6 Rivet Nut 26" <i>Used with 26" MAXX Spoke wheels</i>	1	\$82.74
7e	502250	Handrim Aluminum Hard Anodized 6 Rivet Nut 26" w/ Micro Grip <i>Used with 26" MAXX Spoke wheels</i>	1	\$124.53
5, 6	502171	Handrim Hardware Kit, 5 Rivet Nut, EACH <i>Used with X Core Mag wheels</i>	1	\$33.10
4a	101897	Handrim Aluminum Anodized 5 Rivet Nut 20" <i>Used with 20" 5-Spoke X Core Mag wheels</i>	1	\$71.70
4a	502242	Handrim Aluminum Anodized 5 Rivet Nut 20" w/ Micro Grip <i>Used with 20" 5-Spoke X Core Mag wheels</i>	1	\$113.32
4b	101898	Handrim Aluminum Anodized 5 Rivet Nut 22" <i>Used with 22" 5-Spoke X Core Mag wheels</i>	1	\$71.70
4b	502243	Handrim Aluminum Anodized 5 Rivet Nut 22" w/ Micro Grip <i>Used with 22" 5-Spoke X Core Mag wheels</i>	1	\$113.32
4c	100975	Handrim Aluminum Anodized 5 Rivet Nut 24" <i>Used with 24" 5-Spoke X Core Mag wheels</i>	1	\$60.67
4c	502244	Handrim Aluminum Anodized 5 Rivet Nut 24" w/ Micro Grip <i>Used with 24" 5-Spoke X Core Mag wheels</i>	1	\$112.35
2.0	502170	Handrim Hardware Kit, Superlight, EACH <i>Used with Superlight Spoke</i>	1	\$16.55
1a	100754	Handrim Aluminum Anodized 6 Tab 24" <i>Used with 24" Superlight Spoke</i>	1	\$88.25
1a	502236	Handrim Aluminum Anodized 6 Tab 24" w/ Micro Grip <i>Used with 24" Superlight Spoke</i>	1	\$124.53
1b	101160	Handrim Superlight Aluminum Anodized 25", 6 Tab <i>Used with 25" Superlight Spoke</i>	1	\$98.18
1b	502237	Handrim Aluminum Anodized 6 Tab 25" w/ Micro Grip <i>Used with 25" Superlight Spoke</i>	1	\$112.35
2.0	100536	M5 x 12 BTN SHCS ZC <i>Used with Superlight Spoke</i>	6	\$2.21

Item Number	Part Number	Description	Quantity	Retail
3	100657	M5 Nylock Nut Blk Zn <i>Used with Spinergy</i>	6	\$0.56
5	100629	Handrim Spacer Alum Ano Riv <i>Used with X Core Mag</i>	5	\$1.16
6	100724	M5 x 55 PH TRS HD M/S ZC <i>Used with X Core Mag</i>	5	\$1.10
8	100653	Handrim Spacer Spoke <i>Used with MAXX Spoke wheels</i>	6	\$1.10
9	100698	Handrim Tab <i>Used with Ki Spoke and MAXX Spoke wheels. Tabs are included / installed with MAXX Spoke wheels.</i>	6	\$4.17
10	100654	M5 x 40 DIN7985 PH Pan HD M/S ZC <i>Used with MAXX Spoke wheels</i>	6	\$1.66

Handrim Hardware Chart

Wheel		Handrim Connection				Handrim								
Wheel	Wheel Part No.	Connection Points	Tab	Spacer*	Screw*	Aluminum Anodized	Superlight	Plastic Coated	Projection	Natural Fit Standard	Natural Fit LT	Flex Rim		
18" Ki Spoke ¹	200529	3	100698	100653	Aluminum, Plastic Ctd, Projection: 100654	100206		101106						
20" Ki Spoke ¹	200530	6				Natural Fit: 100835	200536		200542					
22" Ki Spoke ¹	200531						100560		100576	100569	200538	200201		
24" Ki Spoke ¹	200532				200349			100577	200547	100793	200202			
25" Ki Spoke ¹	200533				200350		101870	200548	200539	200540				
26" Ki Spoke ¹	200534				200351		100578	200549	100907	101454				
24" Superlight	101159		6			100536	100754	101161	100836		100830	100828		
25" Superlight	101160							101160	101091		101464	101460		
20" 5-Spoke X Core	101961	5		Aluminum, Projection, Natural Fit: 100629 Plastic Ctd: 101756	100724	101897		101963						
22" 5-Spoke X Core	101962					101898		101964						
24" 5-Spoke X Core	100960					100975		100976	200546					
24" 5-Spoke X Core	100960				101893					100768	100769			
20" Spinerger Spox	See Spinerger Spox Page	6			Screw: 100669 Nut: 100657	103125		103179						
22" Spinerger Spox						100827		100808		100889	100888			
24" Spinerger Spox						100766	101161	100615		100830	100828			
25" Spinerger Spox						100767	101160	100765		101464	101460			
26" Spinerger Spox						101477		101148		200200	100950			
22" Spinerger LX	See Spinerger LX Page	6			Screw: 100669 Nut: 100657	100827		100808		100889	100888			
24" Spinerger LX						100766	101161	100615		100830	100828	See Spinerger LX Page		
25" Spinerger LX						100767	101160	100765		101464	101460			
26" Spinerger LX						101477		101148		200200	100950			
18" MAXX Spoke	109285	3	100698 (Not used w/ Superlight Handrim)	100653 (Not used w/ Superlight Handrim)	Aluminum, Plastic Ctd, Projection: 100654	100206		101106						
20" MAXX Spoke	108244	6				Natural Fit: 100835	200536		200542					
22" MAXX Spoke	105135						100560		100576	100569	200538	200201		
24" MAXX Spoke	105136				200349		101161	100577	200547	100793	200202			
25" MAXX Spoke	107436				200350		101870	200548	200539	200540				
26" MAXX Spoke	107437				200351		100578	200549	100907	101454				

* Spacer and screw part numbers listed in the chart are for standard handrim mounting. If using close mount handrim mounting on aluminum anodized, plastic coated or projection handrims, use part number 000240 for the spacer, part number 102616 for the screw on Ki Spoke and MAXX Spoke wheels or part number 100666 for the screw on 5-Spoke X Core wheels.

¹ Discontinued